

MDC2-1004-BLK Manual Artwork

Dimensions: 546.975mm x 95mm
Print 4 color, 2 sided, accordion fold

MONSTER[™] 2K QHD SMART DASH CAMERA WITH WIFI



Operation Manual MODEL MDC2-1004-BLK V1.0 0225

Introduction

Thank you for choosing the Monster 2K QHD Smart Dash Camera! This WiFi-enabled camera records your drive in stunning 1440P HD quality, so you never miss a detail. Easily access your footage and other helpful features through the free, user-friendly app. Featuring a discreet design and seamless technology, your camera will provide you with peace of mind on every journey. Drive smarter with Monster!

Features

- Record and take photos of your car exterior
- Connect to your phone with WiFi
- Download the footage via the free app or a MicroSD (not included)
- Record and protect collision footage with G-Sensor and Parking Monitoring

What's Included

- 2K Smart Dash Camera
- Mount
- 12ft 12V DC Power Adapter
- Manual

What You Need

- Mobile device with WiFi enabled (requires iOS 12 or Android 11 and above)
- MicroSD card (256GB Max)

Safety Warnings

Please read all instructions before using this product. If damage is caused by failure to follow the instructions, the warranty is null and void.

Dash Cam Recording Tips:

- Recording quality can be affected by lighting conditions such as directly facing bright sunlight, entering/exiting darkness, and tinted windshields.
- Recording quality can be affected by a dirty lens or windshield. Ensure that the lens and windshield are free from dirt and foreign material.

Important Safety Information and Care Tips:

- Exercise all due caution when using this product and obey all applicable traffic laws.
- Do not install the product in a location where it can interfere with the driver's vision of the road and surroundings, or interferes with vehicle operating controls.
- Do not place unsecured on the vehicle's dashboard.
- Never attempt to take pictures, view recordings, or adjust the product while driving.
- Do not expose the product to rain or moisture, or do not use near water such as swimming pools, bathtubs, or sinks.
- Do not expose the product to excessive heat.
- Do not use the product in a strong magnetic field.

- When not in use, disconnect the car adapter from the vehicle's 12V DC power outlet.
- Do not use the product if damaged or modified.
- Do not disassemble. There are no serviceable parts inside.
- This product is equipped with a lithium-ion battery. Do not puncture or damage the product, attempt to remove the battery, or expose the product to a fire.
- Do not use abrasive cleaning solvents to clean the product.

KEEP YOUR ATTENTION ON THE ROAD. DO NOT OPERATE THIS PRODUCT WHILE DRIVING.

At a Glance

- Mount Port
- USB-C Port
- MicroSD Port
- Up/Right Arrow
- Menu / Delete / Lock / Unlock
- Down / Left Arrow
- Camera Lens
- Ok / Select
- Camera / File Management / Go Back
- Lock File Button
- Power On / Off
- Display Screen
- Microphone
- Reset Button
- Camera Mount Suction Cup
- Camera Mount Locking Lever
- Camera Mounting Clip
- Power Cord USB-C Connector
- Power Cord 12V DC Connector

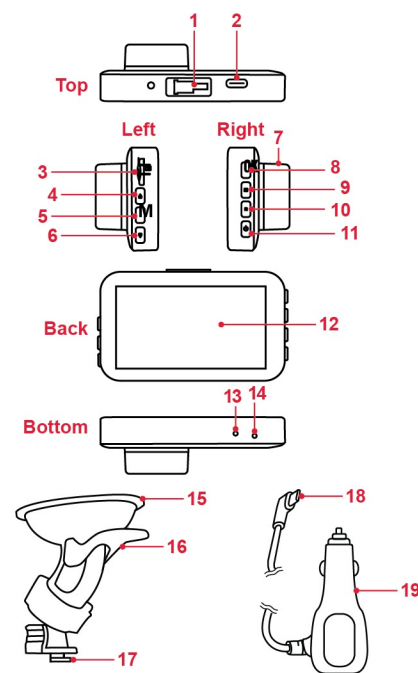

How to Use

Quick Start

- Remove the package contents.
- Insert a MicroSD card up to 256GB (not included) into the MicroSD reader and press down firmly to secure. Note: Camera will not record without a MicroSD card.
- Plug the USB-C end of the included power cord into the camera's USB-C port. Plug the other end into your car's 12V DC port (cigarette port).
- Start your engine to automatically power on the camera. You should see a blinking red camera icon with a timer on the top left of the screen, which indicates the camera is now recording.
- The camera will automatically power off when you turn off your car engine. To manually power off the camera, press and hold the Power On/Off button.

Installation

- Insert the mount into the camera's mount port with the mounting clip nub positioned on the right. Slide the mount to the right to fasten it. Check to make sure it is secure.
- Choose where you want to place the camera on your windshield and wipe the area with a clean cloth. Recommended: Choose a location near the rearview mirror that will provide a clear picture of the car exterior without obstructing the driver's view.

- Hold the camera in place using the suction cup mount, and secure it by pressing down the locking lever. From there, you can rotate the camera as needed by swiveling the mount.
- To avoid obstructing the driver's view with the power cord, loop it over the rearview mirror and tuck it into the car headliner. String it to the right and let it fall down the right A-pillar past the passenger-side glove compartment. See diagram below for visual instructions.

Note: To remove the camera from the windshield, unfasten the locking lever before releasing the suction cup.

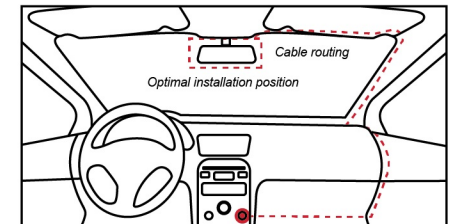

Access Saved Recordings:

- When the camera is powered on, press and hold the Camera Button for 2 seconds until it switches to the File Management screen. Here you can view your saved and locked videos.
- Saved Videos:** Once you have reached the File Management screen, press the OK Button Twice and use the Up/Down Arrows to scroll through your saved videos.

- Locked Videos:** Once you have reached the File Management screen, press the OK Button once then press the Down/Left Arrow once to reach your locked videos. Press the OK Button again, then use the Up/Down Arrows to scroll through the locked videos.

File Management			
DIRECTORY	VIDEO	VIDEO_LOCK	PHOTO
FRONT	20250109_172307_f.ts		
	20250109_172207_f.ts		
	20250109_172107_f.ts		

- Saved Photos:** Once you have reached the File Management screen, press the OK Button then press the Down/Left Arrow twice to reach your saved photos. Press the OK Button again, then use the Up/Down Arrows to scroll through the photos.
- When you reach a photo or video you want to view, press the OK Button. When you are done viewing the photo or video, press the Camera Button to return to the File Management screen.
- When you are finished viewing your videos, press the Camera Button until the camera returns to live recording mode.
Note: You can lock, unlock, or delete individual recordings by pressing the Menu Button on the left side of the camera as you scroll through your recordings.

Camera Functions:

- Turn display on/off:** Press, but do not hold, the Power On/Off button when the camera is turned on. Note: The camera will continue actively filming even if the display is turned off.
- Stop/Start recording:** Press the OK Button when the camera is turned on.
- Take photos:** Press the Camera Button when the camera is turned on but NOT actively filming.
- Access the menu:** Press the Menu Button.
- Turn on/off WiFi:** Press and hold the Up Button.
- Turn on/off G-Sensor and Parking Monitoring:** You can turn these functions on/off in the camera menu. Note: To ensure the camera operates smoothly, Parking Monitoring should be switched off while driving and should only be turned on when the car is parked.
- Lock a video while recording:** Press the Lock File Button once while the camera is actively filming to lock the current video. This means the video recording will remain locked until the loop recording restarts.
- Download saved recordings:** Use the Monster Dash Cam app or download the saved recordings directly from the MicroSD card.
- Add watermarks to the footage:** You can add license and time/date watermarks by going to the camera menu and navigating to "License Stamp" and "Time/Date Stamp."
- Erase the MicroSD:** It is important to erase or "format" your MicroSD card every month to keep your camera running smoothly. This can be done in the camera menu or in the camera settings on the Monster Dash Cam app. Important: Make sure to save any important footage before erasing the MicroSD card so your files are not lost.

Access the Wifi App

Scan this QR Code or follow the instructions below to download the free Monster Dash Cam smartphone app and connect to the camera's WiFi.

Use the NEW app to complete setup



- Turn your camera on.
- Navigate to "WiFi" in the camera menu and press the OK Button to make sure the WiFi is toggled on. This will bring you to the WiFi Information Screen.
- Scan the QR Code on screen (or the QR Code above) to download the app, or search "Monster Dash Cam" in the App Store / Google Play.
- Open the app and press the "+" symbol at the top right of the screen. Follow the instructions to add a new camera and connect to the camera's WiFi.
- When connecting to WiFi, select the SSID that starts with "FHCam" and when prompted, use the password 12345678.

Your device should now be connected.

The camera date/time will sync with your phone date/time. You can use the app to do the following:

- Stream the live video on your phone for a larger display
- Download your saved recordings via "Camera Files"
- Adjust the settings via "Camera Settings"

FAQ / Troubleshooting

What is Parking Monitoring?

Parking Monitoring automatically turns the camera on to record and lock video footage of sudden impacts when your car is parked. You can turn this function on/off in the camera menu.

Note: If Parking Monitoring is activated, you will receive a pop-up notification when you turn on the camera that says a collision was detected and instructs you to check your footage.

What is G-Sensor?

G-Sensor automatically locks video footage of collisions and sudden impacts so it cannot be overwritten. You can turn this function on/off in the camera menu.

Note: If the G-Sensor is activated, you will receive a pop-up notification on the display screen, and the blinking red recording icon will turn temporarily yellow.

Does my camera record time lapse content?

This camera is capable of recording time lapse content, but it must be hardwired to the vehicle to do so. This requires a hardwiring kit with professional installation (not included).

The camera is frozen / isn't turning on.

Stick a needle or pin into the Reset button on the bottom of the camera (labeled RE). This will reset the camera so you can use it again.

You see a "file error" message.

Option 1: Stick a needle or pin into the Reset button on the bottom of the camera (labeled RE). This will reset the camera.

Option 2: Restore the camera to factory settings by navigating to "Factory Reset" in the camera menu. This will restore the camera to default settings.

The camera keeps reverting to the default date and time.

Make sure the camera is connected to a power source and is fully charged before shutting it down to prevent this issue.

The camera shut off suddenly while filming.

Turn off the Parking Monitoring function in the camera menu (turn it back on when your car is parked and you are no longer driving). Be sure you are not operating your camera in temperatures above 70°C / 158°F.

The WiFi function isn't working.

Make sure the WiFi on both your camera and smartphone is turned on, and that you allow all permissions when prompted. Keep your smartphone close to the camera (within several feet).

If this doesn't solve the problem, forget the camera's WiFi network on your smartphone and then reconnect to the camera's WiFi. You can also try restarting your phone and the camera.

If you continue to encounter the issue, contact the manufacturer.

Customer Service

Extend Your Warranty

Scan QR code on the front cover of this manual to extend your product warranty to 2 years.

866-246-2008

customerservice@monsterilluminescence.com

In the event this product becomes defective, please do not return this product to your retailer.

Jem Accessories, Inc. Limited Warranty Policy for Monster Smart Products Last Updated: March 27, 2020

This limited warranty contains important information about your rights and obligations, as well as limitations and exclusions that may apply to you.

- WHAT THIS LIMITED WARRANTY COVERS; PERIOD OF COVERAGE** Jem Accessories, Inc. ("Jem Accessories"), 32 Brunswick Ave, Edison, New Jersey, USA, warrants to the owner of the enclosed Monster Smart-branded product contained in this box ("Product") will be free from defects in materials and workmanship for a period of one year. Notwithstanding the foregoing, the Warranty Period for a factory refurbished Product is one (1) year, even if installed by a professional. If the Product fails to conform to this Limited Warranty during the Warranty Period, Jem Accessories will, at its sole discretion, either (a) repair or replace any defective Product or component, with proof of purchase using original documentation. Repair or replacement may be made with a new or refurbished product or components, at Jem Accessories's sole discretion. If the Product or a component incorporated within it is no longer available, Jem Accessories may, at Jem Accessories's sole discretion, replace the Product with a similar product of similar function. This is your sole and exclusive remedy for breach of this Limited Warranty. Any Product that has either been repaired or replaced under this Limited Warranty will be covered by the terms of this Limited Warranty for the longer of (a) ninety (90) days from the date of delivery of the repaired Product or replacement Product, or (b) the remaining Warranty Period. This Limited Warranty is not transferable from the original purchaser to subsequent owners.
- TOTAL SATISFACTION RETURN POLICY** If you are the original purchaser of the Product and you are not satisfied with this Product for any reason, you may return it in its original condition to the retailer in compliance with the retailer's return policy.
- WARRANTY CONDITIONS; HOW TO GET SERVICE IF YOU WANT TO CLAIM UNDER THIS LIMITED WARRANTY** Before making a claim under this Limited Warranty, the owner of the Product must (a) visit monsterilluminescence.com/support during the Warranty Period to provide notice of your warranty claim and describe the alleged failure, and (b) comply with Jem Accessories (or its authorized distributor's) return shipping instructions. Jem Accessories will have no warranty obligations with respect to a returned Product if it determines, at its reasonable discretion after examination of the returned Product, that the Product is an Ineligible Product (defined below).
- WHAT THIS LIMITED WARRANTY DOES NOT COVER** This Limited Warranty does not cover the following (collectively "Ineligible Products"): (i) Products marked as "sample" or "Not For Sale," or sold "AS IS"; (ii) Products that have been subject to: (a) modifications, alterations, tampering, or improper maintenance or repairs; (b) handling, storage, installation, testing, or use not in accordance with any quick start guide, manual or other instructions provided by Jem Accessories; (c) abuse or misuse of the Product; (d) breakdowns, fluctuations, or interruptions in electric power or the telecommunications network; or (e) Acts of God, including but not limited to lightning, flood, tornado, earthquake, or hurricane; or (iii) any non-Jem Accessories branded hardware products, even if packaged or sold with Jem Accessories hardware. This Limited Warranty does not cover consumable parts, including batteries, unless damage is due to defects in materials or workmanship of the Product, or software

(even if packaged or sold with the product). Jem Accessories recommends that you use only authorized service providers for maintenance or repair. Unauthorized use of the Product or software can impair the Product's performance and may invalidate this Limited Warranty.

- DISCLAIMER OF WARRANTIES** Except as stated above in this limited warranty, and to the maximum extent permitted by applicable law, Jem Accessories disclaims all express, implied, and statutory warranties and conditions with respect to the product, including the implied warranties of merchantability and fitness for a particular purpose. To the maximum extent permitted by applicable law, Jem Accessories also limits the duration of any applicable implied warranties or conditions to the duration of this limited warranty.
- LIMITATION OF DAMAGES** In addition to the above warranty disclaimers, in no event will Jem Accessories be liable for any consequential, incidental, exemplary, or special damages, including any damages for lost data or lost profits, arising from or relating to this limited warranty or the product, and Jem Accessories's total cumulative liability arising from or related to this limited warranty or the product will not exceed the amount actually paid for the product by the original purchaser.
- LIMITATION OF LIABILITY** The Jem Accessories online services at monsterilluminescence.com ("Services") provide you information ("product information") regarding your Jem Accessories products or other peripherals connected to your products ("product peripherals"). The type of product peripherals that may be connected to your product may change from time to time. Without limiting the generality of the disclaimers above, all product information is provided for your convenience, "as is" and "as available". Jem Accessories does not represent, warrant, or guarantee that product information will be available, accurate, or reliable or that product information or use of the services or product will provide safety in your home. You use all product information, the services, and the product at your own discretion and risk. You will be solely responsible for (and Jem Accessories disclaims) any and all loss, liability, or damages, including to your wiring, fixtures, electricity, home, product, product peripherals, computer, mobile device, and all other items and pets in your home, resulting from your use of the product information, services, or product. Product information provided by the services is not intended as a substitute for direct means of obtaining the information. For example, a notification provided through the service is not intended as a substitute for audible and visible indicators in the home and on the product, nor for a third party monitoring service that monitors alarm state.
- YOUR RIGHTS AND THIS LIMITED WARRANTY** This Limited Warranty gives you specific legal rights. You may also have other legal rights that vary by state, province, or jurisdiction. Likewise, some of the limitations in this Limited Warranty may not apply in certain states, provinces or jurisdictions. The terms of this Limited Warranty will apply to the extent permitted by applicable law. For a full description of your legal rights you should refer to the laws applicable in your jurisdiction and you may wish to contact a relevant consumer advisory service. If you need to start a warranty claim for your Monster Smart device, please reach out to Customer Support by emailing customerservice@monsterilluminescence.com or calling our support number 866-246-2008. Please allow 7-10 business days to process warranty claims. Customers located outside of U.S. will be responsible for all shipping costs.

FCC Compliance Notice

Changes or modifications not expressly approved by the party responsible for compliance could void this user's authority to operate this device. This device complies with part 15 of the FCC Rules. Operation is subject to the following two conditions: (1) This device may not cause harmful interference, and (2) this device must accept any interference received, including interference that may cause undesired operation. Note: This equipment has been tested and found to comply with the limits for a Class B digital device, pursuant to Part 15 of the FCC rules. These limits are designed to provide reasonable protection against harmful interference in a residential installation. This equipment generates, uses and can radiate radio frequency energy and, if not installed and used in accordance with the instructions, may cause harmful interference to radio communications. However, there is no guarantee that interference will not occur in a particular installation. If this equipment does not cause harmful interference to radio or television reception, which can be determined by turning the equipment off and on, the user is encouraged to try to correct interference by one or more of the following measures:

- Reorient or relocate the receiving antenna
- Increase the separation between the equipment and receiver
- Connect the equipment into an outlet on a circuit different from that to which the receiver is connected
- Consult the dealer or an experienced radio/TV technician for help

FCC RADIATION EXPOSURE STATEMENT

This equipment complies with FCC radiation exposure limits set forth for an uncontrolled environment. This equipment should be installed and operated with a minimum distance of 20cm between the radiator & your body. This transmitter must not be co-located or operating in conjunction with any other antenna or transmitter.

MONSTER

The illustrated products and specifications may differ slightly from those supplied. The Monster logo is a registered trademark of Monster, Inc. or its subsidiaries in the U.S. and other countries and are used under license. Google, Android, Android Auto and Google Play are trademarks of Google LLC. Apple, Apple CarPlay, and the Apple logo are trademarks of Apple Inc., registered in the U.S. and other countries. All other brand names are trademarks of their respective owners. Neither Jem Accessories, Inc. nor Monster, Inc. is affiliated with the respective owners of their trademarks. Licensed and Manufactured by Jem Accessories, Inc. Edison, NJ 08871.