



# KEPLER

## Device Guide

### Version 1.3



Visit [www.ainaptt.com](http://www.ainaptt.com) to find additional solutions and more user guides. If you have any further questions, you can also email us at: [www.ainaptt.com/contact/](mailto:www.ainaptt.com/contact/)

# TABLE OF CONTENTS

**NOTE!** In order to start using your Kepler, your administrator must (1) activate an AINA Small Talk subscription for you and (2) register your device through the AINA Admin Console. Guides for this process can be found from: [www.ainaptt.com/guides-and-manuals](http://www.ainaptt.com/guides-and-manuals)

## GENERAL

3

▲ 1. Included in the package .....	3
▲ 2. Buttons and connections .....	3
▲ 3. Button functions .....	4
▲ 4. Icons .....	4
▲ 5. Charging the battery .....	4
▲ 6. Inserting the SIM- card .....	5
▲ 7. Power ON/OFF .....	5

## KEPLER DEVICE FEATURES AND FUNCTIONS

6

▲ 1. Home screen .....	6
▲ 2. Settings .....	8
▲ 3. Tips and safety .....	9

# GENERAL

## 1. Included in the package



x1

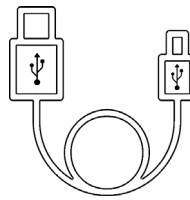

x1



x1

## 2. Buttons and connections

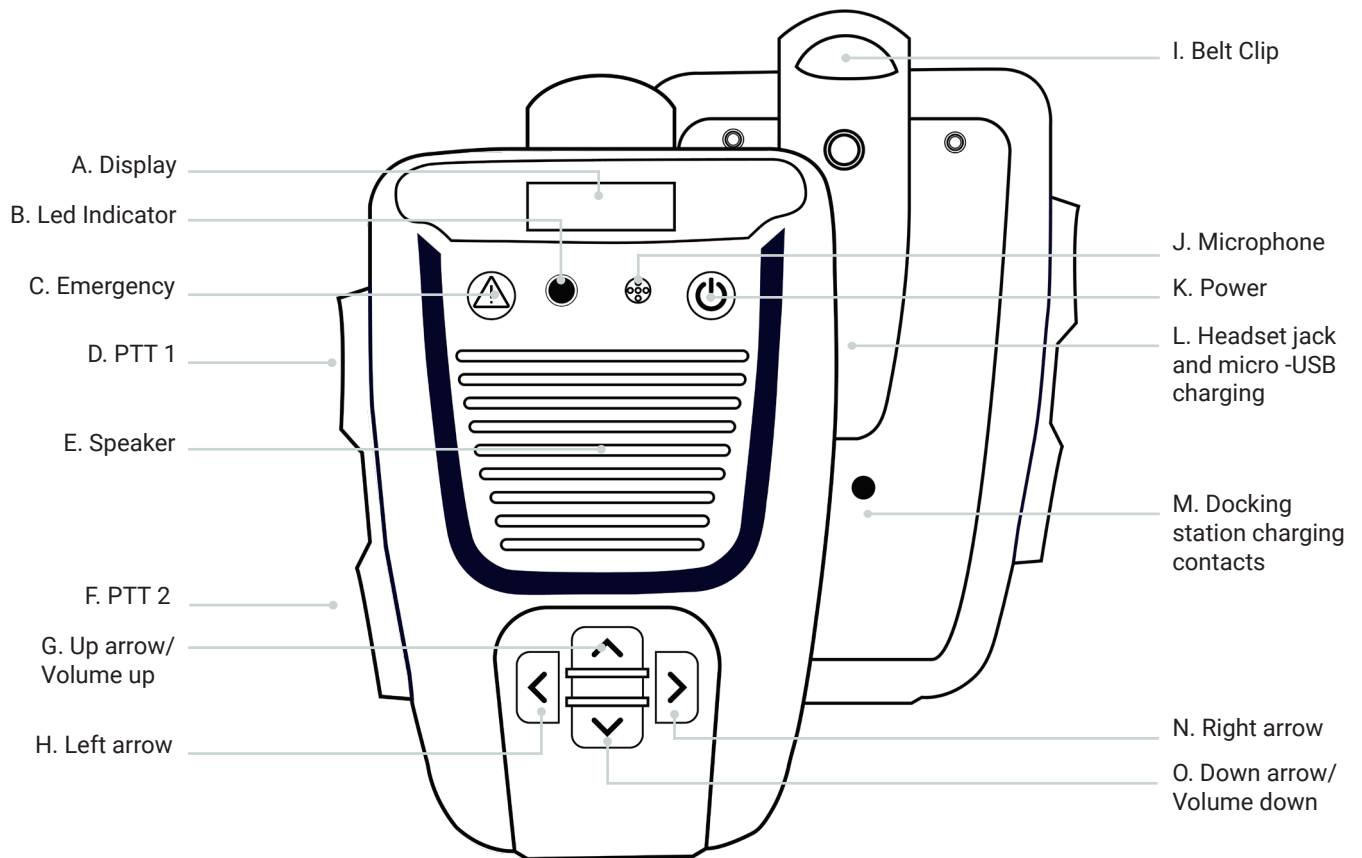

### 3. Button functions



- Press for long to turn the device on or off.
- While the device is off and charging, pressing the button will show the battery level. When the device is on, it will open or close the device's menu.
- While the Screen saver is on, pressing the button will open main screen.



- During operation, the up and down arrow buttons are for volume control.
- While the device is on the settings menu, the up and down arrow can be used for selection.



- Press for 3 seconds to active or cancel an emergency call.



- During operation, pressing the left or right arrow will change the PTT1 group. Pressing the left or right arrow for 3 seconds will change the PTT2 group.
- While the device is on the settings menu, the left and right arrow can be used for selection.

### 4. Icons



Battery status. When there is an exclamation mark (!) above the icon, the battery is in critical level.



Network strength.



GPS positioning on.



Connected to the service.



Disconnected from the service.



Headphones connected.

### 5. Charging the battery

1



Connect the provided USB cable to the device and wall charger.

2



The display will show the battery level for 30 seconds.

3



Wait until the device is fully charged.

4



Disconnect the USB cable.

**NOTE!** Recommended wall charger rating: 2A.

## 6. Inserting the SIM-card

1

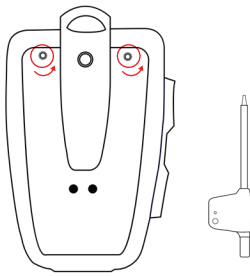

Turn off the device. Open the battery cover with the provided screwdriver and remove the device's battery.

2

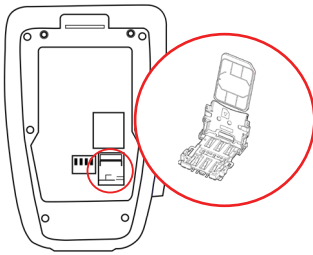

Slide the SIM card holder downward, lift the holder into an upright position and slide the SIM card into the holder. Make sure the SIM card's gold contacts face into the device and the angled corner of the card is positioned correctly (as shown in the picture on the left). Set back down the SIM card holder and slide it upwards to secure it (the SIM card should be lying flat on the device).

3

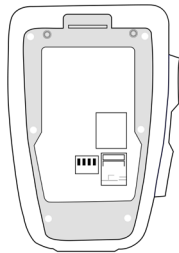

Make sure the inside of the device is clear of any dust and dirt, specially the grey area shown, to ensure the water-tightness of the device.

4

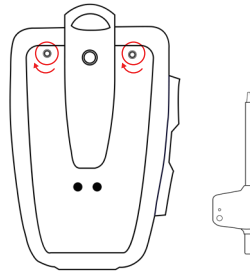

Insert the battery back into the device so that the battery contacts align and the battery label faces into the device. Then slide the battery cover back into place and screw it shut. Do not over tighten.

**NOTE 1!** You will need a nano-SIM card.

**NOTE 2!** The screwdriver head size is TX6.

## 7. Power ON/OFF

ON



OFF

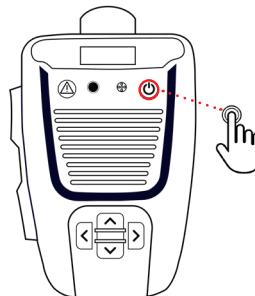

Turn on by pressing the Power button until the green LED turns off. Turn off by first pressing the Power button until "Shutdown?" appears on the screen, and then press the right arrow button to confirm the shutdown process. You can also shutdown the device through the main menu.

**NOTE!** Pressing the Power button for longer than 7 seconds, will restart the device. This should only be used if the device is unresponsive.

We recommend getting a nano SIM-card which has the PIN lock feature deactivated. If it is activated, you will need to insert your PIN when turning on the device by scrolling through the numbers using the up and down arrow buttons, and confirming by pressing the right arrow button. Once you have inserted your complete PIN number, press the right arrow button for 3 seconds to confirm.

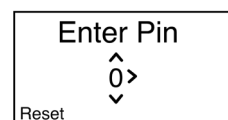

# DEVICE FEATURE AND FUNCTIONS

**NOTE!** In order to start using your Kepler, your administrator must (1) activate an AINA Small Talk subscription for you and (2) register your device through the AINA Admin Console. Guides for this process can be found from: [www.ainaptt.com/guides-and-manuals](http://www.ainaptt.com/guides-and-manuals)

## 1. Home screen

From your Kepler's home screen you can see and do several things.

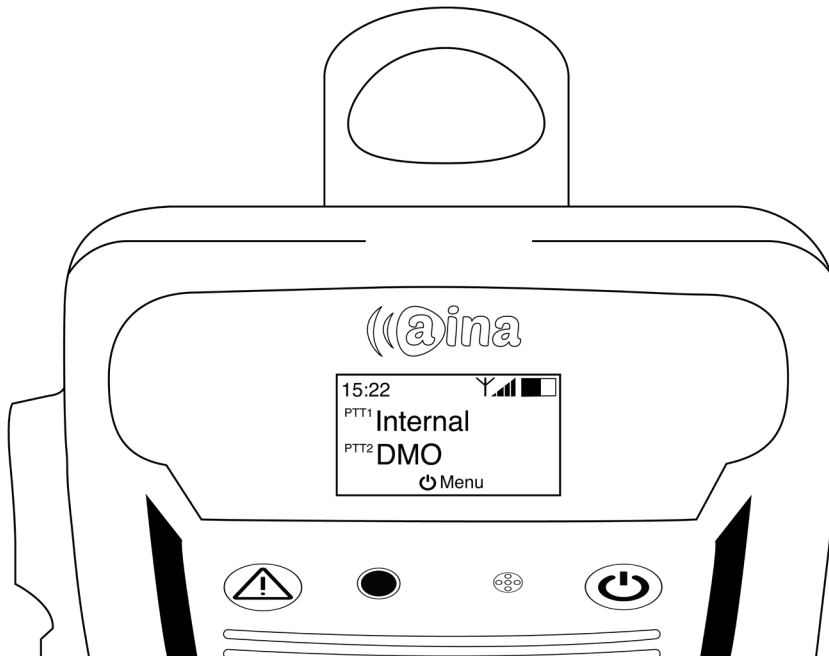

### 1 Device status

At the top, the icons indicate the status of your device (battery, connectivity etc.) Go back to page 4 to learn more about what each icon means.

### 2 Push-to-Talk and communicating with talk groups

From the middle of the home screen you can see what talk group will be contacted if you press the PTT1 or PTT2 button. These talk groups are created and managed through the PTT application being used. When using AINA Small Talk, the talk groups and its members can be modified through the AINA Admin Console.

**Push-to-Talk.** Press the PTT1 or PTT2 button and keep it pressed to contact the corresponding talk group. Release the button when you are done talking. The Kepler's display will indicate when you are talking or receiving a message from a talk group.

**Changing talk group.** If you are part of more than one talk group, you can scroll through the available groups by pressing the left or right arrow button on your device. A quick press will change the PTT1 group and a long press (~3 seconds) will change the PTT2 group.

### 3

#### DMO

Direct Mode Operation (DMO) is a feature that allows for off-network communication. With DMO, the message sent off the network will bounce once from a nearby Kepler to the next, creating a mesh-network with nearby users.

If your administrator has enabled DMO for your device, you will see this on your device's home screen as a talk group.

**DMO Push-to-Talk.** Press the assigned PTT1 or PTT2 button and keep it pressed to contact nearby members through DMO. Release the button when you are done talking. The Kepler's display will indicate when you are talking or receiving a message through DMO.

### 4

#### Emergency

With the Kepler you can also initiate emergency calls if you are in an emergency or distress situation. With AINA Small Talk as your PTT application, pressing the emergency button will alert all the users in your company and automatically open your microphone for them to listen in.

**Emergency call.** Press the emergency button for 3 seconds to activate or cancel an emergency call. After activating the emergency call by pressing the button, you will see a 10 second timer on the screen before the alert is sent to other users. You can still cancel the emergency call during before the timer runs out.

### 5

#### Volume control

Press the up or down arrow button to control the device's volume. The Kepler's display will indicate at which volume level you are.

## 2. Settings

By pressing the power on/off button on the device, you can access or exit the device's settings menu.

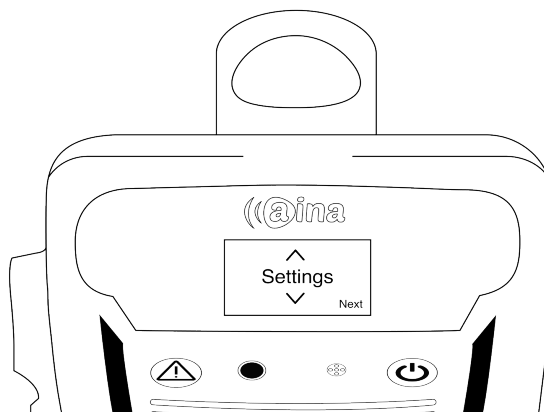

Use the up and down arrow buttons to scroll through settings categories on the device's display. Press the right arrow button to select or confirm a setting and the left arrow button to go back.

Contacts	The list of you contacts	
Settings	Network	<b>Roaming</b> Turn on/ off roaming mode.
	Modem	<b>APN Settings</b> Auto/ Manual. Create APN name.
	Display	<b>Brightness</b> Adjust the display's brightness.
		<b>Inversion</b> Invert the colours of the display.
		<b>Flipping</b> Flip the display.
		<b>Screen Saver</b> Choose when the device should go into saving mode.
	Audio	<b>Notifications</b> Enable/ disable notifications sounds.
		<b>Ringtone</b> Adjust the rington's volume.
		<b>Microphone</b> Choose which microphone to use, the device's or headsets.
		<b>AEC</b> Enable/ disable AEC.
		<b>Microphone level</b> Adjust microphone level.
	Date & Time	<b>Time format</b> Choose which time format to use.
		<b>Time zone</b> Choose which time zone to use.
About	<b>Status</b> Summary of settings chosen.	
	<b>Battery</b> Battery level (%).	
	<b>Modem</b> The device's IMEI number.	
	<b>Network</b> IP address, MAC address, APN.	
	<b>Software</b> Software version numbers.	
Shutdown	<b>Shutdown?</b> Shutdown the device.	



### 3. Tips and safety

#### Microphone performance tip

For best results, hold the device 15-20cm from your mouth when speaking.

#### Safety

1. Do not put the device near your ear, SPL > 100dBA.
2. Avoid contact with magnetic stripe cards.
3. Charging temperature: 0°C - + 45°C.
4. Operation temperature: -10°C - + 60°C.

Frequency	Output power
WCDMA B1,B8	25dBm
LTE B1/3/7/8/20/28/38/40	25dBm
ISM 2.4GHz	20dBm
NFC 13.56MHz	-