



Tru-Comfort Temperature Control Cushion System

**Cooling Unit and Heating/Cooling Unit
User Manual**

viotekusa.com

IC statement

This device complies with Industry Canada license's exempt RSS standard(s).

Operation is subject to the following two conditions: (1) this device may not cause interference, and (2) this device must accept any interference, including interference that may cause undesired operation of the device.

Le présent appareil est conforme aux CNR d'Industrie Canada applicables aux appareils radio exempts de licence. L'exploitation est autorisée aux deux conditions suivantes : (1) l'appareil ne doit pas produire de brouillage, et (2) l'utilisateur de l'appareil doit accepter tout brouillage radioélectrique subi, même si le brouillage est susceptible d'en compromettre le fonctionnement.

SPECIFICATIONS

Working Voltage
10.5~15V

Working Current
0.2~1.5A (Cooling)
0.2~4.2A (Heating)

Working Power
3~50W

Temperature Control
75°F~114°F (24°C~46°C)

Cooling Power Consumption
4w/seat

Heating Power Consumption
50w/seat

Unit Noise Rating
25~55 Decibels

For more information, please visit
www.viotekusa.com or email a request to:
support@viotekusa.com

Support Line: 1-855-229-9472

Personal Climate Control

This unique system runs independently of your vehicle's climate control, preventing interference and ensuring optimal performance.

Built with Quality Materials

We've used some of the best materials available to design the most comfortable and luxurious seating system possible.

Cooling

For those blistering hot days, this system features our patented moisture-wicking technology and a customizable, 5 level Cooling Mode that can continuously cool your seat whenever you like.

Heating

Take the bite out of those cold nights with our 5 level Heating Mode. Adjust temperatures from 86°F to 122°F according to your preference.

Intelligent Temperature Control

Our system will automatically regulate its temperature based on your indicated settings for the best comfort.

Interior Match

Our system is available in beige, light grey, black and brown. Finding a match to your car's interior is easy.

Simple Switching

At the touch of a button, switch between Cooling Mode and Heating Mode.

Eco-Friendly

With just a single cigarette lighter receptacle in your vehicle, our system uses a minimal amount of power to achieve the desired temperature.

Inside the box

Heating/Cooling Unit and Cooling Only Unit

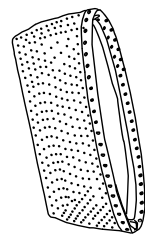

Fan Case x 1

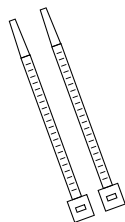

Zip Tie x 1

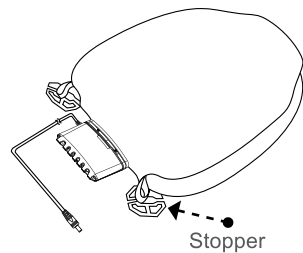

Seat Cushion x 1

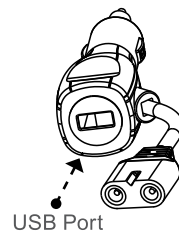

DC Power Inlet x 1

Remote

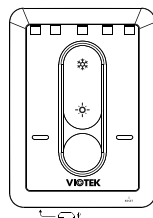

Heating/Cooling Unit Remote

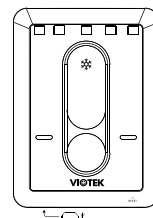

Cooling Unit only Remote

CAUSED INCLUDING THE REPLACEMENT OF EQUIPMENT AND PROPERTY, ANY COSTS OF RECOVERING, PROGRAMMING OR REPRODUCING ANY PROGRAM OR DATA STORED IN OR USED WITH THE PRODUCT AND ANY FAILURE TO MAINTAIN THE CONFIDENTIALITY OF DATA STORED ON THE PRODUCT. THE FOREGOING LIMITATION SHALL NOT APPLY TO DEATH OR PERSONAL INJURY CLAIMS, OR ANY STATUTORY LIABILITY FOR INTENTIONAL AND GROSS NEGLIGENT ACTS AND/OR OMISSIONS. VIOTEK DISCLAIMS ANY REPRESENTATION THAT IT WILL BE ABLE TO REPAIR ANY PRODUCT UNDER THIS WARRANTY OR MAKE A PRODUCT EXCHANGE, AND IS UNABLE TO RECOVER ANY USER SOFTWARE OR DATA ON THE DEVICE.

DECLARATION OF CONFORMITY

This device complies with Part 15 of the FCC Rules.

Operation is subject to the following two conditions: (1) This device may not cause harmful interference, and (2) this device must accept any interference received, including interference that may cause undesired operation.

FEDERAL COMMUNICATIONS COMMISSION NOTICE

“Warning: Changes or modifications to this unit not expressly approved by the party responsible for compliance could void the user’s authority to operate the equipment.”

This equipment has been tested and found to comply with the limits for a Class B digital device, pursuant to Part15 of the FCC Rules. These limits are designed to provide reasonable protection against harmful interference in a residential installation. This equipment generates, uses, and can radiate radio frequency energy and, if not installed and used in accordance with the instructions, may cause harmful interference to radio communications.

However, there is no guarantee that interference will not occur in a particular installation. If this equipment does cause harmful interference to radio or television reception, which can be determined by turning the equipment off and on, the user is encouraged to try to correct the interference by one or more of the following measures:

- + Reorient or relocate the receiving antenna.
- + Increase the separation between the equipment and receiver.
- + Connect the equipment into an outlet on a circuit different from that to which the receiver is connected.
- + Consult the dealer or an experienced radio/TV technician for help.

1 YEAR LIMITED HARDWARE WARRANTY

abuse, neglect or improper maintenance, use under abnormal conditions, accidental drops, abuse or fire;
 (f) Damage to the Product caused by an external electrical fault, surge, or any electrical anomaly;
 (g) Any contamination, condition or other circumstance, which Viotek, in its sole discretion, considers a danger to health and safety, including, but not limited to any contact between the Product and a biohazard, bodily fluids, infectious materials/substance, chemicals, hazardous substances, diseases, radiation, or other;
 (h) Fraud, theft, misplacement, unexplained disappearance, or willful acts.

DISCLAIMER OF WARRANTY

TO THE EXTENT PERMITTED BY LAW, THIS WARRANTY AND THE REMEDIES SET FORTH ABOVE ARE EXCLUSIVE AND IN LIEU OF ALL OTHER WARRANTIES, REMEDIES AND CONDITIONS, WHETHER ORAL, WRITTEN, STATUTORY, EXPRESS OR IMPLIED. AS PERMITTED BY APPLICABLE LAW, VIOTEK SPECIFICALLY DISCLAIMS ANY AND ALL STATUTORY OR IMPLIED WARRANTIES, INCLUDING, WITHOUT LIMITATION, WARRANTIES OF MERCHANTABILITY, FITNESS FOR A PARTICULAR PURPOSE, AND WARRANTIES AGAINST HIDDEN OR LATENT DEFECTS. IF VIOTEK CANNOT LAWFULLY DISCLAIM STATUTORY OR IMPLIED WARRANTIES THEN TO THE EXTENT PERMITTED BY LAW, ALL SUCH WARRANTIES SHALL BE LIMITED IN DURATION TO THE DURATION OF THE EXPRESS WARRANTY AND TO THE REPAIR OR REPLACEMENT SERVICE AS DETERMINED BY VIOTEK IN ITS SOLE DISCRETION. NO RESELLER, AGENT, OR EMPLOYEE IS AUTHORIZED TO MAKE ANY MODIFICATION, EXTENSION, OR ADDITION TO THIS WARRANTY. IF ANY TERM(S) IS HELD ILLEGAL OR UNENFORCEABLE, THE LEGALITY AND ENFORCEABILITY OF THE REMAINING TERMS SHALL NOT BE AFFECTED OR IMPAIRED.

EXCEPT AS PROVIDED IN THIS WARRANTY AND TO THE MAXIMUM EXTENT PERMITTED BY LAW, VIOTEK IS NOT RESPONSIBLE FOR DIRECT, INDIRECT, SPECIAL, INCIDENTAL OR CONSEQUENTIAL DAMAGES RESULTING FROM ANY BREACH OF WARRANTY OR CONDITION OR PERFORMANCE OF THE PRODUCT, OR UNDER ANY OTHER LEGAL THEORY, INCLUDING BUT NOT LIMITED TO LOSS OF USE; LOSS OF REVENUE; LOSS OF ACTUAL OR ANTICIPATED PROFITS (INCLUDING LOSS OF PROFITS ON CONTRACTS); LOSS OF THE USE OF MONEY; LOSS OF ANTICIPATED SAVINGS; LOSS OF BUSINESS; LOSS OF OPPORTUNITY; LOSS OF GOODWILL; LOSS OF REPUTATION; LOSS OF, DAMAGE TO, COMPROMISE, OR CORRUPTION OF DATA; OR ANY INDIRECT OR CONSEQUENTIAL LOSS OR DAMAGE HOWSOEVER

Installation & Usage

1. Adjust the seat position to leave as much space as possible between the seat back and the seat bottom. Next, carefully push the *Unit* and *Stoppers* through the gap between the seat sections. Use the *Stoppers* to secure the cushion's position.

NOTE: Use the *Fan Case* in order to reduce the noise when the fan is in use. It is not required for the seat cushion to function.

2. Slip the *Securing Band* over the head rest and down the back of the seat. Fasten the *Buckle* around the back of the headrest.
3. Pull the front of the cushion around the edge of the seat and under the bottom the seat. Use the metal hooks to secure to the undercarriage of the seat.

NOTE: Take note of the location of the hooks when placing under the seat. All vehicle seats have moving parts and placing a hook too close to one or more of these parts may cause damage.

4. Connect the Power Cord to the DC Power Inlet. Then, insert the outlet into a cigarette lighter receptacle.

NOTE: Up to two (2) seat cushion systems can be connected to a single *DC Power Inlet*.

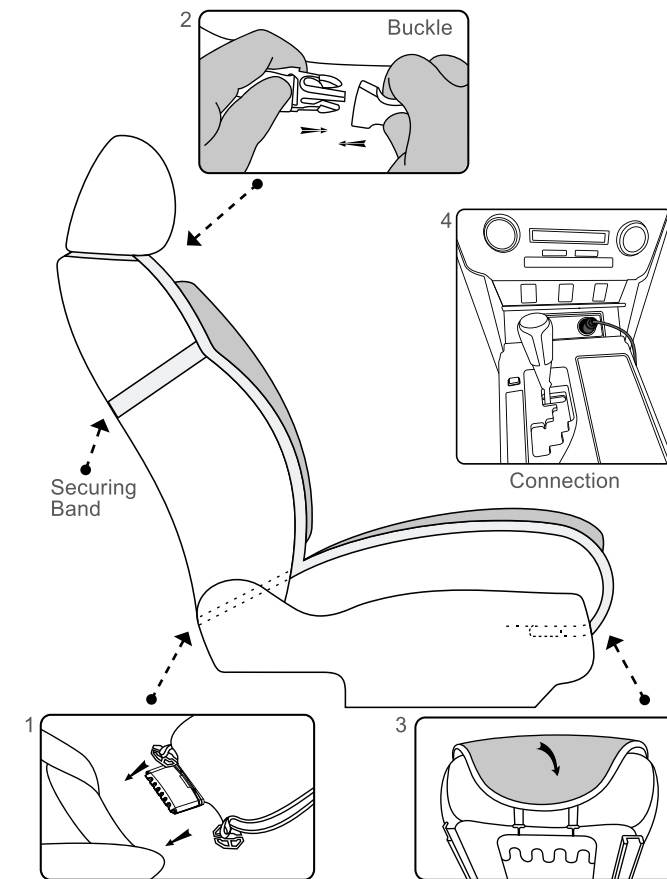

Remote Diagram

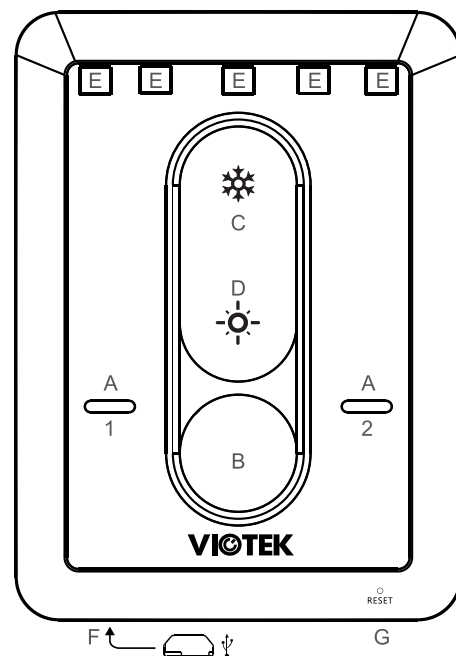

- A. Selected Chair Indicator (1-2, left to right)
- B. Chair Selector
- C. Cooling & (+) (Cooling On/Off & Increases Cooling/Heating)
- D. Heating & (-) (Heating On/Off & Decreases Cooling/Heating)
- E. Level Indicator (1-5, right to left)
- F. Micro USB Charging Port*
- G. Reset (restores remote to factory settings)

NOTE: To reset the remote, use a paperclip or other appropriate object. Insert the end carefully to reach and press the embedded reset button.

NOTE: : The Viotek logo will flash to indicate low battery power. For more information on recharging the remote, see pages 7 and 8 according to whichever cushion system you purchased.

1 YEAR LIMITED HARDWARE WARRANTY

Viotek Inc. (Viotek) offers a ONE YEAR limited warranty covering the hardware of Viotek Seat Cushion (“Product”), limited to those residing in the 50 US States and Canada. This warranty gives you specific legal rights and you may also have other rights which vary from state to state.

Viotek warrants the Product to be free from defects in materials and workmanship under normal use for one (1) year, as sold to the original purchaser, from the date of retail purchase by the original end-user purchaser. If a hardware defect arises and a valid claim is received within the warranty period, at its option and to the extent permitted by law, Viotek will: (1) repair the hardware defect by using new or refurbished parts that are equivalent to new in performance and reliability; or (2) exchange the product with a product that is new or refurbished, that is substantially equivalent to the original product. This warranty is for replacement for like-items only and does not cover items out of production if the company no longer stocks them. This warranty is not assignable or transferable. The original purchaser may call the Viotek toll-free number at 1-855-229-9472 for service request.

Upon Viotek’s replacement or repair of a Product under warranty, the original end-user purchaser will have the remaining warranty under the original warranty period (without any postponement during repair or replacement). When a product or part is exchanged, any replacement item becomes your property and the replaced item becomes Viotek’s property. Important: Do not disassemble the Product. Disassembling the Product will void this warranty. Only Viotek or a party expressly authorized by Viotek should perform service on this Product.

This warranty only covers technical hardware defectiveness during the warranty period and under normal use conditions. Viotek does not warrant uninterrupted or error-free operation of this Product. This Warranty does not apply to damages or circumstances, such as, but not limited to:

- (a) Damage that is caused by conditions, malfunctions, or damage not resulting in from defects in material or workmanship. These conditions include, but are not limited to, accidents, and improper operation or maintenance;
- (b) Product has been tampered with, repaired and/or modified by non-authorized personnel;
- (c) Obsolescence;
- (d) Damage (accidental or other) to the Product that is cosmetic, meaning damage that does not impact the operation and functioning of the Product, such as without limitation to rust, change in color, texture or finish, wear and tear, scrapes, scratches, dents, cracks, or gradual deterioration;
- (e) Damage to the Product caused by war, terrorism, fire, accident, natural disaster, intentional or accidental misuse,

1.The fan unit is having abnormal noise.

- Use the Fan Case in order to reduce the noise when the fan is in use.
- When using level 5 for cooling, the unit will produce the most amount of noise. After 5 minutes or when your body has begun to cool, try adjusting cooling from level 5 to level 3 to continue cooling but reduce noise.

2.The Temperature Control Unit does not function.

- Check if the *DC Power Inlet* is properly connected to the cushion.
- Check if the *DC Power Inlet* is properly inserted into the cigarette lighter receptacle.
- If these present no issue, the remote may need to be recharged.

3.The Seat Cushion moves and/or shifts.

- Check if the Fan is positioned in the center of the seat.
- Check if the Stoppers have been pushed fully between the seat gap and are secure.
- Check if both the Securing Band behind the seat and the Buckle behind the headrest are fully secure.

4.The Seat Cushion does not cool.

- Make sure the blue Level indicator lights up.
- Check all cord and cigarette lighter connections.
- Charge the remote and try again.

5.The Seat Cushion does not heat (if applicable).

- Make sure your unit has the  (heat) button.
- Check all cord and cigarette lighter connections.
- Make sure the Level Indicator light(s) are on and red.

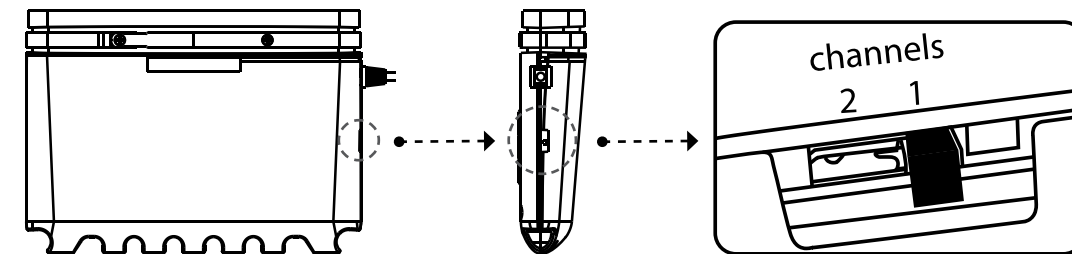

1. Power off and unplug the system if needed. If using for the first time, the unit may automatically be set to channel one. To change the channel, locate the slider switch on the side of the fan. Next, slide the switch towards the opposite side to change to the next channel, you may hear or feel a click.

NOTE: Each channel corresponds to a number. The unit has two channels total. It is recommended to use 1 for the driver's seat and 2 for the passenger seat, etc.

2. After switching to the desired channel, insert the *DC Power Inlet* into your vehicle's cigarette lighter receptacle.
3. To select the channel on the remote, press the chair selector to change channels. The *Selected Chair Indicator* will light up. Continue to press the *Chair Selector* as needed to select the correct channel.

How to Use the Remote

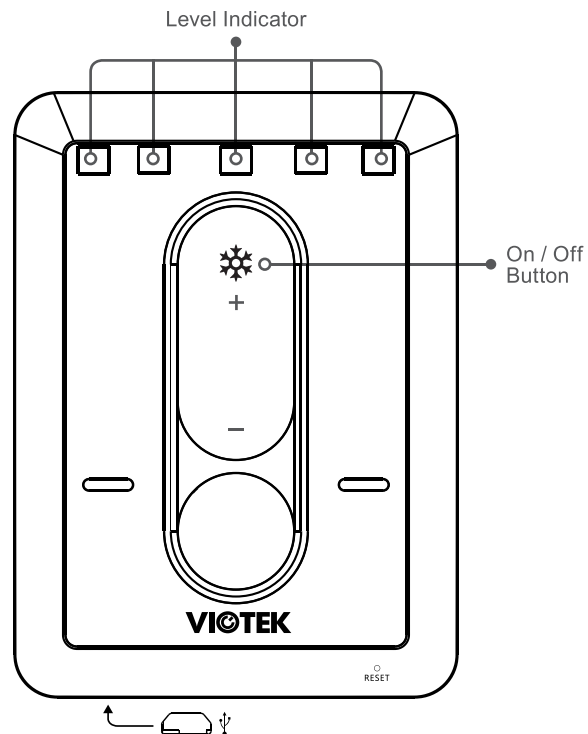

Cooling Only Unit Remote Control

- Press to turn on the cooling function. Blue light indicates that it is on.
- The unit defaults to level 3.
- There are a total of 5 levels. Level 5 is at its coolest.
- Press (+) to increase cooling or (–) to decrease cooling.
- Press again until you reach the desired level.
- To turn the unit off, briefly hold . The blue light will turn off to indicate it is off.

WARNING: Do not operate the remote while driving.

NOTE: The ViOTEK logo will flash to indicate low battery power. To recharge the battery, use a Micro USB charger* and charge for approximately 40 minutes. The logo will stop flashing and remain on to indicate the battery is recharged. Disconnect from the charger; the logo will dim automatically when the remote is not in use.

*Micro USB charger not included

How to Use the Remote

Heating and Cooling Unit Remote Control

- Press (cool & +) or (heat & -) to select the desired function.
- The unit defaults to level 3.
- If the heating function was selected, press (+) to increase heating or (–) to decrease heating. Press again until you reach the desired level.
- If the cooling function was selected, press (+) to increase cooling or (–) to decrease cooling. Press again until you reach the desired level.
- To turn the heating function off, briefly hold . The red light will turn off to indicate it is off.
- To turn the cooling function off, briefly hold . The blue light will turn off to indicate it is off.

WARNING: Do not operate the remote while driving.

NOTE: : The ViOTEK logo will flash to indicate low battery power. To recharge the battery, use a Micro USB* charger and charge for approximately 40 minutes. The logo will stop flashing and remain on to indicate the battery is recharged. Disconnect from the charger; the logo will dim automatically when the remote is not in use.

NOTE: Only one function can be operated at any given time; heating or cooling. Turn the current function off before switching to the other.

*Micro USB charger not included

