

Homido - BTGP-2

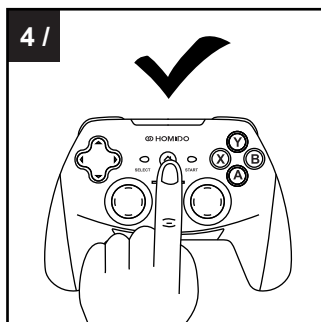
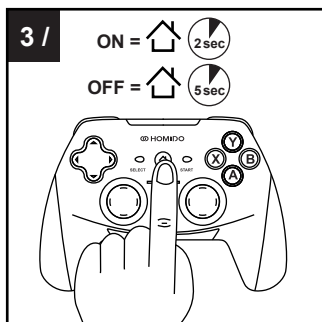
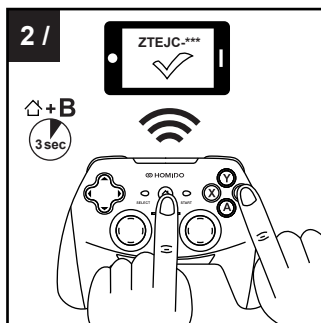
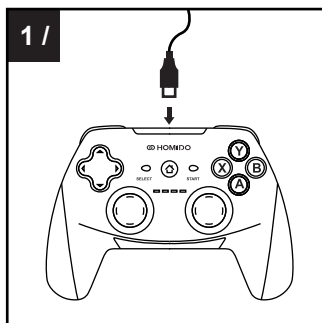

Product introduction:

Homido Gamepad is a Bluetooth (2.1+EDR) connected Game controller for use with Android devices (4.0 version or above).

Disclaimer:

The Gamepad works only with dedicated games.

To find compatible games please use the Homido Center App, & select Category : Gamepad.

The button mapping may differ depending on the game. Please check settings or help section in each game.

Product Specifications:

Size :	150 x 100 x 63 mm
Wireless :	Bluetooth 2.1+EDR
Wireless distance :	2 – 10 m
Compatibility :	Android smartphones
Battery :	Li-battery 3.7V 600mAh
Battery life :	10 hours

1 / Charging

To charge the device, plug in the supplied USB cable and connect to the Gamepad, Whilst the Gamepad is charging a LED will flash on the unit, When the Gamepad is fully charged the LED will stop flashing.

When the Gamepad needs charged the LED will start to flash as soon as there is a drop in the Gamepad's performance. Please charge the Gamepad when this happens.

2 / Pairing with Android device:

1- On your smartphone: Go to Bluetooth setting and turn on Bluetooth (Please consult the manual that accompanied your device for further information.)

2- On the Gamepad: Press and hold the B button and then press the Home button at the same time until the LED blinks (hold approx. 3 secs).

3- On your smartphone: Confirm the connection by going to the Bluetooth control panel, identify the Gamepad (named as ZTEJC-***), and confirm pairing. If prompted, enter the code 0000.

4- Once the Gamepad is Paired with the Smartphone the LED light will stay ON on the Gamepad.

3 / Power ON/OFF

Power On: Press Home button for 2 seconds.

Power Off: Long press Home button for 5 seconds.

The Gamepad has a Sleep function to conserve battery power. The Gamepad enters sleep mode after 1 minute of disconnection, or after 5 minutes without action.

4 / Gamepad Reconnection

Once pairing has been setup to work with your device it is simply to reconnect the Gamepad. Turn on the Gamepad by Pressing home for 2 seconds. The Gamepad will connect automatically. (Make sure Bluetooth is ON on your smartphone before trying to connect the Gamepad)

Troubleshooting:

- Cannot turn on the Gamepad : the Gamepad may have a low battery, please use USB cable to recharge.
- Cannot find the Gamepad on the smartphone Bluetooth control panel : on your smartphone, press "search for new device" if it doesn't start automatically.
- Cannot connect Gamepad:
 1. Turn off the Bluetooth connection on your smartphone. If the Gamepad was paired previously : delete paired Gamepad first.
 2. Press the reset button on the Gamepad (use a needle to press the button in the small hole at the back of the Gamepad).
 3. Please repeat the pairing process by Press and hold the B button and then press the Home button at the same time until the led blinks (approx. 3 secs).
 4. Confirm the connection on your smartphone : go to the Bluetooth control panel, identify the Gamepad (named as ZTEJC-***), and confirm pairing. If prompted, enter the code 0000.
- If problems persist, please contact Homido at www.homido.com or contact your point of purchase

Attention:

1. Do not disassemble, refit or repair on your own. All warranties are null and void if the unit is tampered with by a non authorized Homido agent.
2. Do not keep store or use in humid, high temperature (exceeding 60°C) or dusty environment as this may effect the performance or lifespan of the Gamepad.
3. Avoid contact with water or other liquids, it may affect the performance of the Gamepad.
4. Keep away from fire, the Gamepad has a built-in Lithium Polymer battery which has a risk if exploding if exposed to fire or extreme heat.
5. Charging voltage is USB 3.7-5.5V DC supply (normal smartphone charging power can be used)
6. Children should be under adult's supervision to use this product.
7. Please send a mail at service@homido.com if you have any quality problem or suggestions.

Intended use

This product is only intended as an input device for connecting to a computer, smartphone or tablet pc. Homido accepts no liability whatsoever for any damage to this product or injuries caused due to careless, improper or incorrect use of the product or use of the product for purposes not recommended by the manufacturer.

Battery safety

This product is fitted with a lithium polymer battery. Do not damage, open or dismantle the battery and do not use it in damp and/or corrosive conditions. Only use compatible chargers. Do not expose the product to temperatures exceeding 60°C (140°F). The crossed-out wheelie bin symbol means that you must not dispose of this product and its battery together with general household waste; instead, take it to a recycling point for electrical and electronic equipment and batteries. For information about local recycling points, contact your local authority, civic amenity site or the business where you purchased this product or compatible batteries. The separate collection and recycling of used items of electrical and electronic equipment and batteries prevents any harmful substances they contain from harming human health and polluting the environment.

Declaration of conformity

Homido hereby declares that this product conforms to the relevant safety regulations of EU Directives 1999/5/EC, and 2011/65/EU. The full Declaration of Conformity can be requested via our website at www.homido.com

Conformity notice

Operation of the device may be affected by strong static, electrical or high-frequency fields (radio installations, mobile telephones, microwaves, electrostatic discharges). If this occurs, try increasing the distance from the devices causing the interference.

Technical support

Having technical problems with this product? Get in touch with our Support team – the quickest way is via our website: www.homido.com

Model Number: BTGP-2
FCC ID: 2AH4A-BTGP-2

This device complies with part 15 of the FCC Rules. Operation is subject to the condition that this device does not cause harmful interference (1) this device may not cause harmful interference, and (2) this device must accept any interference received, including interference that may cause undesired operation.
Changes or modifications not expressly approved by the party responsible for compliance

could void the user's authority to operate the equipment.

NOTE: This equipment has been tested and found to comply with the limits for a Class B digital device, pursuant to Part 15 of the FCC Rules. These limits are designed to provide reasonable protection against harmful interference in a residential installation. This equipment generates, uses and can radiate radio frequency energy and, if not installed and used in accordance with the instructions, may cause harmful interference to radio communications. However, there is no guarantee that interference will not occur in a particular installation. If this equipment does cause harmful interference to radio or television reception, which can be determined by turning the equipment off and on, the user is encouraged to try to correct the interference by one or more of the following measures:

- Reorient or relocate the receiving antenna.
- Increase the separation between the equipment and receiver.
- Connect the equipment into an outlet on a circuit different from that to which the receiver is connected.
- Consult the dealer or an experienced radio/TV technician for help.

The device has been evaluated to meet general RF exposure requirement. The device can be used in portable exposure condition without restriction.