

User Manual

BS-65

Graphic illustration

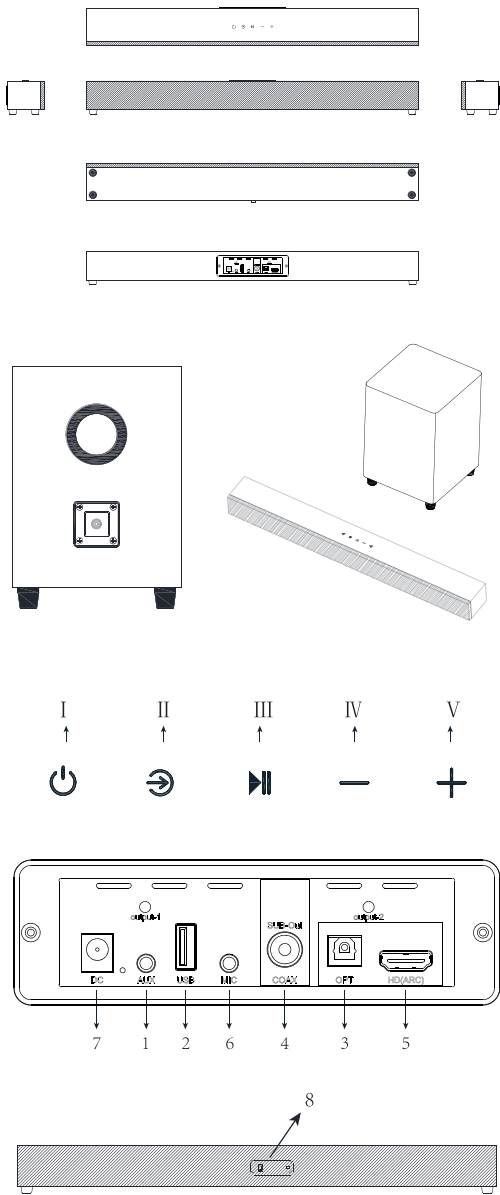

I	Power on/off	Turn on or off the soundbar
II	Mode Selector	Switch audio input mode
III	Play/Pause	Play or stop the music
IV	Volume down	Hold down to turn down the volume/ Briefly press to previous song
V	Volume up	Hold down to turn up the volume/ Briefly press to following song
1	Aux socket	3.5mm audio input
2	USB socket	USB drive audio input, support 32G maximum
3	Optical socket	Optical audio input
4	Subwoofer socket	Subwoofer output
5	ARC socket	ARC audio input
6	Microphone socket	Microphone input
7	Power socket	DC 15V 4.5A
8	Infrared port	Remote controller infrared port

Remote Control Schematic

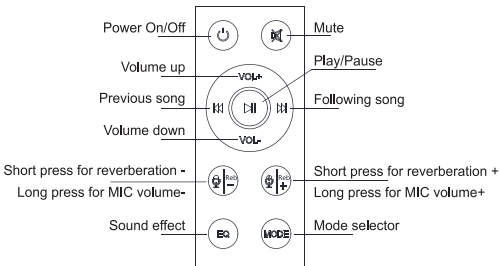

Remote Control Precautions:

- In Aux/ARC/Optical mode, the remote control cannot switch between songs, and the EQ effects does not work.
 - Power on/off button on remote control only perform soft-on function. Press once the speaker enter soft-start. Press again enter soft-start. Buttons on speaker has no function in soft-off mode, except long press the power on/off button.
 - Button battery for remote control, Model: CR2032.
 - Remote effective distance: 5 meters /30°
 - Switch 3 EQ sound effects by using the EQ button:
①music mode;②news mode; ③cinema mode.
 - The remote control can only be used when the speaker is turned on. It only match our corresponding soundbar products.
 - Please take out the insulation sheet on the back of the remote control for the initial use.
- Note: There is no EQ sound effect in AUX, optical and ARC modes.

Power Input

- Power input voltage 15V/4.5A.
- Connect DC power plug to the soundbar power socket.
- The connect the power plug to AC 110V-240V.

Subwoofer connection

Insert one end of the coaxial cable into the coaxial interface of the subwoofer, and then insert the other end into the coaxial socket of the soundbar. Ensure that the soundbar is properly connected to the subwoofer.

Wireless Mode

- You will hear the prompt tone with the blue indicator light flashing Wireless searching mode starts automatically after power on.
- Switch on wireless searching mode on the cellphone. After pairing successfully the device name (BS-65) will be shown connected on the cellphone, then you can open phone player and play songs. Due to different brands of mobile phone and wireless versions the searching and pairing time will be various. Under normal circumstances it only takes 30 seconds. If the pairing password is needed please type "0000" on the cellphone.
- Hold down +/- button to volume up or down.
- Briefly press +/- button to switch between songs.
- Briefly press **▶** button to play or pause the music.

AUX Mode

- Use a 3.5mm Aux cable to connect your cellphone/MP3/PC and insert the cable to the AUX socket on the soundbar.
 - Soundbar will automatically switch to AUX mode. If it is in a different mode press mode selector **↻** to switch to AUX mode.
 - Hold down +/- button to volume up or down.
 - Briefly press **▶** button to play or mute the music.
- Attention: In AUX mode the soundbar cannot switch between songs.

Optical Mode

- Use an optical plug to connect your digital TV or DVD player and connect the cable to the optical socket on the soundbar.
 - Turn on the TV and enter sound settings then convert TV audio output to OPT output.
 - When the soundbar is power on you will hear the prompt tone with blue LED light on, press mode selector **↻** to switch to optical mode.
 - Hold down +/- button to volume up or down.
 - Briefly press **▶** button to play or mute the music.
- Attention: In optical mode the soundbar cannot switch between songs.

USB Mode

- Plug the USB drive into the USB socket.
- Soundbar will automatically switch into USB mode after power on. If it is in a different mode press mode selector **↻** to switch to USB mode.
- Hold down +/- button to volume up or down.
- Briefly press +/- button to switch between songs.
- Briefly press **▶** button to play or pause the music.

ARC Mode

- Use a ARC plug to connect your digital TV or DVD player and connect the cable to the ARC socket on the soundbar.
 - Turn on the TV and enter sound settings, then convert TV audio output to ARC output.
 - When the soundbar is power on you will hear the prompt tone with blue LED light on, press mode selector **↻** to switch to ARC mode.
 - Hold down + or - button to volume up or down.
 - Briefly press **▶** button to play or mute the music.
- Attention:
In ARC mode, the soundbar cannot switch between songs. Make sure the TV has a ARC audio output.
Due to different TV ARC audio output decoding, the soundbar may not be able to support some ARC audio.

Microphone mode:

- You can use the microphone in any mode. Just insert the wireless microphone receiver into the microphone jack and turn on the receiver and microphone switch then you can perform karaoke.
 - If the microphone is silent please check whether the battery of the microphone receiver and mic is insufficient and then charge them in time.
 - Hold down the **▶** about 2 seconds to enter the singing accompaniment karaoke. Press the **▶** for about 2 seconds again to resume the original singing.
- Attention: In AUX /3.5mm mode the soundbar cannot support vocal accompaniment.

Soundbar Connection Instruction

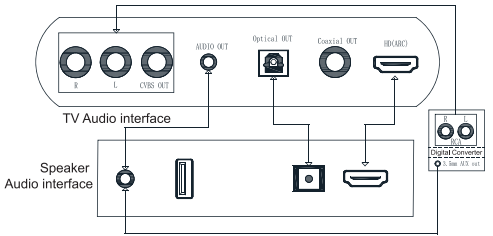

- Turn on the TV.
(Not limited to TV, such as game consoles, projectors, PC, etc)
- Use the data cable which provided to connect the soundbar and television. Ensure that the audio port of the TV is on the audio out output port.
- Ensure that the audio output selected in TV as same as the soundbar audio output.
- Set the digital audio output format of the TV to PCM or automatic.

Common problems and solving method

- If the soundbar cannot be turned on, please check if the power is connected correctly.
- When the soundbar cannot be controlled during use please unplug the power and restart the soundbar.
- Cannot establish a connection even after multiple attempts?
(1) Check whether the soundbar is in Wireless search mode.
(2) If there are too many Wireless receivers in the vicinity, this can hamper the search process. Please turn off other Wireless receivers.
(3) Open the Wireless settings on your phone, disconnect then try again to establish a connection.
- The volume of soundbar is too low or there are distortion?
Please check the volume settings of your phone and adjust the volume.
- Is the signal being dropped when playing music?
Please check whether the distance exceeds the effective range or whether there are any physical barriers between your phone and the soundbar.
- The buttons appear to have no effect on the soundbar?
Please try to use the player on phone or other players.

Attention:

- If connected to tablet, please refer to the connection method for phones.
- Laptop connection: since there are many Wireless versions for laptops, the connection method can vary. If you cannot establish a connection on the first attempt or if you can not get the music to play, please download the very latest Wireless driver.

The power delivered by the charger must be between mir [5] Watts required by the radio equipment, and max[10] Watts in order to achieve the maximum charging speed.

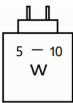

FCC Statement:



Changes or modifications not expressly approved by the party responsible for compliance could void the user's authority to operate the equipment.
This equipment has been tested and found to comply with the limits for a Class B digital device,pursuant to Part 15 of the FCC Rules. These limits are designed to provide reasonable protection against harmful interference in a residential installation. This equipment generates uses and can radiate radio frequency energy and, if not installed and used in accordance with the instructions, may cause harmful interference to radio communications. However, there is no guarantee that interference will not occur in a particular installation. If this equipment does cause harmful interference to radio or television reception, which can be determined by turning the equipment off and on, the user is encouraged to try to correct the interference by one or more of the following measures:
— Reorient or relocate the receiving antenna.
— Increase the separation between the equipment and receiver.
— Connect the equipment into an outlet on a circuit different from that to which the receiver is connected.
— Consult the dealer or an experienced radio/TV technician for help.
This device complies with part 15 of the FCC rules. Operation is subject to the following two conditions (1)this device may not cause harmful interference, and (2) this device must accept any interference received, including interference that may cause undesired operation.

This equipment complies with FCC radiation exposure limits set forth for an uncontrolled environment. This equipment should be installed and operated with minimum distance 20cm between the radiator & your body.