

# **User Manual**

Applicable models:

VB20, Vigor, Vigor U, Vigor X

VB SERIES, Gio, Bro, Eggo

## **INDEX**

<b>Description of hearing aid.....</b>	<b>- 1 -</b>
<b>ON/OFF function .....</b>	<b>- 4 -</b>
<b>Inserting/Replacing the battery... -</b>	<b>6 -</b>
<b>Attach dome (OF) .....</b>	<b>- 8 -</b>
<b>Attach tubing (OF) .....</b>	<b>- 9 -</b>
<b>Inserting/Removing hearing aids-</b>	<b>13 -</b>
<b>Operation of hearing aid .....</b>	<b>- 15 -</b>
<b>Switch control .....</b>	<b>- 15 -</b>

<b>Pairing hearing aids with Android/iOS device .....</b>	<b>- 19 -</b>
<b>FCC Statement .....</b>	<b>- 21 -</b>

## Description of hearing aid

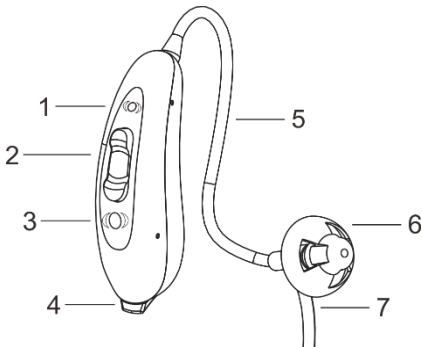

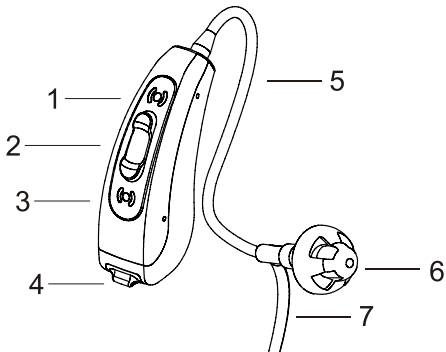

1. Front microphone input
2. Switch control
3. Rear microphone input (optional)
4. Battery door
5. Sound tube
6. Dome
7. Retention

## **ON/OFF function**

1. When the battery door is closed, the hearing aids on, and the default program will be activated.
2. To turn off the hearing aids, partly open the battery door.

Tip: Whenever the hearing aids are not in use, remember to turn them off to avoid unnecessary battery consumption.

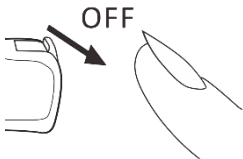
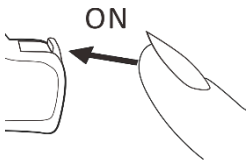



## **Inserting/Replacing the battery**

1. Open the battery door completely by using your fingernail.
2. Remove the used battery if present. Insert the new battery with the positive side in the correct position. The battery door has a '+' indicator to help determine the correct insertion.
3. Gently close the battery door.

Tip: When the hearing aids are not in use for an extended period of time, removing the batteries may help prevent corrosion of the battery compartment, and ensure that battery life is not shortened.

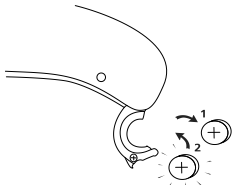

## **Attach dome (OF)**

Push the dome over the flanges on the thin tube. Make sure that the new dome is properly and securely mounted.

Gently press and twist the tube into connector base until the tube is fixed firmly.

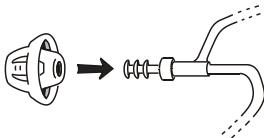

## **Attach tubing (OF)**

Push the tube into connector base of device, insert into the recessed jack and rotate clockwise about 3.5 turns until the tube is fixed firmly .

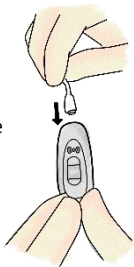

## Attach\remove tubing and dome (RITE)

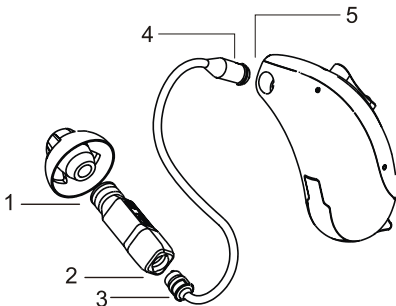

1. receiver flange
2. receiver jack
3. receiver tube plug
4. receiver tube
5. connector base

1. Make sure the receiver tube plug is entirely sheathed in the black receiver and insert into

a recessed jack.

2. Push the dome over the flanges on the black receiver. Make sure that the new dome is properly and securely mounted.

3. Gently press the receiver tube into connector base of device, insert into a recessed jack follow the red arrow until the tube is fixed firmly.

4. Pull tubing off straightly.

## **Inserting/Removing hearing aids**

### **Insertion**

1. Hold the thin tube where it bends, and gently push the dome into the ear canal. Push the dome far enough into the ear canal so that the thin tube lies flush with the head.
2. It is important that the tube and the dome fit correctly into your ear.



3. When the dome is placed correctly, you should not be able to see the thin tube sticking out when facing a mirror.

## Removal

1. Hold the thin tube with your thumb and forefinger and pull the tube outward.
2. Consult hearing care professional if you have difficulties removing the hearing aids.

## Operation of hearing aid

### Switch control

Volume control function: To increase volume press then release the top part of the switch. To decrease the volume, press then release the bottom part of the switch.

Memory switch  
function:

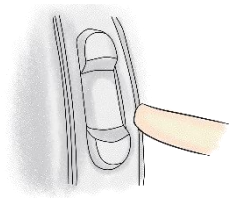

Speech mode is the default programme. To switch to next programme, holding the top part of the switch for three seconds. The programmes will be circulated from P1, P2, P3 to P4.

Holding the down part of the switch for three seconds. The programmes will be circulated from P1, P4, P3 to P2.

You will hear one or more beeps.

The number of beeps indicates which programme you have selected (one beep = programme one, two beeps = programme two, etc.).

When the hearing aid is turned off and then back on, the hearing aid always returns to the default setting (P1). Selected model will return to the program used last time.

Top part of switch	Down part of switch
P1:Speech mode	P1:Speech mode
P2:Restaurant Noise	P4:Outdoor Noise
P3:Road Noise	P3:Road Noise
P4:Outdoor Noise	P2:Restaurant Noise
P1:Speech mode	P1:Speech mode

For the selected model, P4 is Telecoil mode.

## **Pairing hearing aids with Android/iOS device**

Only available for selected models.

Hearing aids will stay in Bluetooth pairing mode while they are turn on.

Ensure Bluetooth is enabled on iOS or Android device. Open **ControlHA** app and tap **Bluetooth HA** to allow APP connecting with your hearing aids. App will show the hearing

aid connection status synchronous with the ***tick icon*** in the top right corner.

Tap ***Bluetooth HA*** again to enter into ***Setting***.  
Select ***Left*** or ***Right*** and then tap ***Save*** to finish the pairing process.

Hearing aids pairing will be done by App automatically after your first time pairing process.

## **FCC Statement**

The device has been evaluated to meet general RF exposure requirement, The device can be used in portable exposure condition without restriction Federal Communication Commission (FCC) Radiation Exposure Statement Power is so low that no RF exposure calculation is needed.

This device complies with part 15 of the FCC rules. Operation is subject to the following two conditions: (1) this device may not cause



harmful interference, and (2) this device must accept any interference received, including interference that may cause undesired operation.

NOTE: The manufacturer is not responsible for any radio or TV interference caused by unauthorized modifications or changes to this equipment. Such modifications or changes could void the user's authority to operate the equipment.

NOTE: This equipment has been tested and found to comply with the limits for a Class B digital device, pursuant to part 15 of the FCC Rules. These limits are designed to provide reasonable protection against harmful interference in a residential installation. This equipment generates uses and can radiate radio frequency energy and, if not installed and used in accordance with the instructions, may cause harmful interference to radio communications. However, there is no guarantee that interference will not occur in

a particular installation. If this equipment does cause harmful interference to radio or television reception, which can be determined by turning the equipment off and on, the user is encouraged to try to correct the interference by one or more of the following measures:

- Reorient or relocate the receiving antenna.
- Increase the separation between the equipment and receiver.

- Connect the equipment into an outlet on a circuit different from that to which the receiver is connected.
- Consult the dealer or an experienced radio/TV technician for help.

FCC ID: 2AGPFVB20