

USER MANUAL

(M/N : RMW-001)

DNX Co.,Ltd.

Installation



Download RANG from Google store or Apple store and install it on your phone.

Connection



RANG uses Bluetooth and GPS to connect to the device. So please check if both of them are turned on. Look at the back side for the button indication (up, down, left, and right). 12 o'clock means up, 6 o'clock means down, 9 o'clock means left, and 3 o'clock means right.

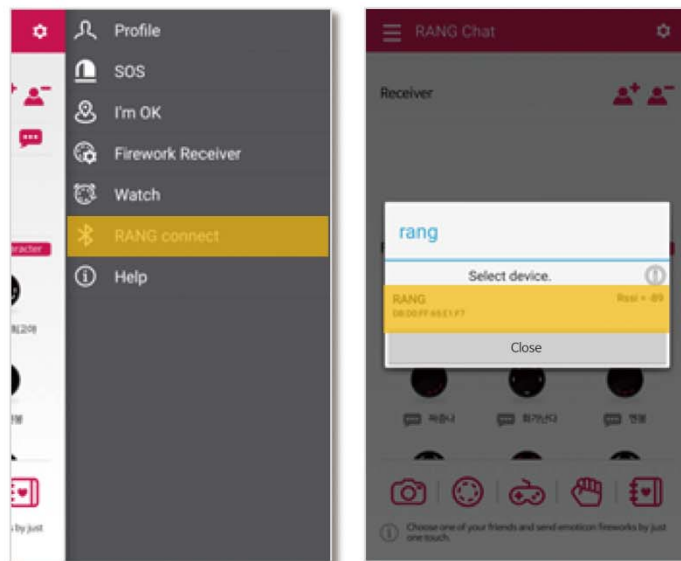

Press "RANG Connect" and there should be "select device" popped up notice and choose RANG. When the connection is successful, you can see the time on your RANG device.



11 : 15

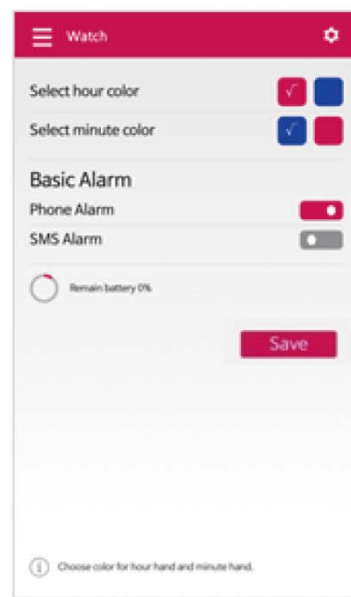

The hour hand light stays still and the minute hand blinks. The blinking turns off after 10 seconds and switches to sleeping mode. You can press any of four buttons (up, down, left and right) to turn it on. Also you can select the color of the hour and the minute in "watch in settings".

Settings & Usage

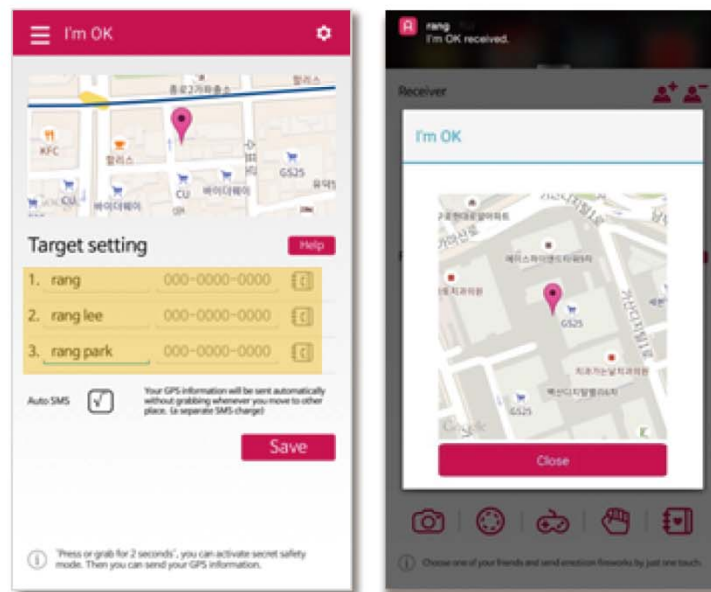

1. I'm OK

- Go to "I'm OK under settings", you can fill in up to three people that you want to inform the location. You can get their phone numbers from the address book. Hold on to RANG or use right hand to press RANG for two seconds. So you can let them know where you are.
- Please install RANG application on your opponent's phone and there should be a popped up notice.

2. SOS

- Go to "SOS under settings", you can fill in up to three people to inform the location and to call automatically. Hold on to RANG or press RANG with your right hand for five seconds to notify them. (calls only in android)
- Please install RANG application on your opponent's phone and there should be a popped up notice and a call.



3. Fireworks

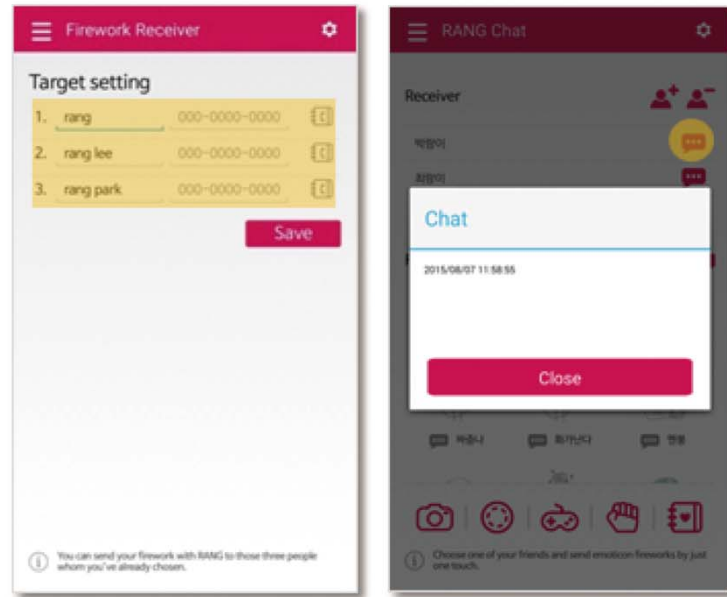

- Go to “Fireworks Receiver under settings”, you can fill it up to three people that you want to send the emoticons. For emoticons, you can select by using left or right button. Then press the button for two seconds and it will be sent.
- If opponent is a RANG user, the same emotion appears on his/her RANG. You can go and check from “RANG chat” for the history.

4. Alarm

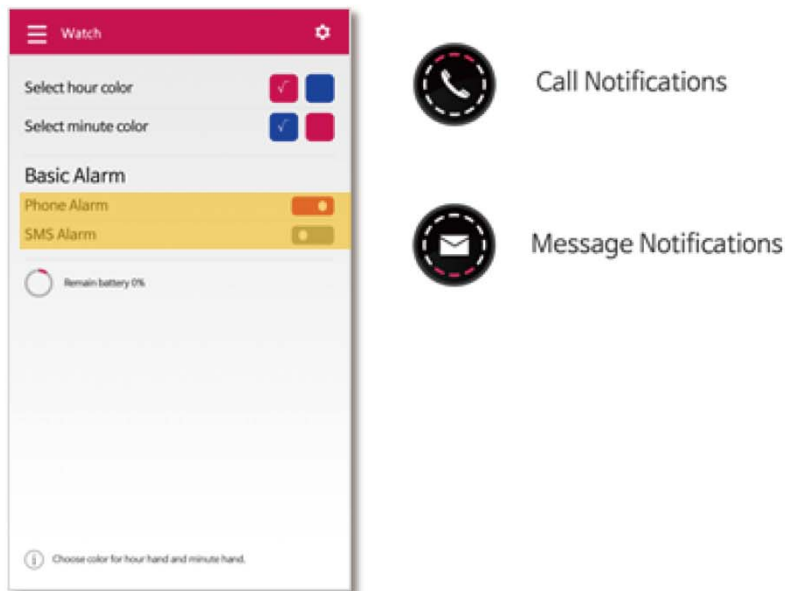

- Go to “watch under settings”, you can change the color of the minute hand and the hour hand. If you want messages and phone notifications through RANG, turn on the alarm.
- When there are phone calls, the light blinks at 12 o’clock. When there are messages, the light blinks at 6 o’clock. This shows only once. (only in android)



5-1. Finding my Phone

Press any button to light the watch. Then press down button for two seconds, and the music starts to play. (It works in silent mode) Then press any buttons to turn off the music. (only in android)



5-2. Recording

Press any button to light the watch. Then press up button for two seconds. Check your phone to see if it's recording. Then press any button to end recording and find a recording file from the phone. (only in android)

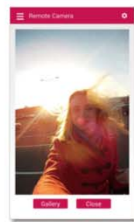

5-3. Selfie

Run 'Remote camera' on your phone and press any button to take a selfie. Then confirm a picture in the gallery.



5-4. Changing a ringtone to vibration

Changing a ringtone to vibration When the phone rings, you can press any button to change it a ringtone to vibration and visa versa. (only in android)

* Due to iOS security policy, there are some restrictions in iOS phone.

FCC Information to User

This equipment has been tested and found to comply with the limits for a Class B digital device, pursuant to Part 15 of the FCC Rules. These limits are designed to provide reasonable protection against harmful interference in a residential installation. This equipment generates, uses and can radiate radio frequency energy and, if not installed and used in accordance with the instructions, may cause harmful interference to radio communications. However, there is no guarantee that interference will not occur in a particular installation. If this equipment does cause harmful interference to radio or television reception, which can be determined by turning the equipment off and on, the user is encouraged to try to correct the interference by one of the following measures:

- Reorient or relocate the receiving antenna.
- Increase the separation between the equipment and receiver.
- Connect the equipment into an outlet on a circuit different from that to which the receiver is connected.
- Consult the dealer or an experienced radio/TV technician for help.

Caution

Modifications not expressly approved by the party responsible for compliance could void the user's authority to operate the equipment.

FCC Compliance Information : This device complies with Part 15 of the FCC Rules. Operation is subject to the following two conditions: (1) This device may not cause harmful interference, and (2) this device must accept any interference received, including interference that may cause undesired operation

Hereby, DNX Co.,Ltd. declares that this **RMW-001** is in compliance with the essential requirements and other relevant provisions of directive 1999/5/EC.

C E2200