

MECOOL®

## WIRELESS GAMEPAD WITH RGB LIGHTING

### Specifications

#### User Manual( GM1 )

1. Direct play without any platform or complicated activation to connect.
2. Support Android, IOS phones / Tablet, PC, N-S, PS3, PS4.
3. Adopt high-precision Hall sticks and Hall trigger, say goodbye to drift, more precise control.
4. Ergonomically designed structure, comfortable grip.
5. Dazzling RGB light.
6. Supports button programming, adjustable trigger tension, dual motor vibration and TURBO function.
7. Support some cloud gaming platforms.

\* Due to the official game platform software upgrade or source code changes and other not resist factors cause of some games can not be played or connected with our gamepad. Our company has no responsibility, we reserves the right of final interpretation for this.

### Instruction button function:

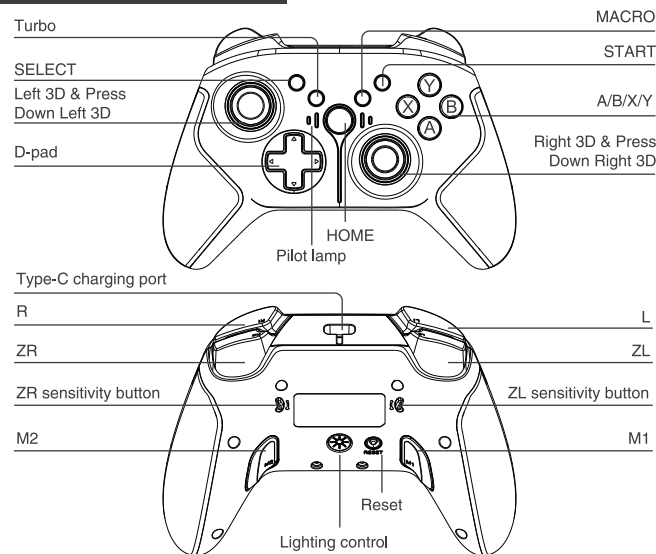

### Electrical parameters:

1. Working current: 30mA(RGB Light off), 120mA(RGB Light on)
2. Static current: <10uA
3. Charging current: 260mA
4. Charging hours: 2.5 hours
5. Battery endurance: 10 hours
6. Battery capacity: 1850mWh/3.7V
7. Vibration: Yes
8. Support platform: Android / IOS phones / Tablet / PC / N-S / P3 / P4

### Direct Play Mode (Android V3)

Press and hold A+ HOME buttons for 2 seconds to enter Direct Play Mode (Android V3). At this time, the LED1 indicator will flashes quickly, then search "GM1" on Android phone / tablet BT and pair, LED1 indicator will be always on after connected successfully! If you connected before, press the HOME button directly, LED1 indicator will flash slowly, automatically reconnect!

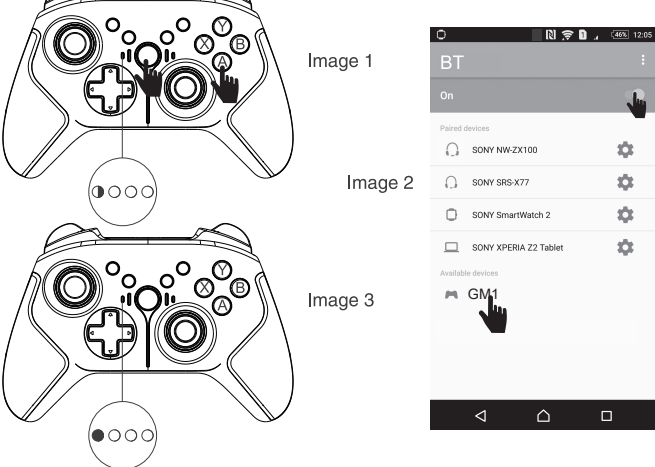

### Mapping game buttons for direct play mode Android :

Follow the official account ("ShootingPlus") to check the default operation instructions. If you need to reset the game buttons, please download and install "ShootingPlus V3" APP from Google Play Store, remap the game buttons in the APP and adjust the button position.



ShootingPlus V3

### Android Standard mode

Press and hold X + HOME buttons for 2 seconds to enter Android Standard mode. At this time, the LED3 indicator will flashes quickly, then search "GM1" and pair it , LED3 indicator will be always on and the controller will be vibrated 1 second after connected successfully. Press HOME button to reconnect, while the LED3 indicator flash slowly, it connected.

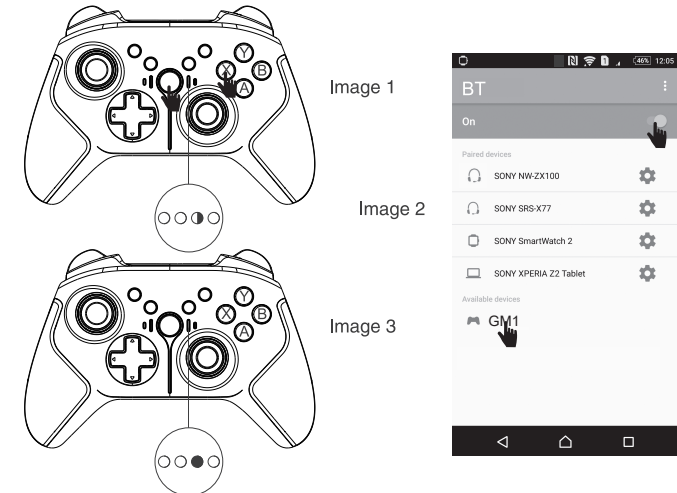

### IOS mode (13.0 or above)

Press and hold B + HOME buttons for 2 seconds to enter IOS mode. At this time, the LED4 indicator will flashes quickly, then search " DUALSHOC 4 Wireless Controller " and pair it , LED4 indicator will be always on and the controller will be vibrated 1 second after connected successfully. Press HOME button to reconnect, while the LED4 indicator flash slowly, it connected.

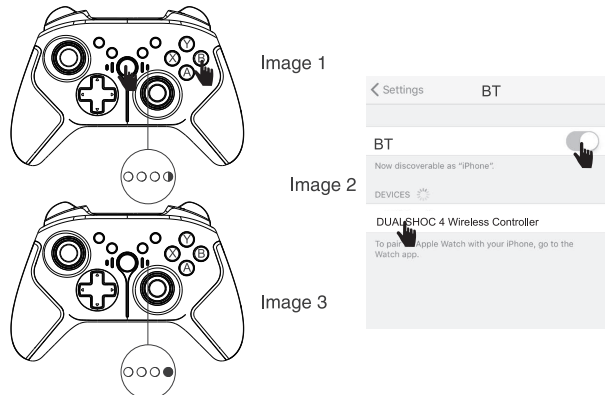

### PC wired mode

1. Connect the USB data cable of the controller to your PC device. The LED1, LED2, LED3, and LED4 indicator on the controller will flash rapidly simultaneously. Once the connection is successful, the controller will be in Xinput wired mode, indicated by the LED1 indicator staying on continuously.
2. To switch to D-input mode, press and hold the home button on the controller for 3 seconds. The LED2 indicator on the controller will remain on constantly to indicate D-input mode.
3. In either mode, press and hold the home button for 3 seconds to freely switch between the two modes. The default mode is Xinput.

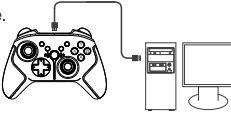

### PC wireless mode

Press and hold R + HOME buttons for 2 seconds to enter PC wireless mode. At this time, the LED1, 2, 3 indicator will flashes quickly, then search " Xbox Wireless Controller " and pair it , LED1, 2, 3 indicator will be always on and the controller will be vibrated 1 second after connected successfully.

### Streaming cloud game platform operation:

Press the B+HOME button to pair and connect with the phone, support P5/P4 streaming cloud game platform. Press the R1+HOME button to pair and connect with the phone, support the XBOX streaming cloud gaming platform.

### P3 / P4 mode

1. Connect the controller to the P3/P4 console using a Type-C USB data cable. Press the HOME button to initiate the pairing process. Once the pairing is successful, the LED4 indicator will remain on continuously. The controller is now ready for wireless connection and to be used.
2. If the controller has been previously connected successfully, you can simply press the HOME button, and after the indicator light flashes, the LED4 light will remain on continuously, indicating a successful reconnection.
3. In P4 mode, press down L3+MACRO to enter touchpad mode. Use R3 to control the simulated touchpad. Press down L3+MACRO again to exit touchpad mode.

### N-S wireless mode

1. Turn on the N-S console and navigate to the main menu. Using your finger, touch and select "Controllers"and then "Change Grip/Order"on the console. On the controller, scroll down the ZR sensitivity button to the lowest position, press and hold the "ZR+HOME"buttons for 2 seconds to turn on the controller and enter pairing mode. The LED2 and LED3 on the controller will flash quickly. When a single LED remainslit, it indicates a successful pairing with the console. Press the A button to confirm.
2. If the controller has been previously paired and connected successfully to the N-S console, and the controller is in power-off mode while the console is in power-on mode, a short pressof the HOME button on the controller will initiate reconnection. The LED2 and LED3 indicator will flash slowly. Once the reconnection is successful, the LED indicator will remain steadily lit, indicating a successful reconnection.

ZR sensitivity button

Scroll down to adjust the ZR sensitivity

ZR button

Home button

### Operations mode

	Android Wireless mode		IOS Wireless Mode	N-S Wireless Mode
	Android V3	Android Standard mode	IOS MFI mode	N-S Wireless mode
Pair Mode(Press for 2 seconds)	A+Home	X+Home	B+HOME	ZR+Home
Indicator	LED 1	LED 3	LED 4	Auto match LED always on
Note	Not Support vibration		IOS 13.0 or above	Support vibration
	P3/P4 Wireless mode		PC mode	
	P3 Wireless mode	P4 Wireless mode	PC wired mode	PC Wireless mode
Pair Mode	Connect console with a USB data cable, then press HOME		Connect PC with a USB data cable	R+Home
Indicator	LED 4		PC P3 mode: LED2 PC 360 mode: LED1	LED 1、LED 2、LED 3
Note	Support vibration			

### Turbo Function Setting

Action keys ( A / B / X / Y / L / ZL / R / ZR ) also support the turbo function

1. Press and hold Turbo + tap once Action keys to turn on the burst function.
2. Press and hold Turbo + tap once Action keys to set the Auto burst function.
3. Press and hold Turbo + tap once Action keys to clear the turbo function.

### RGB Control

1. The default mode is a gradual color-changing effect. The 3D surround lights have a breathing gradient effect.
2. Pressing the lighting control button once will fix the red color, stopping the gradual color change effect.
3. Pressing the lighting control button again will cycle through 8 different lighting effects: gradual color change, red, green, blue, yellow, cyan, purple, and white. Pressing the lighting control button once more will turn off the RGB lights, and the cycle will start again.
4. The lighting duration is set to 5 minutes. After 5 minutes, the lights will turn off. To turn them on again, you will need to press the lighting switch once more.

### Programming function

1. There are two programming buttons on the bottom of the controller, M1 and M2.
2. Each programming button can be used to map a single action button or program multiple buttons. (e.g., A/B/X/Y/L/ZL/R/ZR/L3/R3/Up/Down/Left/Right) can all be programmed.
3. Each programming button can support up to 14 key combinations.
4. The programming buttons do not have TURBO rapid-fire functionality.

5. The programming buttons have a memory function. Regardless of whether the controller is in sleep mode, powered off, or restarted, the controller will remember the last programmed configuration.
- Programming Steps:
6. Press and hold the programming button (M1 or M2) and the "MACRO" button for 3 seconds. The LED indicator 1 or 2 will flash rapidly. Release the buttons to enter programming mode.
7. Press one or multiple regular function buttons (such as pressing one or more keys from "A/B/X/Y/L/ZL/R/ZR/L3/R3/Up/Down/Left/Right" as a combination). Press the corresponding programming button again to confirm and exit, completing the programming. The mode indicator light will return to its previous state.
8. Press and hold the "MACRO" button and the M1 (or M2) button for 3 seconds. After programming starts, if the M1 (or M2) button is not pressed within 50 seconds, the controller will automatically save the programmed key combination to the M1 (or M2) button and exit programming mode.
9. After successful programming, the programming button will have the same function as the single or multiple buttons that were programmed.
- Clearing Programming Function:
10. Simultaneously press and hold the programming button to be cleared (M1 or M2) and the "MACRO" button. The LED indicator 1 or 2 will flash rapidly. Release the buttons.
11. Press the programming button that needs to have its function canceled again to confirm and automatically exit. The mode indicator light will return to its previous state, and the programming function will be cleared.

### Charging / sleep / wake up/ off function

1. Charging function:
  - a. When the power is low, the LED 4 indicator flashes quickly;
  - b. When charging, the LED 4 will be flashes slow;
  - c. When fully charged, the LED 4 will be always on;Note: charging status can't pair, only can reconnect.
2. Sleep / wake up / off function:
  - a. The controller will automatically turn off if no pair within 5 minutes.
  - b. When you need to use the controller again, simply press the HOME button to wake it up and it will reconnect.
  - c. While power-on, press and hold the HOME button for 3 seconds to turn off the controller. All LED indicators will turn off.
  - d. If the device can't be searched, automatically turn off in 3 minutes. And turn off in 30 seconds while can't reconnect.

### Note

1. Please do not store this product in wet or high-temperature areas.
2. Don't knap, beat, drub, pierce, or try to decompose this product, to avoid unnecessary damage to the product.
3. Non-professionals disassemble this product by mistake otherwise it will not be cover by the after-sales warranty service;
4. Non professional personnel should not disassemble the product, otherwise it will not be covered in the after-sales warranty service.

### Accessories List

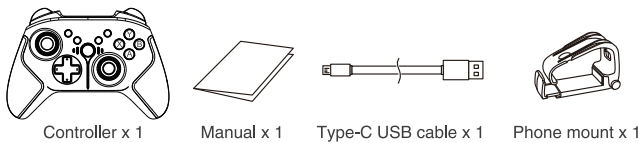

### FCC Warning

This device complies with Part 15 of the FCC Rules. Operation is subject to the following two conditions:

(1) This device may not cause harmful interference, and (2) this device must accept any interference received, including interference that may cause undesired operation.

NOTE 1: This equipment has been tested and found to comply with the limits for a Class B digital device, pursuant to part 15 of the FCC Rules. These limits are designed to provide reasonable protection against harmful interference in a residential installation. This equipment generates, uses and can radiate radio frequency energy and, if not installed and used in accordance with the instructions, may cause harmful interference to radio communications. However, there is no guarantee that interference will not occur in a particular installation. If this equipment does cause harmful interference to radio or television reception, which can be determined by turning the equipment off and on, the user is encouraged to try to correct the interference by one or more of the following measures:

- Reorient or relocate the receiving antenna.
- Increase the separation between the equipment and receiver.
- Connect the equipment into an outlet on a circuit different from that to which the receiver is connected.
- Consult the dealer or an experienced radio/TV technician for help.

NOTE 2: Any changes or modifications to this unit not expressly approved by the party responsible for compliance could void the user's authority to operate the equipment.

FCC ID: 2AGKB-GM1