

INTRODUCTION

Thank you for purchasing the HRB 3033 true wireless earbuds. In order to maximize your listening experience please read the following instructions.

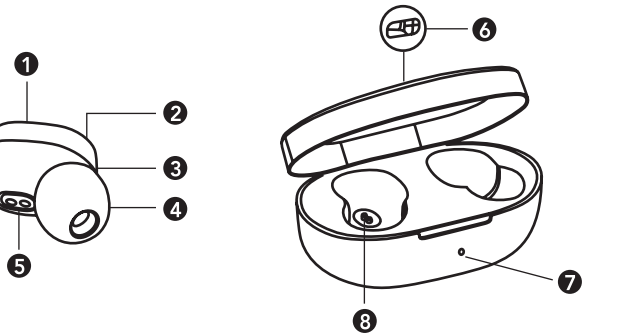

- 1 Multi-function button
- 2 Indicator
- 3 Microphone
- 4 Earbud tip
- 5 Contact points
- 6 Charging port
- 7 Charging indicator
- 8 Charging pins

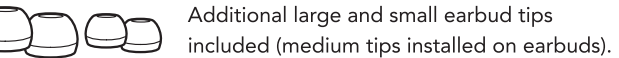

WHAT'S INCLUDED

- HRB 3033 earbuds
- Charging case
- Small, medium and large earbud tips
- USB-C charging cable
- Instruction manual

OPERATING INSTRUCTIONS

Prior to first use, remove the plastic battery isolator tab located between the earbuds and the charging case.

TO	DO THIS
Power ON	Remove the earbuds from the charging case or press and hold both MFB buttons for 2 seconds.
Power OFF	Place earbuds back in the charging case or press and hold both MFB buttons for 5 seconds.
Play/Pause	Press either MFB button once.
Next song	Press the right MFB button three times.
Previous song	Press the left MFB button three times.
Answer a call	Press either MFB button once.
End a call	Press either MFB button once.
Reject an incoming call	Press and hold either MFB button for one second.

NOTE: The function compatibility may vary among different smartphones or devices. Not all functions are available on all devices.

CHARGING THE CASE

Use the included charging cable to fully charge the case before first use. It will take approximately 2 hours to fully charge. The red LED will flash during charging, and remain ON when charging is complete.

CHARGING THE EARBUDS

The earbuds will automatically power OFF and begin charging when they are placed in the charging case. The red LED on the earbuds will be ON to indicate the earbuds are charging. When the earbuds have fully charged, the LED will change to blue and stay lit for 30 to 60 seconds. The LEDs will then turn OFF. It will take 1.5 hours to fully charge the earbuds. The earbuds can be charged 1.5 times using a fully charged case.

PAIRING

The earbuds will automatically enter Bluetooth® pairing mode when used for the first time. The left and right earbuds connect to each other.

1. Remove both earbuds from the charging case. The red and blue LEDs will flash to indicate the earbuds have powered ON.
2. Select "HRB 3033" on the Bluetooth® device list to pair the earbuds automatically.
3. When the earbuds are successfully paired the LED will turn OFF.
4. After initial pairing, the earbuds will automatically turn ON and connect to your device when removed from the charging case, provided both earbuds and your Bluetooth® are ON and within range.

TO USE ONLY THE LEFT OR RIGHT EARBUD

If both earbuds are turned ON and paired to your device, you can return the right or left earbud to the charging case and the earbud (R or L) in your ear will continue to play. To use the right or left earbud only, remove it from the charging case. It will turn ON and connect automatically to your device.

RESET

If the left and right earbuds do not connect to each other, you will need to reset the earbuds and clear paired memory.

1. Remove "HRB 3033" from your device listing and turn Bluetooth® OFF on your device.
2. Turn OFF the earbuds, then press and hold either MFB button for 10 seconds (do this firmly in the center) to enter 'Reset Mode'.
3. The red and blue LEDs will flash at the same time. Release the button and you will hear a beep. Return the earbuds to the charging case.
4. Turn Bluetooth® back ON in your device settings and select "HRB 3033".

OPERATION

- While playing music, press either MFB button to pause, press again to resume
- Quickly press the right MFB three times for the next song, quickly press the left MFB three times for the previous song
- The music will pause and the earbuds will ring when there is an incoming call. Press and hold either MFB button once to answer the call, press and hold to reject the call
- To turn the earbuds OFF without returning them to the charging case, press and hold either MFB button for 5 seconds. The red LEDs will turn ON, then the earbuds will power OFF
- To turn the earbuds ON when they are not in the charging case, press and hold both MFB buttons for 2 seconds

If no Bluetooth® device is connected, the earbuds will automatically turn OFF after approximately 3 minutes.

WARNING!

- Supervise children when using equipment
- This product is not a toy
- Listening to earbuds at high volume levels, particularly over extended periods of time may damage your hearing
- If you have a pacemaker or other electrical medical devices, you should consult your physician before using this product
- The operation of switching on your Hi-Fi system or plugging in the earbuds may cause clicks which at high volume setting may affect your hearing. Therefore, always set the volume control to minimum before switching between different sources (tuner, turntable, CD player, etc.) or plugging in the earbuds
- DO NOT use earbuds while driving or cycling
- The small parts included with this product can be a choking hazard. This product is not intended for use by small children and should be kept away from children under 3 years of age
- If not used for long periods, it is recommended to charge the earbuds and case at least every 3 months
- Please dispose of rechargeable batteries properly. DO NOT dispose of batteries in fire to prevent an explosion

TROUBLESHOOTING

No sound

- Please check the volume on your audio device to make sure it is outputting sound

Connection Problems

- Please return the earbuds to the case and then remove them again if there are any connection issues
- Refer to the cleared paired memory and reset section

The earbuds are not fitting comfortably

- Please switch out the earbud tips to a different size to find the appropriate fit

Improving the Sound

- Sound can sometimes be improved by moving to a larger eartip size. The eartips still need to fit comfortably in your ear

CLEANING

Your earbuds may require periodic cleaning. Remove the tips from the earbuds and wash them with a mild detergent and water. Make sure the tips are dry before putting them back on the earbuds.

IMPORTANT SAFETY INFORMATION

CAUTIONS

- Keep in a safe place free from dust, liquid and extreme temperatures
- DO NOT attempt to disassemble the product
- DO NOT use chemicals to clean the product

SPECIFICATIONS

EARBUDS

Bluetooth® version:	V5.0
Bluetooth® profiles*:	HSP; HFP; A2DP; AVRCP
Wireless range:	10m (32ft.)
Playback time:	Approx. 4.5 hours**
Standby time:	Approx. 40 hours
Rated input:	DC 5V/43mA
Driver diameter:	7.2mm
Sensitivity:	96dB±3dB

Frequency response:	20Hz-20kHz
Impedance:	16Ω±15%
Battery:	Polymer Lithium
Earbud battery capacity:	43mAh
IP rating:	IPX4

CHARGING CASE

Fully powered case:	Provides up to 1.5 charges
Rated input:	DC 5V, 500mA
Output:	DC 5V, 150mA
Battery capacity:	300mAh
*A2DP=Advanced Audio Distribution Profile, AVRCP=Audio Video Remote Control Profile, HSP=Handset Profile, HFP=Handsfree Profile.	
**Approximate playback time, battery life depends on individual use and may be more or less than specified.	
*** Bluetooth® connected, power ON, no music playing.	



The Bluetooth® word mark and logos are registered trademarks owned by Bluetooth® SIG, Inc. and any use of such marks by The Source (Bell) Electronics Inc. is under license. Other trademarks and trade names are those of their respective owners.

FCC ID:	2AGHD-8093124
IC:	255A-8093124
CAN ICES-003(B)/NMB-003(B)	

IC Statement

-English: This device contains licence-exempt transmitter(s)/receiver(s) that comply with Innovation, Science and Economic Development Canada's licence-exempt RSS(s). Operation is subject to the following two conditions:

- (1) This device may not cause harmful interference, and
- (2) This device must accept any interference received, including interference that may cause undesired operation of the device.

The digital apparatus complies with Canadian CAN ICES-3 (B)/NMB-3(B)

-French: L'émetteur/récepteur exempt de licence contenu dans le présent appareil est conforme aux CNR d'Innovation. Sciences et Développement économique Canada applicables aux appareils radio exempts de licence. L'exploitation est autorisée aux deux conditions suivantes:

- (1) l'appareil ne doit pas produire de brouillage, et
- (2) l'appareil doit accepter tout brouillage radioélectrique subi, même si le brouillage est susceptible d'en compromettre le fonctionnement

This device meets the exemption from the routine evaluation limits in section 2.5 of RSS 102 and compliance with RSS 102 RF exposure users can obtain Canadian information on RF exposure and compliance.

cet appareil est conforme à l'exemption des limites d'évaluation courante dans la section 2.5 du cnr - 102 et conformité avec rss 102 de l'exposition aux rf, les utilisateurs peuvent obtenir des données canadiennes sur l'exposition aux champs rf et la conformité. Cet équipement est conforme avec les limites d'exposition aux champs rf de l'exposition non contrôlée.

RF Exposure Statement

The device has been evaluated to meet general RF exposure requirement. The device can be used in portable exposure condition without restriction.

L'appareil a été évalué pour répondre aux exigences générales d'exposition aux radiofréquences.

L'appareil peut être utilisé en condition d'exposition portable sans restriction.

FCC Statement

This device complies with part 15 of the FCC Rules. Operation is subject to the following two conditions:

- (1) This device may not cause harmful interference, and
- (2) This device must accept any interference received, including interference that may cause undesired operation.

Any Changes or modifications not expressly approved by the party responsible for compliance could void the user's authority to operate the equipment.

Note: This equipment has been tested and found to comply with the limits for a Class B digital device, pursuant to part 15 of the FCC Rules. These limits are designed to provide reasonable protection against harmful interference in a residential installation. This equipment generates uses and can radiate radio frequency energy and, if not installed and used in accordance with the instructions, may cause harmful interference to radio communications. However, there is no guarantee that interference will not occur in a particular installation. If this equipment does cause harmful interference to radio or television reception, which can be determined by turning the equipment off and on, the user is encouraged to try to correct the interference by one or more of the following measures:

- ▶ -Reorient or relocate the receiving antenna.
- ▶ -Increase the separation between the equipment and receiver.
- ▶ -Connect the equipment into an outlet on a circuit different from that to which the receiver is connected.
- ▶ -Consult the dealer or an experienced radio/TV technician for help.

THE SOURCE - WARRANTY

The Source warrants that this product will be free from defects in materials and workmanship for a period of twelve (12) months from the date of purchase. Within this period, simply take the product and your proof of purchase to any The Source store or participating dealer and the product will be replaced (where available) without charge. Any product which has been subject to misuse or accidental damage is excluded from this warranty. This warranty is only applicable to a product purchased through The Source company-owned stores or participating dealers in Canada where the warranty is included with the product. While this warranty does not confer any legal rights other than those set out above, you may have additional statutory rights which will vary under the laws of the various countries, states, provinces and other governmental entities in which The Source operates. This warranty is subject to all statutory rights you may have in Canada.

Imported by:
The Source, Barrie, Ontario, Canada, L4M 4W5
Manufactured in China
www.thesource.ca
© 2021 The Source. All rights reserved.



Please Recycle