

Pulse PRO

Setup Instructions for iOS and Android



Contents

SAFETY	3
FCC & ISED STATEMENT	3
THE APP ALLOWS FOR	4
GETTING STARTED	4
WI-FI HUB TECHNICAL SPECIFICATIONS	4
BEST PRACTICES FOR PAIRING THE HUB WITH YOUR WI-FI NETWORK	4
CAPABILITIES	5
WHAT'S IN THE BOX?	5
UNPACKING THE HUB 2.0	5
APP NAVIGATION	5
IOS QUICK START SETUP	6
IOS APP SIGN UP	6
IOS ADDING ADDITIONAL HUB TO EXISTING LOCATION	9
IOS CONFIGURATION IN APPLE HOMEKIT MANUAL OR SCANNED	11
ANDROID APP SIGN UP	12
ANDROID QUICK START SETUP	13
ANDROID ADDING ADDITIONAL HUB TO EXISTING LOCATION	15
CREATING A LOCATION	17
HOW TO PAIR A MOTOR TO THE APP	17
HOW TO CREATE A ROOM	19
HOW TO CREATE A SCENE	20
CREATING TIMERS	22
USER MANUAL TILE CONTROL	23
SHADE HEALTH, HELP, & OTHERS	24
SIGNAL STRENGTH	25
HUB LED BEHAVIOUR	26
SHADE HEALTH INDICATORS	27
TROUBLESHOOTING INFORMATION	28
UNDERSTANDING WIRELESS SIGNAL STRENGTH	30
SHADE ISSUES	30
REPEATERS	31
PULSE PRO OFFLINE ASSISTANCE	32

SAFETY



WARNING: Important safety instructions to be read before installation and use.

Incorrect use can lead to serious injury and will void manufacturer's liability and warranty. It is important for the safety of persons to follow the enclosed instructions.

- Before using the device, read the instruction manual carefully to understand its proper use and maintenance.
- Do not expose to water, moisture, humid and damp environments or extreme temperatures
- Persons (including children) with reduced physical, sensory or mental capabilities, or lack of experience and knowledge, should not be allowed to use this product.
- Use of modification outside the scope of this instruction manual will void warranty.
- Installation and programming to be performed by a suitably qualified installer.
- For use with motorized shading devices.
- Frequently inspect for improper operation.
- Do not use if repair or adjustment is necessary.
- Keep clear when in operation.



Do not dispose of in
general waste

FCC ID: 2AGGZ003B9ACA59

IC: 21769-003B9ACA59

FCC & ISED STATEMENT

This device complies with part 15 of the FCC Rules.

Operation is subject to the following two conditions: (1) This device may not cause harmful interference, and (2) this device must accept any interference received, including interference that may cause undesired operation.

Caution: Changes or modifications to this unit not expressly approved by the party responsible for compliance could void the user's authority to operate the equipment. This device contains licence-exempt transmitter(s)/receiver(s) that comply with Innovation, Science and Economic Development Canada's licence-exempt RSS(s). Operation is subject to the following two conditions: (1) This device may not cause interference. (2) This device must accept any interference, including interference that may cause undesired operation of the device.

L'émetteur/récepteur exempt de licence contenu dans le présent appareil est conforme aux CNR d'Innovation, Sciences et Développement économique Canada applicables aux appareils radio exempts de licence. L'exploitation est autorisée aux deux conditions suivantes : 1) L'appareil ne doit pas produire de brouillage; 2) L'appareil doit accepter tout brouillage radioélectrique subi, même si le brouillage est susceptible d'en compromettre le fonctionnement.

NOTE: This equipment has been tested and found to comply with the limits for a Class B digital device, pursuant to part 15 of the FCC Rules. These limits are designed to provide reasonable protection against harmful interference in a residential installation. This equipment generates, uses and can radiate radio frequency energy and, if not installed and used in accordance with the instructions, may cause harmful interference to radio communications. However, there is no guarantee that interference will not occur in a particular installation. If this equipment does cause harmful interference to radio or television reception, which can be determined by turning the equipment off and on, the user is encouraged to try to correct the interference by one or more of the following measures:

- Reorient or relocate the receiving antenna.
- Increase the separation between the equipment and receiver.
- Connect the equipment into an outlet on a circuit different from that to which the receiver is connected.
- Consult the dealer or an experienced radio/TV technician for help.

To satisfy FCC&IC RF exposure requirements, a separation distance of 20cm or more should be maintained between the antenna of this device and persons during device operation. To ensure compliance, operations at closer than this distance is not recommended.

Les antennes installées doivent être situées de façon à ce que la population ne puisse y être exposée à une distance de moins de 20 cm. Installer les antennes de façon à ce que le personnel ne puisse approcher à 20 cm ou moins de la position centrale de l'antenne.

Limited by local law regulations, version for North America does not have region selection option.

Pulse PRO | Set up Instructions for iOS and Android

The Pulse PRO connects to home networks to unlock the luxury of automated shade control. Experience customization with scene and timer options as well as voice control via Google Assistant, Amazon Alexa, and Apple HomeKit.

THE APP ALLOWS FOR



1. Individual and group control – Group Automate shades by room and conveniently control them accordingly.
2. Remote connectivity - Control shades remotely, whether home or away on a local network or an internet connection.
3. Smart Shade Prediction Function that opens or closes shades with one tap depending on the time of the day
4. Scene control - Personalize shade control and organize how your shades operate by specific daily events.
5. Timer functionality - Set and forget. Lower, raise and activate shade scenes automatically at the optimal time.
6. Sunrise and Sunset - Utilizing time zone and location, the Pulse PRO can automatically raise or lower Automate shades according to the position of the sun.
7. Compatible IoT Integrations:
 - Amazon Alexa
 - Google Home
 - IFTTT
 - Smart Things
 - Apple HomeKit

GETTING STARTED

In order to experience automated shade control through the Automate App, you will need to have:

- Downloaded the free app Automate App via the Apple App Store (available under iPhone apps) or iPad apps for iPad devices.
- Purchased one or more Hub's depending on the size of the area you would like to cover.
- Familiarized yourself with the app navigation guide below.
- Created a Location then pair hub to that location. Our step by step guide will explain in more detail.

WI-FI HUB TECHNICAL SPECIFICATIONS

- Radio Frequency range: ~ 60 feet (no obstructions)
- Radio Frequency: 433 MHz
- Wi-Fi 2.4 GHz or Ethernet Connectivity (CAT 5)
- Power: 5V DC
- For Indoor Use Only

BEST PRACTICES FOR PAIRING THE HUB WITH YOUR WI-FI NETWORK

- Only pair your hub via 2.4GHZ Wi-Fi.
- The Hub must be within signal range of both the automated shades and 2.4GHZ Wi-Fi.
- Ensure 5Ghz are disabled on your Wi-Fi router or disconnected from your mobile device.
- Check your phone and confirm if the Home App has been installed.
- Environments with multiple WAPs (wireless access points) may need all but the main router temporarily disabled.
- Security settings on your router and on phone may need to be temporarily disabled.
- Place the Hub in a horizontal position. (avoid metal enclosures / ceiling or any other locations that may affect the range.
- Before starting the Hub installation, make sure that all your shades are functional and charged. You can test the shade using a remote control or pressing a "P1" Button on the motor head.
- In case of range issues, it is recommended you deploy the antenna or reposition the hub in your installation.
- Add additional repeaters if is required (Only two per Hub).

CAPABILITIES

- Motors per Hub: 30
- Locations per account: 5
- Hubs per location: 5
- Rooms per Location: 30 per Hub
- Scenes per Hub: 20 (100 per location)
- Timers per Hub: 20 (100 per location)

WHAT'S IN THE BOX?



A.
Automate Pulse PRO



B.
USB Power Supply



C.
USB Power Cord



D.
Ethernet cable



D.
Quickstart guide

UNPACKING THE PULSE PRO



1.
Unpack the Pulse PRO

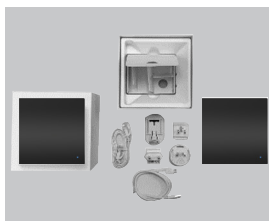

2.
Check the Box Contents



3.
Plug the USB Cord into the
Power Supply

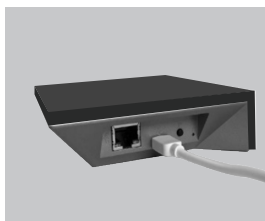

4.
Connect the USB-C end into
the back of the Pulse PRO



5.
Plug the Power Supply into
the outlet and place the
Hub in a central location in
your home

APP NAVIGATION

- 1 Home**
Create a list of your shades, rooms and scenes in one place.
- 2 Shades**
All the shades connected to Pulse PRO will appear here
- 3 Rooms**
Add shades to Rooms and control an entire room with 1 button
- 4 Scenes**
Create a Scene that sets your shades to a particular position eg Sunrise (all Open)
- 5 Timers**
Show a list of Timers that can activate a scene or a single device

App Version 3.0

Supported Device Types

iOS 11 and higher Device Types, Android OS 6.0 OR HIGHER
Mobile and Tablets - Tablet (Landscape is supported)

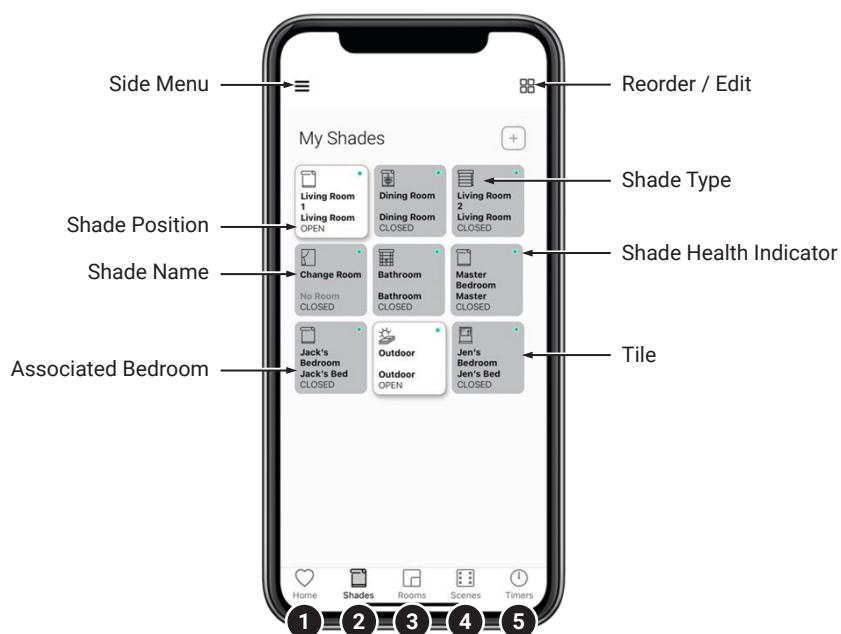

IOS | APP SIGN UP

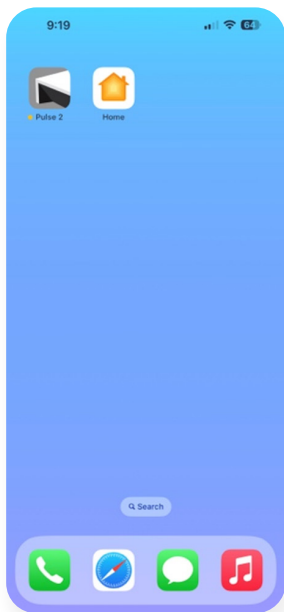

1 Open the App

Open the Automate App mobile App.

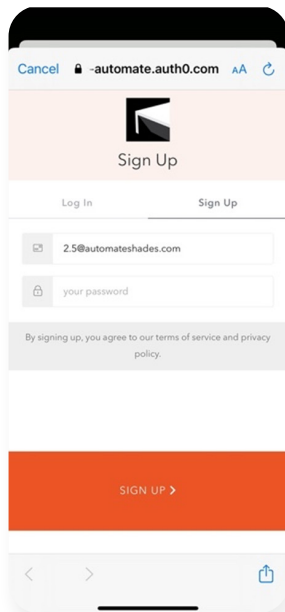

2 Sign Up

If required, create a new account. Select Sign Up on the Top Right corner of the screen.

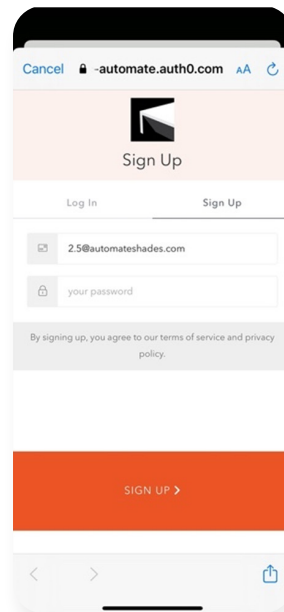

3 Sign Up

Creating an account will require an email address and password.

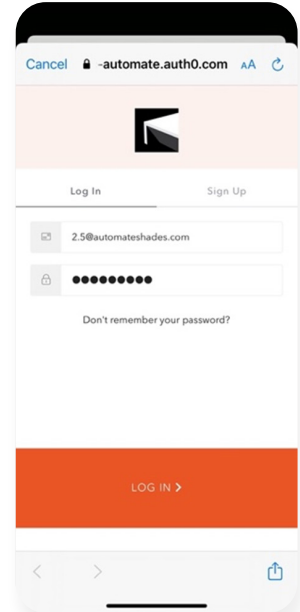

4 Sign In

If you already have an account Log in with your account information.

IOS | QUICK START SETUP

NOTE: Wi-Fi only via a 2.4GHZ connection.
Quick Start prompt will only occur if there is no Locations in the App.

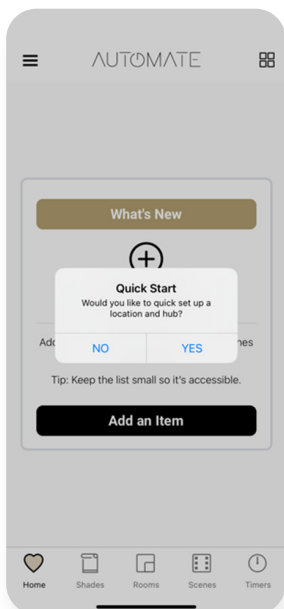

1 Quick Start

Please power up the Hub then follow the Quick Start guide. Select "YES". (Ensure there are locations present).

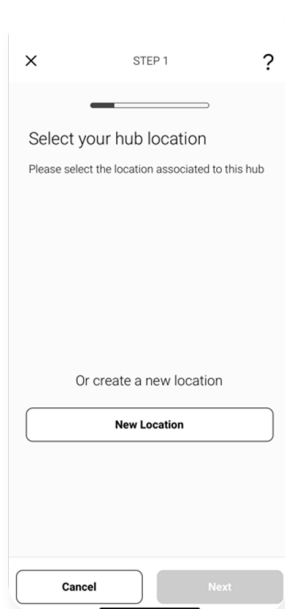

2 Add Location

Select New Location followed by next.

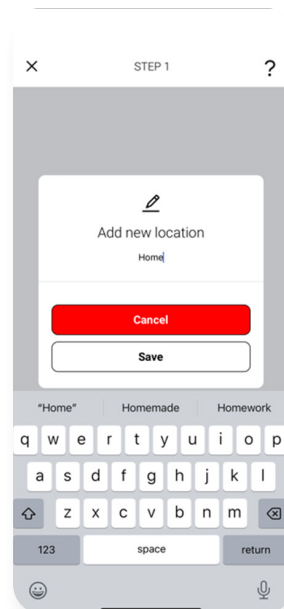

2a Name location

Name your location with your desired name.

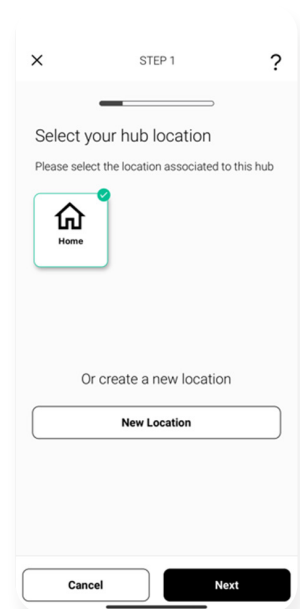

3 Select Location

Now select newly created location and press Next.

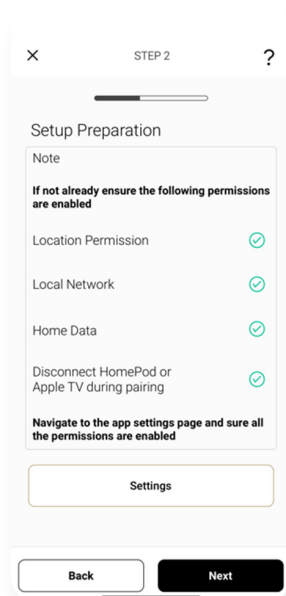

4 Prepare for Setup

Confirm all of your permissions are enabled.

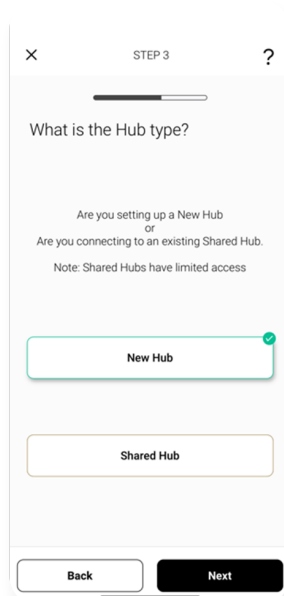

5 Select Hub Type

Select New Hub and press Next.

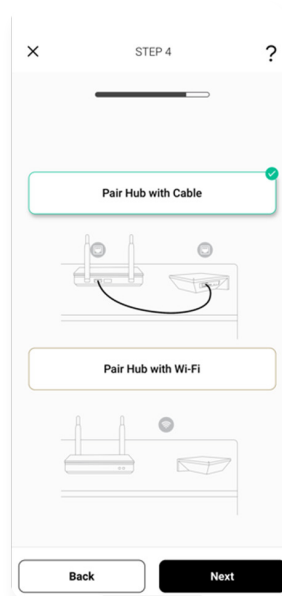

6 Choose Method

For this setup we are using PAIR HUB WITH CABLE method. For WIFI pairing method refer to next section i.e "Adding additional Hub".

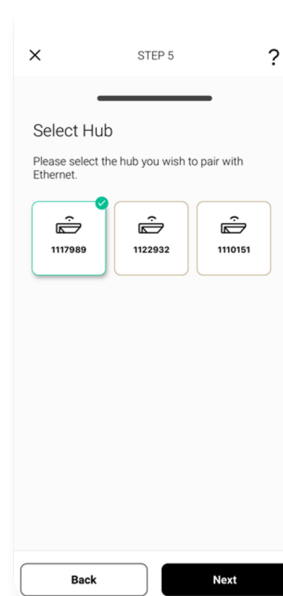

7 Select your Hub

Select your hub from the list which is connected to cable and press Next.

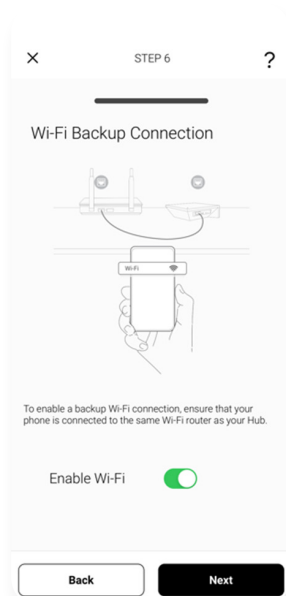

8 WIFI Backup

WIFI toggle ON to switch to WIFI automatically when cable is plugged off. If toggled off skip to step 10.

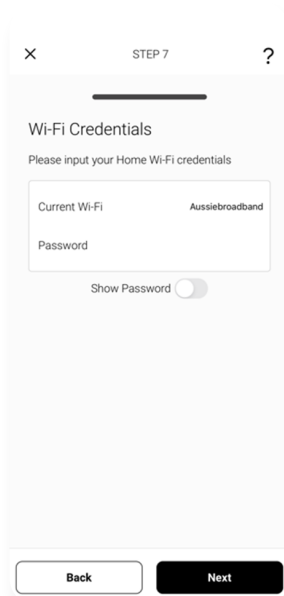

9 Wifi Password

Put in the password for your WIFI which is of the router the hub is connected to.

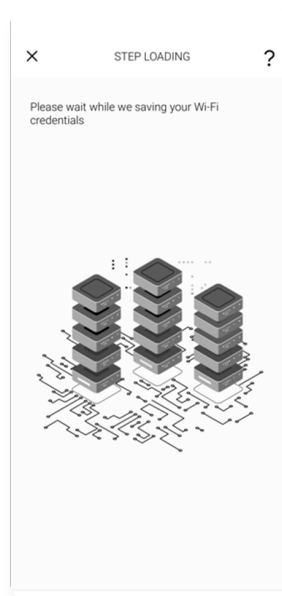

9a Saving Wifi

On this screen wait momentarily as WIFI credentials are being saved.



10 Scan QR code

Now Scan QR code which is at the bottom of the Hub.

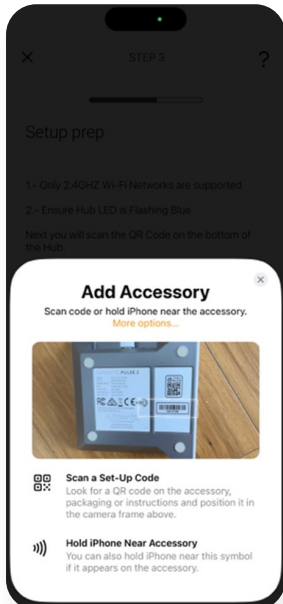

10a Scan QR code

Scan the QR Code on the bottom of the hub to sync with HomeKit.

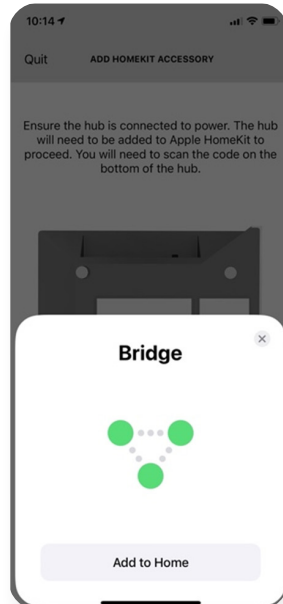

10 HomeKit Discovery

Select add to Home.

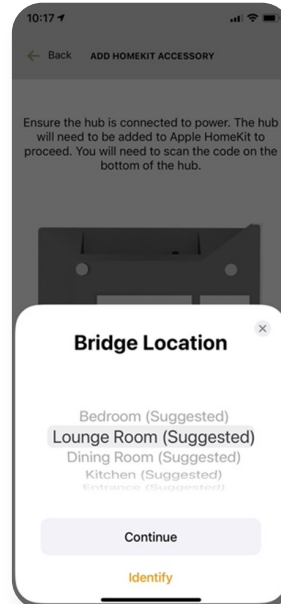

11 HK Location

Select the Location where the Hub will be placed. Select Continue.

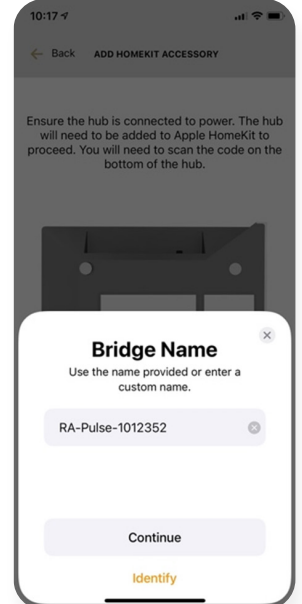

12 Name Hub

Enter and Unique Name for your Hub.

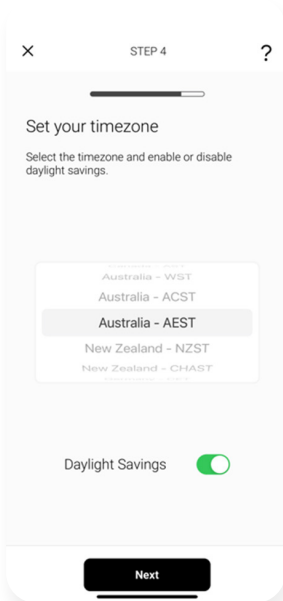

13 Select time zone

Select your time zone and press Next.

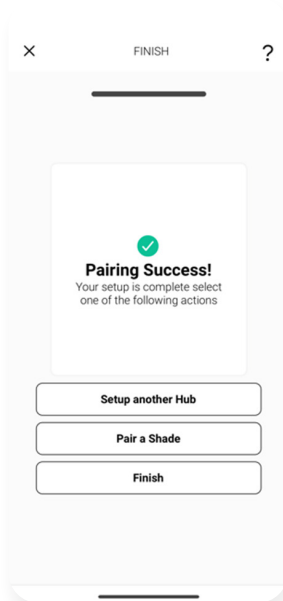

14 Success

Hub has been successfully Paired.

IOS | ADDING ADDITIONAL HUB TO EXISTING LOCATION

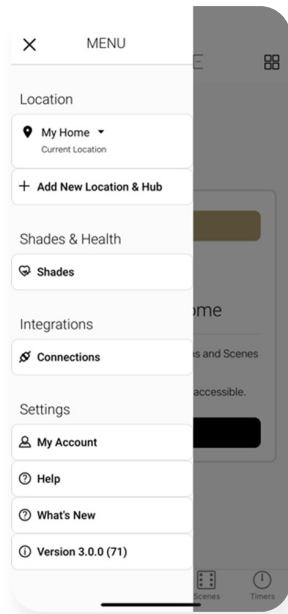

1 Configure a Hub

Select menu then the desired location.

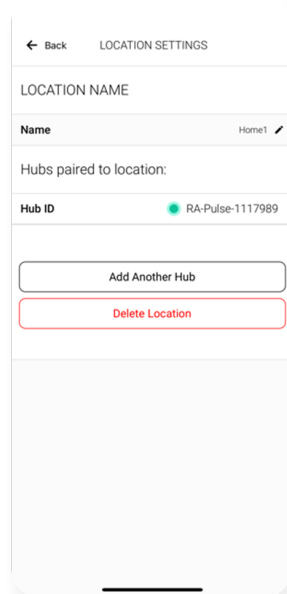

2 Add Hub

Click on "ADD ANOTHER HUB" to start the process to setting up your HUB on the App.

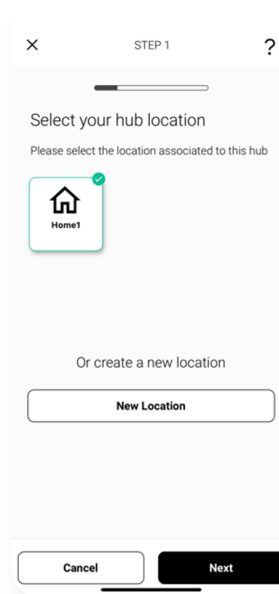

3 Select Location

Select location to add this hub to.

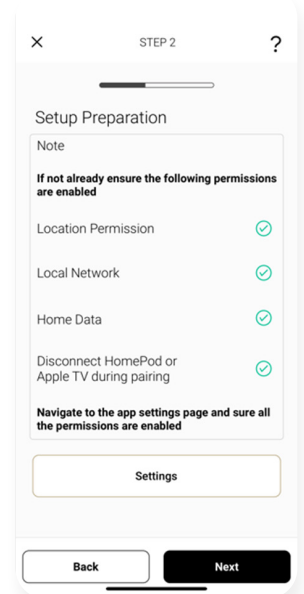

4 Prepare for Setup

Ensure all of your permissions are enabled.

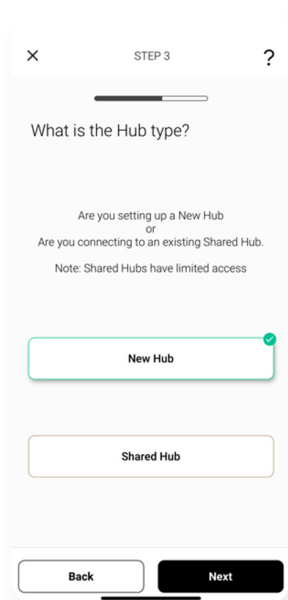

5 Hub Type

Select menu then the desired location.

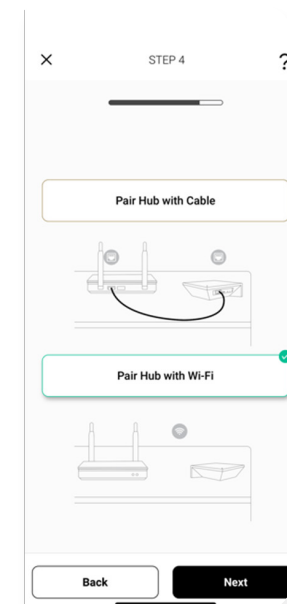

6 Choose Method

Click on "ADD ANOTHER HUB" to start the process to setting up your HUB on the App.



7 Scan QR code

Select location to add this hub to.

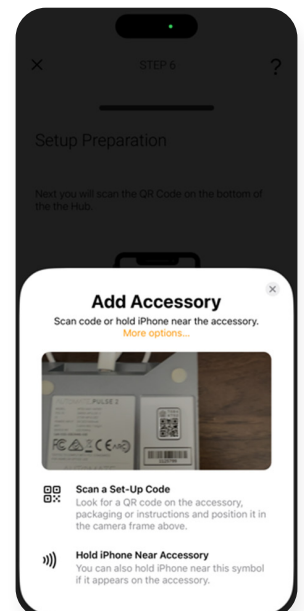

7a Scan QR code

Ensure all of your permissions are enabled.

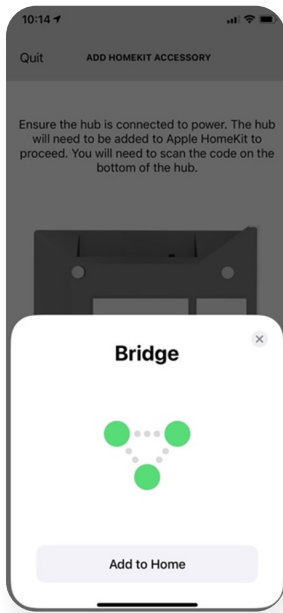

8 HomeKit Discovery

Select add to Home.

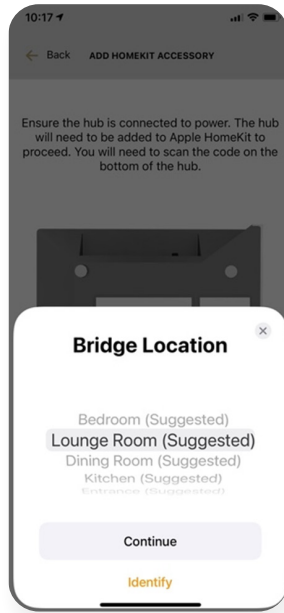

9 HK Location

Select the Location where the Hub will be placed. Select Continue.

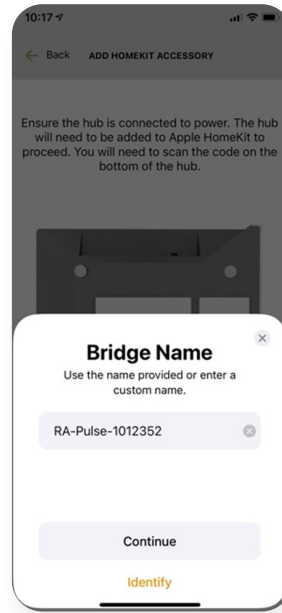

10 Name Hub

Enter and Unique Name for your Hub.

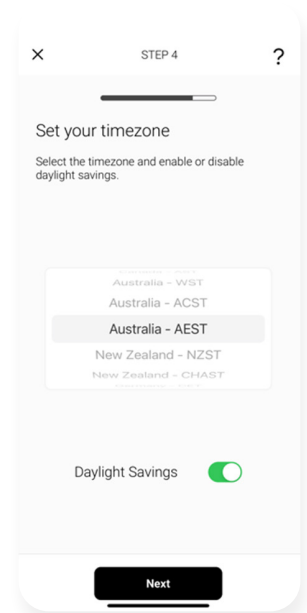

11 Select time zone

Select your time zone and press Next.

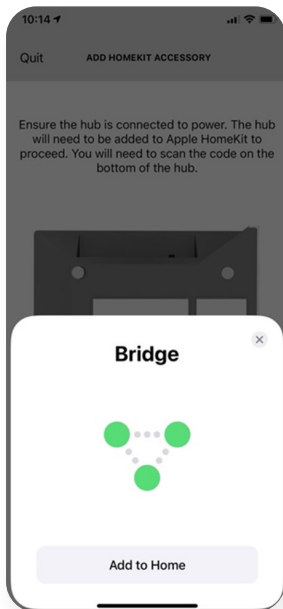

8 HomeKit Discovery

Select add to Home.

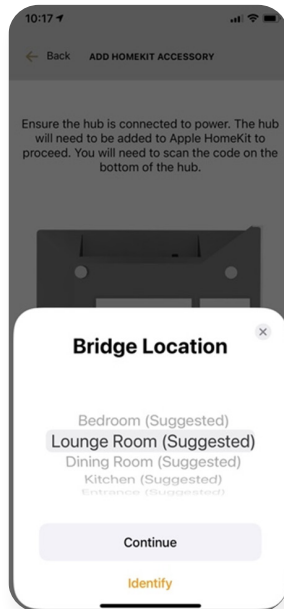

9 HK Location

Select the Location where the Hub will be placed. Select Continue.

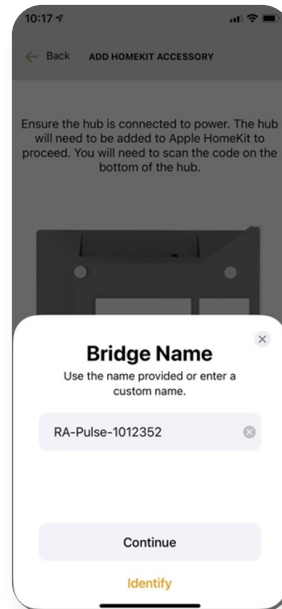

10 Name Hub

Enter and Unique Name for your Hub.

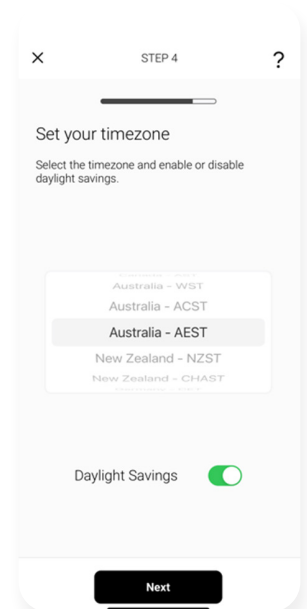

11 Select time zone

Select your time zone and press Next.

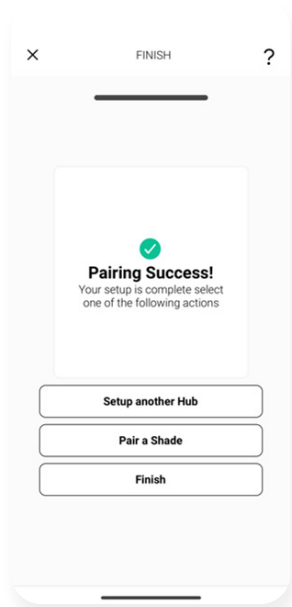

12 Success

Hub has been successfully Paired.

IOS | CONFIGURATION IN APPLE HOMEKIT MANUAL OR SCANNED

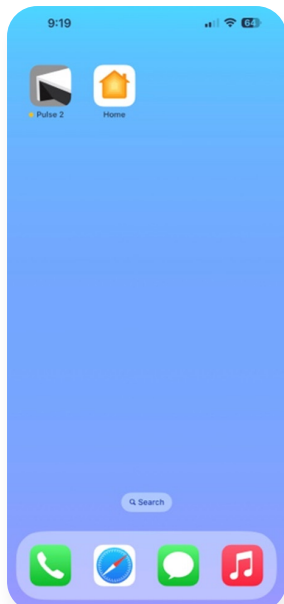

1 Open HomeKit App

Open the Home App.

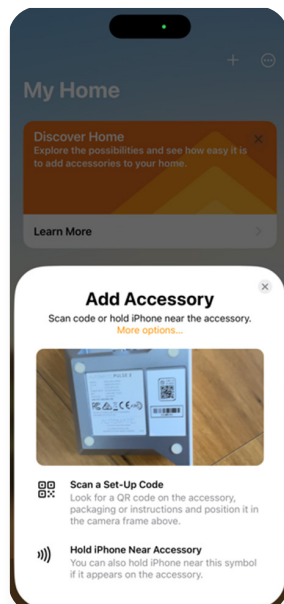

2 Scan Hub

Scan the QR code at the bottom of the Hub. If the Code does not scan select "I don't have a Code or cannot scan".

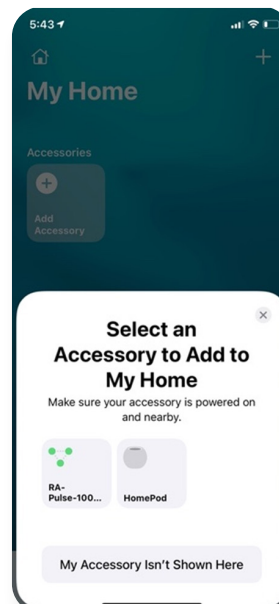

3 Select Hub

Select the RA Pulse ... Device.

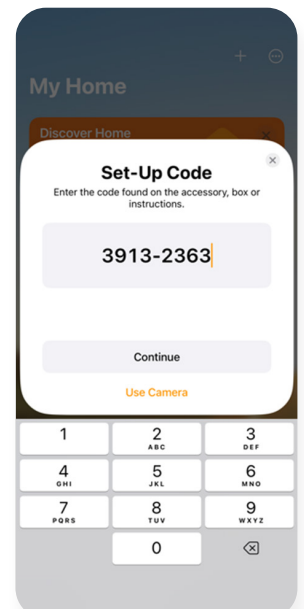

4 Manual Code Entry

Ensure all of your permissions are enabled.

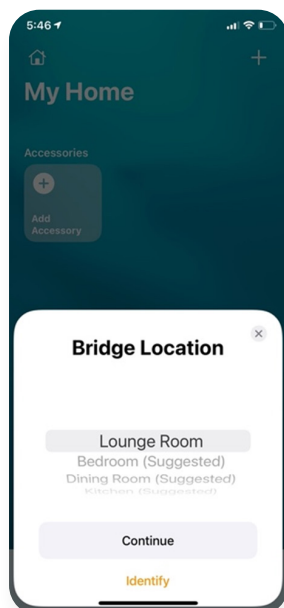

- 1 Select Hub location**
Select the location where the Hub will be installed in.

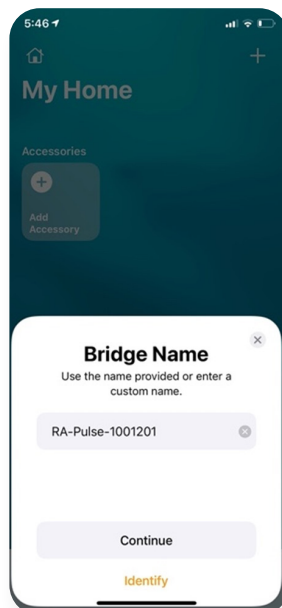

- 2 Configure a Hub**
Enter and Unique Name for your Hub.

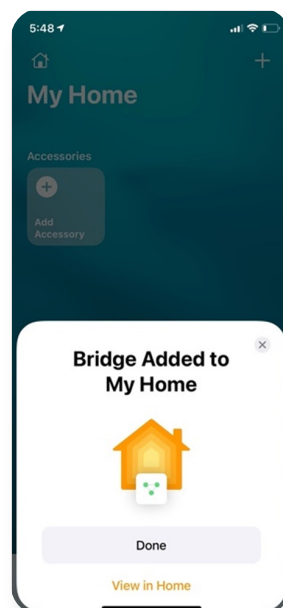

- 3 Configure a Hub**
Setup complete select view in Home.

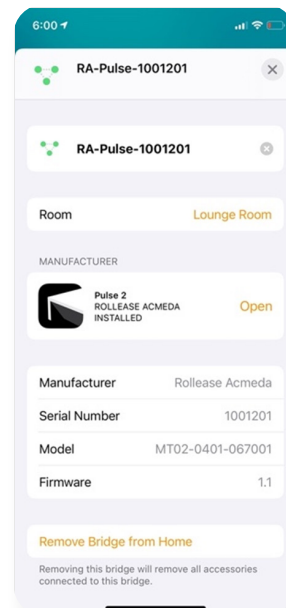

- 4 Configure a Hub**
Verify Hub.

ANDROID | APP SIGN UP

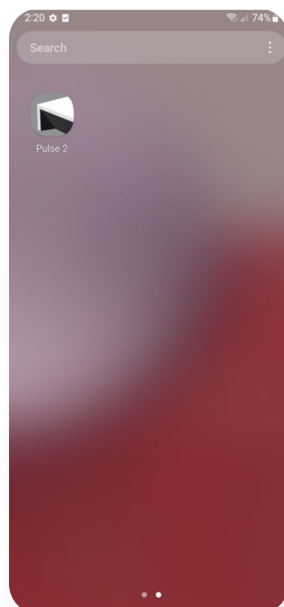

- 1 HomeKit Discovery**
Open the Automate App mobile App.

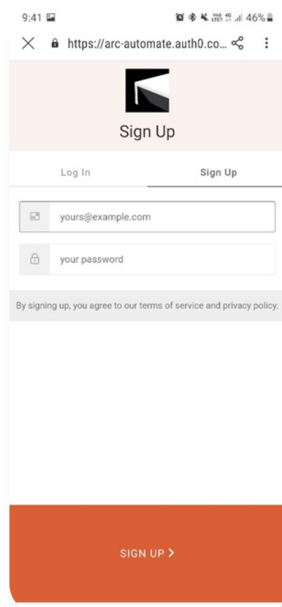

- 2 HK Location**
If required, create a new account. Select Sign Up on the Right tab of the screen.

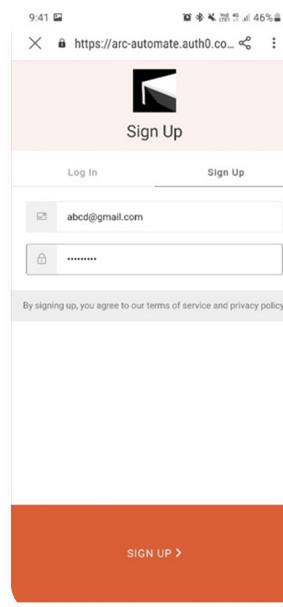

- 3 Name Hub**
Creating an account will require an email address and password.

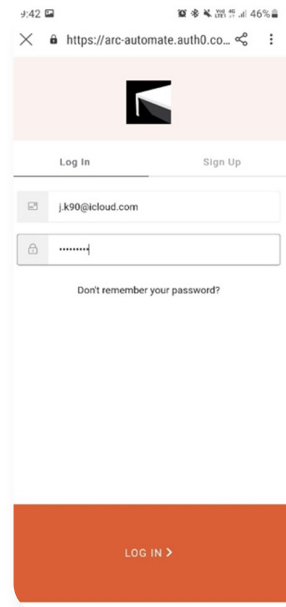

- 4 Select time zone**
If you already have an account Log in with your account information.

ANDROID | QUICK START SETUP

NOTE: Wi-Fi only via a 2.4GHZ connection.
Refer to troubleshooting for more information.

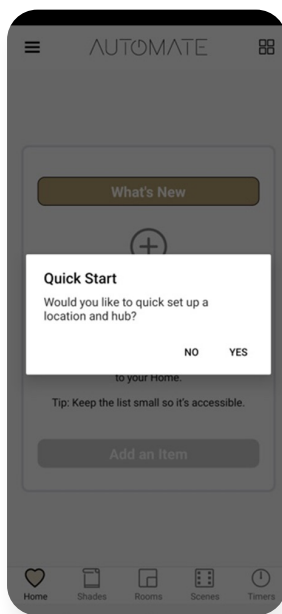

1 Quick Start

Please power up the Hub then follow the Quick Start guide. Select "YES".

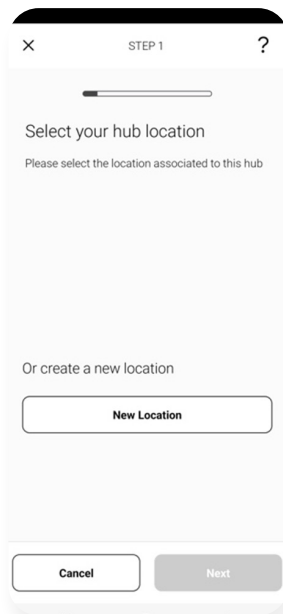

2 Add Location

Select new location and press next.

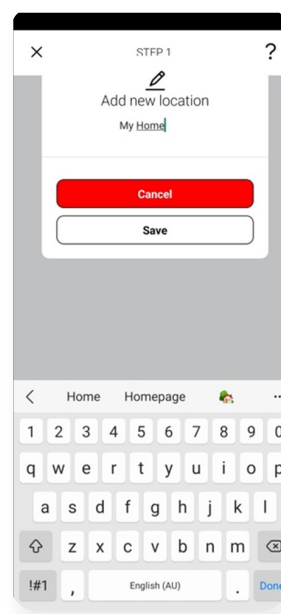

3 Location

Create a location name like "My home".

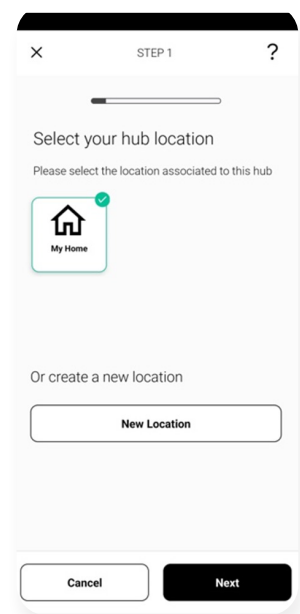

4 Location

Select the location you have just created.

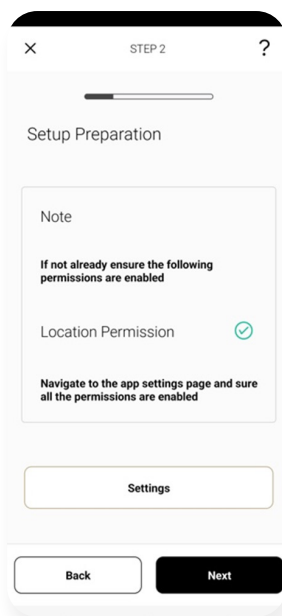

5 Prepare for Setup

Ensure from settings that Location permission is allowed.

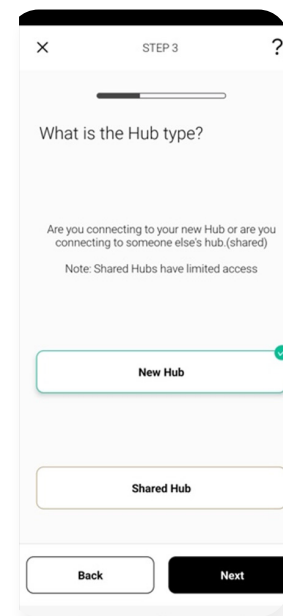

6 Hub Type

Select New Hub and press Next.

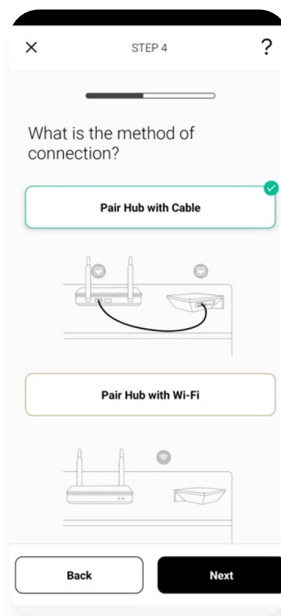

7 Choose Method

For this setup we are using PAIR HUB WITH CABLE method. For WIFI pairing method refer to next section i.e "Adding additional Hub".

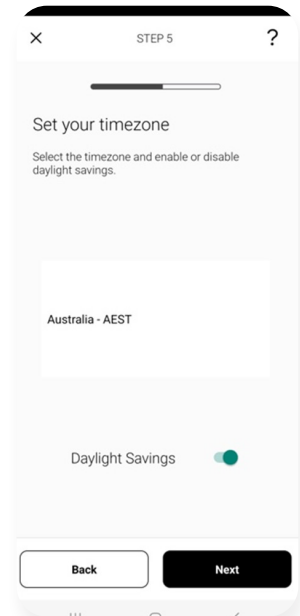

8 Select Time Zone

Choose your time zone and toggle on Daylight savings if applicable.

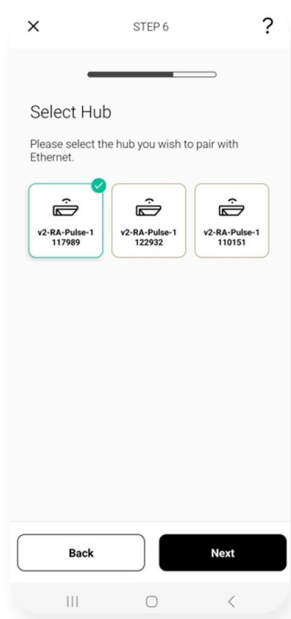

9 Select your Hub

Select your hub from the list which is connected to cable and press Next.



10 WIFI Backup

Turn WIFI toggle ON to switch to WIFI automatically when cable is plugged off. If toggled off and press next, app will take you to step 10.

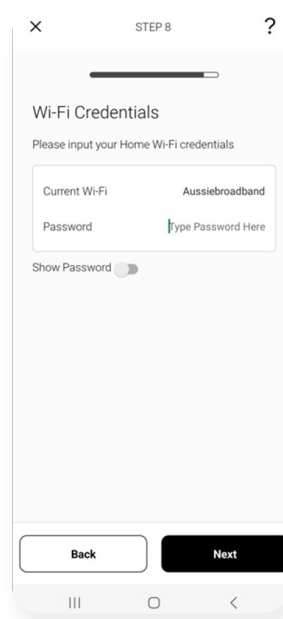

11 Wifi Password

Put in the password for your WIFI which is of the router the hub is connected to and enter Next.

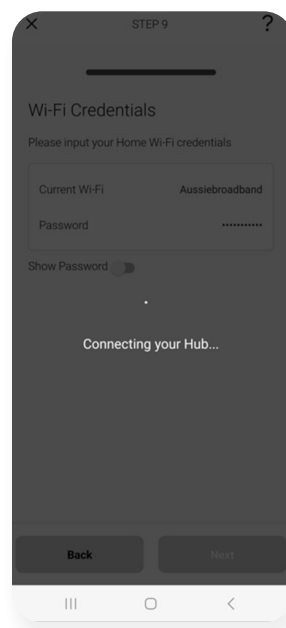

12 Connecting..

Now screen will show connecting your Hub and it connects Hub with internet.

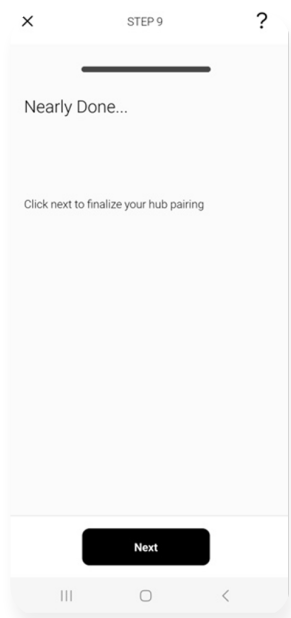

13 Nearly Done

Almost done, press Next on this screen.

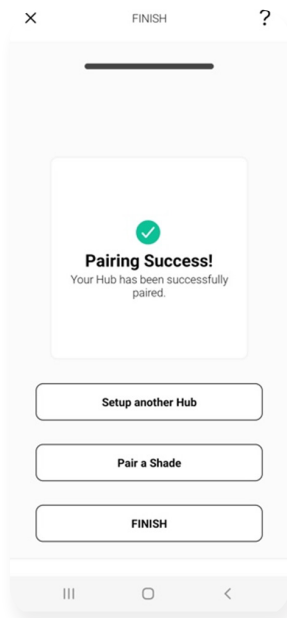

14 Success

Complete. Now pair another hub or start adding shades.

ANDROID | ADDING ADDITIONAL HUB TO EXISTING LOCATION

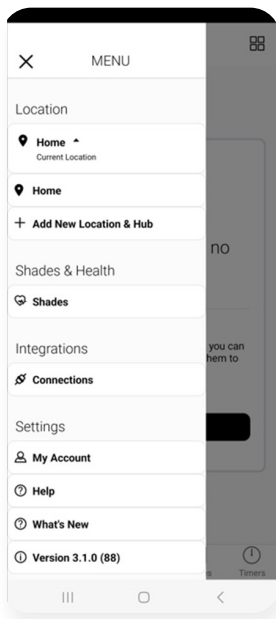

1 Configure a Hub

Select menu then the desired location.

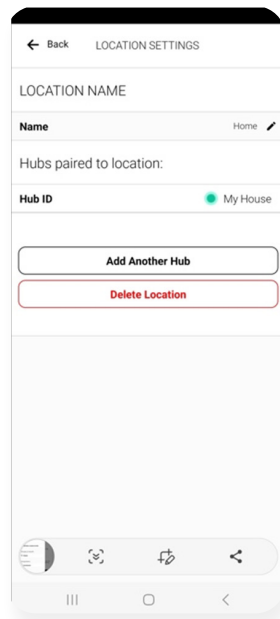

2 Add Hub

Click on "ADD ANOTHER HUB" to start the process to setting up your HUB on the App.

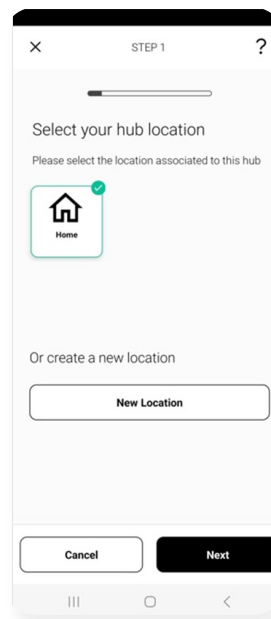

3 Select Location

Select location to add this hub to.

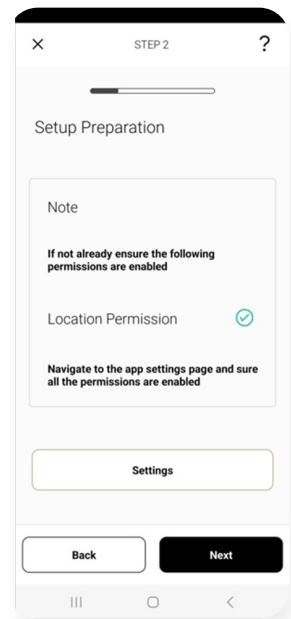

4 Prepare for Setup

Ensure location permissions is enabled.

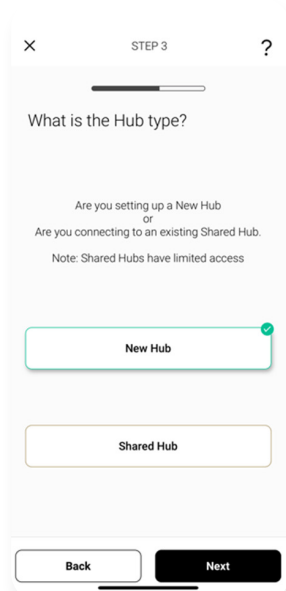

5 Hub Type

Select New Hub and press Next.

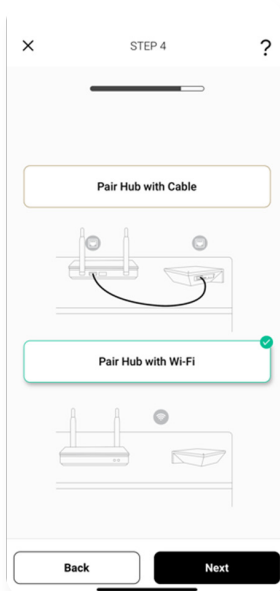

6 Choose Method

For this setup we are using PAIR HUB WITH WIFI method. For Cable pairing method refer to previous section i.e "Android Quick Start Guide".

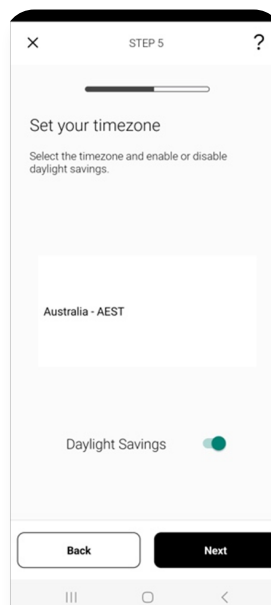

7 Select Timezone

Choose Time zone and if applicable toggle on Daylight savings.

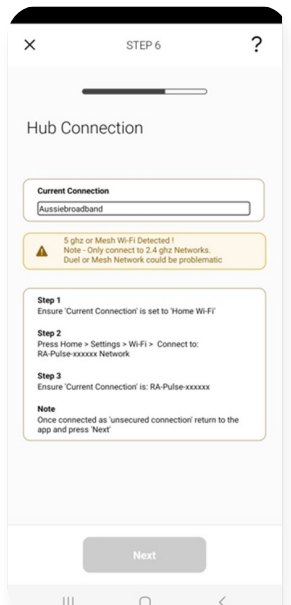

8 Connection

Ensure the Wi-Fi that you going to use is displayed in current connection.

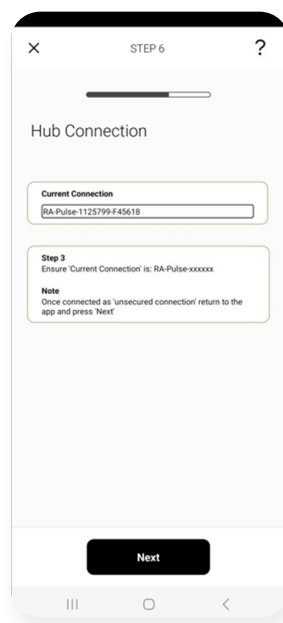

9 Connection

Go to WIFI Settings of your phone, find and select RA-Pulse Network.



9a Connection

After selecting RA-Pulse Network, Come back to the app and ensure that current connection is now RA-Pulse and press Next.



10 Connection

Confirm the serial number on the hub matched the current connection.

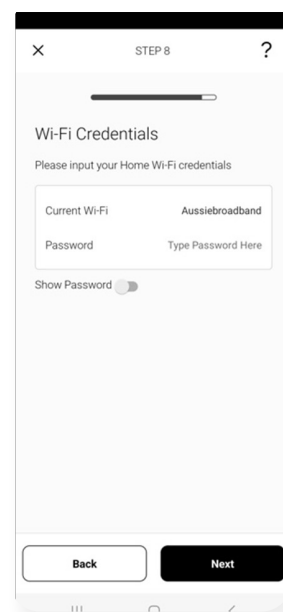

11 Credentials

Now enter the current Wi-Fi credentials carefully and select next.



12 Connection

Ensure current connection is Home WIFI and press Next.

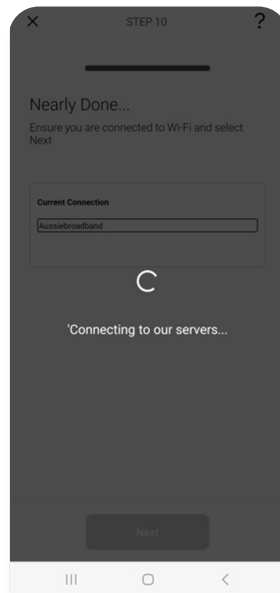

13 Cloud Sync

Connecting

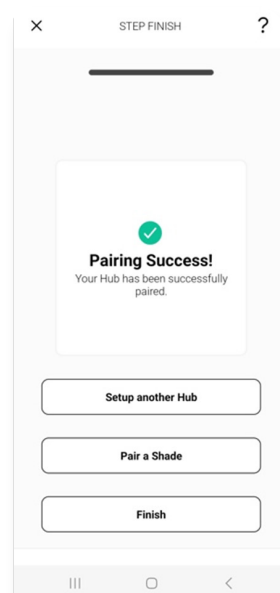

14 Success

Complete. Now pair another hub or start adding shades.

CREATING A LOCATION

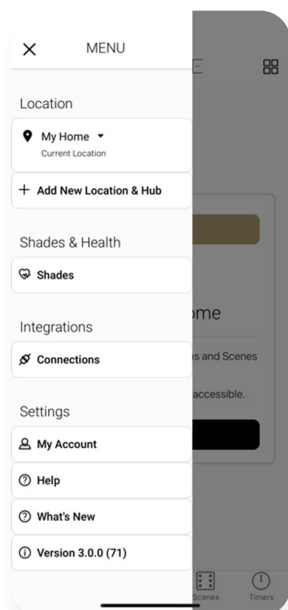

1 Add Location

Open the App from the home screen and select the menu button, click "ADD NEW LOCATION and HUB".

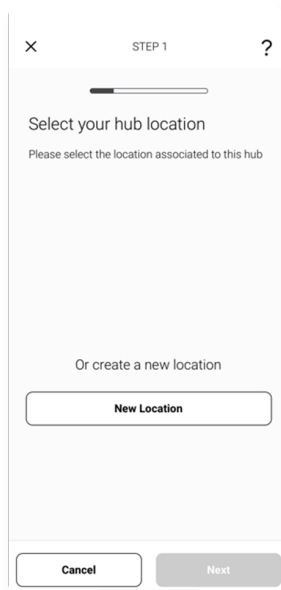

2 Add Location

Select new location and press next.

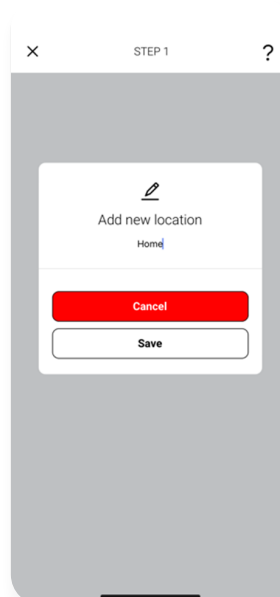

3 Update Name

Change Description of the Location.

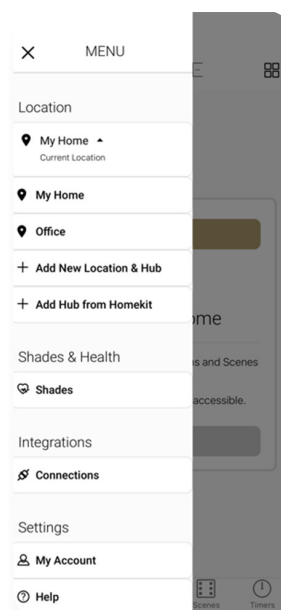

4 Toggle

Select the location icon, and Long press the location to change the locations.

HOW TO PAIR A MOTOR TO THE APP

During the setup, the hub may need to be moved room to room during the pairing process. We recommend setting up your motors with a remote prior to syncing with the App

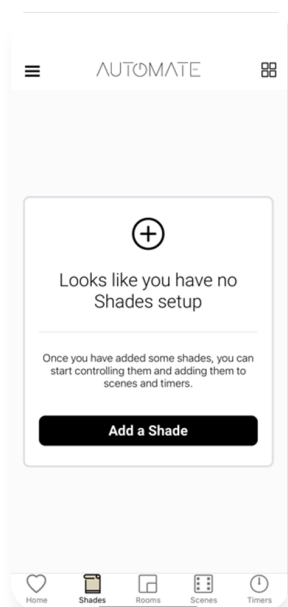

1 Add New Shade

On the Shades screen select the 'Plus' icon to add a new shade.

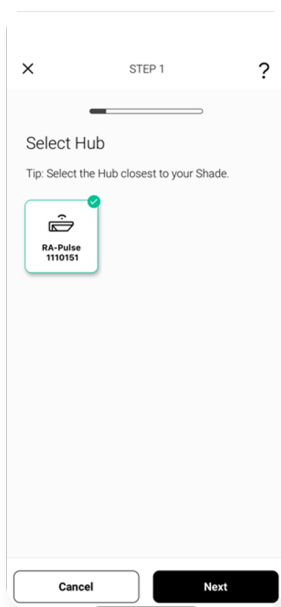

2 Select hub

From the list select the HUB you wish to pair the motor too.

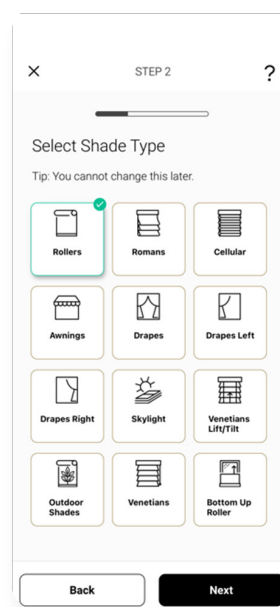

3 Device Type

Select which device type best represents your shade.. (NOTE this can't be changed later).

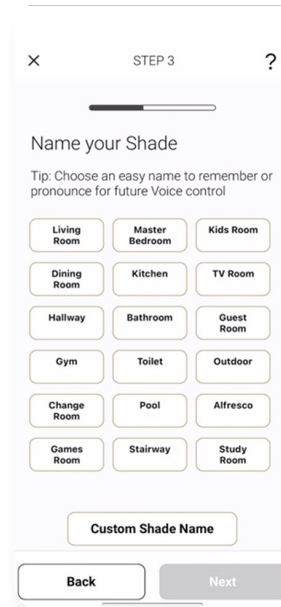

4 Name Shade

Select the shade name from the list or create a custom name. Press next.