

LifeControl

Reduce your Frustration

Quick Start Guide

WWW.LIFECONTROLS.NET

Life Controls LLC

FCC Identifier: 2AGDQLC01

IC Number: 20975-LC01

“NOTE: THE GRANTEE IS NOT RESPONSIBLE FOR ANY CHANGES OR MODIFICATIONS NOT EXPRESSLY APPROVED BY THE PARTY RESPONSIBLE FOR COMPLIANCE. SUCH MODIFICATIONS COULD VOID THE USER'S AUTHORITY TO OPERATE THE EQUIPMENT. “

Product Overview

- Package Contents
- LifeControl Key
- LifeControl USB Lock
- One CR2032 Battery

Description

- The LifeControl is a lock and Key system for your computer. Using the LifeControl software and associated Hardware, the user can automatically lock or unlock his/her computer based on the proximity of the key fob to the USB lock.

LifeControl Key

- Size: 41mm x 33mm x 17mm
- CR2032 battery (replaceable)
- Expected battery life 3-6 months
- Range: Up to 30 feet

LifeControl USB Lock

- 19mm x 13mm x 6mm
- Compatible with USB 4.0

LifeControl Software

- Windows 7, 8, 8.1, 10

FCC Statement

This device complies with Part 15 of the FCC Rules. Operation is subject to the following conditions: (1) This device may not cause harmful interference, and (2) This device must accept any interference received, Including interference that may cause undesired operation.

Important Safety Instruction

1. Do not drop, place, or submerge product into water or any other liquid.
 2. Use this unit only as intended in this manual.
 3. Do not operate this unit if damaged.
 4. Do not attempt to disassemble or attempt to repair this unit.
 5. Changes or modifications of this product are not authorized by
 - a. LifeControls, LLC
 6. Download the latest Firmware from www.lifecontrols.net/download
- All safety and operating instructions should be read, adhered to and followed before the unit is operated.

Quick Start

Powering up the LifeControl Key

- Open the LifeControl Key case using a small coin.
- Install the battery into the printed circuit board.
- Install the printed circuit board, battery down into the slotted half of the LifeControl Key case.
- Snap both side of the LifeControl Key case together.

LifeControl Software

- Create an active account with LifeControls by calling (610) 922-8890.
- Once you have created an account go to lifecontrolweb.cloudapp.net And log into your management console to download software.
- Follow [install management console/guide](#).
- Install software on all PC you would like your LifeControl Key to be enabled.
- The enabled computers will now lock and unlock based on your proximity settings
- The Key connect and disconnect range can be configured in the settings tab of the management console.
- Detailed user instructions can be found in the management console guide.

WWW.LIFECONTROLS.NET
Life Controls LLC

LifeControl

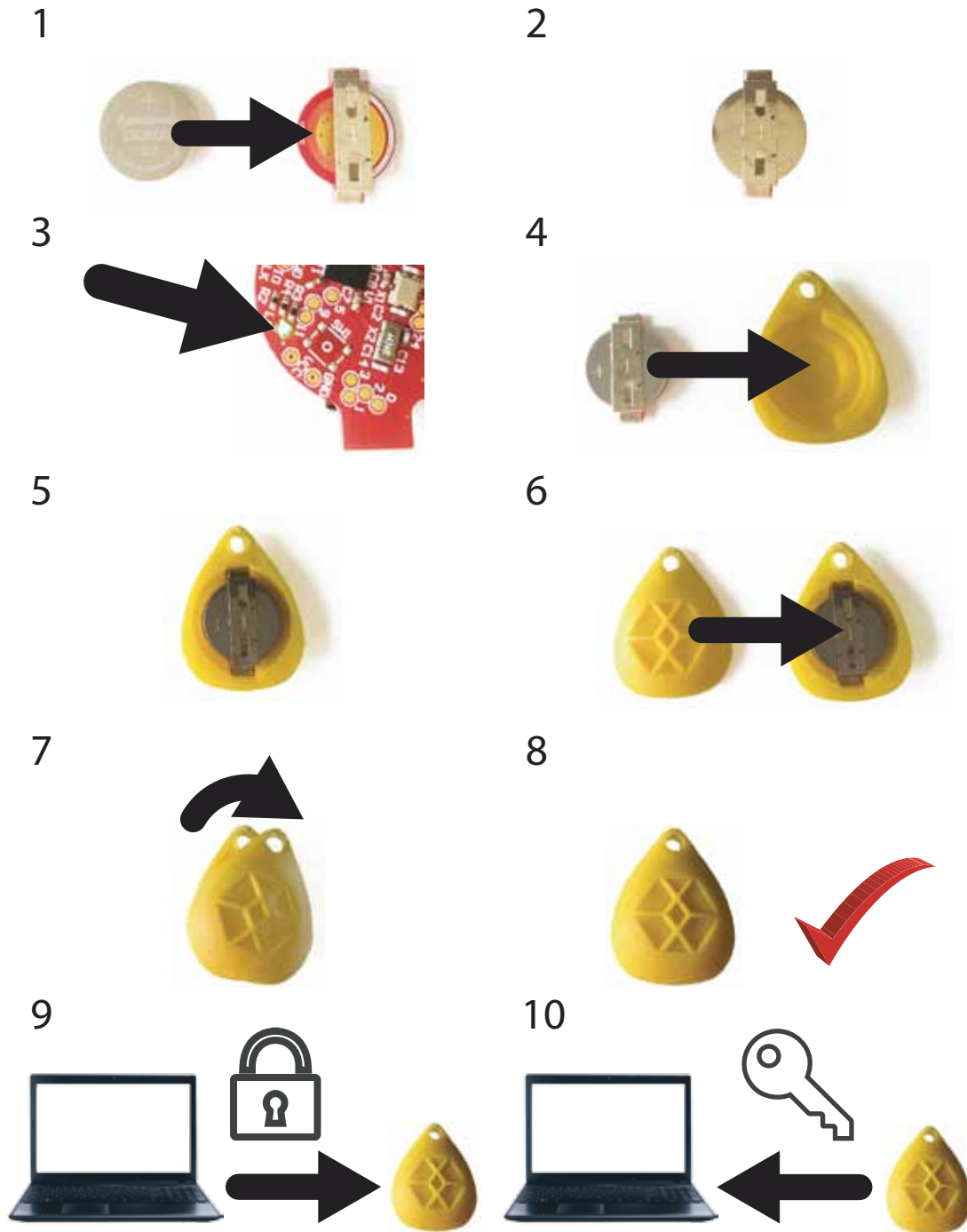

FCC Part 15

This device complies with FCC Rules Part 15 operation is subject to the following two conditions:

1. This device may not cause harmful interference.
2. This device must accept any interference, including interference that may cause undesired operation of the device.

Industry Canada Notifications

This device complies with Industry Canada's license-exempt RSSs. Operation is subject to the following two conditions:

- (1) This device may not cause interference; and
 - (2) This device must accept any interference, including interference that may cause undesired operation of the device.
- Le présent appareil est conforme aux CNR d'Industrie Canada applicables aux appareils radio exempts de licence. L'exploitation est autorisée aux deux conditions suivantes:
- (1) l'appareil ne doit pas produire de brouillage;
 - (2) l'utilisateur de l'appareil doit accepter tout brouillage radioélectrique subi, même si le brouillage est susceptible d'en compromettre le fonctionnement.

"NOTE: THE GRANTEE IS NOT RESPONSIBLE FOR ANY CHANGES OR MODIFICATIONS NOT EXPRESSLY APPROVED BY THE PARTY RESPONSIBLE FOR COMPLIANCE. SUCH MODIFICATIONS COULD VOID THE USER'S AUTHORITY TO OPERATE THE EQUIPMENT."