

User Manual

【Product Appearance】

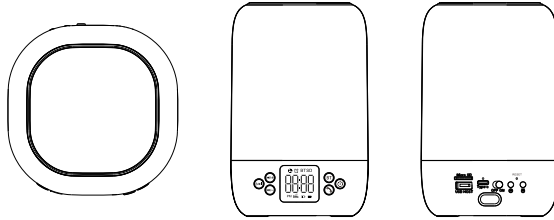

【Operation Instruction】

1. "⌚" KEY: Enter sleep timer mode settings . press and hold to enter sleep helper mode.
2. "☎" KEY: Press to answer calling. Press twice to fast call back the recent call.
3. "⏮/+ " KEY: Press to increase the volume.Press and hold to play the next song
In sleep helper mode, Press and hold to changer sleep helper sounds.
4. "⏭/- " KEY: Press to decrease the volume.Press and hold to play the previous song.In sleep helper mode. Press and hold to change sleep helper sounds.
5. "BT " KEY: Enter the Bluetooth mode, there will be a prompt tone for successful connection and disconnection.
6. "⏮/+ " KEY: In Bluetooth mode and MP3 mode, Press and hold to play/pause.
In any mode, press and hold to turn off the speaker ,press to turn on the speaker

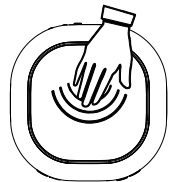
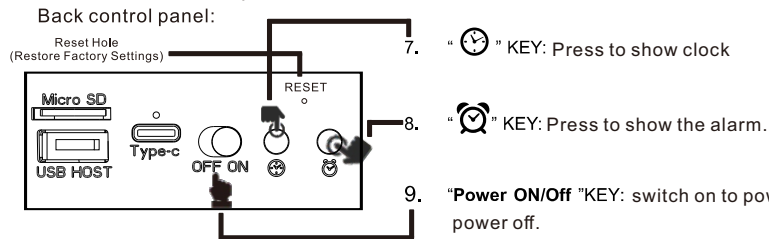

- "Speaker mesh" : Touch speaker mesh to wake up the speaker or adjust the night light.
Bluetooth mode is disconnected for 5 minutes, and the software shuts down after 2 minutes in clock mode.
*SLEEP timer turn off the speaker without the nightlight. Touch speaker mesh or press "⏮/+ " / "⌚ " key to turn on the speaker.

【Device power supply and Charging instructions】

1. USB DC 5V power supply.
2. Built in Rechargeable Lithium Battery(Not removable).
3. When charging, connect a 5V charger to the Type-c charging port of the Speaker, and the red LED indicator lights up. When the battery is full, the green LED indicator light up.

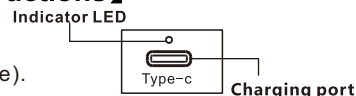

4. If unused the speaker for more than one month, please recharge it every month to keep the Lithium Battery be activity.
- 5.If speaker doesn't use within two and there months in avoid of battery over discharge or battery leakage problems, please check the Lithium Battery before using.
6. Battery status indicator show



【LIGHT FUNCTION INSTRUCTION】

Touch "speaker mesh" to control the night light

- 1.Touch The white LOW light (Soft and comfortable,about 30% brightness value.)
- 2.Touch The white MIDDLE light (Appropriate,about 60% brightness value.)
- 3.Touch The white HIGH light (about 100% brightness value.)
- 4.Touch Magic lights (lights will change color with the change of volume and rhythm and will flash once every magic state)

Touch the speaker mesh for a long time, and the light color will start to change automatically.
When you encounter a favorite color, you can let go and customize the light color.

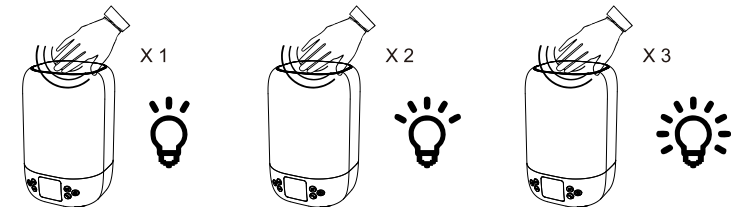

【CLOCK MODE】

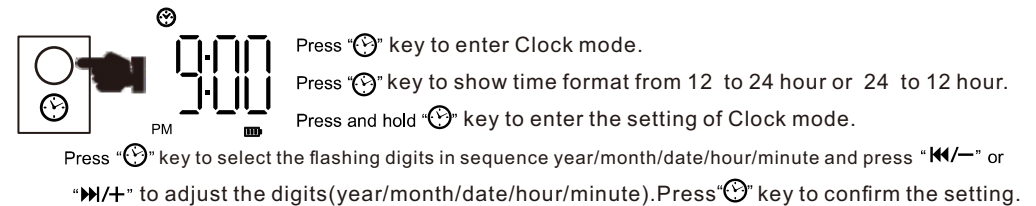

【ALARM MODE】

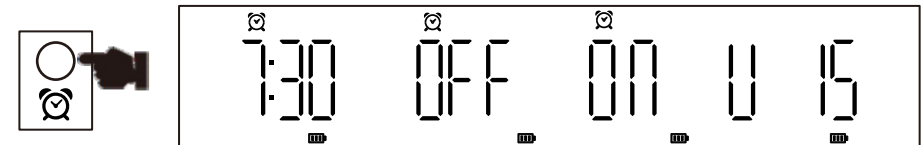

Press the "🔔" key to complete the setting and enter to select the alarm switch setting.

Press "⏮/-" or "⏭/+" to select "ON" alarm clock on, or "OFF" alarm clock off.

then enter the alarm volume setting, press the "⏮/-" "⏭/+" key to adjust the volume.

Press the "🔔" key to confirm and complete all settings. When the alarm alerts, the white light will gradually turn on.

Touch "Speaker mesh" to turn on the snooze function (The snooze function is twice, with an interval of 5 minutes each time) double-click "Speaker mesh" Or press any key to turn off the alarm.

* If use Mp3 file inside TF card for alarm sound, the User make directory named as Alarm and store one Mp3 file inside the alarm directory. Then insert TF card in the speaker.

【BLUETOOTH MODE】

Press "BT" key to enter Bluetooth Mode.

Music playing mode



Press "⏮/⏭" key to play/pause the song.

Press "⏭/+" key to increase the volume. Press and hold "⏭/+" key to play the next song.

Press "⏮/-" key to decrease the volume. Press and hold "⏮/-" key to play the previous song.

* User also can use Mobile phone to control the multimedia speaker.

Handset and Hands-free MODE

Press "📞" key to answer a call. Press "📞" key to hang up the call.

How to connect speaker by Bluetooth

* Firstly, user turn on Bluetooth device in the call phone / MID/computer and select the device name as "DY20" to connect. After connected, user hear the indicated sound. When return Bluetooth mode, Bluetooth speaker and Mobile phone will paired automatically.

【MP3 PLAYER MODE】

Inserted TF card/U disk to enter Mp3 player Mode.

Press "⏮/⏭" key to play/pause the song.



Press "⏭/+" key to increase the volume. Press and hold "⏭/+" key to play the next song.

Press "⏮/-" key to decrease the volume. Press and hold "⏮/-" key to play the previous song.

【SLEEP TIMER】

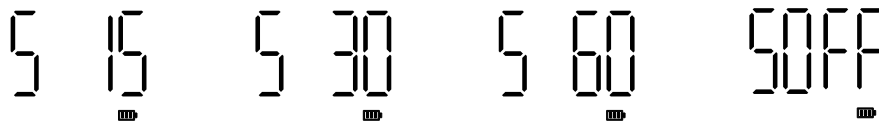

Press "🕒" key to select the indicator light in sequence 15 min, 30 min, 60min be set the count time

SOFF: Sleep timer is off



* After 15mins/30mins/60mins, the speaker and the night light will be turned off.

* Next time you will want to use sleep timer. Please follow to do the above procedure again.

【SLEEP HELPER MODE】

The speaker with sleep helper "🛏️" is operated by IR remote control. This speaker has a variety of sleep helper sound for selection:

Sound of the waves "🌊", Sound of bugs "🐛",
Burning sound "🔥", White noise "🌀", Sound of
thunderstorm "⚡", Sound of water "💧", Sound of
the wind "💨", Lullaby "🎵", Bird chirping "🐦"



Press and Hold "🕒" enter sleep helper mode

Press and Hold up or down key to select the sound of the sleep helper. Press up or down key to adjust

the volume of the sleep helper, and press play/pause key to play or pause the sleep helper.

* The ideal distance of the remote control is 2 meters.

【FAQ】

No power	Check Lithium Rechargeable Battery which has power or not Check DC5V Plug which is plugged properly
No sound or Sound distortion	Check the level of volume which is not on zero status Check music file which is damaged or not. The damaged music file produce sound distortion and cannot played. Please keep the good music files. Check Lithium Rechargeable Battery which is not enough power.
Device hang up	Use <1mm stick to press and hold reset key inside hole between time set key and alarm set key. Switch OFF the power then Switch ON the power again or After Charging, Switch ON the power once again.

【Specification】

Display	LED	
Built in lithium Rechargeable Battery	Play time : Max 4-5 Hours *According to the level of Volume	
MP3	Output power	20W
	MP3 Bit Rate	8K bps – 320K bps
	Signal noise Ratio(SNR)	85dB
	Signal Distortion	<0.55%
Music Format	MP3	
Operation temperature	-5 to 40 Celsius Degree	

* The appearance, function and specification of the product may change
The company reserves the right of final interpretation

FCC Warning Statement

Changes or modifications not expressly approved by the party responsible for compliance could void the user's authority to operate the equipment. This equipment has been tested and found to comply with the limits for a Class B digital device, pursuant to Part 15 of the FCC Rules. These limits are designed to provide reasonable protection against harmful interference in a residential installation. This equipment generates uses and can radiate radio frequency energy and, if not installed and used in accordance with the instructions, may cause harmful interference to radio communications. However, there is no guarantee that interference will not occur in a particular installation. If this equipment does cause harmful interference to radio or television reception, which can be determined by turning the equipment off and on, the user is encouraged to try to correct the interference by one or more of the following measures:

- - Reorient or relocate the receiving antenna.
- - Increase the separation between the equipment and receiver.
- - Connect the equipment into an outlet on a circuit different from that to which the receiver is connected.
- - Consult the dealer or an experienced radio/TV technician for help.

This device complies with part 15 of the FCC Rules. Operation is subject to the following two conditions: (1) This device may not cause harmful interference, and (2) this device must accept any interference received, including interference that may cause undesired operation.

The device has been evaluated to meet general RF exposure requirement. The device can be used in portable exposure condition without restriction.