

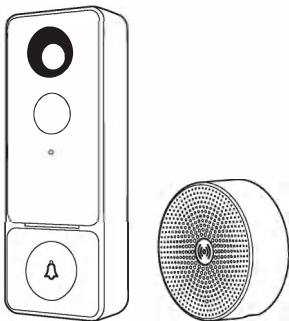

# MEARI

## Smart Wi-Fi Video Doorbell

### Bell 24T



### Quick Start Guide

# What's in the Box

Please consult this checklist for all parts.

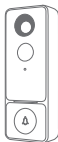

Doorbell X1



Chime X1



Power cable X1



Screw package X1



\* Bracket removing tool X1



Double-sided tape X1



Quick start guide X1

\* Bracket removing tool is used for taking doorbell off of bracket.  
Please keep it carefully.

# Description

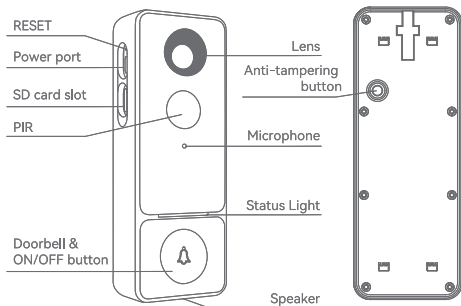

## Doorbell

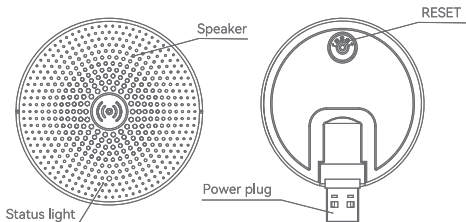

Name	Description
Power supply	DC 5V/1A
Status light	<ul style="list-style-type: none"><li>● Solid red: Network malfunction</li><li>● Blinking red slowly: Waiting for network connection</li><li>● Blinking red fast: Connecting the network</li><li>● ● Solid blue: Functioning properly</li></ul>
SD card slot	SD card storage (up to 256GB)
RESET	Press and hold the button for 3 seconds to reset the device (all settings will be restored to factory defaults)
Doorbell button	Press the button to activate the doorbell; Press and hold the button for 5 seconds to turn off the device and press again to wake up the device
Anti-tampering button	An alarm will sound when the doorbell is removed from the bracket. If needed, please turn off the anti-tampering function in the App in advance

## Chime



Name	Description
Power supply	DC5V±10%
Status light	 Blinking blue: Waiting for configuration  Solid blue: Configuration completed
RESET	Press and hold the button for 3 seconds to reset the device (all settings will be restored to factory defaults); Press the button to pair with the doorbell

# Get the App

## 1 Download App

- **If you are new to Meari**

Meari is available for both iOS and Android. Search for "Meari" in App Store or Google Play, or scan the QR Code to download the App.

You can select the App according to needs.



Download App (iOS & Android)

- **If you have already an account**

Skip this section.

Note: Support



iOS



Android

## 2 Set up router

The device supports only 2.4GHz Wi-Fi (5GHz Wi-Fi is not supported).

Ensure your router is set to 2.4GHz Wi-Fi and you have the SSID and password.

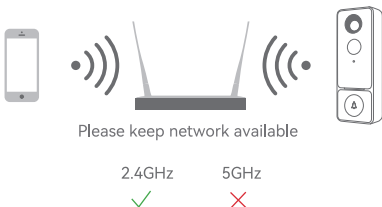

**Note:** Device supports 2.4GHz Wi-Fi network only.

The length of the Wi-Fi SSID and password should not exceed 24 characters.

If your device has trouble connecting to the Wi-Fi network, or if you wish to switch networks, press and hold the RESET button for 5 seconds to reset the device.

# Registration

Note: The app interface may vary due to version updates. Please check the App Store for the latest updates.

## 1 Sign up

Open the App, and tap **Sign up** to register.

If you already have an account, tap **Log In** to access it.

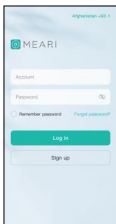

## 2 Complete registration

Enter a valid email address, agree to the privacy agreement, then set your nickname and password.

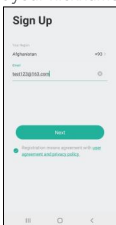

Note: Before creating a new account, please read the [Privacy Policy](#) and [Terms of Use](#) carefully.

# Add Device

## 1 Activate the doorbell

Press the doorbell button to activate the doorbell.

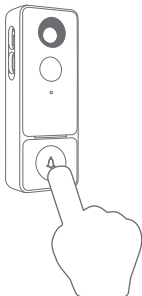



## 2 Pair doorbell to the App

### Pairing method 1

- a. Enable Bluetooth on your phone.
- b. In the App, tap **Add Device** or **+ > Add Device**. The device will be searched for via Bluetooth and appear on the screen. Follow the on-screen instructions to complete pairing.

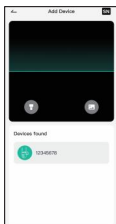

- c. Complete the network configuration.

## Pairing method 2

- a. In the App, tap **Add Device** or **+ > Add Device**. Scan the QR code located on the device casing.

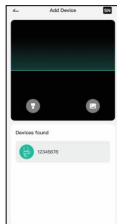
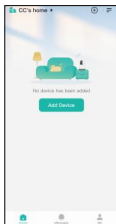

- b. Reset the device and ensure a stable Wi-Fi connection.

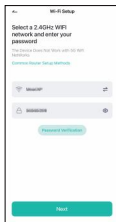

- c. Complete the network configuration.

### Pairing method 3

a. In the App, tap **Add Device** or **+ > Add Device**. Select the icon according to actual camera.

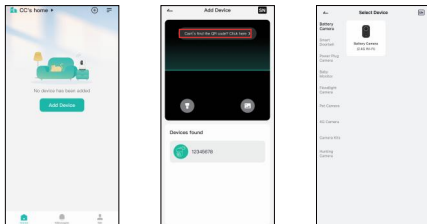

b. Reset the device and ensure a stable Wi-Fi connection.

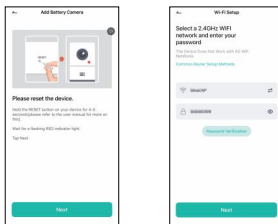

- c. Use the device to scan the QR code displayed in the App on your phone. Place your router, phone, and device close together for best connectivity.

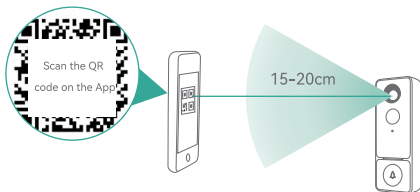

- d. Complete the network configuration.

# Pair Chime

Note: Doorbell and chime have been configured before leaving the factory, If the chime isn't paired by default, please use the following instructions to pair it manually with the doorbell.

## Pairing method 1: pair via pressing ringing button

a. Supply power to chime.

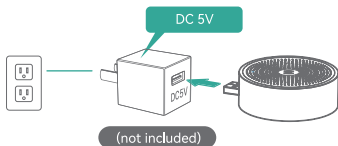

b. Press the RESET button of chime. Status light flahing blinking blue indicates the chime enters the configuration mode.

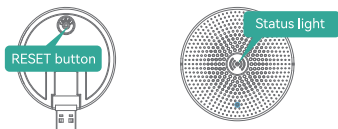

c. Press the doorbell button, and the chime will sound to react. The chime status light will be in solid blue when pairing succeeds.

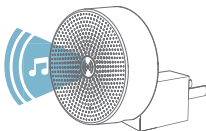

## Pairing method 2: pair via App

- a. Press the RESET button of chime. Status light flashing blinking blue indicates the chime enters the configuration mode.
- b. In the App, tap **Settings > Chime Setting**.
- c. Select **Wireless Chime**, and tap **Chime Pairing**, and confirm the status light of chime blinks blue.
- d. Tap Pair and the chime will automatically pair with the doorbell.

**Note:** If the configuration fails, please press the RESET button for 5 seconds to reset your chime and Press the RESET button, then add it again.

# Installation

## 1 SD card installation (optional)

Insert the SD card (sold separately) into the SD card slot.

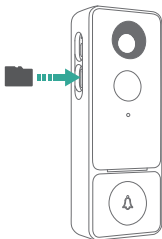

## 2 Remove the bracket of doorbell

- On the live view interface of APP, turn off tamper alarm function.
- Insert the bracket removing tool into the slot with red box in the picture above, and the bracket will pop out automatically.

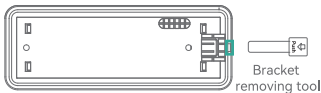

### 3 Bracket Installation

#### Method 1: screws

- Install the bracket to the wall with screws.
- Align the doorbell to the bracket.
- Push the doorbell down firmly until it is secure.

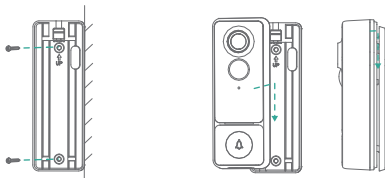

#### Method 2: tape

- Remove the film from one side of the tape and stick to the red area in the picture above.
- Once adhered, removed the film from the other side of the tape and stick to the wall.

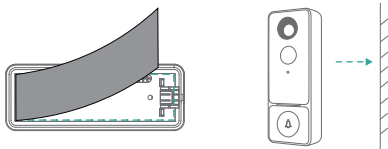



# Live View

Note: The app interface may vary due to version updates. Please check the App Store for the latest updates.

Open the App to view live feed, take snapshots, talk, record videos, and use other functions as needed.

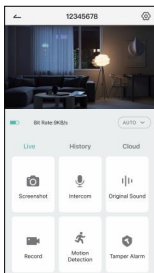

## Charging

If you are not using a power cable for power, the App will show a reminder when the battery is low.

Connect the device to an outlet (DC 5V/1A) using the power cable.

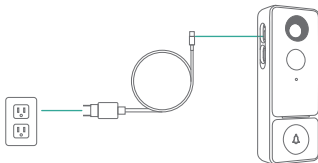

## FAQs

Q: The device cannot be previewed properly?

A: Check if the Wi-Fi network signal is strong.

If not, it is recommended to place the device closer to the router or reset the device and add it to the App again.

Q: Why is the device still in the list of devices after resetting?

A: What the device resets are the network settings only. To completely remove the device, please launch the App and delete your device.

Q: How to switch the Wi-Fi network to another one?

A: First, remove the device from the list and reset the device. Then, connect your phone to the target Wi-Fi network and then add the device to the App again.

Q: Why doesn't the device recognize the SD card?

A: It is recommended to insert the SD card after power is cut. Confirm whether the SD card is normally available and the format is FAT32. The SD card can't be recognized when the Internet environment is not good.

Q: Why I can't get the notifications with App?

A: Please confirm that the App has been running on the phone, and the relevant reminder function has been enabled. Also, please confirm the message notification and authority confirmation of the phone system have been enabled.

## Tech Specs

Model: B1	
Resolution	1984(H) x 1488(V)
Field of view	85°/65°/105°
IR distance	Up to 10 m (32.8 ft)
Working temp	-10°C to 50°C
Local storage	SD card (up to 256GB)
Input power	DC 5V / 1A
Consumption	Up to 2W
Capacity	5200mAh rechargeable Li battery
Supported phone OS	iOS 9 / Android 5.0 or later
Bluetooth	2400-2483.5MHz (Max. power<20dBm)
SRD	433MHz (Max. power<10dBm )
2.4GHz Wi-Fi	2412-2472MHz (Max. power<20dBm ) (For CE)
	2412-2462MHz (Max. power<30dBm ) (For FCC)

# Certifications



Don't throw batteries or out of order products with the household waste (garbage). The dangerous substances that they are likely to include may harm health or the environment. Make your retailer take back these products or use the selective collect of garbage proposed by your city.



Hereby, we declare that the radio equipment type 'B1' is in compliance with the Directive 2014/53/EU.

The full test of the EU declaration of conformity is available at the following Internet address: <http://www.meari.com>

## Specific precautions for EMC

This is a Class B product, in a domestic environment, this product may cause radio interference, in which case the user may be required to take adequate measures.

## RF EXPOSURE INFORMATION

This device meets the EU requirements (2014/53/EU) on the limitation of exposure of the general public to electromagnetic fields by way of health protection.

## **BATTERY SAFETY**

1. Your device contains a rechargeable lithium-ion battery and should be replaced only by a qualified service provider. Do not disassemble, open, crush, bend, deform, puncture, shred or attempt to access the battery in your device.
2. Do not modify or remanufacture the battery, attempt to insert foreign objects into the battery, or immerse or expose it to water or other liquids, expose to fire, explosion or other hazard.
3. DO NOT use a battery if its case appears damaged, swollen, or compromised. Examples include, but are not limited to, leaking, odors, dents, corrosion, rust, cracks, swelling, melting, and scratches.
4. Do not put the battery in trash that is disposed of in landfills. When disposing of the battery, comply with local ordinances or regulations.

## **Power Adapter Safety**

1. The power plug is intended to serve as a disconnect device. Do not drop or cause an impact to the power adapter.
2. If the power cable is damaged (for example, the cord is exposed or broken), or the plug loosens, stop using it at once. Continued use may lead to electric shocks, short circuits, or fire.
3. Do not touch the device or the power adapter with wet hands. Doing so may lead to short circuits, malfunctions, or electric shocks.

## **Child's Safety**

1. Comply with all precautions with regard to child's safety. Letting children play with the device or its accessories may be dangerous.
2. The device and its accessories are not intended for use by children. Children should only use the device with adult supervision.

## **Operation Requirements**

1. Use the device under allowed humidity and temperature conditions.
2. Do not aim the device at strong light sources (such as lamplight, and sunlight) when focusing it, to avoid reducing the lifespan of the CMOS sensor, and causing overbrightness and flickering.
3. Observe local laws and regulations, and respect the privacy and legal rights of others.

## Industry Canada (ISED) Compliance Statement

This device complies with Industry Canada's licence-exempt RSS(s). Operation is subject to the following two conditions:

- (1) This device may not cause interference; and
- (2) This device must accept any interference, including interference that may cause undesired operation of the device.

Le présent appareil est conforme aux CNR d'Industrie Canada applicables aux appareils radio exempts de licence. L'exploitation est autorisée aux deux conditions suivantes :

- (1) l'appareil ne doit pas produire de brouillage;
- (2) l'utilisateur de l'appareil doit accepter tout brouillage radioélectrique subi, même si le brouillage est susceptible d'en compromettre le fonctionnement.

The device meets the exemption from the routine evaluation limits in section 2.5 of RSS 102 and compliance with RSS-102 RF exposure, users can obtain Canadian information on RF exposure and compliance.

Le dispositif rencontre l'exemption des limites courantes d'évaluation dans la section 2.5 de RSS 102 et la conformité à l'exposition de RSS-102 rf, utilisateurs peut obtenir l'information canadienne sur l'exposition et la conformité de rf.

This transmitter must not be co-located or operating in conjunction with any other antenna or transmitter. This equipment should be installed and operated with a minimum distance of 20 centimeters between the radiator and your body.

Cet émetteur ne doit pas être Co-placé ou ne fonctionnant en même temps qu'aucune autre antenne ou émetteur. Cet équipement devrait être installé et actionné avec une distance minimum de 20 centimètres entre le radiateur et votre corps.

### **FCC Statement**

This equipment has been tested and found to comply with the limits for a Class B digital device, pursuant to part 15 of the FCC Rules. These limits are designed to provide reasonable protection against harmful interference in a residential installation. This equipment generates, uses and can radiate radio frequency energy and, if not installed and used in accordance with the instructions, may cause harmful interference to radio communications. However, there is no guarantee that interference will not occur in a particular installation. If this equipment does cause harmful interference to radio or television reception, which can be determined by turning the equipment off and on, the user is encouraged to try to correct the interference by one or more of the following measures:

- Reorient or relocate the receiving antenna.
- Increase the separation between the equipment and receiver.
- Connect the equipment into an outlet on a circuit different from that to which the receiver is connected.
- Consult the dealer or an experienced radio/TV technician for help.

### **RF EXPOSURE WARNING**

FCC Radiation Exposure Statement: This device complies with FCC radiation exposure limits set forth for an uncontrolled environment and it also complies with Part 15 of the FCC RF Rules. This equipment must be installed and operated in accordance with provided instructions and the antenna(s) used for this transmitter must be installed to provide a separation distance of at least 20 cm from all persons and must not be co-located or operating in conjunction with any other antenna or transmitter. End-users and installers must be provided with antenna installation instructions and consider removing the no-collocation statement.

This device complies with Part 15 of the FCC Rules. Operation is subject to the following two conditions: (1) this device may not cause harmful interference, and (2) this device must accept any interference received, including interference that may cause undesired operation.

### **Caution!**

Any changes or modifications not expressly approved by the party responsible for compliance could void the user's authority to operate the equipment.

© 2024. All rights reserved. All trade names are registered trademarks of respective companies. Apple, the Apple logo, iPhone are trademarks of Apple Inc. registered in the U.S. and other countries. Google, the Google logo, Android are trademarks of Google Inc. App Store is a service mark of Apple Inc. Google Play is a service mark of Google Inc.

V1.0 202409



THANK YOU FOR BUYING MEARI PRODUCT!

