

ClipTooth™ aluminum

Get a **Grip**™

USER MANUAL
www.cliptooth.com



warranty

register now to get your cliptooth warranty activated

to activate your cliptooth warranty you will need to send us an email at **warranty@cliptooth.com** **within 30 days from date of purchase** with the following information:
1. name & surname 2. where did you purchase your cliptooth from? 3. date of purchase
4. telephone number

product warranty terms

your cliptooth carries a one-year limited warranty against defects in materials and workmanship

what isn't covered

the warranty will not cover product failure because you broke it (any defect or malfunction that is caused as a result of misuse, failure to follow operating instructions, abuse, or use with improper or faulty equipment). it doesn't cover incidental damages. also, the warranty isn't any good after you open any product that isn't intended to be opened – please don't try and fix anything yourself. this warranty does not provide service or support for any of the third party products used with the cliptooth, including, but not limited to mobile phones and tablets.

documentation and making a claim

to help ensure warranty claims are for the genuine cliptooth, our warranty support department may require a receipt to complete your claim. if a receipt is required, you will be emailed requesting a copy be attached and sent to us via email to make a claim email us at **warranty@cliptooth.com** with the following details: 1. name & surname 2. where did you purchase your cliptooth from? 3. date of purchase 4. telephone number 5. what problems or defect you are experiencing with your cliptooth. we will, at our discretion, repair or replace any product that proves to be defective in material or workmanship. if your product is no longer being manufactured or is out of stock, we may replace your product with a similar or better product at our option.

contents

- 1 congratulations & thank you
- 2 what your cliptooth does
- 3 4 key features of your cliptooth
- 4 about your cliptooth
- 5 getting started
- 6 charging your cliptooth
- 7 turning your cliptooth on & off
- 8 pairing your cliptooth to your mobile device
- 9 pairing your cliptooth to a second mobile device
- 10 how to practically operate your cliptooth
- 11 using your cliptooth with 2 mobile devices
- 12 how to answer, terminate, reject and redial a call
- 13 how to adjust the volume of your cliptooth
- 14 using your cliptooth to play music from your mobile device
- 15 mobile phone theft/loss feature of cliptooth
- 16 playing audio from popular apps/gps/call services
- 17 how to wear your cliptooth
- 18 voice prompts of your cliptooth
- 19 safety, tips and how to take care of your cliptooth
- 20 battery level indicator
- 21 using siri (iphone ios) & other speech recognition applications with your cliptooth
- 22 how to reset your cliptooth
- 23 usb memory function
- 24 technical specifications
- 25 function table

1. congratulations & thank you

congratulations on purchasing your cliptooth ! cliptooth is a world first patented product that puts your safety, health & productivity first! thank you for your purchase & be sure to use your cliptooth as shown in this user manual so that you can enjoy the maximum safety and convenience benefits!

2. what your cliptooth does

- make & receive calls from your mobile device wirelessly & hands free
- listen to music & audio from your mobile device wirelessly & hands free
- single earphone, clip & bluetooth unit that allows you to clip it on your clothing, bags and other items for easy and convenient carrying and immediate accessibility when receiving a call
- 2-3 second automatic phone connect and call answer which allows you to keep your cliptooth off when not in use for infinite standby time & to conserve cliptooth & mobile phone battery life
- plays audio from popular apps and mobile services such as skype, youtube, wechat, viber, facebook chat ,facetime and qq.
- plays the audio of your gps application on your mobile phone so that you can hear all instructions for directions clearly and directly in your ear
- supports voice command/speech recognition features of your mobile device such as Siri (apple ios) and other speech recognitions applications
- multi point-can be used for 2 mobile devices simultaneously
- alert if phone is distanced from user (theft / phone forgotten)
- voice prompts for easy use
- rotating clip which doubles up as a memory stick and charging device
- cliptooth battery level indicator (iphone only)
- works with mobile phones, tablets, computers & other bluetooth enabled devices
- volume control
- play / pause / next - previous song control
- independent answer button when powered on

3. 4 Key features of your cliptooth

earpiece & clip 1 single unit

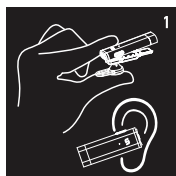

2-3 second automatic phone connect & call answer when switched ON-saves battery life

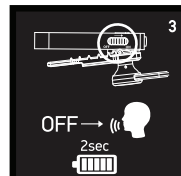

clips on clothes, bags etc for easy use and carrying

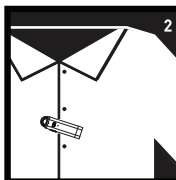

easy to use-when receiving call unclip turn ON & talk turn OFF & clip on when finished



4. about your cliptooth

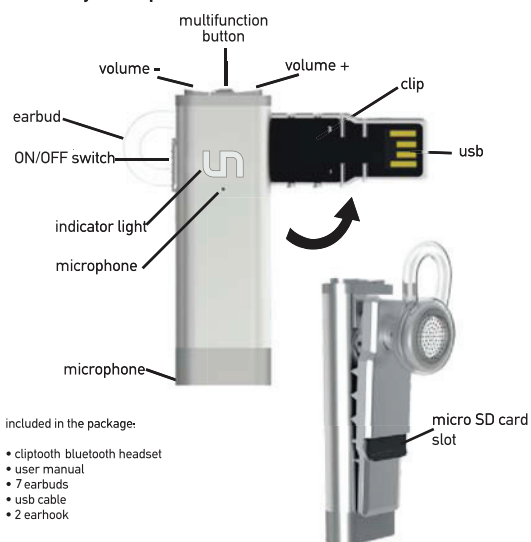

5. getting started

please attend to the following items before using your cliptooth

- charge your cliptooth (see 6 below)
- activate the bluetooth function on your mobile device (refer to the manual of your mobile device)
- pair your cliptooth with your mobile phone/mobile device (see 8 below)

6. charging your cliptooth

(please refer to the diagram in 4 above)

- make sure that the **ON/OFF switch** of your cliptooth is in the **OFF** position
- swivel the clip to the right as shown in 4. above and place the USB into the USB port of your computer or usb wall charger
- when the cliptooth starts to charge the **indicator light** will turn on with a red color
- allow the cliptooth to fully charge (+/- 2 hours). once it has fully charged the red indicator light will turn off

"IMPORTANT": the connection terminals are on one side of the USB. If you place the USB into the USB port of your computer or usb wall charger and it does not start charging (indicator light turns RED) PLEASE INSERT THE USB THE OTHER WAY AROUND SO THAT THE CONNECTION TERMINALS OF THE USB ARE MAKING CONTACT WITH THE CONNECTION TERMINALS OF YOUR USB PORT OR USB WALL CHARGER.

the lifetime of the battery will be significantly reduced if your cliptooth is left uncharged for a long period so please ensure that you recharge your cliptooth at least once a month.

7. turning your cliptooth ON & OFF

(please refer to the diagram in 4 above)

- to turn your cliptooth **ON** simply push the **ON/OFF switch** upwards to the **ON** position
- to turn your cliptooth **OFF** simply push the **ON/OFF switch** downwards to the **OFF** position

8. pairing your cliptooth to your mobile device

your cliptooth connects to mobile phones and other bluetooth enabled devices such as tablets, mp3 players, laptops & computers using a procedure called "pairing" which is simple and can be done easily and quickly by following the below steps:

- make sure the bluetooth feature of your device is turned on (refer to your mobile device user manual on how to do this) and that your mobile device and cliptooth are close to each other (10cm – 20cm)
- turn your cliptooth **ON**, the **indicator light** will start flashing red & white alternately and the **voice prompt** will say "**pairing**", your cliptooth is now ready to pair
- open the bluetooth menu of your mobile device and "search for new devices" and in a few seconds you will see "**cliptooth alu**"
- choose "**cliptooth alu**" and wait until your mobile device and your cliptooth connect. if your mobile device asks for a pass code please enter 0000. as soon as connection is achieved the **voice prompt** of your cliptooth will say "**your headset is connected**"

Note:

- make sure you complete the above steps within 3 minutes of switching your cliptooth **ON** as it remains in pairing mode for maximum 3 minutes
- repeat the above steps should pairing not be successful on your first try. sometimes it may take 2 – 3 attempts to get a successful pairing depending on the make and model of mobile phone/device you have

9. pairing your cliptooth to a second mobile device

your cliptooth can be used with 2 mobile devices simultaneously. to pair with a **second mobile device** please follow the below steps:

- after successfully pairing with your **first mobile device** as specified in 8 above turn your **first mobile device OFF** or deactivate the bluetooth feature of this device and then turn your cliptooth **OFF**.
- make sure the bluetooth feature of your **second mobile device** is turned on (refer to your mobile device user manual on how to do this) and that your **second mobile device** and cliptooth are close to each other (10cm – 20cm)
- turn your cliptooth **ON**. the **indicator light** will start flashing red & white alternately and the voice prompt will say "**pairing**", your cliptooth is now ready to pair.
- open the bluetooth menu of your **second mobile device** and "search for new devices" and in a few seconds you will see "**cliptooth alu**"
- choose "**cliptooth alu**" and wait until your **second mobile device** and your cliptooth connect. If your **second mobile device** asks for a pass code please enter 0000. as soon as connection is achieved the **voice prompt** of your cliptooth will say "**your headset is connected**"

once paired with the **second mobile device** turn your cliptooth **OFF**. then make sure that **both your mobile devices** are turned **ON** with the **bluetooth function activated**. turn your cliptooth **ON** and it will automatically connect to both mobile devices & you will hear the voice prompt "**your headset is connected**" for each time it connects with each mobile device. if one of your devices does **not automatically connect** with your cliptooth, switch your cliptooth **OFF** and then switch it back on again. if the device still does not automatically connect navigate to the bluetooth settings of this device, make sure that the bluetooth feature is activated and connect manually to your cliptooth by pressing "**cliptooth alu**" on the list of paired devices. if you **continue to have pairing problems** we suggest that you **reset your cliptooth** (see 22 below), **delete cliptooth as a device from the paired list on both your mobile devices** and then follow the steps in 8 & 9 again.

10. how to practically operate your cliptooth

your cliptooth has great unique features – the first unique feature is that the whole unit is a clip which clips on your clothes bags etc for easy carrying and immediate accessibility! the second unique feature is that when you turn it ON it automatically connects to your mobile device and automatically answers an incoming call all in approximately 2-3 seconds.

• the unique recommended practical way to use your cliptooth

make sure your cliptooth is **OFF**. clip it on your shirt, bag, clothing etc.

when **receiving a call** simply unclip, turn **ON**, place in your ear & start talking! (your cliptooth **automatically connects to your mobile device & answers your call in 2 – 3 seconds!**). when you finish your call turn your cliptooth **OFF** & clip it back on! SO EASY, SO CONVENIENT, SO SIMPLE, SO SAFE! & the great feature is that because your cliptooth is **OFF** when it is clipped on, you have **infinite standby time & you save the battery life of your cliptooth & your mobile device!**

If you want to **make a call** simply unclip, turn **ON**, place in your ear, dial or select your number and make your call! (your cliptooth **automatically connects to your mobile device in 2 – 3 seconds!**). when you finish your call turn your cliptooth **OFF** & clip it back on! SO EASY, SO CONVENIENT, SO SIMPLE, SO SAFE!

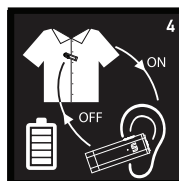

easy to use-when receiving call unclip turn **ON** & talk, turn **OFF** & clip on when finished

10. how to practically operate your cliptooth continued..

- when you are in your car we recommend that you use your cliptooth as follows:

before you start driving unclip your cliptooth, turn it **ON** and place it in your ear. it will automatically connect to your mobile phone and you will hear "**your headset is connected**". keep the cliptooth in your ear for the entire duration of your driving.

place your mobile phone on a reliable car mount so that you can clearly see the screen without having to move close to it or touch it.

when a call comes in you will hear the ringing sound through your cliptooth in your ear and you will answer by pressing the **multifunction button** (see 4 above). When your call is complete you can terminate it by pressing the **multifunction button** again.

- avoid any contact with your mobile phone whilst driving
- avoid making any calls – if it is absolutely necessary to make a call stop your car slowly in a safe area far away from any danger or traffic, dial your number and once your call is active through your cliptooth you can start driving again. be extra careful when entering traffic again. you can also make a call by using Siri (iphone ios) or other speech recognition features of your mobile device (see 21 below)
- answer only calls that are absolutely necessary – if a call comes in and you absolutely have to take it, answer it as specified above

Note: some countries prohibit using a mobile phone in the car even with a bluetooth headset so make sure you are aware of your local country laws.

your safety and the safety of others around you comes FIRST & is a priority !

when you have finished driving, take your cliptooth out of your ear, turn it OFF, clip it on your clothes, bag etc and exit your car.

11. using your cliptooth with 2 mobile devices

your cliptooth can connect to 2 mobile devices simultaneously. this allows you to use the features of your cliptooth for both devices. please follow the instructions in 8 and 9 above on how to pair and connect your cliptooth to 2 mobile devices.

12. how to answer, terminate, reject & redial a call

- **answering a call** – you can answer a call in 2 ways with your cliptooth. the first way is by simply turning it **ON**. it will automatically connect with your mobile phone and answer your call in 2-3 seconds. the second way is by simply pressing the **multifunction button** (this way requires that your cliptooth is already switched **ON** before your call comes in) see 10 above
- **terminating a call** – you can terminate a call in 2 ways with your cliptooth. the first way is by simply pressing the **multifunction button**. the second way is by pressing the end/termination button on your mobile phone
- **rejecting a call** – if your cliptooth is switched **OFF** when your call comes in you can reject it by pressing the reject button on your mobile phone. if your cliptooth is switched **ON** before your call comes in you can reject it by double pressing the **multifunction button**
- **redialing a call** – you can redial a call in 2 ways with your cliptooth. the first way is by double pressing the **multifunction button** (this way requires that your cliptooth is already switched **ON** and connected to your mobile phone). the second way is by redialing directly from your mobile phone

13. how to adjust the volume of your cliptooth

you can adjust the volume of your cliptooth during a call or whilst listening to audio/music by simply long pressing the **volume "+"** or **volume "-"**. once the volume reaches the maximum or minimum level you will hear a beep. we suggest that you also adjust the volume control directly from your mobile phone by pressing the volume buttons usually found on the side of your mobile device.

14. using your cliptooth to play music from your device

- **play music** – you can hear your music played from your mobile device on your cliptooth. make sure your cliptooth is turned **ON** and connected to your mobile device. select the song/s you want to hear and press play on your mobile device. you can pause the song by short pressing the **multifunction button** and short pressing it again to resume playback.
- **changing tracks** – you can change tracks to the next song by short pressing the **volume "+"** button and change tracks to the previous song by short pressing the **volume "-"** button
- **adjusting the volume** – see 13 above on how to adjust the volume

15. mobile phone theft/loss feature of cliptooth

your cliptooth can assist in preventing loss/theft of your mobile phone. when your cliptooth is in your ear and connected to your mobile phone it will sound an alarm saying **"beyond the range of connections"** when your mobile phone is distanced more than 8 – 10 meters from your cliptooth. this way you will know that you have either forgotten your mobile phone or it has been taken from you

16. playing audio from popular apps/gps/call services

your cliptooth allows you to hear the audio from popular apps & call services such as Skype, Viber, Facebook Chat, Wechat, QQ and FaceTime. in addition to this it allows you to hear the audio of your gps application on your mobile phone like Google Maps and Apple Maps. Simply turn it **ON**, make sure it is connected to your mobile phone and run your app/gps/call service

17. how to wear your cliptooth

- **on your body** – when not in use wear your cliptooth by simply **clipping** it on your shirt, clothes, bag etc SO EASY AND SO SIMPLE
- **on ear** - your cliptooth comes with an **earbud** and **earhook** accessory. we suggest that you place it in your ear only with the earbud and see if it positions firmly. you can also adjust the little "ear" of the **earbud** to the left or to the right which will give you a firmer hold and placement (be careful not to damage the earpiece when moving the little ear left or right). if the **earbud** is not enough for a firm placement in your ear then clip on the **earhook** and use it as well

18. voice prompts of your cliptooth

your cliptooth has voice prompt features which make it really easy to use. these voice prompts are heard under the following circumstances:

- **"power on"** – this is heard when you switch your cliptooth **ON**
- **"pairing"** – this is heard when your cliptooth is ready to pair
- **"your headset is connected"** – this is heard when your cliptooth has connected with your mobile device
- **"power off"** – this is heard when your cliptooth is switched **OFF**
- **"your headset is disconnected"** – this is heard when your cliptooth is disconnected from your mobile device
- **"beyond the range of connections"** – this is heard when your mobile device is distanced more than 8 – 10 metres from your cliptooth
- **"battery full"** – this is heard when your battery is full
- **"battery level high"** – this is heard when the battery level is high
- **"battery level medium"** – this is heard when the battery level is medium
- **"battery level low"** – this is heard when the battery level is low
- **"recharge headset"** – this is heard so you can recharge
- **"incoming call"** – this is heard on android mobile phones when there is an incoming call

19. safety, tips and how to take care of your cliptooth

- **high volume** – avoid high volume as it can lead to hearing loss. adjust the volume of your cliptooth to a comfortable level and which is not louder than needed to hear your call
- **cleaning** – clean your cliptooth with a soft dry cloth
- **water** – keep your cliptooth away from water. any contact with water will damage your cliptooth
- **storage** – do not store or use your cliptooth in temperatures below 15°C or higher than 55°C otherwise battery life will be reduced
- **usb charging clip** – swivel the clip without force to the right in order to charge
- **removal of battery** – do not attempt to remove the battery from your cliptooth, it is a built-in rechargeable battery

20. battery level indicator

the battery level of your cliptooth can be seen on the top right corner of your iOS device. note that this feature is not available on android or other mobile devices

21. using siri (iphone ios) and other speech recognition applications with your cliptooth

your cliptooth supports Siri (iphone ios) and other speech recognition applications found on your mobile device.

you can activate Siri or other speech recognition/voice command applications and give voice commands directly from your cliptooth by simply **double pressing** the **volume "+"** button

22. how to reset your cliptooth

you can reset your cliptooth by pressing **both volume + & -** buttons continuously for 5 – 7 seconds. in order for this to work your cliptooth must be on and NOT connected to your device. after resetting your cliptooth please follow the instructions and steps specified in this manual so that you can pair it with your mobile devices and start using it again. we suggest that you reset your cliptooth in the following cases:

- you have new mobile devices and want to erase all prior pairing of your cliptooth with your old mobile devices so that you can pair successfully with your new mobile devices
- your cliptooth is not functioning correctly or as specified in this manual
- your second mobile device is not successfully pairing or connecting with your cliptooth

23. usb memory function

Your cliptooth also functions as a usb memory stick. simply insert a micro sd card in the slot shown in 4. above, swivel the clip to the right and place it into the usb of your computer. note that the maximum capacity micro sd card that you can use is 32GB

24. technical specifications

- supports HSP, HFP, AZDP, AVRCP
- transmitting power : class 2
- working distance: <= 10m
- frequency range: 2.402-2.480GHz
- charging time <= 2 hours
- talk time >= 5 hours
- music time >= 4 hours
- standby time when switched ON : >=70 hours
- standby time when switched OFF: >= 1 year
- weight 10g

25. function table

| FUNCTION | FUNCTION BUTTON | | | | Voice prompt | Indicator light |
|-------------------|----------------------|------------------------|--------------|--------------|-----------------------------------|---|
| | multifunction button | switch ON/OFF | VOL + | VOL - | | |
| power ON | | switch to ON position | | | power on | white and red light flash alternately once |
| pairing | | switch to ON position | | | pairing | white and red light flash alternately quickly |
| power OFF | | switch to OFF position | | | power off | red light flashes once |
| call answer | short press | | | | "doo beep" | white light flashes once every 3 seconds |
| call reject | double short press | | | | "doo" | white light flashes once every 3 seconds |
| call terminate | short press | | | | "doo" | white light flashes once |
| voice dialing/sri | | | double press | | "doo" | white light flashes once every 3 seconds |
| call transfer | | | | double press | "doo" | red light flashes |
| last call/redial | double press | | | | "doo" | white light flashes |
| music pause | short press | | | | | white light flashes twice every 3 seconds |
| music play | short press | | | | | white light flashes once every 3 seconds |
| previous song | | | | short press | | |
| next song | | | short press | | | |
| volume increase | | | long press | | "beep" when max volume reached | |
| volume decrease | | | | long press | "doo" when minimum volume reached | |

NOTES

FCC Warning Statement

Changes or modifications not expressly approved by the party responsible for compliance could void the user's authority to operate the equipment. This equipment has been tested and found to comply with the limits for a Class B digital device, pursuant to Part 15 of the FCC Rules. These limits are designed to provide reasonable protection against harmful interference in a residential installation. This equipment generates uses and can radiate radio frequency energy and, if not installed and used in accordance with the instructions, may cause harmful interference to radio communications. However, there is no guarantee that interference will not occur in a particular installation. If this equipment does cause harmful interference to radio or television reception, which can be determined by turning the equipment off and on, the user is encouraged to try to correct the interference by one or more of the following measures:

- - Reorient or relocate the receiving antenna.
- - Increase the separation between the equipment and receiver.
- - Connect the equipment into an outlet on a circuit different from that to which the receiver is connected.
- - Consult the dealer or an experienced radio/TV technician for help.

This device complies with Part 15 of the FCC rules. Operation is subject to the following two conditions: 1) this device may not cause harmful interference, and 2) this device must accept any interference received, including interference that may cause undesired operation.

ClipToothTM

aluminum

Get a **Grip**TM

www.cliptoorth.com

