

# LightON<sup>®</sup>

## AL-LZ100-NM LON ZigBee Gateway

### <Main Function>

LON Communication

ZigBee Communication

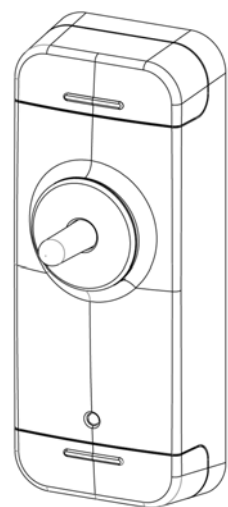

<AL-LZ100-NM>

---

## *Features*

---

AL-LZ100-NM	<ul style="list-style-type: none"><li>- Reliable and rapid control by LON communication.</li><li>- Wireless control by ZigBee communication.</li></ul>
The way of Communication	<ul style="list-style-type: none"><li>* LON communication<ul style="list-style-type: none"><li>- 78Kbps / 2 wire / Non-polarity</li><li>- Two-way communication / Event Driven</li><li>- Free Topology</li></ul></li><li>* ZigBee communication<ul style="list-style-type: none"><li>- 2.4GHz / 2Mbps</li><li>- Point to Point Repeating Function</li></ul></li></ul>
Operating Temperature	-10 °C ~ 50 °C
Operating Voltage	DC 24V

---

---

## Description

---

LightON® AL-LZ100-NM is the device which convert between the devices using ZigBee communication and the devices using LON communication.  
Through it, you can build the radio wire integration solution.

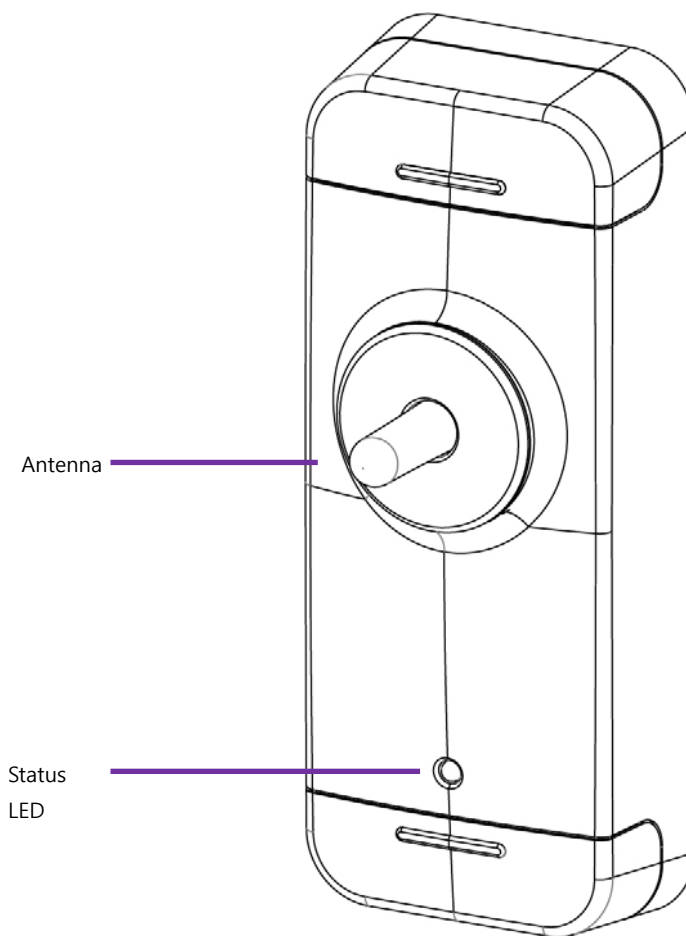

<b><i>AL-LZ100-NM</i></b>	<b>Function</b>
Antenna	Radio wave Transmit and Receive (2.4GHz/Helical Antenna)
Status LED	Indicate the current state by LED color and blinking

---

## Description of the Connection

---

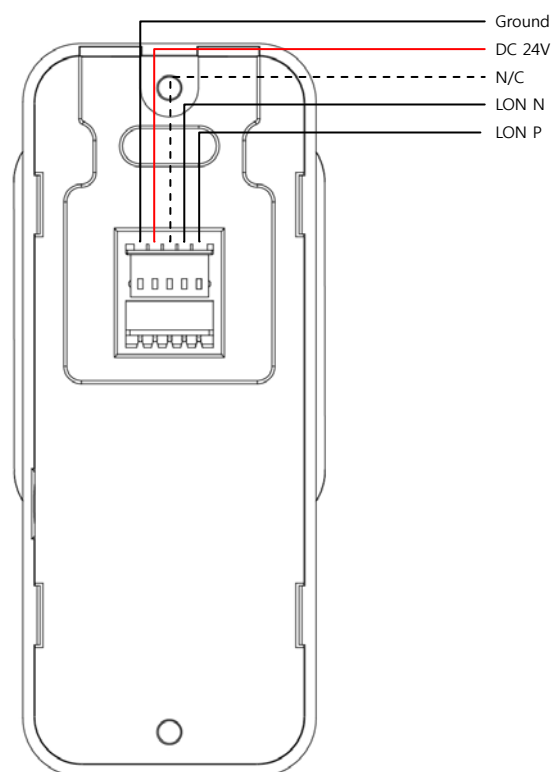

1	Input power Connection	Connect the DC Power line to the Ground and DC24V Connection Point.
2	LON Connection	<p>Connect the LON communication lines to the LON N and LON P Point.</p> <p>⚠ – In case the number of the products connecting it is few, it can be input power by LON communication line without external power (Option)</p>

---

## *Cautions*

---

### **A Warning on Self-Repairs**

This product should only be handled by an approved electrician with training about our products. For your safety, please do not try to disassemble and repair this product yourself.

### **Prohibition of Putting Foreign Materials**

This product should only be handled by an approved electrician with training about our products. For your safety, please do not try to disassemble and repair this product yourself.

Be careful not to enter the foreign materials. If any foreign materials is input, cut off the power and remove it immediately.

### **Shock Damage**

When installing this product please make sure that the main power is turned off. Please do not knock against this product with sharp or heavy objects. This may cause an electric shock or fire hazard.

---

---

## *Technical Support*

---

### **Product of ABI SYSTEMS Co., Ltd.**

- LON ZigBee Gateway
- Model Name: LightON<sup>®</sup> AL-LZ100-NM
- Input Power: DC 24V / 1A

### **Head Office**

#308 ACE Techno Tower 8, 11, Digital-ro 33-gil, Guro-gu, Seoul, 08380, Republic of KOREA

Phone : +82-2-2025-7591

Fax: +82-2-2025-7592

Email: [sales@abisys.co.kr](mailto:sales@abisys.co.kr)

Web: [www.lighton.co.kr](http://www.lighton.co.kr) / [www.abisys.co.kr](http://www.abisys.co.kr)

- ※ Information in this document, including URL, and other internet Web site references, is subject to change without notice.

## **FCC Information to User**

This equipment has been tested and found to comply with the limits for a Class B digital device, pursuant to Part 15 of the FCC Rules. These limits are designed to provide reasonable protection against harmful interference in a residential installation. This equipment generates, uses and can radiate radio frequency energy and, if not installed and used in accordance with the instructions, may cause harmful interference to radio communications. However, there is no guarantee that interference will not occur in a particular installation. If this equipment does cause harmful interference to radio or television reception, which can be determined by turning the equipment off and on, the user is encouraged to try to correct the interference by one of the following measures:

- Reorient or relocate the receiving antenna.
- Increase the separation between the equipment and receiver.
- Connect the equipment into an outlet on a circuit different from that to which the receiver is connected.
- Consult the dealer or an experienced radio/TV technician for help.

## **Caution**

Modifications not expressly approved by the party responsible for compliance could void the user's authority to operate the equipment.

**FCC Compliance Information :** This device complies with Part 15 of the FCC Rules. Operation is subject to the following two conditions: (1) This device may not cause harmful interference, and (2) this device must accept any interference received, including interference that may cause undesired operation

## **IMPORTANT NOTE:**

### **FCC RF Radiation Exposure Statement:**

This equipment complies with FCC RF radiation exposure limits set forth for an uncontrolled environment.

The antennas used for this transmitter must be installed to provide a separation distance of at least 25 cm from all persons and must not be co-located or operating in conjunction with any other antenna or transmitter.

## CAUTION

To reduce the risk of electric shock, do not remove the top cover (or the rear section).  
No user serviceable parts inside, refer servicing to qualified personnel.



This symbol, wherever it appears, alerts you to the presence of uninsulated dangerous voltage inside the enclosure-voltage that may be sufficient to constitute a risk of shock.



This symbol, wherever it appears, alerts you to the important operating and maintenance instructions in the accompanying literature. Please read the manual.

- 1) Read these instructions.
- 2) Keep these instructions.
- 3) Heed all warnings.
- 4) Follow all instructions.
- 5) Do not use this equipment near water.
- 6) Do not use near any heat sources such as radiators, heat resistors, stove, or other equipment that produce heat.

### CAUTION

**RISK OF EXPLOSION IF BATTERY IS REPLACED  
BY AN INCORRECT TYPE.  
DISPOSE OF USED BATTERIES ACCORDING  
TO THE INSTRUCTIONS**

### European CE notice to users and product statements

This product is CE marked according to the provisions of the R&TTE Directive(99/5/EC). Hereby, ABIsystems Co.,Ltd. declares that this product is in compliance with the essential requirements and other relevant provisions of Directive 1999/5/EC.

For further information, please contact [http:// www.abisys.co.kr](http://www.abisys.co.kr)

# CE1177

ABIsystems Co.,Ltd.

308 (ACE Techno Tower 8), 11, Digital-ro 33-gil, Guro-gu, Seoul, Korea

Tel: +82-2-2025-7591

Fax: +82-2-2025-7592

URL: [www.abisys.co.kr](http://www.abisys.co.kr)

## **CONTACT INFORMATION**

Manufacturer Address : 308 (ACE Techno Tower 8), 11, Digital-ro 33-gil, Guro-gu, Seoul, Korea To locate in-country ABIsystems Co.,Ltd., distributors of the ZigBee Gateway please refer to the ABIsystems Co.,Ltd.

Website <http://www.abisys.co.kr>

These distributor(s) represent local contacts for this product.

### **CORPORATE HEADQUARTERS:**

ABIsystems Co.,Ltd.

308 (ACE Techno Tower 8), 11, Digital-ro 33-gil, Guro-gu, Seoul, Korea

Tel: +82-2-2025-7591

Fax: +82-2-2025-7592

Web: <http://www.abisys.co.kr>

This device complies with Industry Canada license-exempt RSS standard(s).

Operation is Subject to the following two condition: (1) this device may not cause interference ,and (2) this device must accept any interference, including interference that may cause undesired operation of the device.



**EUROPEAN UNION “DECLARATION OF CONFORMITY”**

**DECLARATION OF CONFORMITY**

**ABIsystems Co.,Ltd.**

308 (ACE Techno Tower 8), 11, Digital-ro 33-gil, Guro-gu, Seoul, Korea

declare under our sole responsibility that the product(s)

ZigBee Gateway – AL-LZ100-NM

to which this declaration relate(s) is in conformance with the following standards:

EN 301 489-1 V1.9.2:2011

EN 301 489-17 V2.2.1:2012

EN 60950-1:2006/A2:2013

EN 300 328 V1.8.1:2012

following the provisions of the 1999/5/EC Directives.