

表

裏

BOCCO QUICK START GUIDE

What's in the box?

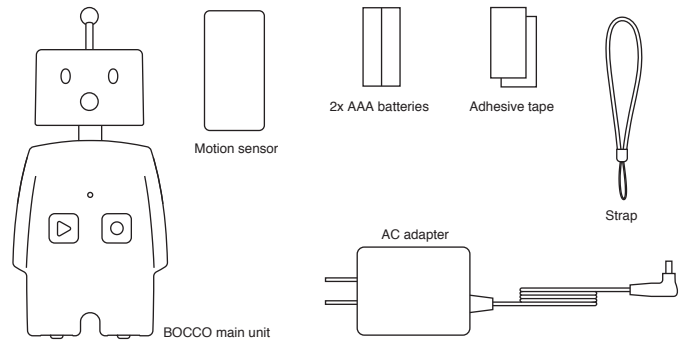

An iPhone, iPad or Android phone and Wi-Fi access point are required for using BOCCO.

Download the App



Please search for "BOCCO" in the App Store or Google Play to download the latest version of the BOCCO app.

OS Compatibility	iOS 8 or later Android 4.4
Device Compatibility	iPhone 5 / iPad Retina or later Nexus 5 / Galaxy S6 / Xperia Z4

First-time setup

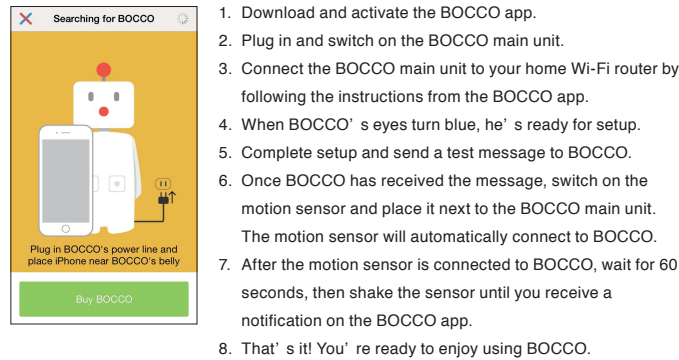

* You can find the PIN number for setup on the underside of BOCCO's foot.

How to switch on and off

BOCCO main unit

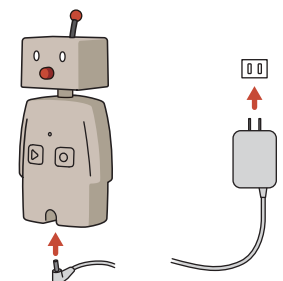

Plug the AC adaptor into the jack on the back of the BOCCO main unit, then plug the other end into an outlet. Once plugged in to a power supply, BOCCO will boot up automatically. This may take a few minutes. When setup has been completed, BOCCO will make a start-up chime and his eyes will cease blinking.

* Never disconnect the AC adapter while BOCCO is booting up. Doing so may cause the main unit to become defective.
* When restarting BOCCO, disconnect the AC adapter and wait 10 seconds before plugging it back in.

Motion sensor

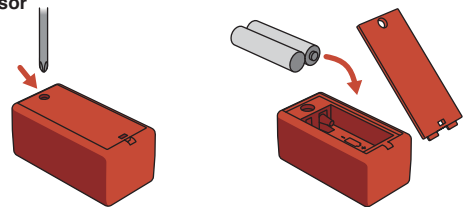

Use a cross slot screwdriver to loosen the screw on the reverse side of the motion sensor and insert the provided AAA batteries. The sensor will boot up automatically. The AAA batteries are provided for first-time setup; replacement batteries may be required for prolonged use.

* Boot up the motion sensor after completing the first-time setup of the BOCCO main unit. If the sensor does not connect to the BOCCO main unit, reboot it next to the BOCCO main unit.

BOCCO Key features

Receive a notification from the motion sensor

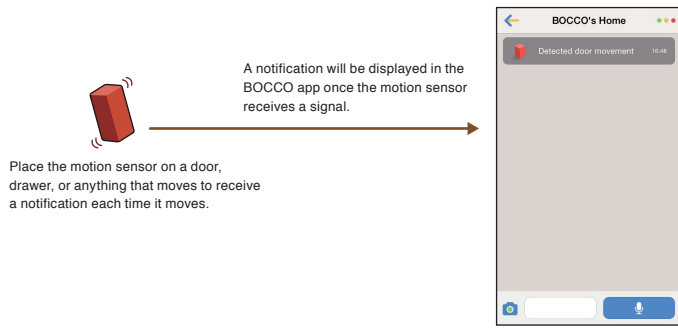

Send a voice message from BOCCO

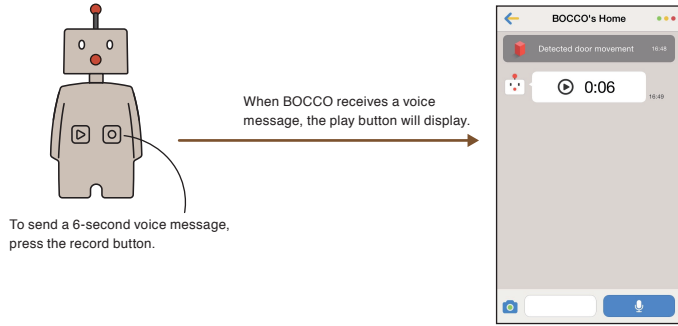

Send a voice message from the BOCCO app

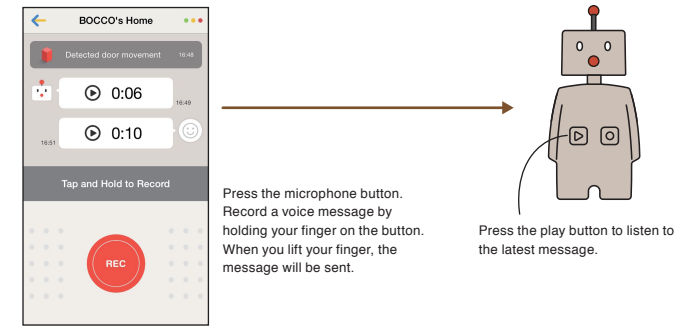

Send a text message from the BOCCO app

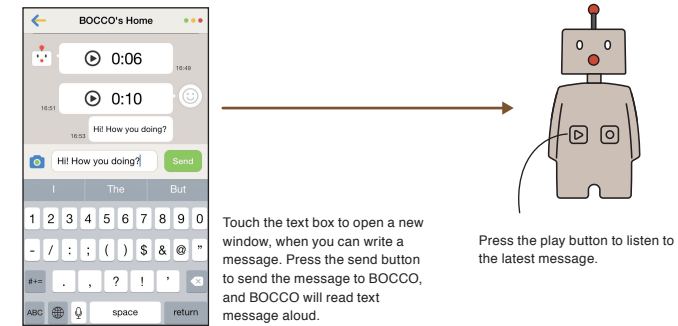

Installation location

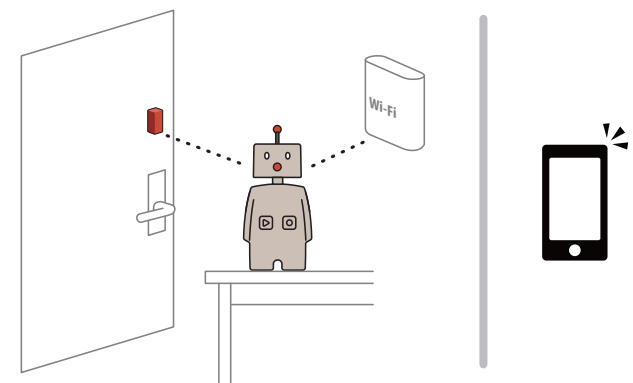

BOCCO main unit

Place the BOCCO main unit in a location where the Wi-Fi signal is strong. Avoid areas with weak signals or interference from other devices or appliances.

Motion sensor

BOCCO will send a message to the BOCCO app when the motion sensor detects motions. Place the motion sensor in the desired location of detection, such as on a door or drawer. To install the motion sensor, use the included adhesive tape or the strap. The motion sensor has an operating range of 33ft (10m), but obstructions such as walls or appliances may reduce this. Please ensure the motion sensor is within the operating range of the BOCCO main unit.

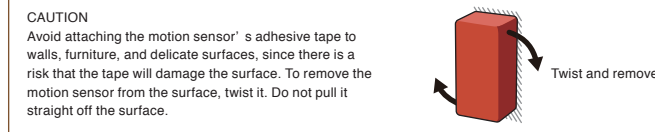

Buttons

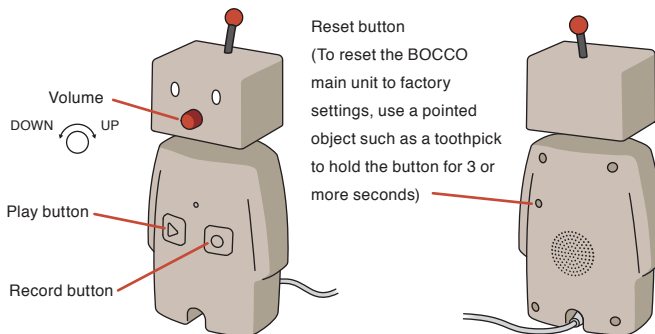

* If there is no sound, please check the volume.

Specifications

BOCCO main unit	
Product dimensions	W90mm x D55mm x H195mm
Item weight	220g
Wi-Fi	IEEE 802.11 b/g
Bluetooth	Bluetooth Low Energy
Power source type	100-240V AC Adaptor Type A (US/Japan)
Voice synthesis	Speech Synthesis VOICETEXT
Motion sensor	
Product dimensions	W34mm x D30mm x H68mm
Item weight	30g (without batteries)
Bluetooth	Bluetooth Low Energy
Sensor	Acceleration sensor
Power supply	2x AAA batteries
Battery lifetime	Approximately 1 year (light or regular use)

Signals from BOCCO

LED color	Status (functioning normally)
White	During boot-up
Blue	During the first-time setup
White	When receiving a message
Green	Now playing
Red	Now recording
Yellow	Now sensing
Green	Now updating the firmware
LED color	Status (error)
Yellow	Disconnecting BOCCO from the Wi-Fi network Place BOCCO within range of the Wi-Fi router and reset the BOCCO main unit.
Red	No Internet connection Please use another device to ensure your Wi-Fi router is connected to the Internet, then restart the BOCCO main unit.
Red	Failed to update firmware Restart the BOCCO main unit. The firmware will be updated automatically, which might take several minutes. Please do not switch off or restart the BOCCO main unit until the update has completed.

CAUTION / WARNING

- Replace the batteries in the motion sensor after 1 year of usage. There is risk of leakage if the battery is not replaced.
- Use of the adhesive tape is at your own risk. Do not attach adhesive tape to a sensitive or valuable surface. The manufacturer will bear no responsibility for any damage caused by usage of the included adhesive tape.
- Do not or remodel or embellish this product.
- To clean the BOCCO main unit and motion sensor, use a moist cloth and soap or other neutral detergent. Do not use organic solvents such as alcohol, thinner, or polishing material.
- Use between 30°F to 100°F (0°C to 40°C)
- Do not use in a sauna or very humid room.
- Do not use near to water. None of the included contents are waterproof.
- Do not leave in direct sunlight for an extended period of time.
- Do not use near to fire.
- Do not drop, throw, or step on.
- Do not pull, twist, or use excessive force on movable parts.
- Damage may occur to the internal motors if the BOCCO main unit is used in a tipped-over position. Please use the BOCCO main unit in an upright position, standing on its feet.
- Do not compress the BOCCO main unit while it is switched on.
- Place the BOCCO main unit in a flat and stable place to reduce the risk of it falling.
- Keep the BOCCO main unit and AC adapter out of reach of pets.
- Do not disconnect the AC adapter while the BOCCO main unit is booting up.
- Use only with the included AC adapter. Never attempt to use a third party adapter.

FCC CAUTION

This device complies with part 15 of the FCC Rules. Operation is subject to the following two conditions: (1) This device may not cause harmful interference, and (2) this device must accept any interference received, including interference that may cause undesired operation.

This equipment complies with FCC radiation exposure limits set forth for an uncontrolled environment. This equipment should be installed and operated with minimum distance 20 cm between the radiator & your body. This transmitter must not be co-located or operating in conjunction with any other antenna or transmitter.

Help

If you have any questions, please email us.

✉ support-en@bocco.me

Main unit
FCC ID : 2AFXT-RB002-W
FCC ID : 2AFXT-RB002-B
Sensor
FCC ID : 2AFXT-RB002

RB002-QR1 Rev.01 2015.10

山折

谷折