

Quick Guide

V2.0 issued in Dec, 2016

KUDRONE

Drone with 4K Camera

1. Download kudrone APP

1.1 Scan the QR code below to download and install the kudrone APP



· The guide is subject to change without prior notice.
Please visit the official website for the latest version and download User Manual.

2. Charge the Battery

2.1 Plug Micro USB of charging cable into kudrone Drone and USB into power bank

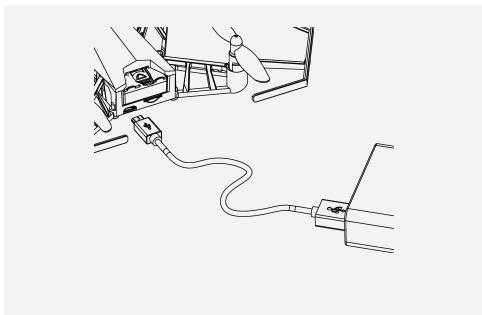

2.2 Plug batteries into the charger till they are buckled together. (Note: the charger is not included in the standard package and needs to be bought additionally.)

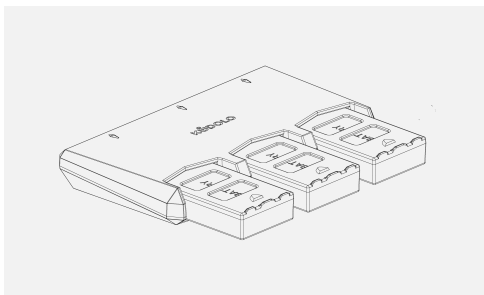

3. Insert / Remove the Battery

3.1 Insert or remove the battery

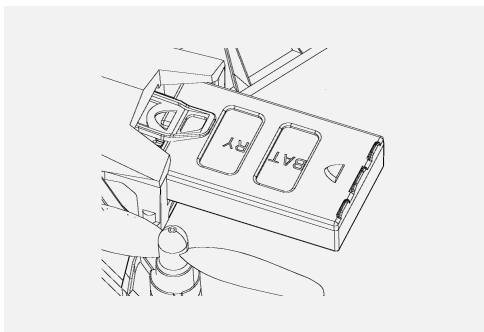

4. Fix Propeller

4.1 Fix propellers on the axle of motors (Note: “L” propeller at “L” side marked on the drone bracket, and similarly “R” propeller at “R” side.)

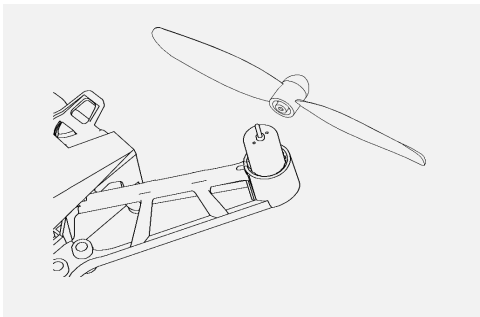

5. Protector

5.1 Fix the protector on motors

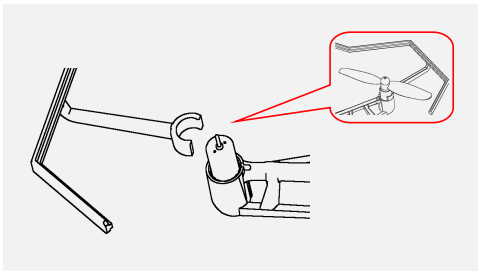

6. Turn on the Drone & Connect

6.1 Press the power button for 3 seconds till the left and right LED lights turn blue, which indicates successful turning on the drone

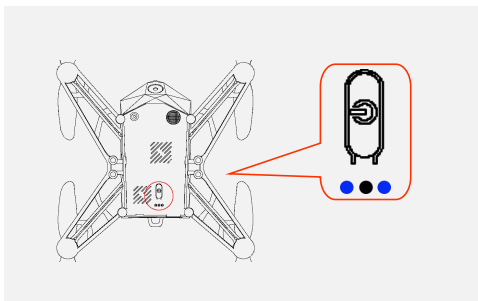

6.2 Enter the Wi-Fi setting page on your device and connect the device to “kudrone drone xxx” hotspot (Note: It is advised to change Wi-Fi Name and password timely.)

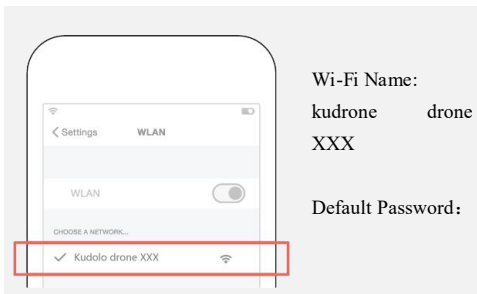

7. Auto Photo Mode

7.1 Non-APP Mode: after turning on the drone, continuously press power button twice and make user and camera face to face (The drone will automatically fly backward and hover in the air and then return back after taking 3 photos.)

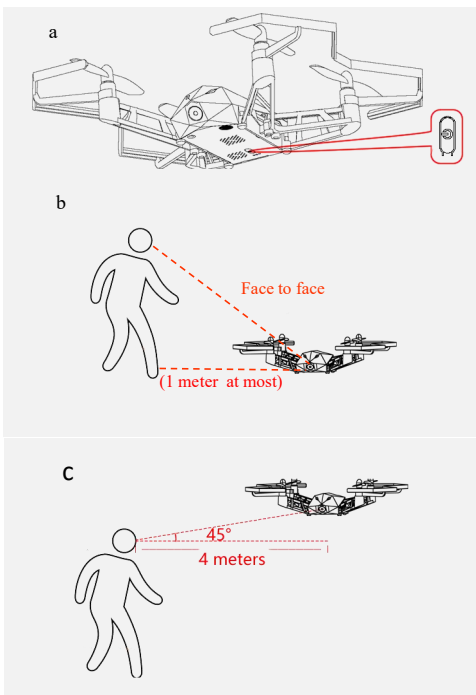

7.2 APP Mode: after connecting Wi-Fi, register or login into the homepage and then click “Auto Photo” to choose any one among the four modes: “AUTO SELFIE PHOTO” “360° PANO PHOTO” “360° PANO VIDEO” or “360° PILOT-ENCIRCLED VIDEO” under “Auto Photo” page.

① Click “Auto Photo”

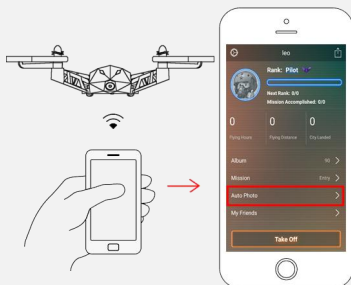

② Choose any mode under “Auto Photo” page

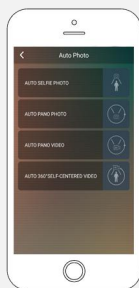

A. AUTO SELFIE PHOTO

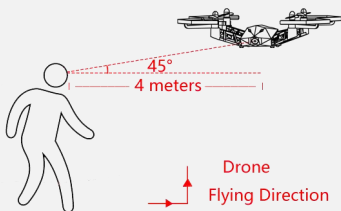

B. AUTO PANO PHOTO

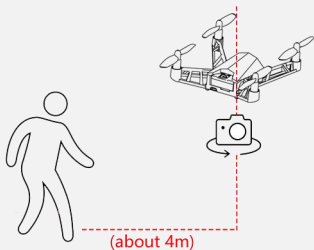

C. 360° PANO VIDEO

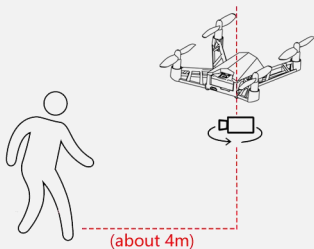

D. 360° SELF-CENTERED VIDEO

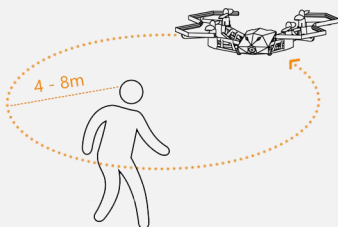

8. Flight Control

8.1 Register or login into homepage and click “Take Off” to enter flight control page

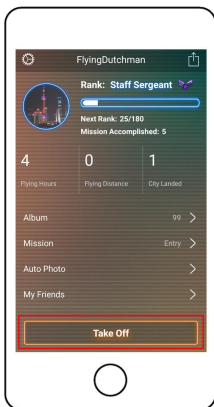

8.2 Flight control page



3. Joystick : slide your finger to control your kudrone Drone

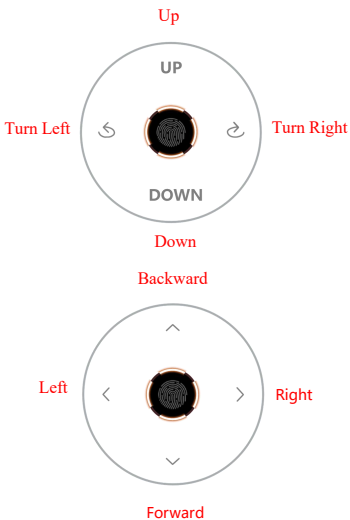

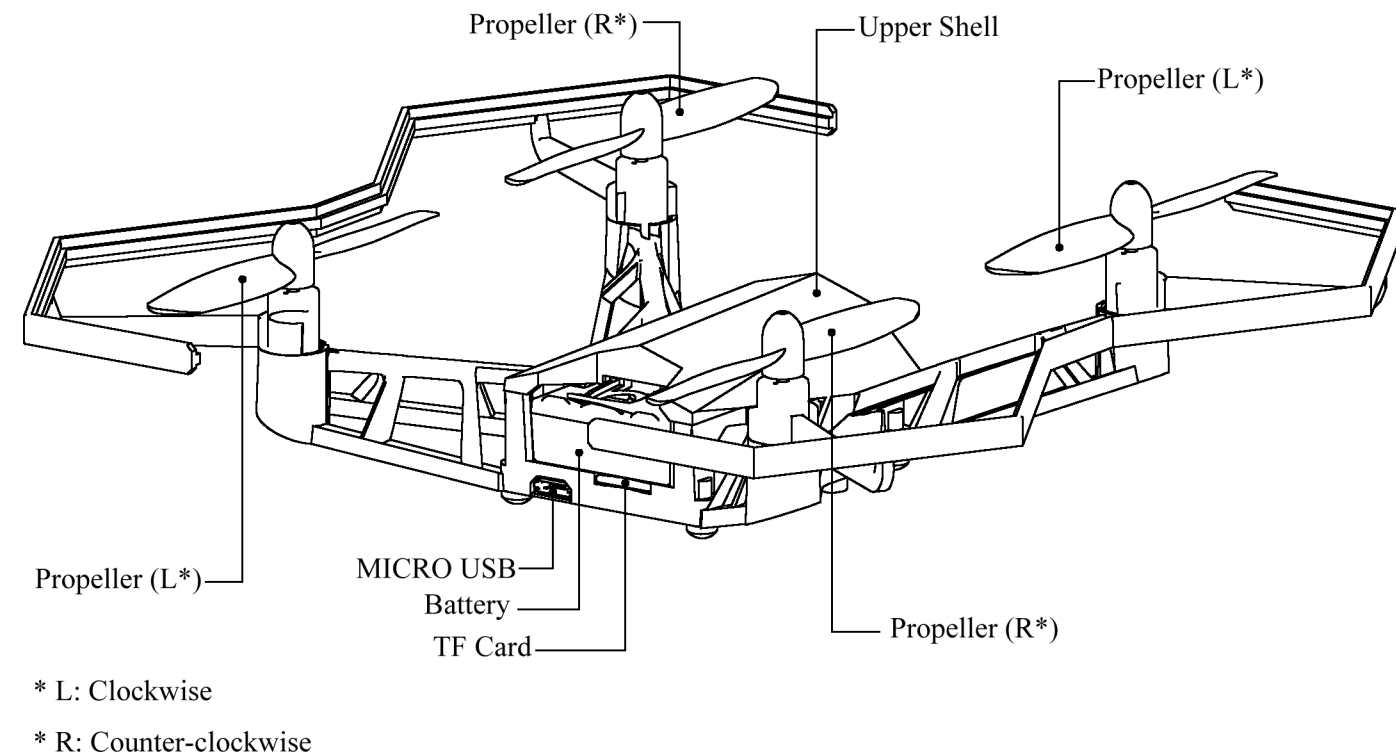
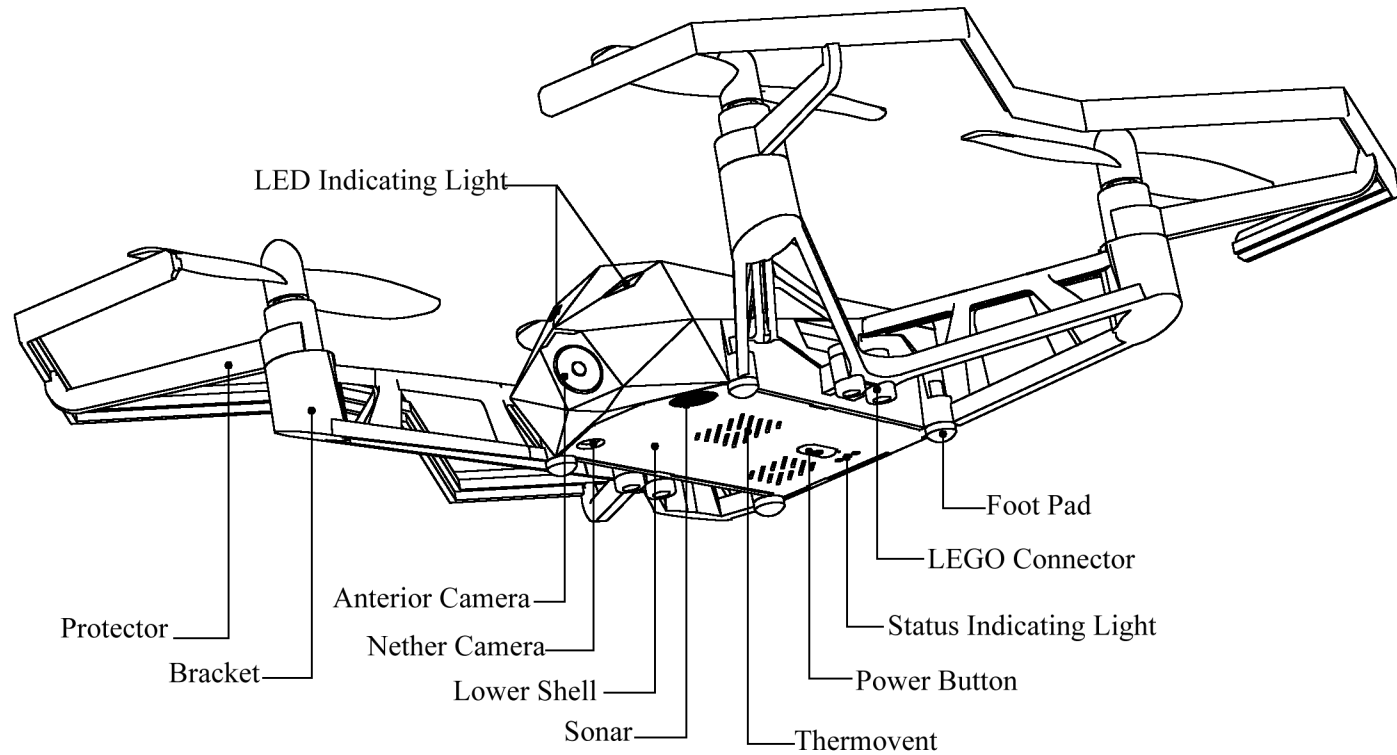



kudrone.com

Copyright @ 2016 Shenzhen Ruixiang Technology Co., Ltd.

All Right Reserved

Warning Statement

This device complies with part 15 of the FCC Rules. Operation is subject to the following two conditions: (1) This device may not cause harmful interference, and (2) this device must accept any interference received, including interference that may cause undesired operation.

Any Changes or modifications not expressly approved by the party responsible for compliance could void the user's authority to operate the equipment.

Note: This equipment has been tested and found to comply with the limits for a Class B digital device, pursuant to part 15 of the FCC Rules. These limits are designed to provide reasonable protection against harmful interference in a residential installation. This equipment generates uses and can radiate radio frequency energy and, if not installed and used in accordance with the instructions, may cause harmful interference to radio communications. However, there is no guarantee that interference will not occur in a particular installation. If this equipment does cause harmful interference to radio or television reception, which can be determined by turning the equipment off and on, the user is encouraged to try to correct the interference by one or more of the following measures:

- Reorient or relocate the receiving antenna.
- Increase the separation between the equipment and receiver.
- Connect the equipment into an outlet on a circuit different from that to which the receiver is connected.
- Consult the dealer or an experienced radio/TV technician for help.

This equipment complies with FCC radiation exposure limits set forth for an uncontrolled environment. This equipment should be installed and operated with minimum distance 20cm between the radiator & your body.