

Power Bank with Bluetooth Speaker

Model No. LI7000BL / LI700PR

INSTRUCTION MANUAL

BEFORE YOU USE THIS DEVICE FOR THE FIRST TIME, PLEASE READ THE FOLLOWING NOTES IN THIS MANUAL AND HEED ALL WARNINGS AND CAUTIONS, EVEN IF YOU ARE FAMILIAR WITH HANDLING ELECTRONIC DEVICES. KEEP THIS MANUAL IN A SAFE PLACE FOR FUTURE REFERENCE.

WARNING

To prevent serious injury or damage:

- Keep dry. DO NOT open, drop, short-circuit, incinerate, expose to temperatures higher than 140°F, or change/use if damage.
- Only use charging adaptors provided with the Power Bank. Use of any other adaptors may damage the unit or result in a fire.
- Do not submerge in water or any other liquid. It is not waterproof.
- Do not operate in explosive atmospheres, such as in the presence of flammable liquids, gases or dust.
- DO not charge the Power Bank for more than 10 hours. Overcharge will cause overheating and shorten the battery life.
- Read warning on the package before use.

PROPOSITION 65

This product and its power cords may contain chemicals known to the State of California to cause cancer, birth defects, or other reproductive harm; wash your hands after handling.

PRODUCT DESCRIPTION

Your rechargeable Battery Bank provides portable power to recharge Cell phones, Tablets, Cameras, MP3 Players, rechargeable headphones and other portable USB electronic devices; it also provides Hands free operation for mobile devices while driving or in the office with the built-in Bluetooth speaker and music playback.

FEATURES

- Bluetooth wireless speaker
- Super bright LED area light
- Answer / Reject calls
- Micro SD port for mp3 music playback
- Powerful speaker for loud and clear sound during phone calls or music playback
- Battery status indicator
- Micro USB charging cable Included
- 12V vehicle - USB charging adapter included
- Removable Visor clip

SPECIFICATIONS

Input: Micro USB 5V/1A
USB Output: 5V-DC 2A
Battery Type:..... Internal Rechargeable Lithium-ion
Battery Pack:..... 5200mAh
Bulb Type: White LED
Power: 1.0W
Frequency Response:..... 100HZ-20KHZ
Speaker:..... 3W/4Ω Diameter: 31mm
Bluetooth stereo receiver distance: .. 32.8 feet

RUNNING TIME

The approximate running time for this Power Bank when the battery is fully charged and at maximum performance level are as following:

LED Area light: Up to 150 Hours
Standby Mode: 200 Hours
Talk Time:..... 20 Hours
Music Playback: 15 Hours

OPERATION MODES

This rechargeable power bank features a usb port to recharge portable usb devices, an area light for emergencies and a bluetooth speaker for music playback and cell phone hands free operations.

PRODUCT DIAGRAM

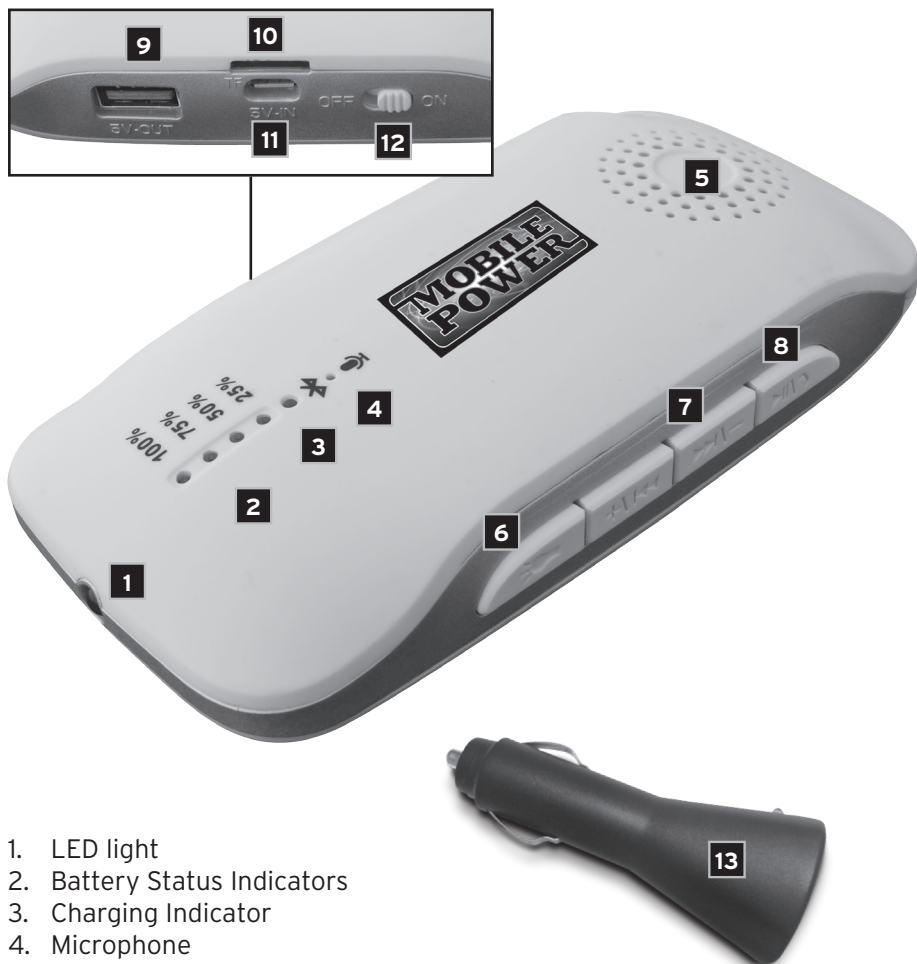

1. LED light
2. Battery Status Indicators
3. Charging Indicator
4. Microphone
5. Speaker
6. LED Light Power Button
7. Volume Controls
8. Answer Call / Play / Pause Button
9. Output USB Port
10. Micro SD Card Slot
11. Micro USB Charging Port
12. Unit Power Switch
13. 12V DC Charger

PAIRING A DEVICE

To pair a device for the first time follow below steps:

1. Turn the main power switch to the ON position; the Power Bank will automatically enter the pairing mode and the Bluetooth indicator light will fast blink (Red/Blue).
2. Go to settings / Bluetooth connection on mobile phone or Bluetooth device and search for A6-2 on the list of devices
3. Click on A6-2 device and pair (Bluetooth indicator light will slow blink blue). **Note: once the device is paired, is ready for music playback and / or cellphone hands free operations.**

ANSWER / REJECT CALLS

Once cell phone device is paired and connected, short press the call/play button to answer a call and short press again to hang up the call.

To reject calls, long press the call/play button.

USING THE USB CHARGING PORT

1. Short press the Light button once to activate the USB Port (LED Battery status indicator lights will turn ON)



2. Connect USB portable device into the unit's USB port using the Power Bank Micro USB cable provided or charging cable provided with USB device. **Note: If a device is not connected to the Power Bank USB port within 20 Seconds of activating the USB port; it will turn OFF automatically and it will require to press the Light Button once again to activate it.**



- Unit will recharge and/or Power the USB portable device once connected. **Note: Pressing the light button while charging an USB device will display the unit's battery status, recharge unit when it reads low (25%).**

MUSIC PLAYBACK

The Portable Power Bank can playback music via Bluetooth while connected to a Bluetooth player such as Cell phone, Mp3 player, laptop and more; to pair the device follow the PAIRING A DEVICE instruction.

- Once device is paired, short press Play button on Power bank for music playback
- To pause the music, short press the Play button a second time
- To fast-forward a song, short press the >> button
- To rewind a song, short press << button

The music can also be controlled on the player device as usual.

NOTE: To disconnect device, slide the main ON/OFF switch to the OFF position.

MICRO SD MUSIC PLAYBACK

- Insert a micro SD card into the micro SD card slot on the side of the unit above the charging port.

Note: Micro SD card must contain MP3 music files

- The unit will Automatically enter playback mode
- Short press Play button on Power bank for music playback
- To pause the music, short press the Play button a second time
- To fast-forward a song, short press the >> button
- To rewind a song, short press << button

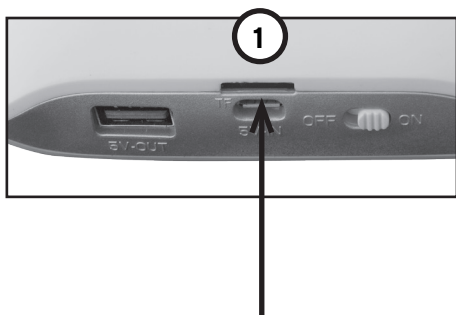

VOLUME CONTROLS

To Increase the volume:

Long press the +/<< button to turn the volume UP.

To decrease the volume:

Long press the -/>> button to turn the volume down.

AREA LIGHT

To turn the area light ON:

Long press the Light button on the side of the unit.

To turn the Area light OFF:

Long press the light button a second time.

BATTERY STATUS INDICATOR

To check the battery status on the unit, short press the light button on the side of the unit (blue LEDs will light up depending on the battery status) 25% • 50% • 75% • 100%

CHARGING INSTRUCTIONS

The portable battery bank must be fully charged before being used for the first time. It is recommended that the battery be recharged every 3 months to ensure maximum performance.

USING USB CHARGING CABLE

1. Plug the micro USB charging jack cable into the charging port on the side of the unit
2. Plug the other end of USB cable into a USB charging port or use provided 12V car charging adapter to recharge from vehicle's power outlet or cigarette lighter port.
3. The LED battery status indicator lights will come on while charging is in progress.
4. The battery will be fully charged after approximately 5-6 hours and the Top LED charging indicator light will stop blinking when the unit is fully charged.
5. Disconnect the charging cable from the unit first and then the other end from the power outlet. TO PREVENT OVERCHARGING DO NOT CHARGE FOR MORE THAN 10 HOURS CONTINUOUSLY.

SAFETY PRECAUTIONS

- Recharge the unit indoors in a dry location only. Exposure to damp or wet conditions could cause a shock or damage to the unit.
- Do not recharge the unit near flammable liquids or materials.
- Store in dry location and do not allow the unit to come in contact with water, rain or snow.
- If the charging cable/adaptor comes in contact with water, place in a dry location at room temperature, on a soft absorbent towel and allow to dry thoroughly.
- Do not operate the unit until is completely free of moisture.
- Use only the charging adapter supplied with the unit. Do not attempt to charge the unit with an adapter that is not compatible as this could result in a fire, damage to the unit or personal injury.

CARE AND MAINTENANCE STORAGE

- Store the Portable Power Bank and charging adapters in a clean and dry area.
- Be sure to keep the charging adapters supplied with this product stored separately from similar items as only charging adapters included with this light are compatible.
- Using an non-compatible charger could cause damage to the unit and / or personal injury.
- The Portable Power Bank may also be store in a vehicle for hands free operation.
- To prevent unit and any other accessories being damaged, ensure that it is properly secured and in a safe place inside the vehicle.

CLEANING

All exterior surfaces of the Portable Power Bank can be wiped clean with a soft cloth dampened with a mild soap and water solution. Do not immerse or submerge any parts of the Power Bank in water or any other solvent. Never use solvents or cleaning agents containing petroleum (petrol, kerosene, oil), paint thinner, turpentine, alcohol or ammonia. Harsh materials like these can damage the surfaces.

MAINTENANCE

Only qualify service personnel must perform repairs. Do not open the exterior casing of the Power Bank as there are no user serviceable parts

inside. Opening or visible attempts to open or repair the unit may void the warranty and / or cause damage to the unit or personal injury. LED bulb do not need to be replaced.

This product contains an internal Lithium-ion battery pack formulated from environmentally sensitive materials. This product must be disposed of properly with due care for the environment. Please return this product to your local dealer or local recycling center where batteries will be recycled or disposed of properly.



MobilePower, LLC. Warrants to the original purchaser that the Vehicle Boosting System shall be free from materials defects in constructing material and workmanship for a period of one year from the original date of purchase except the internal Lead Acid rechargeable battery pack warranted for a period of one year. If the product is determined by MobilePower, LLC. to be defective in material and workmanship during the warranty period MobilePower, LLC. will repair or replace the defective product or defective accessories/components with the factory original specification product at MobilePower, LLC. option. The original purchaser is certified to obtain this warranty with the proof of purchase within the warranty period. To obtain a return authorization and shipping instructions related to the warranty services in North America visit us at www.mobilepower-us.com or call 800-708-8550 Customer Support or contact us at customerservice@mobilepower-us.com. You may ship the defective product with freight prepaid to MobilePower, LLC. Your replacement will be mailed back to you at no additional charge. Great care must be taken when packing the product and all associated accessories into a suitable packing box along with original dated purchasing receipt or invoice. The package must include a letter stating the defect details, contact information including physical address. Any address with a PO Box will not be processed and will be held until further notification from the consumer. Make certain that your package can be tracked when you are shipping the defective products to us. MobilePower, LLC will not be responsible for lost packages sent by consumers. MobilePower, LLC. Will not be responsible for damages incurred during shipment to our facilities. Failure to provide the original purchase receipt or proof of purchase will render this warranty invalid.

THIS WARRANTY SHALL NOT APPLY IF THIS PRODUCT (A) IS DAMAGED RESULTING FROM ABUSE, MISUSE, NEGLIGENCE, ACCIDENT, LACK OF MAINTENANCE, WEAR AND TEAR, UNREASONABLE USE OR BY OTHER CAUSES UNRELATED TO THE DEFECTIVE MATERIAL OR WORKMANSHIP; (B) IS USED WITH PRODUCTS THAT ARE NOT COMPATIBLE WITH VEHICLE BOOSTING SYSTEM; (C) IS USED FOR COMMERCIAL PURPOSES; (D) IF THE PRODUCT HAS BEEN SUBJECTED TO WATER AND FIRE.

This warranty provides you with specific legal rights, and you may also have other rights which vary from state to state.

This warranty is valid only in North America.



MobilePower, LLC. Miami, FL
www.mobilepower-us.com
Customer Support: (800) 708-8550
customerservice@mobilepower-us.com

FCC Caution: Any changes or modifications not expressly approved by the party responsible for compliance could void the user's authority to operate this equipment.

This device complies with Part 15 of the FCC Rules. Operation is subject to the following two conditions: (1) This device may not cause harmful interference, and (2) this device must accept any interference received, including interference that may cause undesired operation. This device and its antenna(s) must not be co-located or operating in conjunction with any other antenna or transmitter.

NOTE: This equipment has been tested and found to comply with the limits for a Class B digital device, pursuant to Part 15 of the FCC Rules.

These limits are designed to provide reasonable protection against harmful interference in a residential installation. This equipment generates, uses and can radiate radio frequency energy and, if not installed and used in accordance with the instructions, may cause harmful interference to radio communications.

However, there is no guarantee that interference will not occur in a particular installation.

If this equipment does cause harmful interference to radio or television reception, which can be determined by turning the equipment off and on, the user is encouraged to try to correct the interference by one or more of the following measures:

- Reorient or relocate the receiving antenna.
- Increase the separation between the equipment and receiver.
- Connect the equipment into an outlet on a circuit different from that to which the receiver is connected.
- Consult the dealer or an experienced radio/TV technician for help.