

# ViPRO

## Handheld 3-Axis Brushless GIMBAL User Manual

WINGSLAND ViPRO Vol.1.1

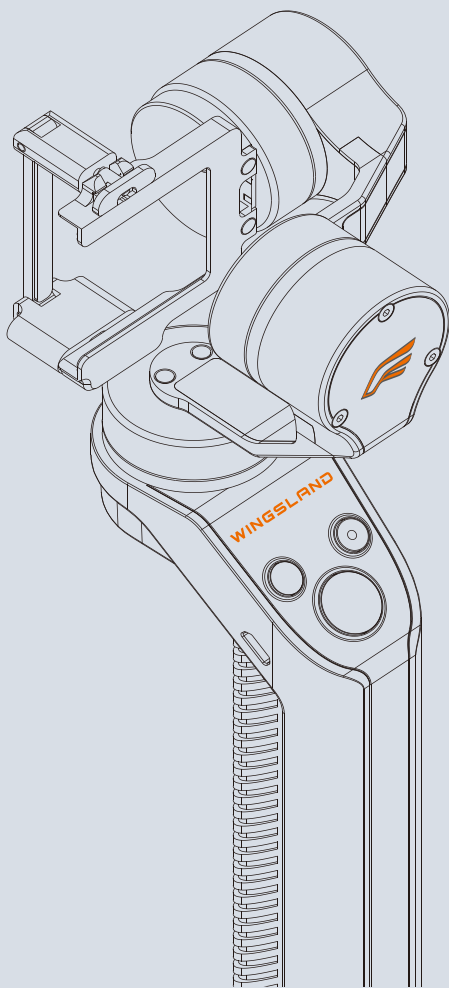

Hot line:400-080-5969



Shenzhen WINGSLAND Technology Co., Ltd

Add: 2F, 10 Block, ZhongYunTai Technology & Industry Park,  
Tangtou First Road, Shenzhen, GuangDong

Tel: 086-0755-23123451

Product info in description depends on the actual product, specifications are subject to  
change without prior notice.



# What's in the box

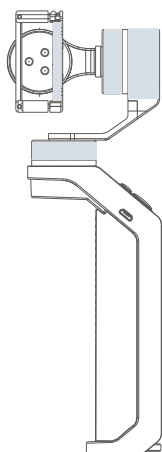

1

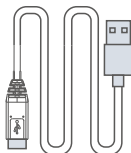

2

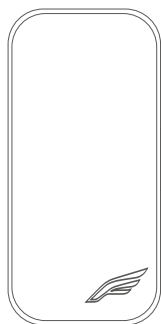

5



3

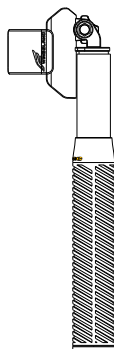

6



7

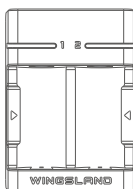

4

- |                                 |                                   |
|---------------------------------|-----------------------------------|
| 1. 1x GIMBAL                    | 2. 1x USB Cable                   |
| 3. 4x Rechargeable Battery      | 4. 1x Charger                     |
| 5. 1x Case                      | 6. Extension Bar (Optional)       |
| 7. Remote Controller (Optional) | 8. Mobile Device Holder(Optional) |

What's  
in the box

Charging

How to Use

Install Camera

Extension  
Bar Usage

# Charging

1. Insert USB Cable into mobile device or computer charging port.
2. Connect USB Cable with Charger, the Charger Blue LED blink once to finish self-check.
3. Set 2 Batteries into the Charger, the Charger Red LED turns solid red to start charging.
4. Charging is completed when the Charger Blue LED turns on.

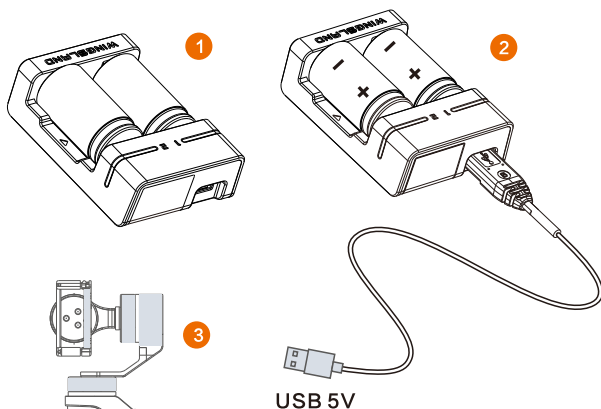

**Install Batteries:** Unscrew battery compartment cover on the bottom of GIMBAL, put the batteries into the battery compartment directly.

1. Make sure to use WINGSLAND genuine battery.
2. Ensure take the batteries out of the Charger after the batteries is fully charged.
3. Do not store the battery in the wet damp or high-temperature environment.
4. Avoid Battery short circuit.
5. Please do not arbitrarily discard battery, to dispose of the battery in accordance with the local regulations.



# How to Use

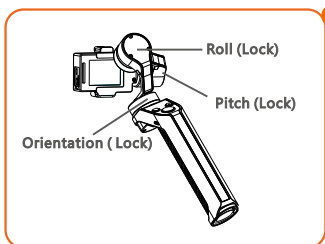
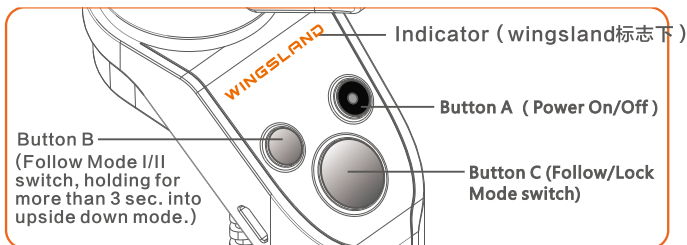

**Lock Mode**

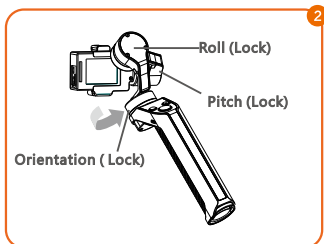

**Follow Mode I**

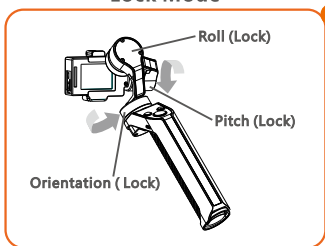

**Follow Mode II**

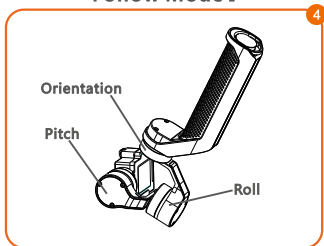

**Upside Down Mode**

## 1 Mode Status

Mode	Indicator	Roll	Orientation	Pitch
Lock Mode	Red LED	Lock	Lock	Lock
Follow Mode I	Orange LED	Lock	Follow	Lock
Follow Mode II	Blue LED	Lock	Follow	Follow

## 2 Power On GIMBAL

After install the camera tight, press power button ( Button A) with holding for 3 sec. to start GIMBAL. ( Figure ),On the side of Button A, turns on Red LED with the completion of camera initialization, the camera orientation in the forward and middle position is default.

## 3 Power Off GIMBAL

Press power button ( Button A) with holding for 3 sec. to power off the GIMBAL.

## 4 Lock/Follow Mode switch and Reset

Follow Mode is default after GIMBAL powered on. Press Button C to switch between Follow Mode and Lock Mode.Press Button C with holding for 2 sec. to make Camera reset the orientation in the forward/middle position and Follow Mode I status.

## 5 Follow Mode I /Follow Mode II switch

Follow Mode I is default after GIMBAL powered on, the orientation will follow according to the GIMBAL action.if you want a pitch angle, you need to switch into Follow Mode II through pressing Button B.

## 6 Upside Down Mode ( Figure 4)

When shooting a low angle view, switch GIMBAL Operating Mode into Upside Down Mode through pressing Button B with holding for more than 3 sec. Press again, Upside Down Mode ESC.

## 7 Specifications

	Standard Value	Range	Remark
Working Voltage	8.4V	6.0V~12.0V	2S18350
Pitch Angle	0° Horizontal	-160° Upward ~ 160° Downward	Horizontal Hand Held
Roll Angle	0° Horizontal	-50° ~+50°	
Heading Angle ( Vertical)	/	-160° Left~160° Right	Vertical Hand Held
Heading Angle ( Horizontal)	/	-50° ~+50°	Horizontal Hand Held
Pitch Speed	/	2° /Sec.~100° /Sec.	
Heading Speed	/	3° /Sec.~160° /Sec.	
Motors Overload Protection Current	1200MA		
Operating Temp	-45~85℃		
Package Size	28cmX15cmX9cm		
Weight	285g(Exclude Camera & Batteries)		

## 8 Firmware Upgrade

Download and install the WINGSLAND firmware and operations manual through visit SHENZHEN WINGSLAND official homepage [www.szsungreen.com](http://www.szsungreen.com)

# Install Camera

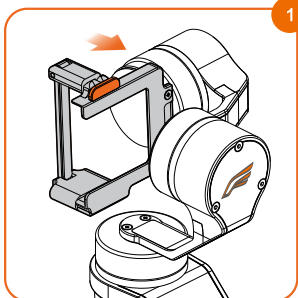

■ Pull out the lock catch.

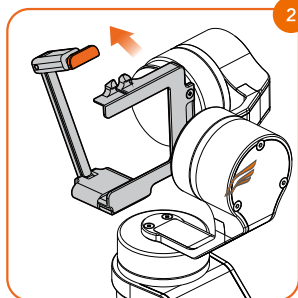

■ Lift upwards to open.



■ Install camera correctly, pay attention the Camera Lens and Screen installation methods.



**Warning**

**This GIMBAL is compatible with Gopro Hero 1, Gopro Hero 2, Gopro Hero 3, Gopro Hero 4 and Yi action Camera, etc.**

# Extension Bar Usage

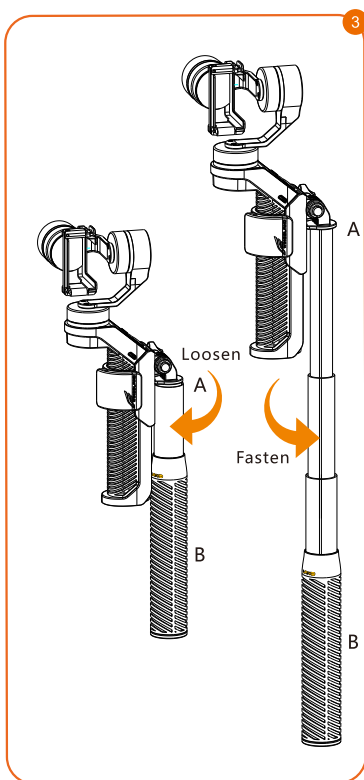
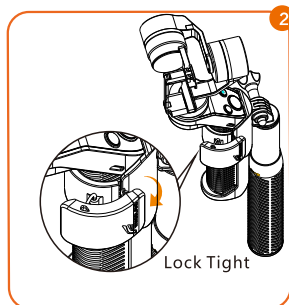
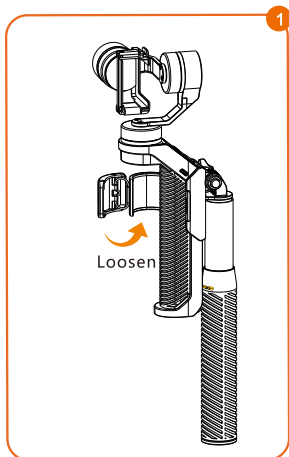

1. Assembly the extension bar according to the graphic descriptions.
2. Grasp extension bar end A, spin end B in the anti-clockwise direction, loosen the joint fixed device.
3. Find a appropriate length you need, hold extension bar end A, spin end B in the clockwise direction, fasten the joint fixed device.



## **FCC Caution.**

### **§ 15.19 Labelling requirements.**

This device complies with part 15 of the FCC Rules. Operation is subject to the following two conditions: (1) This device may not cause harmful interference, and (2) this device must accept any interference received, including interference that may cause undesired operation.

### **§ 15.21 Information to user.**

Any Changes or modifications not expressly approved by the party responsible for compliance could void the user's authority to operate the equipment.

### **§ 15.105 Information to the user.**

**Note:** This equipment has been tested and found to comply with the limits for a Class B digital device, pursuant to part 15 of the FCC Rules. These limits are designed to provide reasonable protection against harmful interference in a residential installation. This equipment generates uses and can radiate radio frequency energy and, if not installed and used in accordance with the instructions, may cause harmful interference to radio communications. However, there is no guarantee that interference will not occur in a particular installation. If this equipment does cause harmful interference to radio or television reception, which can be determined by turning the equipment off and on, the user is encouraged to try to correct the interference by one or more of the following measures:

- Reorient or relocate the receiving antenna.
- Increase the separation between the equipment and receiver.
- Connect the equipment into an outlet on a circuit different from that to which the receiver is connected.
- Consult the dealer or an experienced radio/TV technician for help.

### **\* RF warning for Portable device:**

The device has been evaluated to meet general RF exposure requirement. The device can be used in portable exposure condition without restriction.

.....