

Touchable controller Bluetooth Headphone OK-608BT User manual



IMPORTANT: Please read these user instructions carefully before using this device and retain for future use!

Special instructions:

- Please enjoy your music at a reasonable volume. This will enable you to hear external noises as well as respecting others.
- Lower the volume and stop using the device if you hear a ringing in your ears.
- Use only the accessories supplied with the device.
- Avoid contact with water or other liquids. To clean, simply wipe the device with a soft cloth.
- Keep away from direct sunlight and avoid exposure to extreme heat or cold. Protect the device from shock, rain and humidity.
- Immediately switch off the device if you notice smoke or odours coming from it.
- Do not attempt to repair the product yourself. Use only qualified service personnel to repair this device.
- Never allow children to play with the device.
- Liability will be expressly disclaimed for any damage or loss of data caused by failure to follow these instructions or to due to misuse or poor handling of the device.

Description:

1. Button ►|| (on/off, play/pause, answer/hang up and redial)
2. Micro USB port
3. LED indicator
4. 3.5 mm AUDIO IN jack
5. Reset button
6. Button ◀◀ (play previous track and volume down)
7. Button ▶▶ (play next track and volume up)

Technical Features:

- Voltage: DC 5V
- 320mAh rechargeable lithium battery
- Bluetooth : BT 3.0+EDR
- Impedance: 32 ohm+/-15%
- Frequency: 20-20 kHz
- Sensitivity: 105dB +/- 3dB
- Distortion: 0.10%

Charging the battery:

- Fully charge the battery before using your device the first time.
- Turn the device off during the recharging process to extend the life of the unit and the battery.
- Plug the cable into the unit's micro USB port (2).
- Insert the USB at the other end of the cable into a USB adapter or the USB port of your computer. The LED will be red.
- The recharging process takes about 3 hours.

Bluetooth pairing:

- Switch on your device by pressing and holding the ►|| button (1) for a few seconds.
- You will hear a beep and see the LED indicator blinking blue and red, indicating the unit is ready to be paired with a source device that has a Bluetooth feature.
- Activate the Bluetooth feature of the device to be connected (smartphone, computer, tablet computer, etc.) and activate scan for other devices (refer to the device user manual).
- The device will appear in the list of Bluetooth peripherals under "OK-608BT". The two devices are now ready to pair.
- You can now use this device as a sound source for your headphones (refer to the device user manual).
- TIP: For better streaming from the sound source to the device, keep the distance between the devices short and avoid any objects giving off electromagnetic interference that may interfere with streaming.

Using the buttons:

- Press and hold the ►|| button (1) for a few seconds to turn the device on and off.
- Tap the ►|| button (1) to play/pause.
- If you get a phone call, tap the ►|| button (1) to answer the call. While in the call, tap the ►|| button (1) again to hang up.
- Tap the ►|| button (1) twice in quick succession to redial the last called number.
- Tap the ▶▶ button (7) to skip to the next track or ◀◀ (6) to go back to the previous track.

- Press and hold the ►► button (7) for a few seconds to increase the volume or ◀◀ (6) to decrease the volume.

Using the touch sensitive control system:

The left earcup (L) has a touch sensitive control system. You can use the same functions as the buttons by simply touching the left earcup (L) as shown in the illustration below:

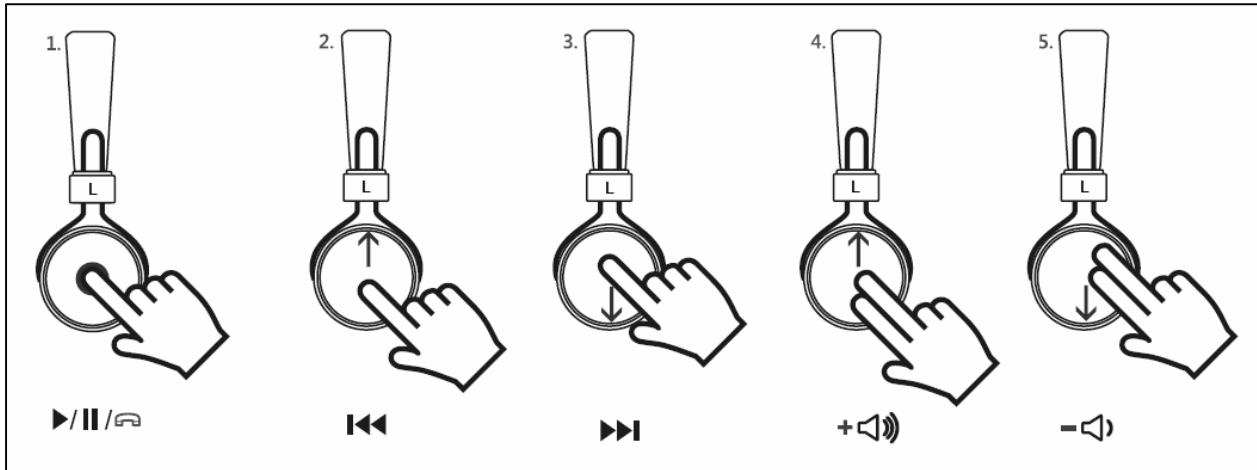

- 1) Touch the middle of the earcup once to play/pause or to answer/end a phone call. Tap twice in quick succession to redial the number just called.
- 2) Swipe 1 finger up to go back to the previous track.
- 3) Swipe 1 finger down to skip to the next track.
- 4) Swipe 2 fingers up to increase the volume.
- 5) Swipe 2 fingers down to decrease the volume.

Audio cable:

- Plug the audio cable provided into the AUDIO IN jack (4).
- Plug the other end of the cable into the AUDIO OUT jack of the source (refer to the device user manual).
- You can now use this device as a sound source for your headphones (refer to the device user manual).

This device complies with part 15 of the FCC Rules. Operation is subject to the following two conditions: (1) This device may not cause harmful interference, and (2) this device must accept any interference received, including interference that may cause undesired operation.

§ 15.21 Changes or modification warning

Any Changes or modifications not expressly approved by the party responsible for compliance could void the user's authority to operate the equipment.

§ 15.105 Information to the user.

Note: This equipment has been tested and found to comply with the limits for a Class B digital device, pursuant to part 15 of the FCC Rules. These limits are designed to provide reasonable protection against harmful interference in a residential installation. This equipment generates uses and can radiate radio frequency energy and, if not installed and used in accordance with the instructions, may cause harmful interference to radio communications. However, there is no guarantee that interference will not

occur in a particular installation. If this equipment does cause harmful interference to radio or television reception, which can be determined by turning the equipment off and on, the user is encouraged to try to correct the interference by one or more of the following measures:

- Reorient or relocate the receiving antenna.
- Increase the separation between the equipment and receiver.
- Connect the equipment into an outlet on a circuit different from that to which the receiver is connected.
- Consult the dealer or an experienced radio/TV technician for help