



User's Guide for Battery WiFi Video Doorbell LY-113

Product Overview

Our doorbell is a Wi-Fi enabled Smart Video Doorbell which helps you to see, hear and speak to anyone at your door from your smartphone or tablet from anywhere. This Video Doorbell supports answering ring calls from mobile App, two-way audio, instant alert, motion detection and live monitoring.

Product Features

- One 18650 specification batteries work regularly for 4-6 months
- HD Megapixels collocated with wide-angle lens
- Support mobile phone remote fast wakeup within 1 second
- 2.4G Wi-Fi connection
- High quality two-way talk with noise cancellation
- Support PIR motion detection, when someone hovers at the door, it will send push alerts to your mobile phone immediately
- With IR-cut, it can switch automatically and it is clearly visible at both day and night to keep your home and family safe.

Product Specification Sheet

Lens	FOV/160°C Wide-angle lens (4Glass)
Infrared LEDs	5pcs Infrared LEDs with 5 meters flash distance
PIR Motion Sensor	4 meters PIR distance
Storage	Up to 32GB Micro SD card
Connectivity	802.11b/g/n Wi-Fi@2.4G
Power consumption	Standby 200 uA Working 220 mA
Battery	One 18650 specification batteries
Wi-Fi distance	60 meters (open space without obstacle)15 meters (indoor)
Limited distance between doorbell and chime indoor	30 meters
Video Compression	H.264
Voice Intercom	Two-way audio with noise cancellation
Video resolution	1280*720@30 fps

Notifications	Push Notifications within 1 second
Device Wakeup	Within 600 ms
Working Temperature	-20°~ 60° C
Storage Temperature	-40°~ 70° C

Install your doorbell

1 A brief introduction of the Doorbell.

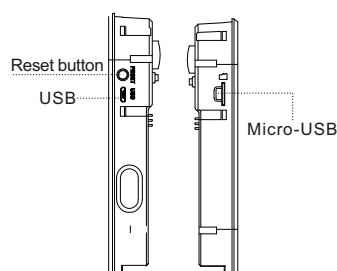
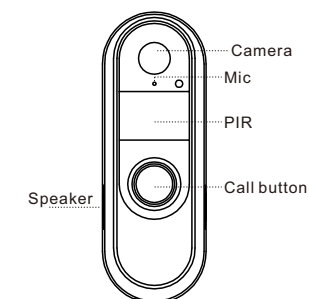

Setp1. open the cover of device.

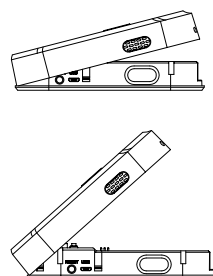

Step 2: Install anchors (on stucco, brick or concrete)
On stucco, brick or concrete, use the bit to drill two holes in your wall, and install the anchors2.

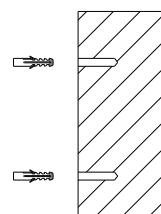

Step 3: Fix the doorbell on the wall through fixing screw hole..

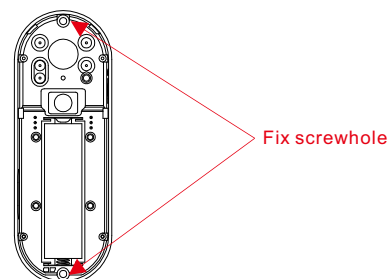

Step4: install one pcs 18650 battery.

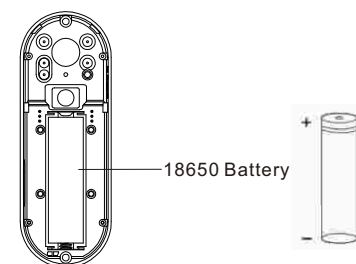

Setp5: Press the Reset button long until you hear the "system reset" prompt from the doorbell speaker. Close the cover and lock the bottom screw of the cover.

Indoor chime user manual

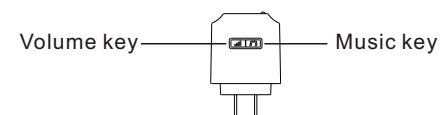

Volume settings

Press the volume key once to trigger one time, 5 levels volume cycles from low to high . In mute mode, only flashing light when press the remote control .

Music key

Press once to trigger one time, press for next music to play once.

Change the ring

The indoor chime has 18 kinds of music for options. You can press the music key to choose your favorite music.

Press the volume button for 5 seconds till a prompt tone "Ding", then turn into learning mode, press the doorbell button right now, when the indoor chime made a " Ding ...Ding "prompt tone, means the relevant music of indoor chime triggered by the doorbell was changed.

This equipment has been tested and found to comply with the limits for a Class B digital device, pursuant to part 15 of the FCC Rules. These limits are designed to provide reasonable protection against harmful interference in a residential installation. This equipment generates, uses and can radiate radio frequency energy and, if not installed and used in accordance with the instructions, may cause harmful interference to radio communications. However, there is no guarantee that interference will not occur in a particular installation. If this equipment does cause harmful interference to radio or television reception, which can be determined by turning the equipment off and on, the user is encouraged to try to correct the interference by one or more of the following measures:

- Reorient or relocate the receiving antenna.
- Increase the separation between the equipment and receiver.
- Connect the equipment into an outlet on a circuit different from that to which the receiver is connected.
- Consult the dealer or an experienced radio/TV technician for help.

Caution: Any changes or modifications to this device not explicitly approved by manufacturer could void your authority to operate this equipment.

This device complies with part 15 of the FCC Rules. Operation is subject to the following two conditions: (1) This device may not cause harmful interference, and (2) this device must accept any interference received, including interference that may cause undesired operation.

This equipment complies with FCC radiation exposure limits set forth for an uncontrolled environment.

This equipment should be installed and operated with minimum distance 20cm between the radiator & your body.