



Warning: Changes or modifications to this unit not expressly approved by the party responsible for compliance could void the user's authority to operate the equipment.

CRYSTAL ACOUSTICS | WiSound Teevy Quick Guide

Thank you for purchasing Crystal Acoustics Teevy

Teevy uses a **unique driver design** to create a fully immersive 360° **room filling musical experience**, as well as convenient, compact size **for placing it anywhere in your home**.

Small yet powerful, it produces an **unexpectedly deep and clear bass**

With Teevy, you can **connect numerous devices** and enjoy countless hours of **non compromised listening**

Acoustic Features:

- **5 Drivers** (Teevy-5MR), **6 drivers** (Teevy-6MR) with Balanced Directivity for **wide sound everywhere in the room**
- **Ideal In-Room** response using **WiSound technology**
- **Incredible Bass** down to **38Hz** (Teevy-5MR), **35Hz** (Teevy-6MR)

Note: This equipment has been tested and found to comply with the limits for a Class B digital device, pursuant to Part 15 of the FCC Rules. These limits are designed to provide reasonable protection against harmful interference in a residential installation. This equipment generates, uses and can radiate radio frequency energy and, if not installed and used in accordance with the instructions, may cause harmful interference to radio communications. However, there is no guarantee that interference will not occur in a particular installation. If this equipment does cause harmful interference to radio or television reception, which can be determined by turning the equipment off and on, the user is encouraged to try to correct the interference by one or more of the following measures:

Reorient or relocate the receiving antenna.

Increase the separation between the equipment and receiver.

Connect the equipment into an outlet on a circuit different from that to which the receiver is connected.

Consult the dealer or an experienced radio/TV technician for help.

*This equipment complies with FCC RF radiation exposure limits set forth for an uncontrolled environment.

This equipment should be installed and operated with a minimum distance of 20 centimeters between the radiator and your body.*

1 Place it

Teevy is designed **to be placed under your TV**. The TV must have a base **no wider** than **580mm** (Teevy 5) or **780mm** (Teevy 6) and **no deeper** than 280mm (Teevy 5 & Teevy 6) and must weigh **no more than 60kg** (30lbs).

If the TV base is **too large to fit**, place Teevy on an extra **shelf under your TV rack**, taking care **not to cover the unit's side speakers**. Alternatively, you can **mount it on the wall**.

To mount your Teevy on the wall, you'll need to drill **two holes**:

1. Mark with a pen or pencil the points where you'll drill the holes. **The distance between the two holes is 400mm for Teevy 5 and 600mm for Teevy 6.**
2. **Drill the holes** on the **wall** using a drill.
3. **Place the plugs** in the **holes on the wall** and enter them **fully** (you may need a hammer).
4. Screw the mounting **hooks in the plugs**.
5. **Hang** your Teevy on the **wall**, with the **high/mid drivers looking up and sideways**. After placing it, **pull gently on each side**, to make sure that the two support points are secured.

WiSound Speaker

Drivers firing forward, sideways and upwards

Room-filling sound

Full Source Size
With natural sound height

Rich feeling of space

Wide dispersion with zero directivity

Wide listening area

Sound from reflections

Direct Sound

Wide Listening Area

Conventional Speaker

Front-firing speakers only

Narrow sound
Limited sweet spot

Limited Source Size
Lack of height in sound perception

Narrow feeling of space

High directivity

Narrow listening area

Narrow Listening Area

Sweet Spot

2 Connect it

Connect Teevy to your devices through:

1. **Optical:** If available, use this connection **for best quality**
2. **RCA:** Connect **both left and right** channels to your device
3. **AUX 3.5mm:** Connect to the **headphone** output of your device
4. **USB:** Play songs from your **USB HDD/Flash** or **charge your phone/tablet**
5. **Ethernet:** Get **network access** in case of no/weak Wi-Fi signal

CRYSTAL ACOUSTICS

with WiSound technology

www.CrystalAcoustics.com

www.WiSound.com

*Note: When the 3.5mm socket is used, it takes **priority** over the **RCA** input and it becomes the **Auxiliary Source**. In this case the **RCA** input is **muted**.*

*Note: To **save power**, Teevy will **automatically turn off** (in optical / line-in mode) if **no sound** has played through it for **30 minutes**. It will automatically **turn on** again once it **receives a signal**.*

3 Control it

Control Teevy by the included **remote control**.

Power ON/OFF

Play/Pause

Previous Track

Web Radio Presets

Learning Function

Mute

Volume Up

Next Track

Volume Down

Bluetooth Pairing

Input Selector

CRYSTAL ACOUSTICS

WiSound

*Note: If in **maximum volume** you are experiencing **crackling sound** during heavy **Bass passages**, the **protection mechanism** for the amplifier and speaker drivers has been activated. **Turn down the volume a bit!***

4 Select it

Use the **Input button** on the **unit** or on the **remote control**, to **cycle** between the various available options:

Bluetooth

Optical

Auxiliary

WiFi

Input colors are according to table:

Color	Input
Blue	Bluetooth
White	Optical
Green	Aux
Yellow	Wi-Fi

5 Pair it [Bluetooth]

You can connect your Teevy with any **Bluetooth enabled device** (phone, tablet, computer, etc).

1. Select the **Bluetooth input** on the **remote** by **cycling Inputs**.

2. To **pair** a Bluetooth device to Teevy, **press and hold the pairing button** for about **5sec**. The Bluetooth indicator LED will **start blinking**.

3. Consult the instructions of the device **to be paired** to connect to Teevy. Successful pairing will be signaled by a **'beep'** from the unit and the **Bluetooth indicator LED** will **stop blinking**.

Settings Bluetooth

Bluetooth

DEVICES

Cuby 7 Not Connected

Cuby 9 Not Connected

Once paired, **music** from your device **will play** through the unit.

To add another Bluetooth device, **repeat from step 2**. Teevy may store up to **eight** paired devices in memory.

6 Network it [Wi-Fi]

Use **App Store** (IOS devices) or **Google Play** (Android devices) to download **WiSound** application (**Wi-Fi connection and internet access are required**).

Run the App and **follow on screen guide** to setup network.

To **add the first speaker** in your network:

1. Press **Add Device** button



2. Type the **password of your wifi network** and press next



3. Press the **WPS button** on the **back** of your **speaker** and press **next**



4. The **App** searches the speaker and **automatically adds it** to your **network**

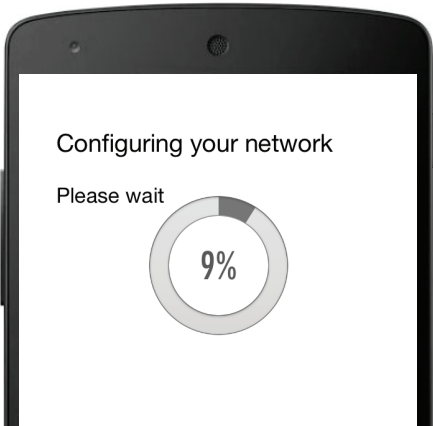

5. You can now **select the speaker's name** or **set a custom one**

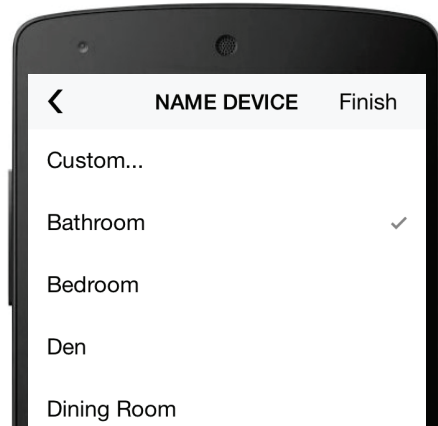

6. To **add more speakers**, **press + on the top right** and **repeat steps 1-5**



Note: If you use **Ethernet connection**, instead of Wi-Fi the above procedure is not required. You **just need to run the App** and the speaker is already there!

Table below summarizes the **network status** depending on **LED**:

Useful:

If there is **no Wi-Fi router available**, you can connect your phone/tablet **directly** to the speaker's network. Typically the name is **TeevyX_YY** and the default password is **Wisound1234**. You are strongly advised to **change this password** through the **App** or through your **speaker's web interface (10.10.10.254, under Network tab)**

7 Group It

In the **list of the available speakers**, grab and **drag one speaker and drop it over another speaker**. In this way, this speaker (slave) becomes **part of a group** and **Master's music** is also played through all the **Slave speakers**.



If you want to **ungroup**, just grab and **drag the slave speaker below the middle line**. Slave speaker becomes Master speaker and **can play different music**.



Useful:

- You can make **one or more** groups
- You can have **more than one Slave** speakers under the **same Master**
- In a Group, even if the source is **Optical / Line in / Bluetooth**, you can listen to Slave speakers playing the **same song** as the Master speaker (**Redirect feature**)
- You can simultaneously control the **volume of all the speakers** in a group by using Volume buttons of your phone/tablet
- For a **Group** configuration, choose which speaker can play **Left (L) , Right (R) or Left/Right (LR)**, by touching the **relevant icon**.

8 Learn it

You can **control Teevy's volume** with your **TV's remote control**. To learn your TV's remote to Speaker:

1. Keep pressed **LEARN** button on **remote** for about **2 seconds** (LED slow blinking)

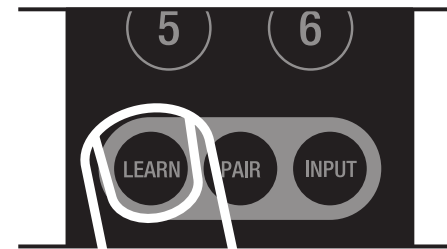

2. Press either **Vol+ on speaker's remote** (LED fast blinking)



3. Press relevant **Vol+ on TV's remote** (LED stops blinking)

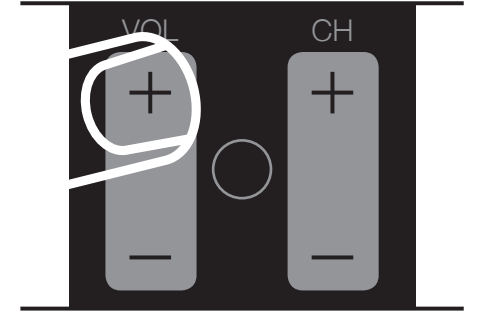

4. Repeat steps 1-3 for **Vol-**

Note: Some TV remotes **may not be compatible** with **Learning function**

9 Play it

Music Selection

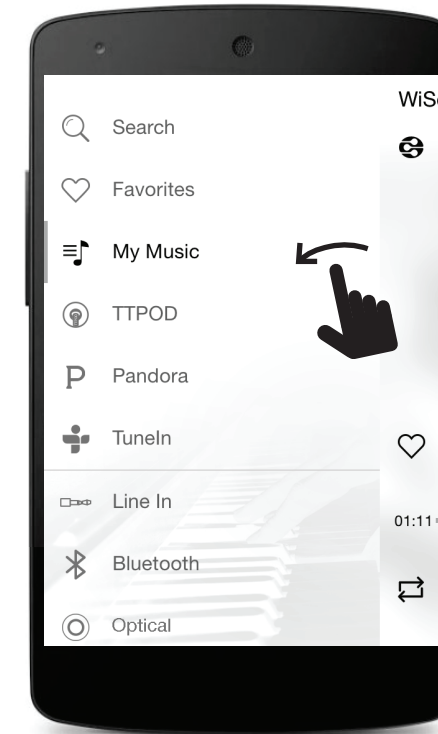

Now playing



Available speakers

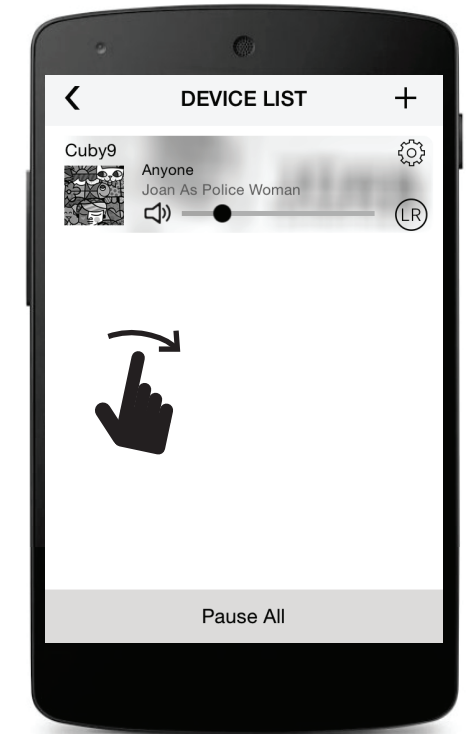

- Select your **local** songs or **USB** songs through **My Music**
- Access **Web Radio** through **TuneIn**
- Change **Input** through **Line In / Bluetooth / Optical**
- Search** for **online songs** through **Search**
- Access** your **Favorites** through **Favorites**
- Access **Web services** (Pandora/Spotify/Deezer) by touching the **corresponding icons** (region dependent)

Useful:

Your friends/guests can **stream** their music to the **entire group** of speakers **without downloading any Apps** or having to **connect** to your sensitive **Wi-Fi** network. Just ask them to **pair** their phones/tablets via **Bluetooth** to the **Master speaker!**

10 Preset it

To **assign** web radio stations to **preset** buttons (up to 6 stations can be assigned):

1. Select **TuneIn**

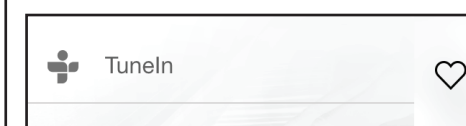

2. Browse your favorite **station**



3. Press the **small icon** next to the **web radio station**



4. Select the required **preset number**



Any time wishing to **access** the **preset** web radio stations, simply **select Wi-Fi as input** and **press** the relevant **button** on the **remote**.

11 Charge it

You can charge any **USB** powered device. Just **plug it** to your Teevy's **USB Power Out**.

CrystalAcoustics.com | WiSound.com
WirelessMultiroom.com