

Product Description

LEA-ATT-WPB915-A is a "wearable panic button". The "wearable panic button" is a wireless connected wearable accessory that allows the user – by pressing the button – to send a panic message to predefined contacts, through a gateway.

- Multi-wear accessories: it can be adapted on a wristband, on a pendant around the neck or on the belt.
- Water resistant: it can be worn in the shower or bath
- LED indicates transmission.
- It is powered by a removable battery.
- The battery cover is connected to a tamper switch which detects when the cover is opened to send a message to the gateway

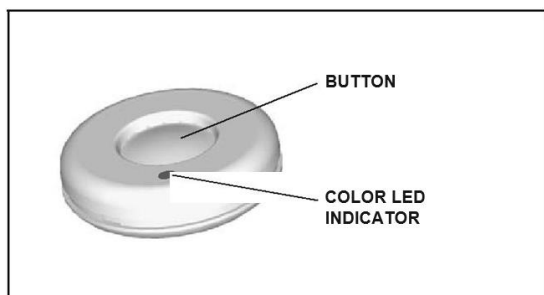

Figure 1. Panic Button Features

LED Status

- Panic button – hold until LED turns from red to green (blinking)
- Battery cover tamper – LED blinks shortly in red
- Nominal state (idle mode) – LED is off

Panic Button

- 2sec press will trigger panic message

Accessories

Figure 2. Panic Button accessories mounting

Replacing the battery

Use an appropriate coin to rotate and open the battery cover. The arrow on the cover must be pointing at the "O" letter before trying to extract the cover.

Remove old battery, and insert a new one (only use brand new batteries).

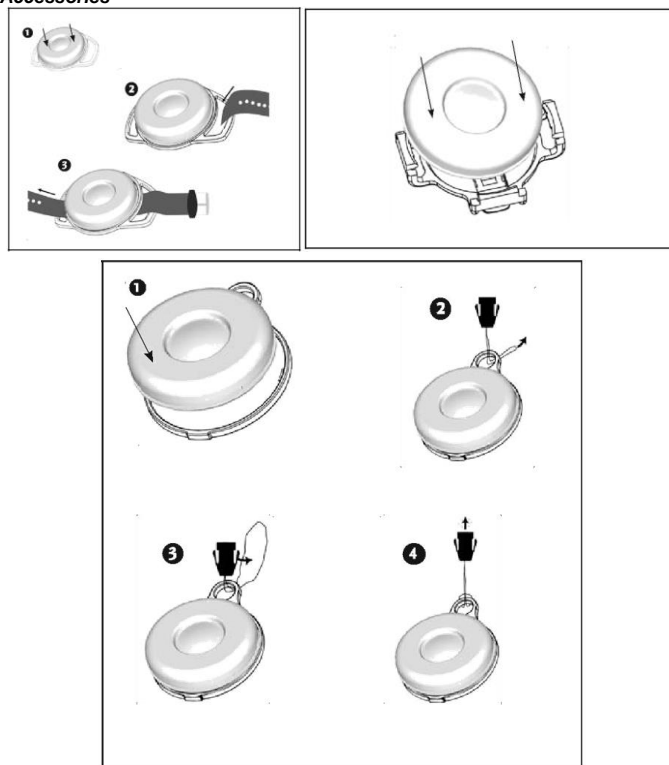
Control that the rubber joint is clean and well positioned inside the device before re-inserting the cover.

With an appropriate coin, rotate and close the battery cover. The arrow on the cover must be pointing at the "C" to ensure correct closure.

WARNING: incorrect operations may result in the loss of waterproofness.

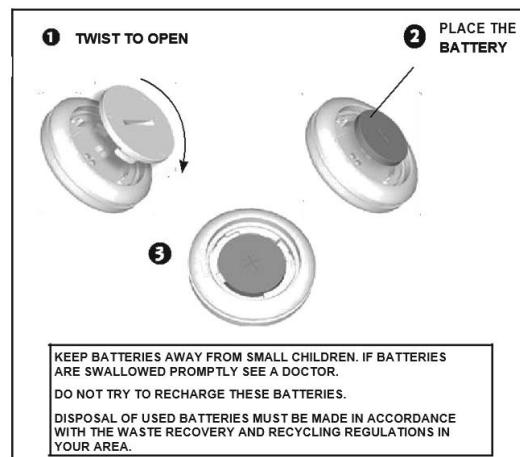

Figure 3. Panic Button Battery Replacement

Packaging content

- 1 Wearable Panic Button
- 1 CR2032 battery
- 2 Wristbands with 1 watch clip
- 1 Lanyard with 1 necklace clip
- 1 Belt clip
- Installation notice

Technical description

Size: diameter =1.5inch and thickness =0.4inch with housing material made of plastic (PC)

Operating temperature: 0°C to +45°C

Battery: 3VDC Lithium CR2032

Data Protocol: proprietary FW-Protocol

Modulation Type GFSK (1 Frequency) with frequency hopping

Frequency band: 902MHz to 928MHz (central operating frequency is 915MHz)

Channel 20dB bandwidth: 135kHz

Channel receive bandwidth: 231kHz

Channel spacing: 250kHz

Maximum conducted output power (at antenna port): 0dBm

Crystal oscillator reference frequency: 27MHz for operations and 32.768kHz for standby mode.

Recycling Information

LEA products are marked with the WEEE mark (in accordance with the Waste Electrical and Electronic Equipment Directive). This product should not be disposed of with regular waste or recycling. Unusable or unneeded equipment should be taken to a local electronic waste facility. Contact your local government for locations.

RoHS – Restriction of Hazardous Substances Directive

The RoHS directive aims to restrict certain dangerous substances commonly used in electronic and electronic equipment. LEA PLC adapters comply with this directive.

FCC Compliance Statement

This device complies with part 15 of the FCC Rules. Operation is subject to the following two conditions: (1) This device may not cause harmful interference, and (2) this device must accept any interference received, including interference that may cause undesired operation.

Any changes or modifications not expressly approved by the party responsible for compliance could void the user's authority to operate the equipment.

FCC ID: 2AFAY LEA002



HALWPB0R9-SMDL01