

WooriKooli W User Manual

Streaming Media Player



- ※ Read this manual thoroughly before using this product.
- ※ The images used in this manual may be different from the actual appearance of the products.
- ※ The meaning of the signs used in this manual is as follows.

Note In case of something to refer to in using the product

Caution In case product damage or malfunction is inevitable if instructions are not properly followed.

Copyright © 2015 KOOLi Inc. All rights reserved.

- ※ The description and images in this manual may be changed without prior notice to enhance the function of the product or for other reasons.

WooriKooli W at a Glance

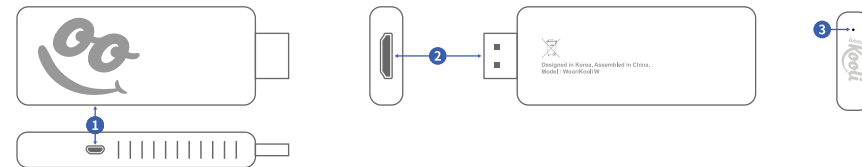

- 1 Micro-USB** : Supplies power when connected to a power adapter or USB port of your TV.
- 2 HDMI** : Plugs into the HDMI port of your TV. It can be connected to other TVs or monitors with an HDMI port.
- 3 LED Lamp** : Displays the status of the power adapter or USB power connection.
When it is functioning normally, the white lamp is turned on. If power supply is cut off, the lamp is turned off.

Caution Power should be supplied to the USB port. Use a power adapter to supply power.

Remote Functions

- 1 Power** : Activates or cancels Sleep Mode. WooriKooli W will be restarted when this button is pressed for longer than three seconds
- 2 Status LED** : Displays the operation and input status of the buttons of a remote
- 3 Search** : Browses contents that you want to watch
- 4 Navigation** : Moves between menus on the screen
- 5 OK** : Selects and executes the menu
- 6 Back** : Moves to the previous screen
- 7 Home** : Displays the main home screen

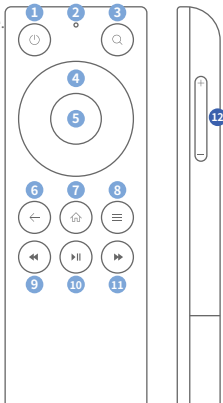

- 8 Menu** : Executes function of the menu (When a specific function is in execution, the related menu will be displayed)
- 9 Rewind** : Moves to the screen 10 seconds earlier during the runtime of the content
- 10 Play/Pause** : Plays or temporarily stops the content
- 11 Fast Forward** : Moves to the screen 10 seconds later during the runtime of the content
- 12 Volume** : Control the volume

Note You can use the remote that came with your TV or receiver to change the volume

Preparation—Step 1: Installation



1. Connect the USB power cable to WooriKooli W and then to the HDMI port of your TV. (Use an extension cable for HDMI, if necessary.)
2. Connect the USB power cable to the power adapter, which is plugged into the outlet. If it is difficult to connect with a power adapter, connect the USB power cable to the USB port of your TV.
3. Turn on your TV and select the input setting on your TV to match the input port where the HDMI cable is connected.

Caution Power adapter connection is recommended as some USB ports do not provide sufficient continuous power.

Preparation—Step 2: Remote

Insert batteries

1. Press the battery door latch down to remove the battery door.
2. Insert two AAA-size batteries.
3. Slide the door back into place.

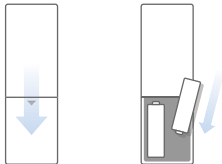

Pairing WooriKooli W with a Remote

Make sure that WooriKooli W is properly connected to your TV before remote pairing and confirm that the TV power and HDMI are selected for input setting.

1. Press the OK button and the Home button at the same time, and hold for three seconds. (If the LED lamp blinks six times in a row at regular intervals, the pairing process is completed.)
2. After completing the pairing process, press the OK button to move to start to use.

Note If the remote isn't working, press the OK button and the Home button at the same time, and hold for longer than three seconds.

Start to use —Step 1: Initial Setting

The initial setting is allowed only once after the purchase of the product. After that, you can check and change the relevant setting on the setting menu.

1. **Network Connection** : If you use a wired Ethernet network to connect, WooriKooli W automatically detects your network. If you use a wireless network to connect, select your network from the list and enter your network password.
2. **Screen Resolution** : You can adjust the width and length.
3. **Time Zone** : You can select the time zone for the area of use. When selection is completed, move to steps for Product Verification.

Caution · If not connected to the network, you cannot move to the next step.
· Check the Wi-Fi connection of the internet router installed nearby.

Start to use—Step 2: Product Verification

WooriKooli W offers membership-based service. To start using the service, complete the product verification process, and register for membership on the web site.

1. To check the verification code

Check the 4-digit verification code comprised of numbers and alphabets on the product verification page. (It is the verification code endowed to the product. You can use the service only after the code is registered on the web site.)

2. To enter the verification code

Go to <http://go.kooli.tv> to register the verification code.

3. To register for membership

Continue the membership subscription on the web site after registering the verification code.
(For those who already registered for membership, WooriKooli W will be registered automatically.)

Use service

Once you completed membership subscription and product verification process on the KOOLi web site, you can enjoy various VOD contents on your TV including movies, dramas, variety shows, etc.

Service Packages

If subscribed to the monthly paid service, you can enjoy watching Korea's hottest TV series and movies on demand in high definition.

You can search for the content you want by pressing the search button and checking the list of contents in service on the web site.

※ Contents can be purchased individually other than the monthly paid service package.

To pay for content

When you purchase the paid content other than the monthly paid service package, the PIN Code input screen will be displayed on the purchase guide page. Enter the PIN code after confirming the registered payment information you entered at the time of membership subscription to complete the purchase.

Note

- The PIN Code is essential information to enter to purchase an individual content. You can set the information when registering for membership on the web site.
- If you lose or change the PIN Code, visit <http://kooli.tv/account>

My page

1. Notice

You can check the available update or major notifications. The related information can be checked on KOOLi's Web site as well.

2. Watch History

You can check and manage the history of your VOD contents watched.

3. Purchase History

You can check the service package you are using and the purchase history of individual VODs.

4. Parental Control

You can turn parental controls on or off. Enter the PIN Code to confirm your settings.

Note If you want to subscribe to or change the service package in use, check the related information via <http://kooli.tv/account>

Caution

When the product is connected via the wireless network, the connection can be unstable because of the long distance between the product and the router or radio interference. It is recommended to install the wireless router near the proximity of your device and avoid radio interference elements such as walls, electric wave devices, etc. (If the wireless connection is not available, wired connection is recommended.)

Safety Precautions

- Avoid places with direct sunlight or heated areas as there could be a risk of explosion or electric shock.
- Be careful not to drop this product from a high location. Do not disassemble, repair, or reorganize the product as well as it may cause a fire or electric shock.
- Unplug this product for safety if not used for a long time.

Use and Handling

- Do not apply shock or impact on the remote as it can malfunction.
- Keep the product away from liquid or other foreign substances.
- Avoid places with vibration or magnetic force.

Caution in Using Batteries

- Check + and — when inserting batteries into the remote. If not matched properly, it may cause a fire or damage to the remote.
- Do not use old and new batteries at the same time for the remote as the remote may not work properly.

Warranty

Warranty Period

- The warranty period is counted as of the date of purchase. Thus, check the date of your purchase.
- The warranty service will be available for a year since the date of your purchase.
- If the product is experiencing functional failure within the warranty period during the normal process of use, it can be repaired or replaced under the warranty.

Coverage of Warranty

We will have no obligation to replace/repair the product if the warranty is expired or if the product becomes defective because of the following:

1. Defect is attributed to the user's mistake or is caused by:

- arbitrary disassembly or reorganization;
- repair done by someone who is not one of our designated engineers;
- the user's mishandling or misuse of the product (dropped, submerged in water, shock exposure, damage, forced manipulation, etc.);
- the use of nonregular parts or accessories.

2. Defect is caused by other reasons such as:

- an act of nature (damage by fire, brine, storm, flood, lightning, etc.);
- the expiration of expendable parts (terminals and various attachments);
- failure to properly follow the manual, or nonconformance with instructions.

Note For more details on the warranty and replacement policy, visit <http://kooli.tv/support>

What's in the box



WooriKooli W



Remote



User guide

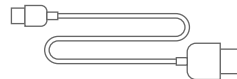

USB cable

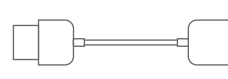

HDMI extension cable



2 x AAA batteries

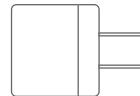

Power adapter

Other Information



FCC ID : 2AF8K-W

Designed in Korea. Assembled in China.

FCC RF INTERFERENCE STATEMENT

NOTE : Change or modification not expressly approved by the party responsible for Compliance could void the user's authority to operate the equipment

NOTE : This equipment has been tested and found to comply with the limits for a Class B digital device, pursuant to Part 15 of the FCC Rules. These limits are designed to provide reasonable protection against harmful interference in a residential installation.

This equipment generates, uses and can radiate radio frequency energy and, if not installed and used in accordance with the instructions, may cause harmful interference to radio communications. However, there is no guarantee that interference will not occur in a particular installation.

If this equipment does cause harmful interference to radio or television reception which can be determined by turning the equipment off and on, the user is encouraged to try to correct the interference by one or more of the following measures.

- Reorient or relocate the receiving antenna.
- Increase the separation between the equipment and receiver.
- Connect the equipment into an outlet on a circuit different from that to which the receiver is connected.
- Consult the dealer or an experienced radio, TV technical for help.
- Only shielded interface cable should be used.

Finally, any changes or modifications to the equipment by the user not expressly approved by the grantee or manufacturer could void the users authority to operate such equipment,

NOTE : Exposure to Radio Frequency Radiation. Antenna shall be mounted in such a manner to minimize the potential for human contact during normal operation.

The antenna should not be contacted during operation to avoid the possibility of exceeding the FCC radio frequency exposure limit.

NOTE : This device complies with part 15 of the FCC Rules.

NOTE : Operation is subject to the following two Conditions :

- (1) This device may not cause harmful interference, and
- (2) This device must accept any interference received, including interference that may cause undesired operation. For compliance could void theuser's authority to operate the equipment.

Correct disposal of this product

(Waste Electrical & Electronic Equipment)

The product and its electronic accessories(e.g. battery, cable) should not be disposed of with other household waste. Household user should contact either the retailer where they purchased this product, or their local government office, for details of where and how they can take these items for environmentally safe recycling.

Business users should contact their supplier and check the terms and conditions of the purchase contract. This product and its electronic accessories should not be mixed with other commercial wastes for disposal.

Correct disposal of batteries in this product

To protect natural resources and to promote material reuse, please separate batteries from other types of waste and recycle them through your local, free battery return system.



Visit! Kooli.tv



Copyright © 2015 KOOLi Inc. All rights reserved.