

Novi User Manual For Base

The Novi User Manual is embodied in three separate areas:

- 1) The Novi Mobile App**
- 2) The Novi Legal Insert**
- 3) The Novi Corporate Site under “Terms and Conditions”**

- 1) The Novi Mobile App. Here are screenshots from the Novi Mobile App that make up the user manual:**

novi

Create Account

Already Have an Account?





Terms and Conditions

By using this application, you agree to the [Terms of Service](#) and [Privacy Policy](#)

Cancel

Accept

Already Have an Account?



novi

Welcome!

Let's get started! Begin by removing your Relay Station and Sensor from the package



Power Relay Station

Power on the Relay Station



Connect to your router

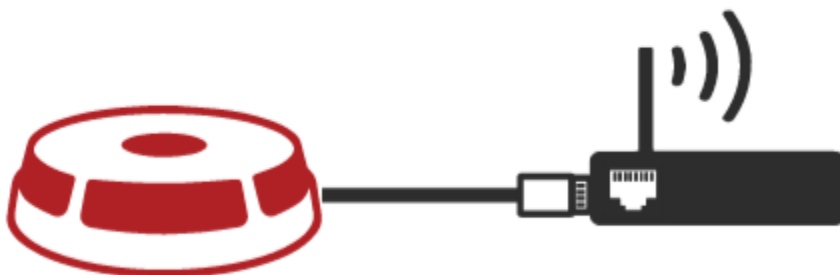

The LED on the Relay Station should now be illuminated



novi

Sync Relay Station

Enter the 5 characters on your Relay Station. You must sync before continuing.



Enter ID and Sync



Enter Relay Station ID



| | | | |
|---|---|---|---|
| A | 1 | 2 | 3 |
| B | 4 | 5 | 6 |
| C | 7 | 8 | 9 |
| D | E | F | 0 |



Register

Cancel



Enter Relay Station ID

Name Relay Station

Enter Relay Station Name

Name Relay Station

Cancel

We

!...

If



1 2 3 4 5 6 7 8 9 0
Q W E R T Y U I O P

A S D F G H J K L



Z X C V B N M



?123

,

.



Enter Relay Station ID

Name Relay Station

Enter Relay Station Name

10019 Test

Name Relay Station

Cancel

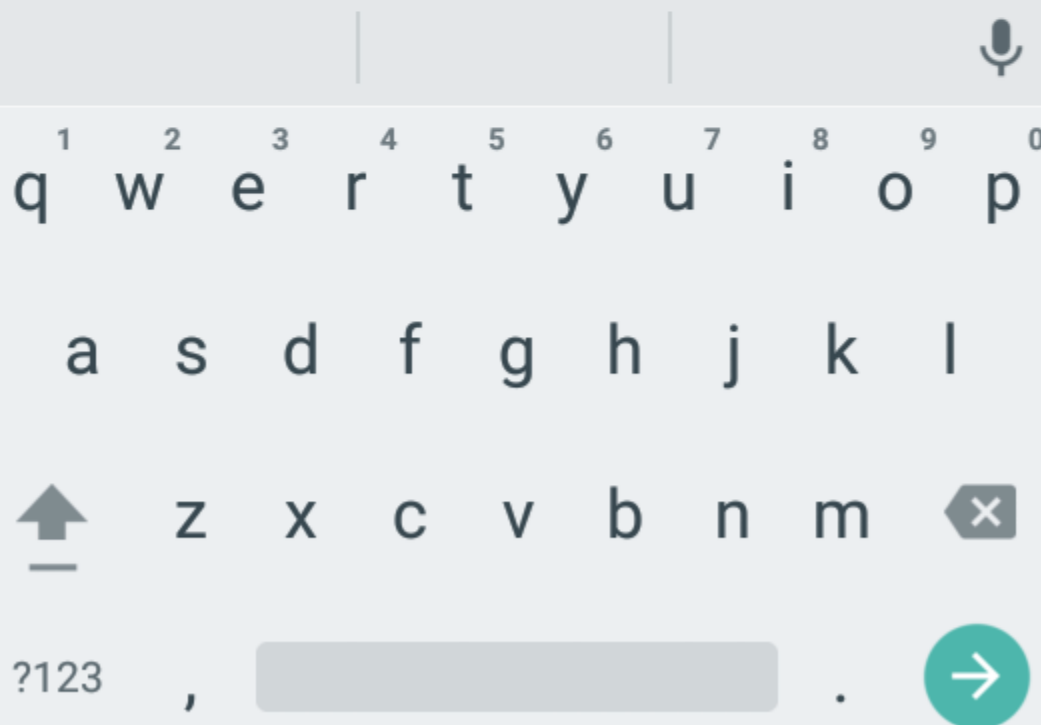

Power Sensor

Separate the Sensor from it's mounting bracket



Pull the protruding tab

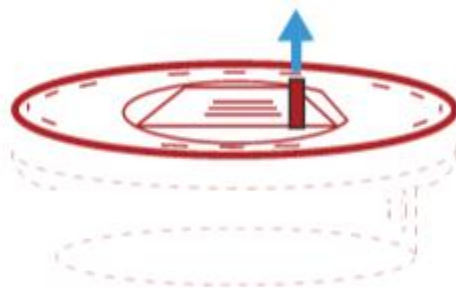



NOVI

Sync Sensor

Enter the 5 characters on your Sensor. You must sync before continuing.



Enter Sensor ID and Sync



Enter Sensor ID

0 3 7 5 3

| | | | |
|---|---|---|---|
| A | 1 | 2 | 3 |
| B | 4 | 5 | 6 |
| C | 7 | 8 | 9 |
| D | E | F | 0 |



Register

Cancel



Enter Sensor ID

Name Sensor

Enter Sensor Name

Name Sensor

Cancel

We

!

If



1 2 3 4 5 6 7 8 9 0
Q W E R T Y U I O P

A S D F G H J K L



Z X C V B N M



?123

,

.



Enter Sensor ID

Name Sensor

Enter Sensor Name

Front Room

Name Sensor

Cancel

Too

Groom

Soon



1 2 3 4 5 6 7 8 9 0
q w e r t y u i o p

a s d f g h j k l

↑ z x c v b n m ×

?123

,

.



novi

Test Picture

Before attaching the Sensor to the ceiling, hold it in the desired position and press the button below to verify correct placement

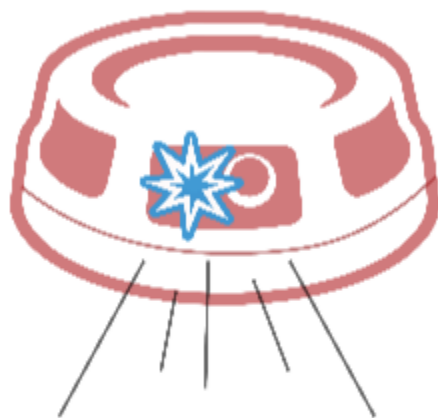

novi



Take Another

Next



Place Sensor

Apply both adhesive strips to the bottom of the
Sensor mounting bracket

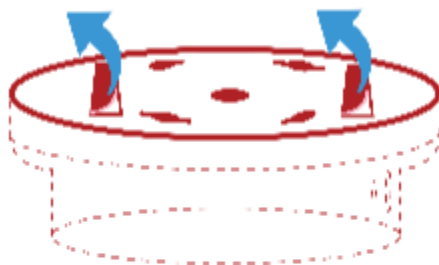

Press Sensor against ceiling firmly for 30
seconds



Rotate Sensor so that it's facing a major point of
entry



novi

Press Sensor against ceiling firmly for 30 seconds



Rotate Sensor so that it's facing a major point of entry



Next



novi

Security Pin



Emergency Contacts



Next



Create Pin

Choose a secret four digit code. You can change the pin later.



| | | |
|---|---|---|
| 1 | 2 | 3 |
| 4 | 5 | 6 |
| 7 | 8 | 9 |
| # | 0 | ← |

Cancel



AT&T



3:33

Back

Emergency



Add Contact



Add Emergency Contact

Name

Phone Number

Address Book

Notify After

hour(s)



minute(s)

20 Minutes



 Cancel

Add 



novi

Security Pin



Emergency Contacts



Next



novi

Setup Complete!

Your system has been setup properly.

Get Started



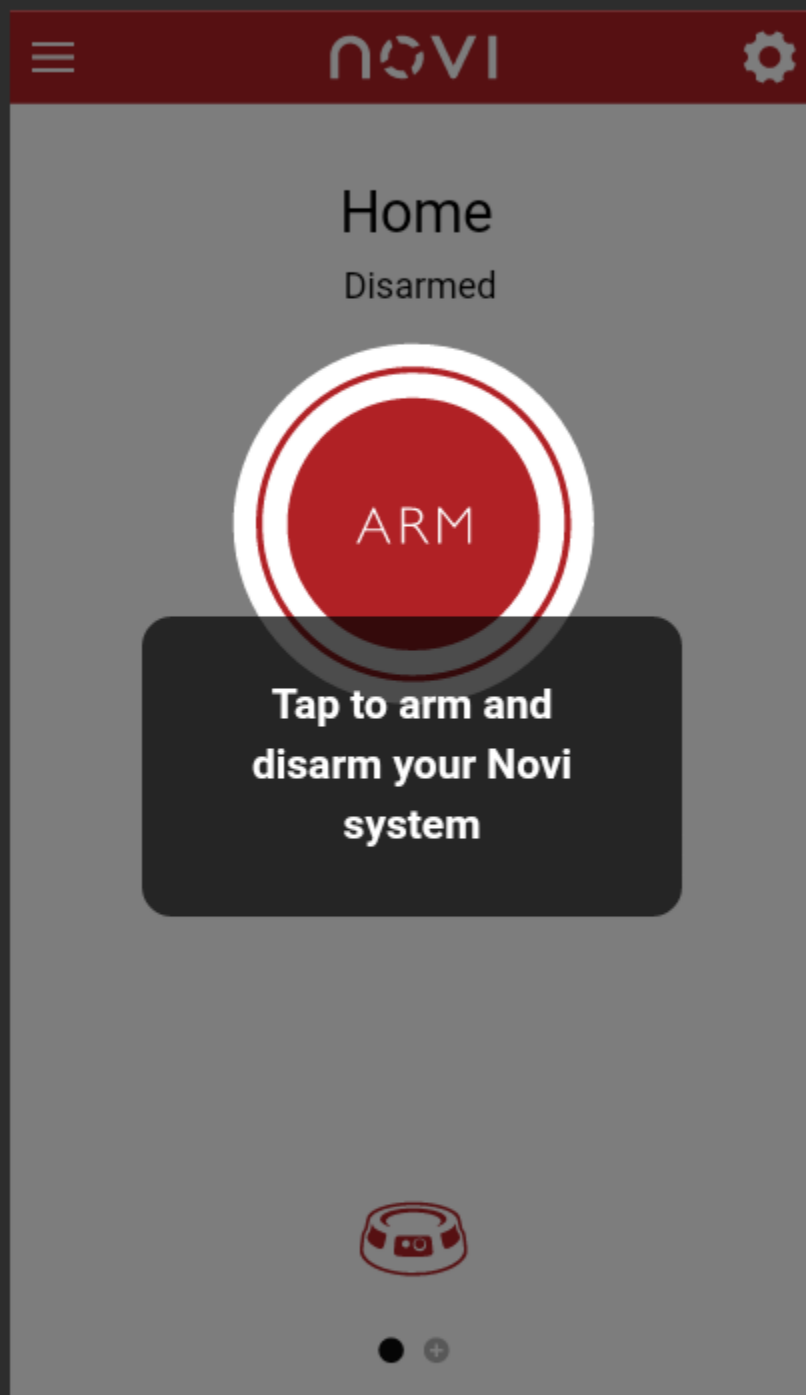

Tutorial

Done

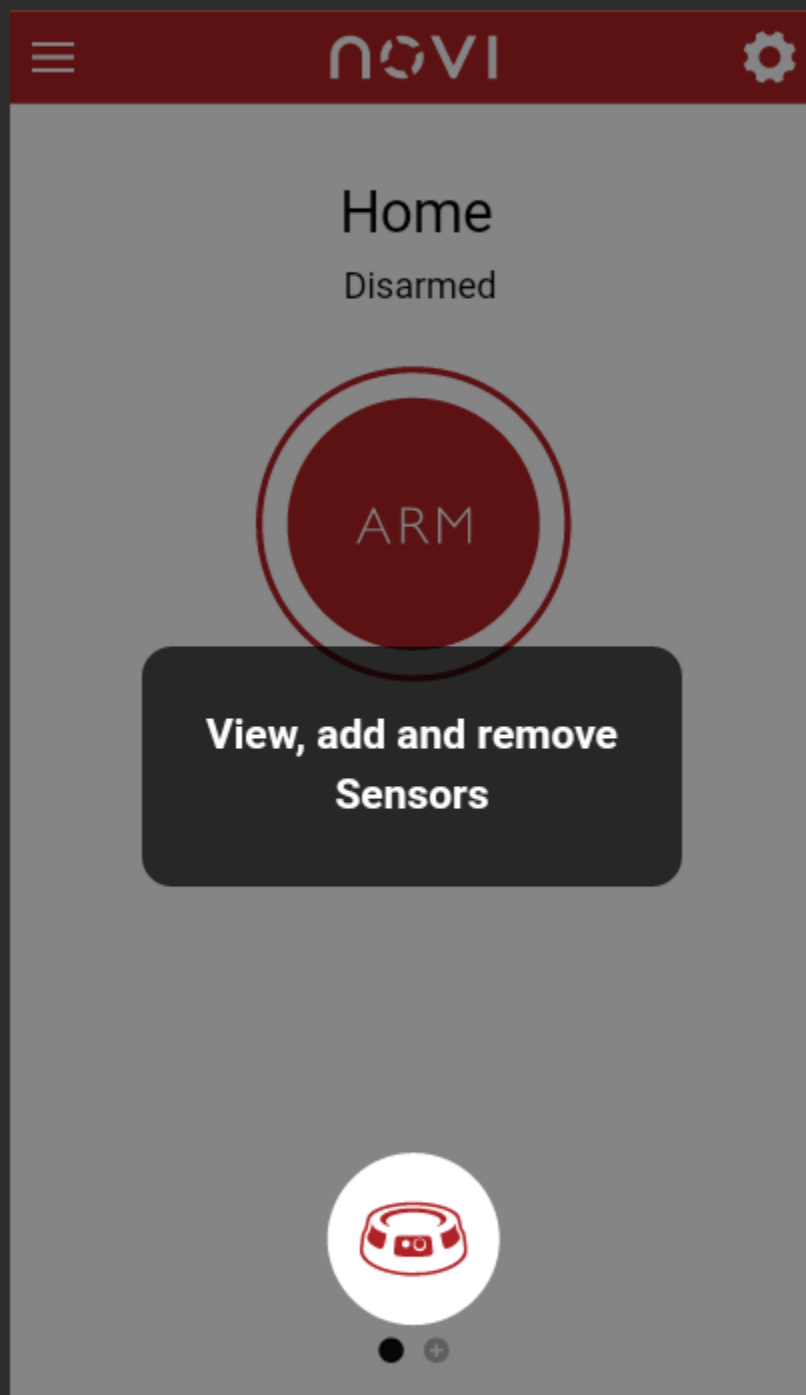

Tutorial

Done

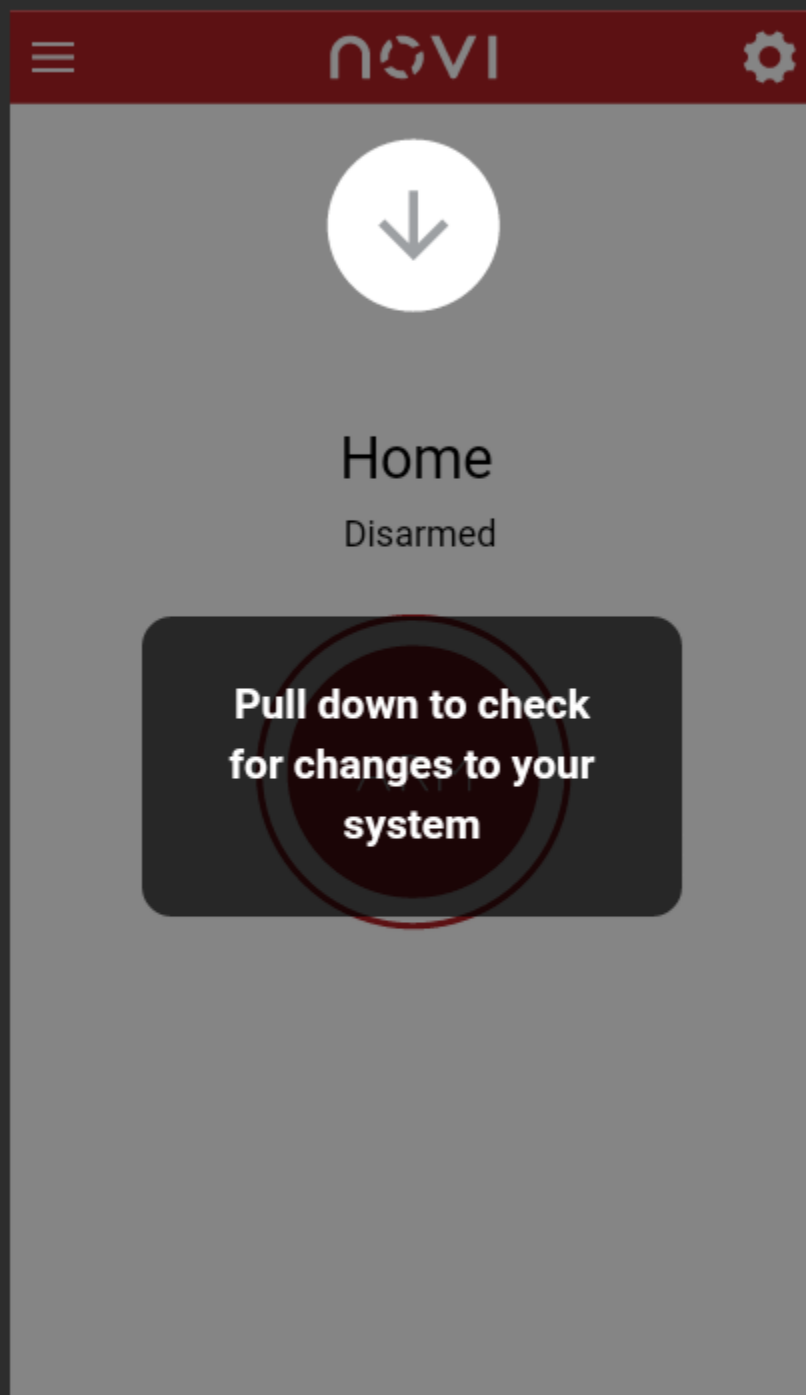

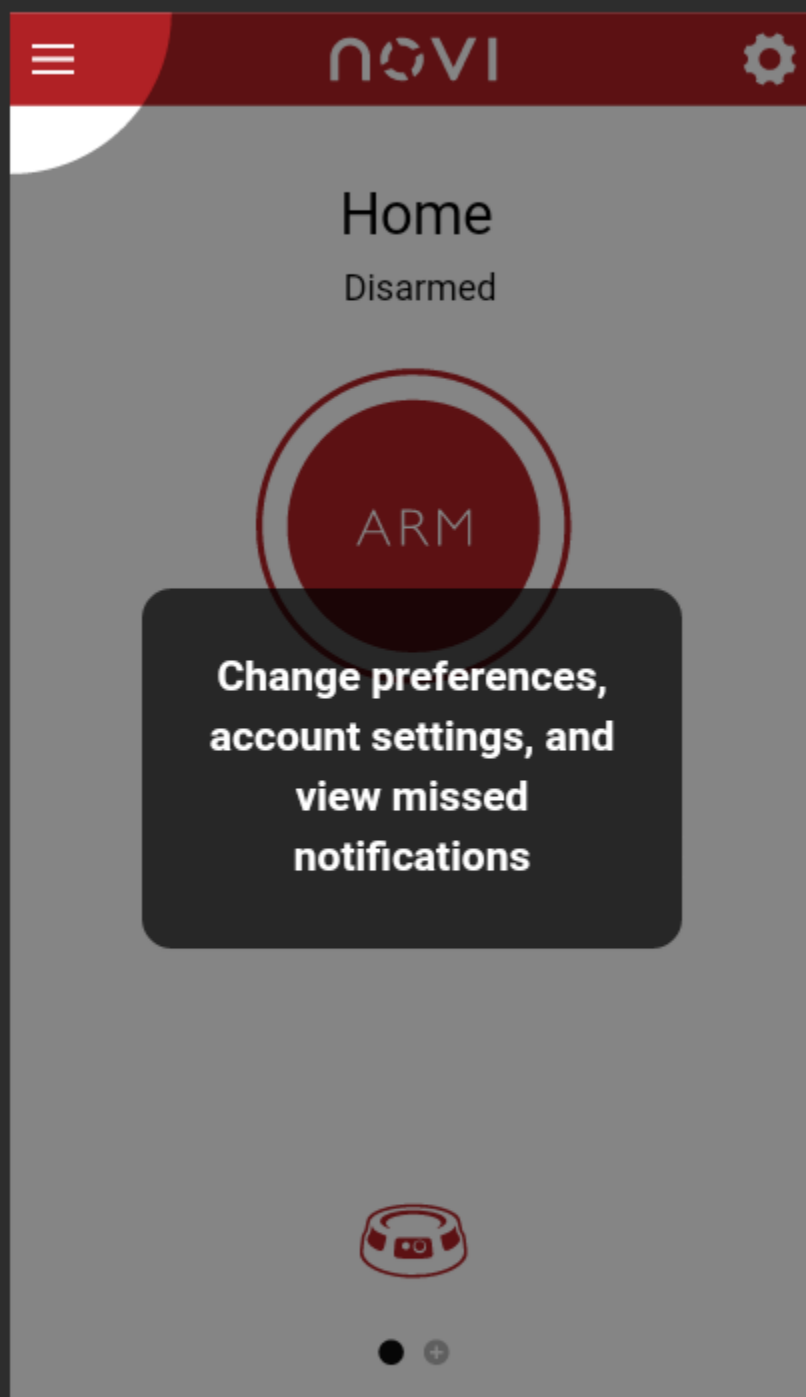

Tutorial

Done

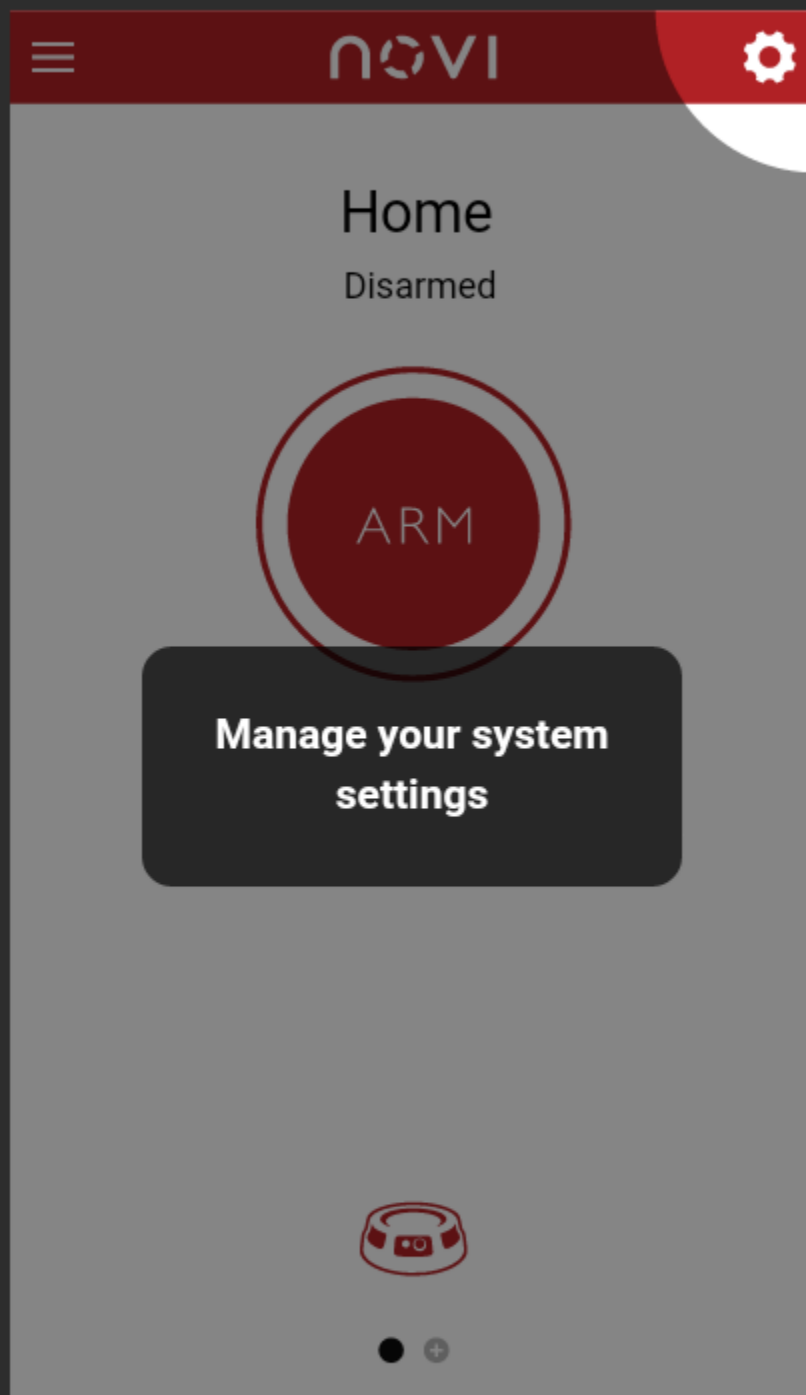

2) The Novi Legal Insert

Installation

When installing, always:

1. Use safety glasses
2. Use a ladder that is secured. Always follow all written instructions for the ladder you are using as well as all warning and caution labels on the ladder, itself.

For Novi Sensor to detect motion or smoke it must be placed on the ceiling facing the entry point that you want protected. Positioning the Sensor correctly to detect motion is subject to many variables. Users should test (1) positioning, (2) detection, and (3) threshold settings to ensure optimum Passive Infrared motion performance. 100 percent motion detection cannot be guaranteed.

If product is installed incorrectly, product could fall off ceiling. Ensure that the Sensor(s) is/are secured tightly to the ceiling. Use care in determining whether the Sensor(s) requires adhesive tape or anchors and screws for secure and proper installation.

If the Sensor is dropped, there may be damage to the internal components not visible through the plastic casing. To test functionality, arm the Novi app and trip the motion detector to ensure that notifications, images, and siren are working properly.

Always follow all instructions for safe installation as contained in (1) the app and (2) support page of the Novi website.

Product Use

Your ability to receive app notifications is subject to having your hand-held device turned on and having cell-data coverage in your location. While Novi servers are very reliable, there may be a server error occasionally resulting in you not receiving a notification.

Warnings

This Novi Security system is NOT intended to:

- Replace your current smoke detectors or alarms
- Be a life-saving device
- Supplement a fire alarm or fire-alarm system
- Replace door locks
- Prevent break-ins
- Automatically contact the police or fire department when motion or smoke is detected

NO ALARM: No siren or alarm sounds from the Novi Security device when smoke is detected.

BATTERIES: Do not recharge, put in fire, disassemble, put in backwards or mix with used batteries or other battery types. Follow all warnings and instructions for the AA batteries you use with the device.

SENSOR MAGNET: When the Novi Sensor(s) is/are placed on the ceiling, abrupt impacts to the ceiling or the floor above the ceiling could result in the magnets separating and the Sensor(s) falling from the ceiling.

WIRELESS COMMUNICATION: All radios are subject to environmental conditions. Microwaves and building structure can greatly affect the reliability and range of the radio.

ENVIRONMENT: Novi Sensor and Relay Station are intended for use indoors in dry locations.

3) The Novi Corporate Site under “Terms and Conditions”

Regulatory Statements:

This device complies with part 15 of the FCC Rules. Operation is subject to the following two conditions: (1) This device may not cause harmful interference, and (2) this device must accept any interference received, including interference that may cause undesired operation.

This device complies with Industry Canada licence-exempt RSS standard(s). Operation is subject to the following two conditions: (1) this device may not cause interference, and (2) this device must accept any interference, including interference that may cause undesired operation of the device.

(FRENCH)

Cet appareil est conforme aux normes d'exemption de licence RSS d'Industry Canada. Son fonctionnement est soumis aux deux conditions suivantes : (1) cet appareil ne doit pas causer d'interférence et (2) cet appareil doit accepter toute interférence, notamment les interférences qui peuvent affecter son fonctionnement.

IMPORTANT! Changes or modifications not expressly approved by Novi Security, Inc could void the user's authority to operate the equipment.

NOTE: This equipment has been tested and found to comply with the limits for a Class B digital device, pursuant to part 15 of the FCC Rules. These limits are designed to provide reasonable protection against harmful interference in a residential installation. This equipment generates, uses and can radiate radio frequency energy and, if not installed and used in accordance with the instructions, may cause harmful interference to radio communications. However, there is no guarantee that interference will not occur in a particular installation. If this equipment does cause harmful interference to radio or television reception, which can be determined by turning the equipment off and on, the user is encouraged to try to correct the interference by one or more of the following measures:

- Reorient or relocate the receiving antenna.
- Increase the separation between the equipment and receiver.
- Connect the equipment into an outlet on a circuit different from that to which the receiver is connected.
- Consult the dealer or an experienced radio/TV technician for help.

CAN ICES-3 (B)/NMB-3(B)

This equipment complies with radiation exposure limits set forth for uncontrolled environment. The antenna(s) used for this transmitter must be installed to provide a separation distance of at least 20 cm from all persons and must not be collocated or operating in conjunction with any other antenna or transmitter.

(FRENCH)

Cet appareil est conforme aux limites d'exposition au rayonnement RF stipulées par la FCC et l'IC pour une utilisation dans un environnement non contrôlé. Les antennes utilisées pour cet émetteur doivent être installées et doivent fonctionner à au moins 20 cm de distance des utilisateurs et ne doivent pas être placées près d'autres antennes ou émetteurs ou fonctionner avec ceux-ci.