

WIFI Camera

## Quick Start Guide



O-KAM Pro

## FCC Warning Statement

Changes or modifications not expressly approved by the party responsible for compliance could void the user's authority to operate the equipment. This equipment has been tested and found to comply with the limits for a Class B digital device, pursuant to Part 15 of the FCC Rules. These limits are designed to provide reasonable protection against harmful interference in a residential installation. This equipment generates uses and can radiate radio frequency energy and, if not installed and used in accordance with the instructions, may cause harmful interference to radio communications. However, there is no guarantee that interference will not occur in a particular installation. If this equipment does cause harmful interference to radio or television reception, which can be determined by turning the equipment off and on, the user is encouraged to try to correct the interference by one or more of the following measures:

- - Reorient or relocate the receiving antenna.
- - Increase the separation between the equipment and receiver.
- - Connect the equipment into an outlet on a circuit different from that to which the receiver is connected.
- - Consult the dealer or an experienced radio/TV technician for help.

This device complies with part 15 of the FCC Rules. Operation is subject to the following two conditions: (1) This device may not cause harmful interference, and (2) this device must accept any interference received, including interference that may cause undesired operation.

## RF Exposure Statement

To maintain compliance with FCC's RF Exposure guidelines, This equipment should be installed and operated with minimum distance of 20cm the radiator your body.

**Vulnerability Reporting:** <http://www.szsincam.com/Reporting/>



## Camera Structure

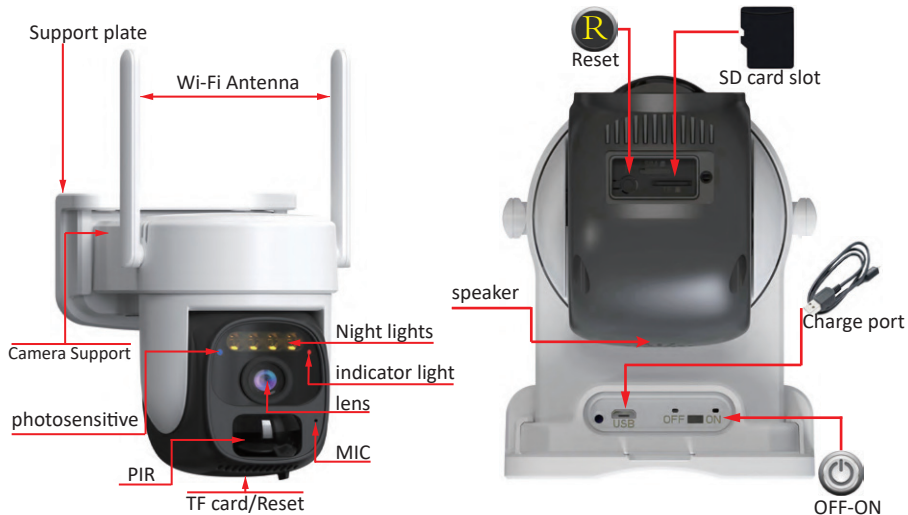

- ✘ The camera has a built-in large-capacity battery.
- ✘ Built-in micro SD card slot, micro SD up to 256Gb.

### Micro SD installation steps:

Step 1: Open the silicone cover at the bottom of the bracket and check that the toggle switch is in the "OFF" state. (note that the camera is turned off before inserting the Micro SD card)

Step 2: open the black rubber plug on the camera.

Step 3: Hold the SD card with tweezers, insert the SD card into the SD card slot, and push the SD card into place with tweezers.

Step 4: Finally push the silicone cover back.

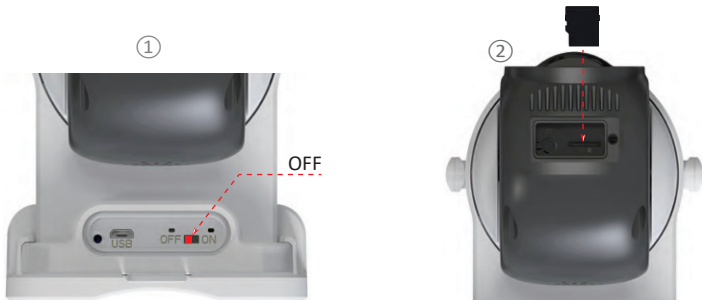

## Antenna placement Mode

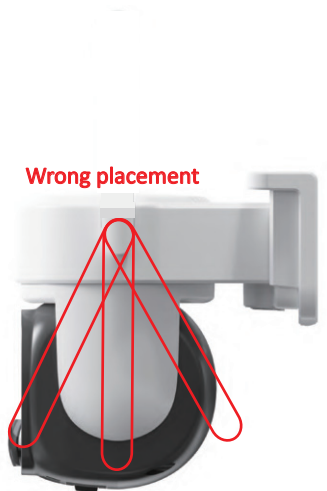

## Battery Charging

The battery inside the camera is not fully charged due to shipping safety regulations. Please use a USB cable (5V adapter not included) to charge the battery.

When charging, the LED indicator light is always red, and when fully charged, the red light goes out. The camera takes about 4 hours to fully charge.



## LED Indicator Information

LED Indicator	Description
Blue light flashes slowly	Waiting for distribution network
	Network configuration failed
Blue light is always on	Configuration complete
Blue light flashes quickly	Disconnected from the network
Green light flashes slowly	Restoring factory settings
	Device unbinding
Green light is always on	AP mode
Steady red light	Charging
Red light goes out	fully charged

## Download App

Use your phone to scan the QR code on the right to download the application, while users can use the APP Store/Google Play to search for O-KAM Pro to download.

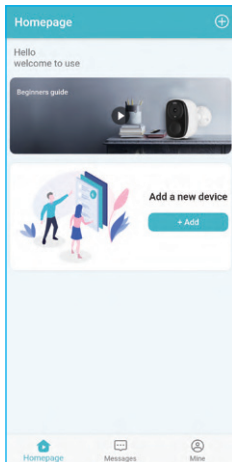
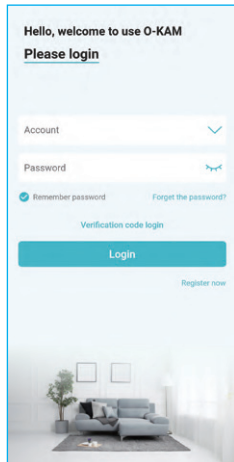



## ADD DEVICE

Step 1. Power on the camera until you hear the APP connection prompt (no prompt, you need to reset the camera).

Step 2: Click "+" on App right corner under Home page.

There will have multiple connection way for you to adding the device.

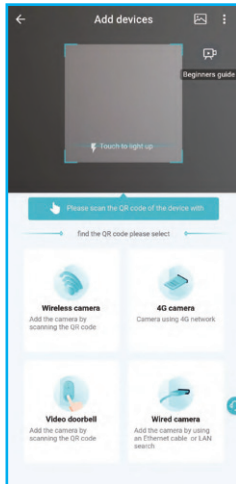
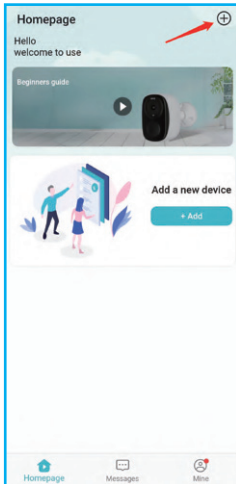

## Scan code binding

Follow below tips to connect the WiFi

1. Use the phone camera to scan the QR code on the camera body
2. The camera supports **2.4Ghz/5Ghz** WIFI, choose the best WiFi signal and enter the correct WiFi password in the password field.
3. The QR code is scanned successfully, and the app automatically jumps to the next interface.

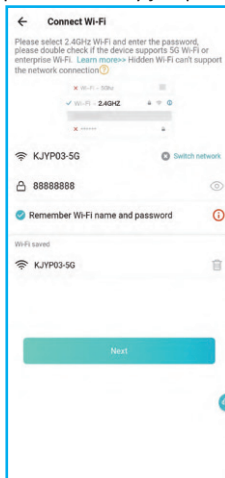
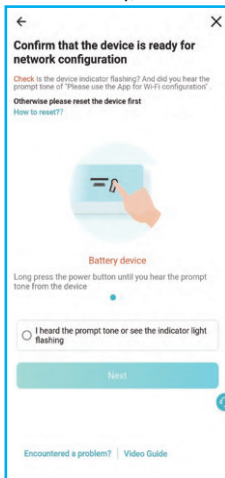

## Quickly configure the network.

1. In the interface of scanning QR code - discover new device, click connect.
2. The camera supports **2.4Ghz/5Ghz** WIFI, choose the best WiFi signal and enter the correct WiFi password in the password field.
3. Wait for the camera to connect to the router/server.

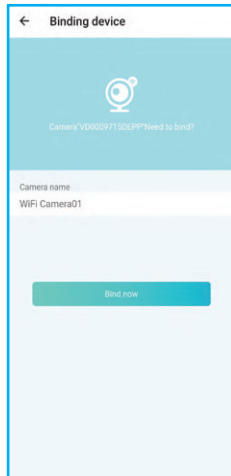
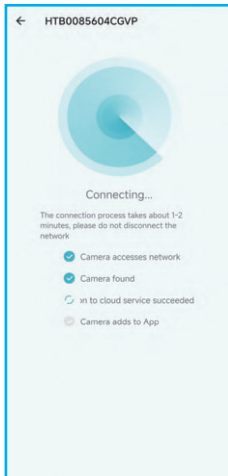
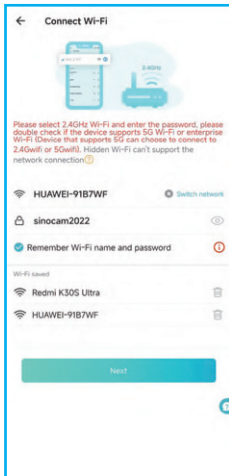
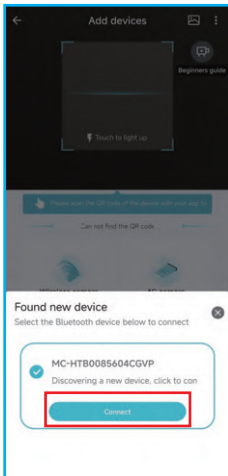

## Run A Test

After setup, tap on the live view window in the app for a test. Then take your Battery camera outside to the installation spot and run a test there. Make sure the installation spot is covered by a strong 2.4 GHz Wi-Fi /5Ghz Wi-Fi signal. If the battery camera doesn't work well outside, you may need to move the router closer to the installation spot or invest in a Wi-Fi extender.

## Installation Guide

Check the following things before you drill holes on your wall: This camera has been successfully added to your O-KAM App and is able to stream video.

### Find a good installation spot.

- ※ Die empfohlene Installationshöhe beträgt 2-2.5 Meter (etwa 6.5-8.2 Fuß)
- ※ PIR (motion sensor) setting for lighting on/off automatically is around 10M (30 Feet).
- ※ Make sure the camera's sight is not blocked.

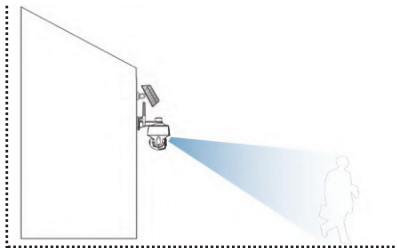

## Camera installation method

1. Mark holes on the wall using the provided drilling template. Drill 4 holes using one drill bit (15/64", 6mm).
2. Install anchors to fix the screws.
3. Align the Support plate with the drilled screw hole, and fix the Support plate to the wall with the matched screws.
4. The raised positions on both sides of the camera support are aligned with the slots on both sides of the support plate, and then push the camera upward until the camera is directly connected with the support plate.

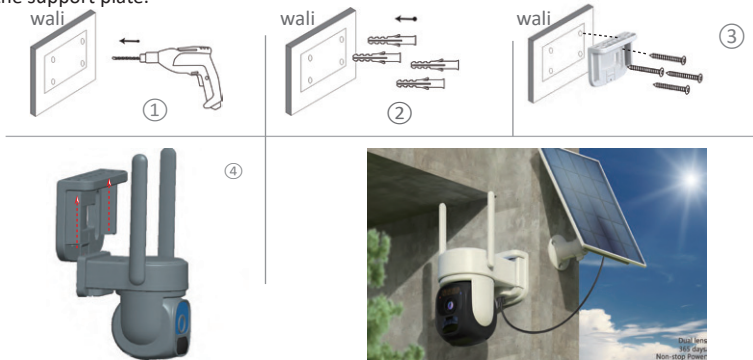

# Live Streaming Interface

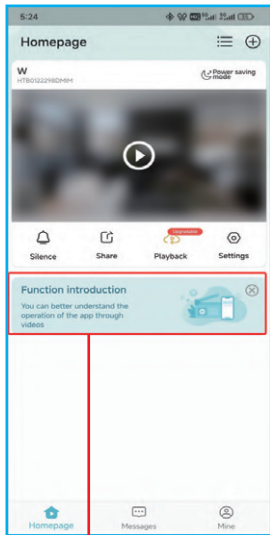

APP operation and use, video instruction

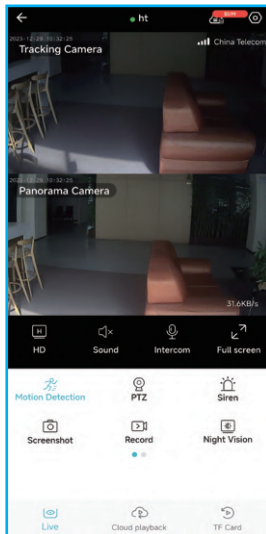

functional areas

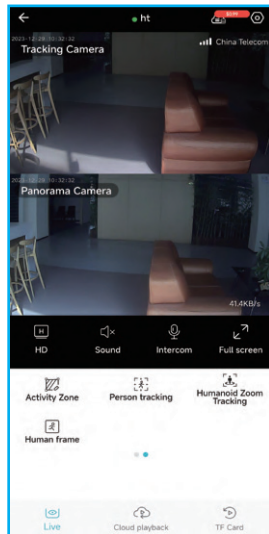

## Running the test

The app is configured and the test is run by clicking on the Live View window in the app. Then place the camera at the installation location for testing. Make sure the installation location has a strong Wi-Fi signal. If the Battery Camera does not work properly outdoors, you may need to move the router closer to the installation location or purchase a Wi-Fi extender.

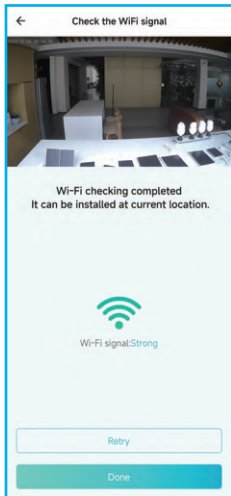
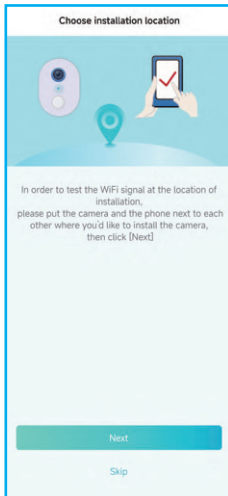
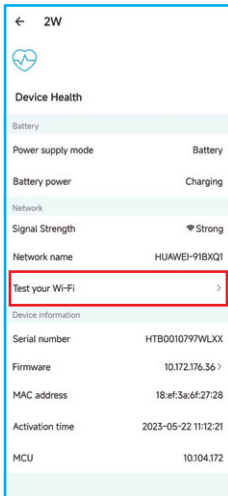
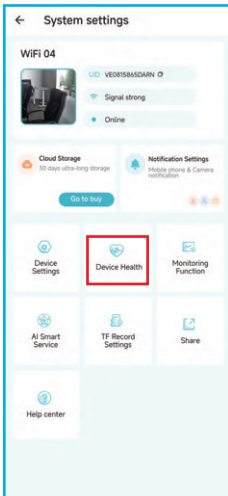

## Device Sharing

\*Share open permission, the shared person can set the function of the device; if If you turn off the permission, you can only watch the video, but cannot set the function.

