

## IMPORTANT SAVEGUARDS

When using electrical products, especially when children are present, basic safety precautions should always be followed, including the following:

### READ ALL INSTRUCTIONS BEFORE USING

#### DANGER- TO REDUCE THE RISK OF ELECTROCUTION:

Do not use the charging base near water (bathtub, sink, etc.) or outdoors. Never immerse in liquids. Choose a stable, dry location.

Check supply cord and charging device regularly for cracks or other damages. Never touch with sharp/hot objects. The supply cord cannot be replaced. If the cord is damaged the appliance should be scrapped. Never operate damaged charging device or toothbrush.

**WARNING- To reduce the risk of burns, electrocution, fire, or injury to persons.**

Use this product only for its intended use as described in this manual.

Close supervision is necessary when this appliance is used by, on, or near children or individuals with certain disabilities.

Improper repairs or modifications to the device may result in electric shock, injury or fire.

Replace the brush heads after a fall or impact (even without visible damage). If parts of the brush head break off, there is a risk of choking.

Never touch the mains plug with wet hands and never pull it out by the cable.

Only use supplied charging device and original brush heads.

Do not use outdoors or where oxygen is being administered.

Use the device only at room temperature (0-40°C)

Never use while sleeping or drowsy.

This toothbrush is also suitable for braces and dentures.

Wearers of a pacemaker or other electrical implant should consult a doctor prior to use.

## SAVE THESE INSTRUCTIONS

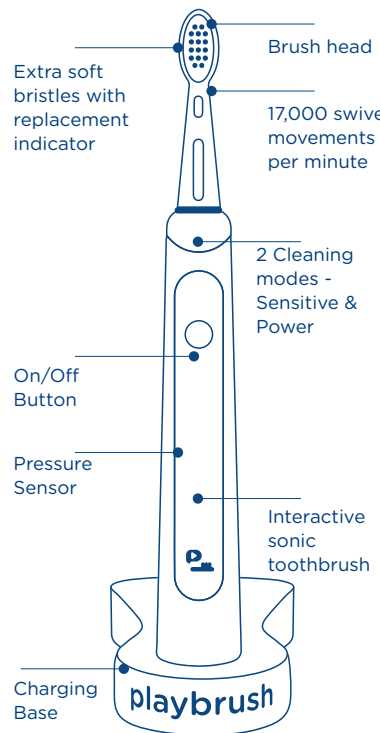

### HYGIENE

Replace brush heads every 3 months. Thoroughly rinse the brush attachment and toothbrush under running water after each use.

### GUARANTEE

For this device, the manufacturer provides you with a two-year warranty from the date of purchase (purchase receipt). The guarantee covers the repair or replacement of a device with material or manufacturing defects. To obtain the warranty, use only original Playbrush brushes. Wear and tear in the context of normal use are not covered by the guarantee. The guarantee expires in the case of third-party entries or changes to the original condition, as well as in commercial use. The guarantee service requires that the defective device is sent with the purchase receipt. Excluded from the guarantee:

- Damage due to non-observance of the operating instructions
  - Damage due to improper use
- We accept no liability for damage to the smartphone or tablet that has arisen in connection with the use of Playbrush. The manufacturer disclaims any liability for damage caused by non-observance of these

operating instructions, by improper repairs or incorrect operation. Subject to change.

### BATTERY PACK

To extend the life of the battery, use the toothbrush at least every six months until fully discharged and fully charged again. The toothbrush should never be left uncharged and charged at least every 6 months. Place the toothbrush in the charger after each use to ensure optimal performance at all times. For the most energy-efficient use, it is recommended that the plug of the charger be removed from the socket after full charge. This product contains a non-replaceable, rechargeable nickel metal hydride battery. DO NOT attempt to open or disassemble the device to replace or remove the battery. Please contact the original manufacturer for maintenance or replacement of the battery.

If liquid runs out of the device or the rechargeable batteries, do not touch them. In case of contact with eyes, rinse immediately with clean water and seek medical advice. Do not rub your eyes. If you suspect that the battery is faulty due to unforeseen behaviour of the device - stop charging, please turn off the power and do not

attempt to charge or use the product. Contact us immediately at [support@playbrush.com](mailto:support@playbrush.com)

### DISPOSAL

Electrical appliances must not be disposed of with household waste. Use the return options in the designated sales or collection points. The toothbrush contains a nickel-metal hydride battery. For environmental reasons, it must be removed at the end of its life and disposed of in an environmental manner.



### REMOVE THE BATTERY CELL

Replacement of the battery is not possible. Fully empty the toothbrush before disposal.

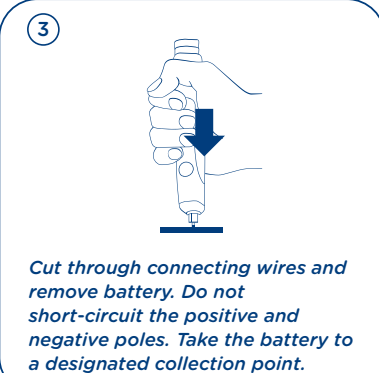
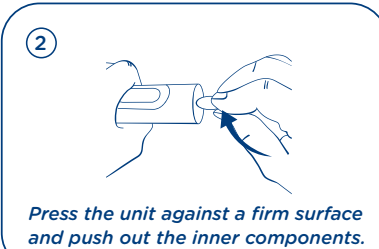
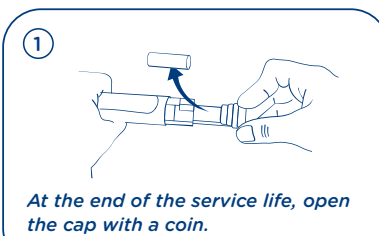

### DECLARATION OF CONFORMITY

Hereby, Playbrush GmbH declares that Playbrush complies with the essential requirements and other relevant provisions of Directives 2014/30/EU, 2014/35/EU, 2014/53/EU, 2009/125/EC and 2011/65/EU. The compliance statement can be viewed at [https://www.playbrush.com/wp-content/uploads/2018/07/DoC\\_en.pdf](https://www.playbrush.com/wp-content/uploads/2018/07/DoC_en.pdf).

### FCC RULES

This device complies with Part 15 of the FCC Rules. Operation is subject to the following two conditions:

- (1) this device may not cause harmful interference, and
- (2) this device must accept any interference received, including interference that may cause undesired operation.

No changes shall be made to the equipment without the manufacturer's permission as this may void the user's authority to operate the equipment.

This device has been designed and complies with the safety requirements for portable RF exposure in accordance with FCC rule part §2.1093 and KDB 447498 D01.

FCC ID: 2AF47A116



## Quickstart Guide

### 1 Activate

Charge the Playbrush Smart Sonic using the supplied charging station. Once you take it off charge you should see a blue blinking light. If not, continue charging.

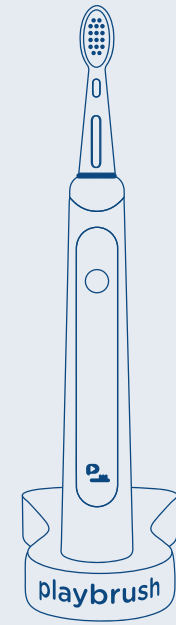

### 2 Turn on Bluetooth

Make sure that Bluetooth on your smartphone/tablet is turned on. Don't pair Playbrush and your smartphone/tablet in Bluetooth settings. This takes place within the app.



### 3 Playbrush App



Download the Playbrush app onto your smartphone or tablet.

**Android Users:** As Bluetooth falls under the location settings, please allow the app to access your location. Playbrush will never actually access the location.

**A one-off registration** is required when first loading the app. If you purchased your Playbrush from the Playbrush website, please enter the email address you used for your order. Otherwise, please use any email address.

### 4 Connect

Pick up your Playbrush and launch the app. If the Playbrush isn't showing a blinking blue light, press the start button.

If your Playbrush shows a blinking blue light, it will automatically begin to connect within the app. Your Playbrush is successfully connected when it shows a full blue light.



### Playbrush Light Signals

#### Blinking Red

Playbrush needs to be charged.



#### Blinking Green

Playbrush is charging.



#### Full Green Light

Playbrush is fully charged.



### Vibration Feedback

When connected to the app, Playbrush will vibrate to indicate if pressure or speed of brushing is too high. When offline brushing (not using the app), Playbrush will vibrate every 30 seconds.

### ✈ Flight mode

Use flight mode to save battery. Connect Playbrush to the app and press the aeroplane button in settings to turn on flight mode. Simply press the start button and connect in the app to disable flight mode.

For any queries please contact us: [support@playbrush.com](mailto:support@playbrush.com)

## FAQ

### My Playbrush Smart Sonic does not work:

- Your Playbrush may need to be charged. Place the toothbrush on charge overnight.
- Try using the socket with another electrical appliance.

### Brushing performance is low or insufficient:

- The toothbrush head may need to be cleaned or replaced.
- Your Playbrush may need to be charged.

### Playbrush Smart Sonic turned off during brushing:

- Playbrush will automatically turn off when the battery level is low. Place the Playbrush on charge for at least 1 hour or overnight if possible.

### Playbrush Smart Sonic sometimes vibrates in unusual motions during brushing:

- Your Playbrush's vibrations will quickly pause every thirty seconds and at 2 minutes to help track brushing time. Your Playbrush's vibrations will also pause to indicate if pressure or speed of brushing is too high.

### You do not have access to all games or other features:

- Some games and brushing statistics are only available to subscription customers.
- To discover all subscription upgrades, please visit our webshop.

**General information**

Modelnr.: A116  
Manufacturer:  
Trisa AG  
Distributor:  
Playbrush GmbH,  
AT: support@playbrush.com,  
www.playbrush.com

www.playbrush.com

**Instructions For Use**

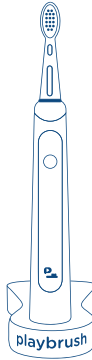

**playbrush**  
SMART SONIC