

Intelligent Wireless Lighting Control Unit

LFX Connect Sense (LFX-CS1)

Overview



LFX Connect Sense is a control component within the LFX Intelligent Lighting System. LFX Connect Sense connects and controls a wide range of lighting fixtures or ballasts and communicates to the rest of the system using IEEE802.15.4 wireless protocol. It provides 0-10V and PWM dimming and a 15A relay ON/OFF control.

LFX Connect Sense has a built-in occupancy sensor, and photo sensor. With its integrated features and intelligent design that allows it to easily snap onto a standard junction box, it is a cost-effective and easy-to-install energy saving solution.

FEATURES

Innovative Integrated Sensors

- Built-in motion occupancy sensor using advanced microwave technology allows the control unit to be hidden above fall ceiling
- Greater flexibility in installations with the included plug-in photo sensor or external photo sensor extension unit (optional)

Ease of Installation

- Compact design
- Designed to fit and connect on a standard junction box
- Integrated sensors for single point installation

Versatile Control Capability

- PWM and 0-10V Dimming control with 30mA output allows control of many fixtures with one control unit
- 15A relay to switch ON/OFF ballasts or drivers

Reliable and Secured Wireless Standard

- Based on IEEE802.15.4(PHY) wireless protocol
- Traffic is secured with AES 128-bit encryption

Intelligent Wireless Lighting Control Unit

LFX Connect Sense (LFX-CS1)

SPECIFICATIONS

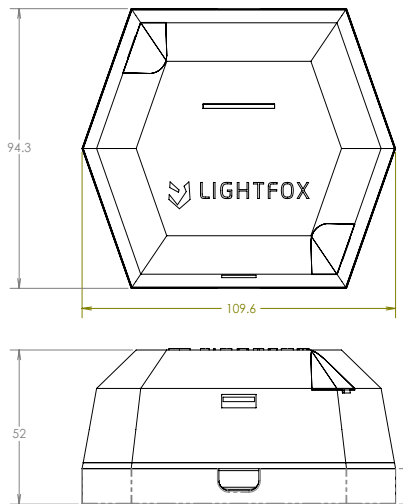

Operating:
Environment:

-20°C to +65°C
Indoor use only (or inside non-metallic waterproof enclosure)

Operating Voltage:
Dimming Control:

AC90-277V ; 50-60 Hz
PWM, 0-100%
0-10V, 30mA shared with PWM
Relay ON/OFF, 15A

Wireless Standard:
Receiver Sensitivity:
Controllable Range:
Motion Sensor:
Motion Sensor Range:
Power Consumption:

IEEE802.15.4(PHY)
- 80dBm
20m (indoor)
Microwave 5.8GHz
3 to 6m
1W (@277V; Relay ON)
0.5W (@277V; Relay OFF)

Compliance:
Mounting:
Dimensions:
Warranty:
Order Info:

FCC Part 15, UL, CE, RoHS
Mount on standard octagonal J box
94.3 x 109.6 x 52mm (L x W x H)
3 years
LFX-CS1 LFX Connect Sense
LFX-ES1 External Photo Sensor 1M
LFX-ES3 External Photo Sensor 3M

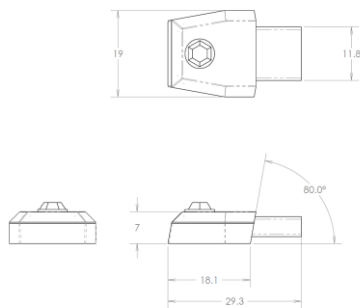

Plug-in Photo Sensor

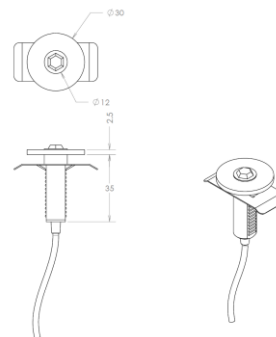

External Photo Sensor Extension (OPTIONAL)

TERMINALS

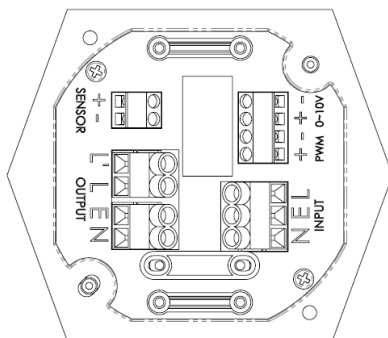

**Pictures and Specifications are for reference only and subject to change without notice*

Intelligent Wireless Lighting Control Unit

LFX Connect Sense (LFX-CS1)

Warning

This device complies with Part 15 of the FCC Rules. Operation is subject to the following two conditions:

(1) this device may not cause harmful interference, and (2) this device must accept any interference received, including interference that may cause undesired operation.

changes or modifications not expressly approved by the party responsible for compliance could void the user's authority to operate the equipment.

NOTE: This equipment has been tested and found to comply with the limits for a Class B digital device, pursuant to Part 15 of the FCC Rules. These limits are designed to provide reasonable protection against harmful interference in a residential installation. This equipment generates, uses and can radiate radio frequency energy and, if not installed and used in accordance with the instructions, may cause harmful interference to radio communications. However, there is no guarantee that interference will not occur in a particular installation. If this equipment does cause harmful interference to radio or television reception, which can be determined by turning the equipment off and on, the user is encouraged to try to correct the interference by one or more of the following measures:

- Reorient or relocate the receiving antenna.
- Increase the separation between the equipment and receiver.
- Connect the equipment into an outlet on a circuit different from that to which the receiver is connected.
- Consult the dealer or an experienced radio/TV technician for help.

RF Exposure Statement

To maintain compliance with FCC's RF Exposure guidelines, This equipment should be installed and operated with minimum distance between 20cm the radiator your body: Use only the supplied antenna.

*Pictures and Specifications are for reference only and subject to change without notice