

TF1

E-POS MINI

Quick Reference Guide



Packing Checklist

Confirm that all the following items are contained in the carton. If any item is missing or damaged, Contact E-Taxfree Nordic Oy for replacement.

<input checked="" type="checkbox"/>	Quick Reference Guide	X1
<input checked="" type="checkbox"/>	AC Adapter	X1
<input checked="" type="checkbox"/>	E-POS MINI	X1
<input checked="" type="checkbox"/>	Power Cord Mounting	X1
<input checked="" type="checkbox"/>	Security Lock	X1

Safety Notices

Observe the following safety measures at all times to prevent bodily injury or damage of your product.

- Throughout the manual carefully prior to initiations.
- To avoid the risk of electric shock: Do not attempt to disassemble this product. Contact E-Taxfree Nordic Oy for replacement.
- The product does not contain consumer replaceable components. Contact E-Taxfree Nordic Oy for replacement.
- Before power connection, be sure to use the correct AC voltage that is between AC100V~ AC240V.
- Make sure that the product is powered off prior to any device installation.

I/O Interface

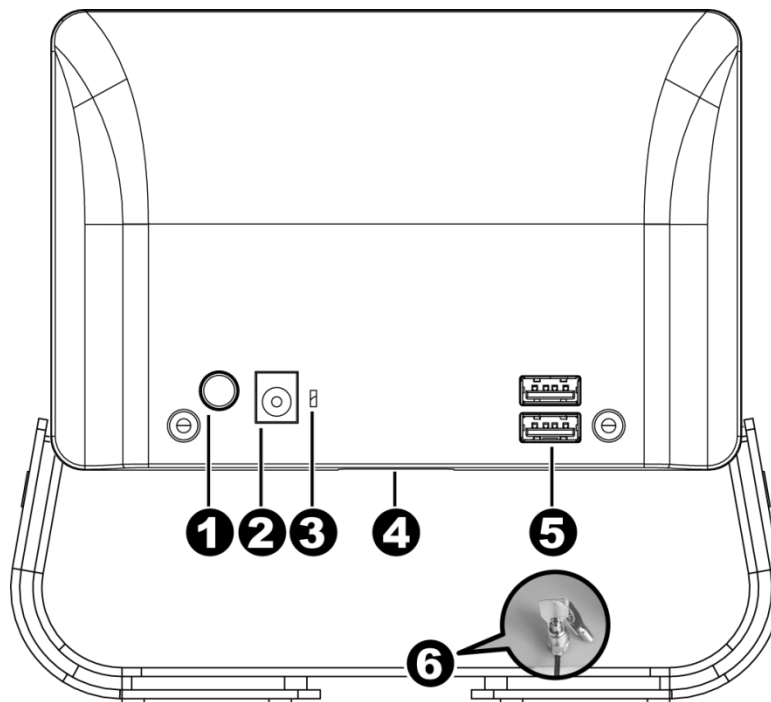

No.	Port	Description	No.	Port	Description
①	Power Button	Power on/off Switch	②	POWER (DC Input)	DC 5V / 3A
③	Power Cord Mounting	Power cable locked	④	scanner	2D scanner (Motorola engine)
⑤	USB	2 x USB 2.0 Type A	⑥	Lock	Security Lock

- ⑥ That way you can lock the security cable to the E-POS MINI case, and loop the cable other end around a fixed object. Once the case and cable are locked together, thieves can't detach the case without damaging the E-POS MINI.

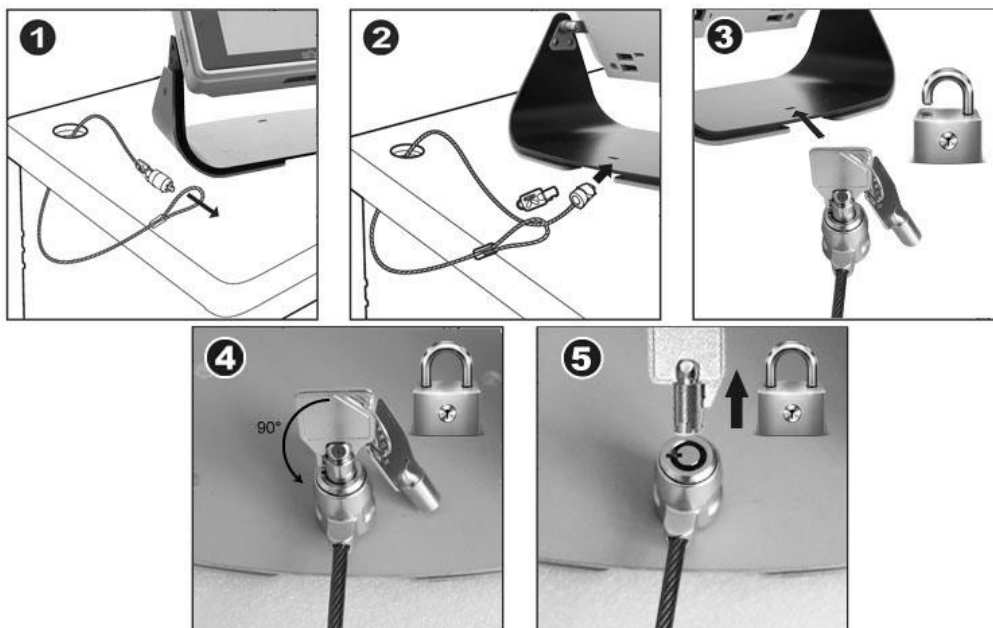

Appearance

Front View

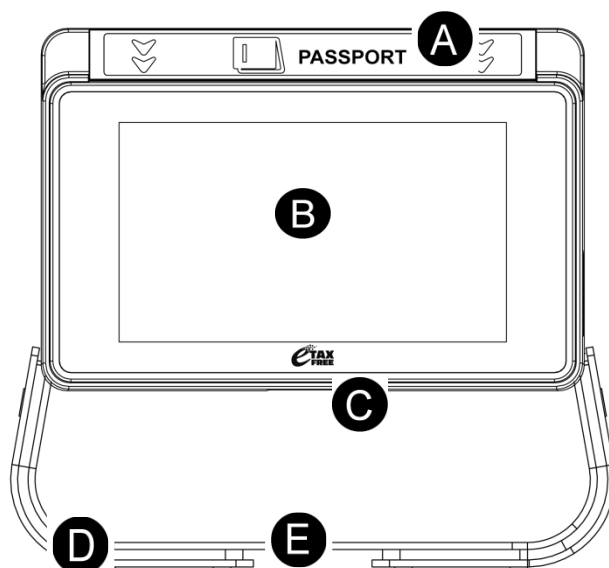

Side View

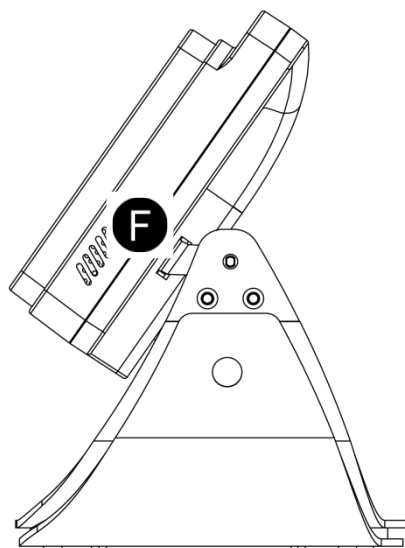

A	MRZ scanner	B	5" TFT LCD Display screen
C	2D scanner (Motorola engine)	D	Base
E	Security Lock	F	Speaker

Side View

Tilt angle 55 ~ 10 degree(45° Default)

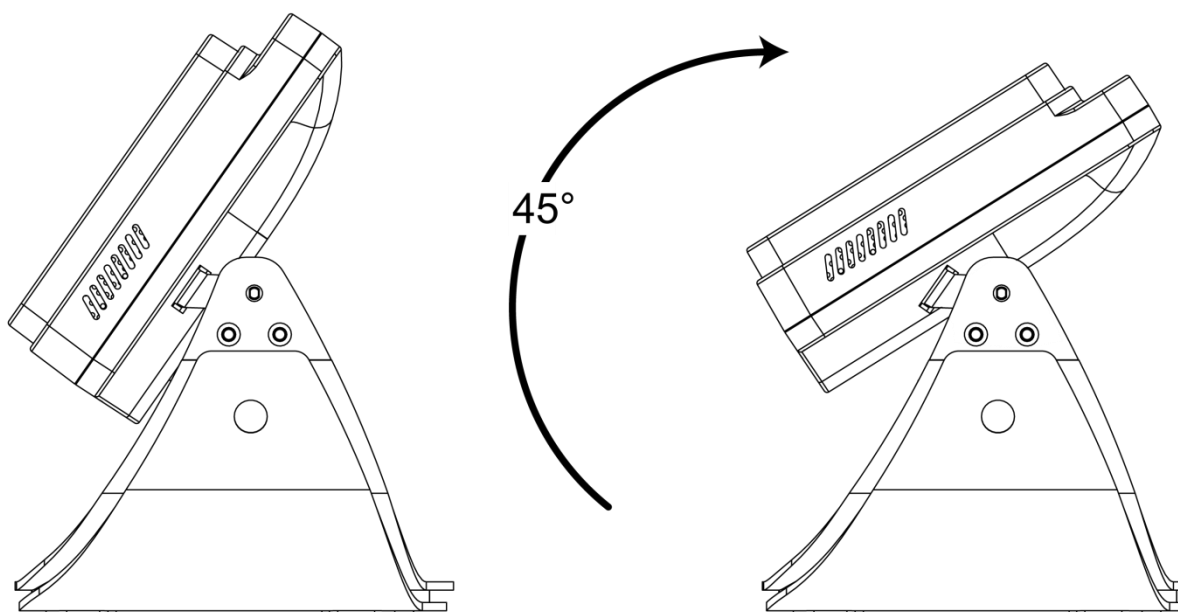

USING YOUR E-POS MINI

For first-time use, you need to Plug your E-POS MINI Connect the power connector and plug the AC adapter side into any AC outlet.

Step 1 Choose the sleeve size of the power cord retainer based on the thickness of the cord. The smaller sleeve can be snapped off and used for thin cords.

Step 2 Slide the retainer around the AC power cord, and pass it around the loop on the switch.

Step 3 Slide the retainer through the first latch.

Step 4 Slide the retainer through the other latches to lock it.

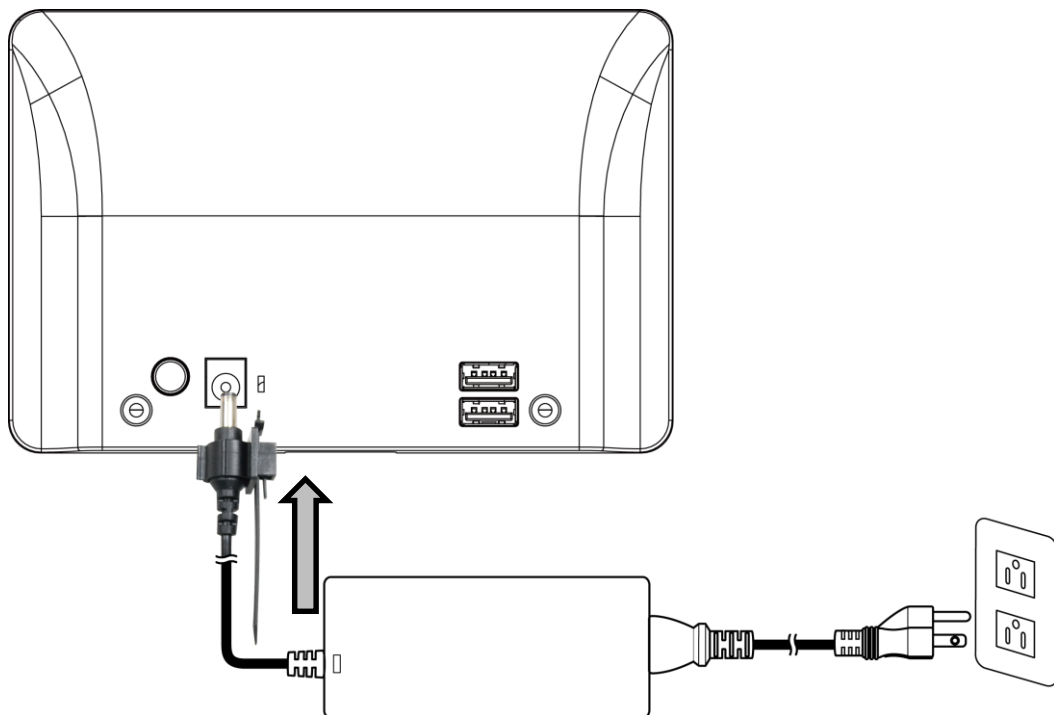

Power on for the first time

To turn on your E-POS MINI, press and hold the power button until you see the Android logo. Wait a moment for your E-POS MINI to boot up. You will then be asked some questions before you can use your E-POS MINI.

If the E-POS MINI screen turns off, it has entered sleep mode. Briefly press the power button to wake it up.

USING THE TOUCHSCREEN

Your E-POS MINI uses a touch screen for selecting items and entering information. Use your finger to tap the screen.

Tap: Touch the screen once to open items and select options.

Drag: Hold your finger on the screen and drag across the screen to select text and images.

Tap and hold: Tap and hold an item to see a list of actions available for that item. On the pop-up menu that appears, tap the action you want to perform.

Scroll: To scroll up or down the screen, simply drag your finger up or down the screen in the direction that you want to scroll.

The Home screen

When you start your E-POS MINI, or wake it from power saving, it will display the Home screen. This screen gives you quick access to information and simple controls with widgets or shortcuts to apps. Widgets display information such as the time and weather, or provide additional controls and direct access to applications. Some have been preinstalled on your E-POS MINI.

The Home screen features some useful controls and information.

Laser Safety

The data collector emits laser beams.

IEC 825-1/EN 60825-1: Laser class 2

FDA CDRH Laser class II. Complies with 21 CFR 1040.10 and 1040.11 except for deviations pursuant to laser notice No. 50 dated June 24, 2007.

Class II laser devices are not considered to be hazardous when used for their intended purpose. Avoid staring into the laser beam.

MRZ passport scanner



Scanner

Skew, Pitch, and Roll

Measured on a 20 mil Code93 and QR code symbol at a distance of 5 inches. Tolerance for skew and pitch is reduced at extreme ends of the working range.

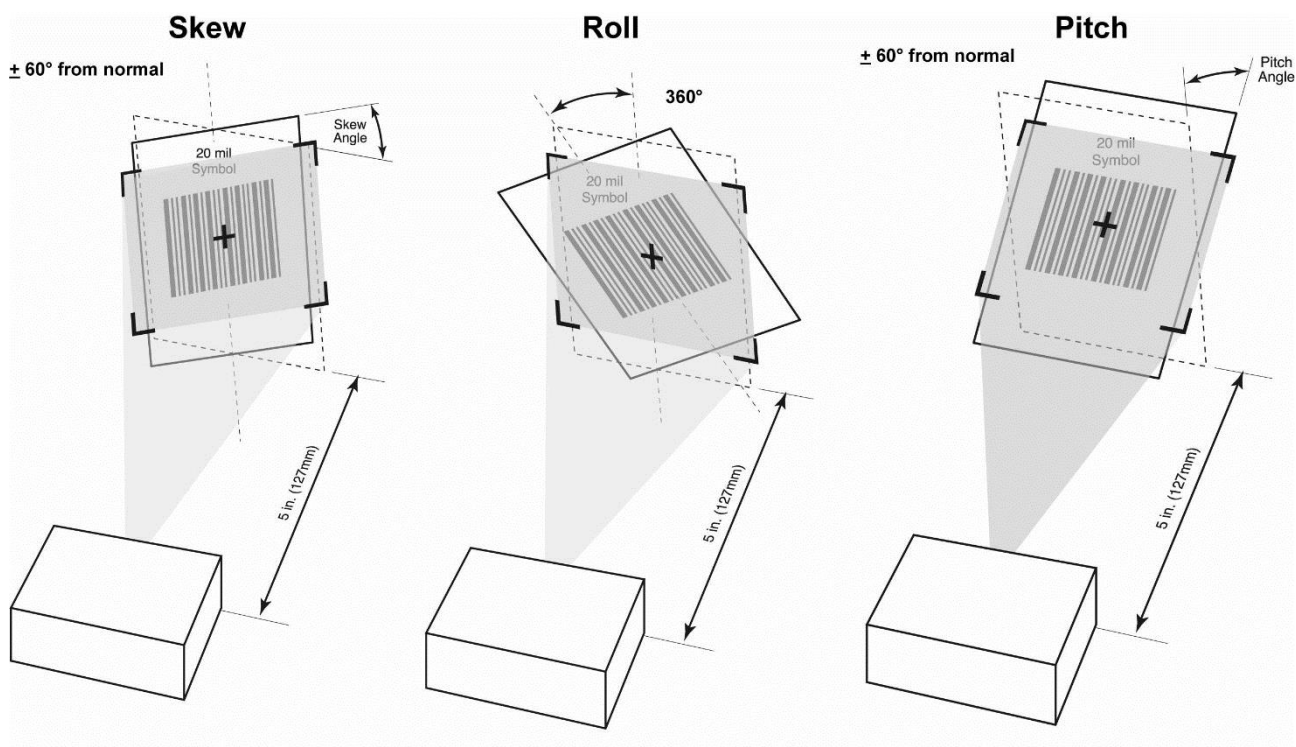

lists the typical and guaranteed distances for selected barcode densities. The minimum element width (or "symbol density") is the width in mils of the narrowest element (bar or space) in the symbol.

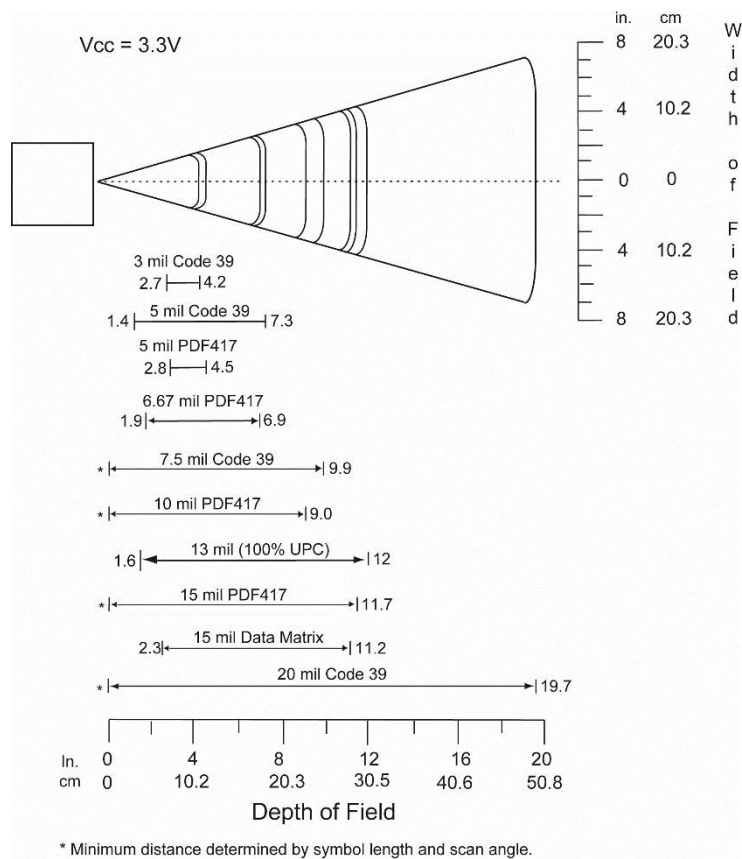

Note: Typical performance at 73°F (23°C) on high quality symbols in normal room light.

Specification

Model Name		TF1
System		
Processor	MTK MT6582V	
ROM	8GB	
RAM	1GB	
Display Size	5" TFT LCD	
Resolution	960 x 540 pixels	
Touch Panel	Capacitive	
OS Support	Android 4.4	
Interface		
USB	2(5V/0.2A)	
Wired LAN	802.11b / g / n	
3G	Micro Sim Card - Yes	
Speaker	Yes	
2D Scanner	Motorola SE-4500DL 2D Scanner	
Passport Scanner	Elyctis MRZ Scanner ID3	
Adjustable Angle	From 55°-10°(total 45°)	
Audio Supported	WMA, MP3, MIDI, AMR, AAC	
Video Supported	3GP, MP4, AVI	
Power Supply	DC 5V / 3A	
Laser Emission wavelength	640-660nm	
Laser Output power	0.71mW Peak	
Environment		
Operating Temperature	5°C ~ 40°C	
Storage Temperature	-20°C ~ 60°C	
Operating Humidity	15% ~ 80% RH	
Storage Humidity	20% ~ 90% RH	
Mechanical		
Housing Color	White	
Dimension(W x D x H)	173 x 145.8 x 108 mm	
Weight	1 kg	

Product specification is subject to change without prior notice.

Federal Communications Commission (FCC) Statement

The users manual or instruction manual for an intentional or unintentional radiator shall caution the user that changes or modifications not expressly approved by the part responsible for compliance could void the user's authority to operate the equipment.

Federal Communications Commission (FCC) Statement

This equipment has been tested and found to comply with the limits for a Class B digital device, pursuant to part 15 of the FCC rules. These limits are designed to provide reasonable protection against harmful interference in a residential installation. This equipment generates, uses and can radiate radio frequency energy and, if not installed and used in accordance with the instructions, may cause harmful interference to radio communications. However, there is no guarantee that interference will not occur in a particular installation. If this equipment does cause harmful interference to radio or television reception, which can be determined by turning the equipment off and on, the user is encouraged to try to correct the interference by one or more of the following measures:

This device complies with Part 15 of the FCC Rules. Operation is subject to the following two conditions:

- 1) This device may not cause harmful interference.
- 2) This device must accept any interference received, including interference that may cause undesired operation of the device.

FCC RF Radiation Exposure Statement:

1. This Transmitter must not be co-located or operating in conjunction with any other antenna or transmitter.
2. This equipment complies with FCC RF radiation exposure limits set forth for an uncontrolled environment. This equipment should be installed and operated with a minimum distance of 20 centimeters between the radiator and your body.

Bluetooth

This equipment manipulates the Bluetooth V4.0 and low energy (BLE) system that operates at 2402 MHz ~ 2480 MHz with 79 channels available, The modulation type have GFSK, 8-DPSK and DQPSK. It also features a WLAN coexistence interface controller, and integrated Class 1.5 Power Amplifiers (PAs) to address the needs of mobile devices that require minimal power consumption and compact size.

Wi-Fi

The Wi-Fi complies with IEEE 802.11 b/g/n standard and it could achieve up to a speed of 72.2Mbps with single stream in 802.11n draft, 54Mbps as specified in 802.11g, or 11Mbps for 802.11b to connect to the wireless LAN. Frequency range 2.400 GHz ~ 2.497 GHz (2.4 GHz ISM Band), the 802.11b modulation have DQPSK, DBPSK and CCK, that 802.11 g/n modulation have OFDM /64-QAM,16-QAM, QPSK and BPSK. Number of channels support ch1~ch11.

LASER RADIATION

CLASS 2 LASER PRODUCT

Wave length 655nm

Complies with 21 CFR Part 1040 except as permitted in LN 50,06/24/2007

DO NOT STAY INTO BEAM

EC60825 1:2007

Maximum output 1 0mW



This device complies with part 15 of the FCC Rules Operation is subject to the following two conditions: (1) This device may not cause harmful interference, and (2) this device must accept any interference received, including interference that may cause undesired operation



E-TAXFREE NORDIC OY

Tammasaarenlaituri 3 | 00180 Helsinki | Finland

Phone: +358 10 5044 040 www.e-taxfree.com