

# NUVU Airwaves Music Player Instruction

Model:NV25

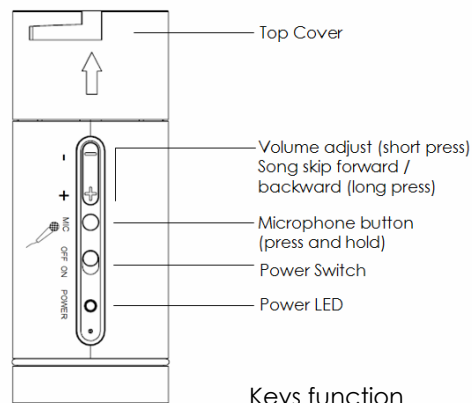

Put the top cover into balloon adaptor

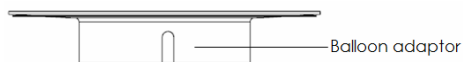
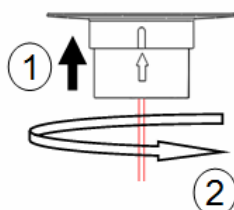

Rotate the top cover  
clockwise to lock the balloon  
adaptor

3



Microphone  
button

4

Hold the cable and release  
the balloon rise **slowly**

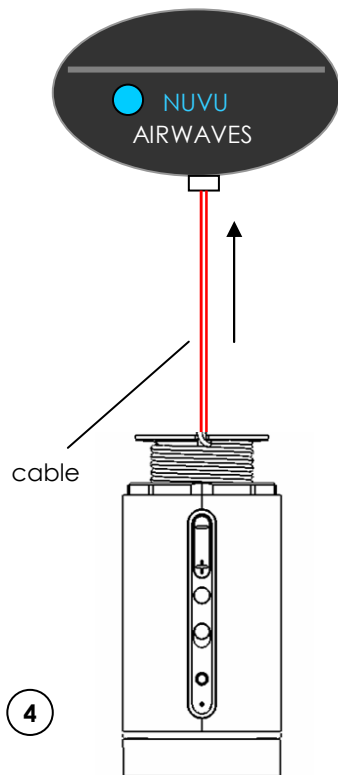

Microphone  
location



1

## 5 Power on and connect the unit

(1 ) Turn on the unit by sliding the  
power switch to power on position

(2) The unit will activate Bluetooth search  
automatically

(3) Select the device name " OP-BM\_001"  
in your mobile phone.

(4) The power LED will flash from fast to  
slow while Bluetooth connected

(5) Adjust the sound volume use volume  
control button.

(6) When the battery needs to be charge,  
use standard micro USB cable connect  
the USB socket on unit.



### Power LED Status

- Blue = Power On
- Red = Power Charging
- Blue + Fast Flashing (1 sec )  
↔ = Bluetooth signal searching
- Blue + Slow Flashing (2 sec )  
↔ = Bluetooth connected

Device Bluetooth ID: OP-BM-001

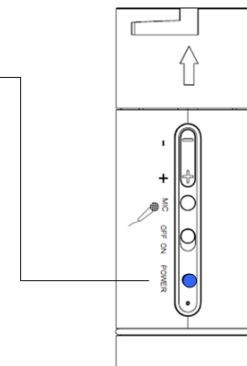

Release helium from Balloon  
Use the provided tube, put it into balloon Helium inlet  
Press down the balloon body unit flat on surface

### Note:

If the sound output is slow, please check below setting

- (1) The sound level in mobile phone and player volume setting
- (2) Check the balloon fill up Helium is firm enough

### Specification

Battery capacity: 800mAh  
Battery voltage: 3.7V  
Play time: 6 hours  
Bluetooth range: 10M  
Battery charging: Micro USB

This device complies with part 15 of the FCC rules. Operation is subject to the following two conditions:

- (1) this device may not cause harmful interference, and
- (2) this device must accept any interference received, including interference that may cause undesired operation.

Changes or modifications to this unit not expressly approved by the party responsible for compliance could void the user's authority to operate the equipment.

This device complies with Industry Canada licence-exempt RSS standard(s). Operation is subject to the following two conditions:

- (1) this device may not cause interference, and
- (2) this device must accept any interference, including interference that may cause undesired operation of the device.

Le présent appareil est conforme aux CNR d'Industrie Canada applicables aux appareils radio exempts de licence. L'exploitation est autorisée aux deux conditions suivantes :

- (1) l'appareil ne doit pas produire de brouillage, et
- (2) l'utilisateur de l'appareil doit accepter tout brouillage radioélectrique subi, même si le brouillage est susceptible d'en compromettre le fonctionnement.