

Universal Wireless Remote Controller

Operation Manual

Many thanks for purchasing our product! This is a portable wireless control, used for mobile phone,MID/TV box, smart TV/PC and so on.It can be used as gamepad, wireless mouse, music control, e-book page, PPT presentation etc.and support iOS, Android, Windowsoperate system and so on.

Important Note: Products are subject to change without any notice. And this product has applied for patents, counterfeiting is not permitted.

Oproduct sketch map :

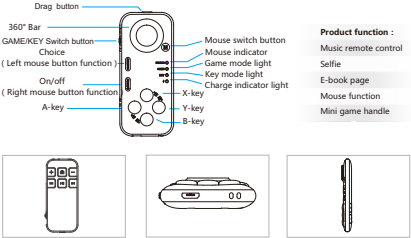

Operating instructions :

1.Power on/off and pair connection(power mode introduction)

① **Power On:** Press **START** button until **LED is on (about 2 seconds)**.Default is automatic mode.

Power on mode changing instruction(please operator on power off mode)
Stand automatic mode: Press A button, then press **START** to power on, Mouse light will be on first, this is standard mode.
Android MTK mode: Press Y button, then press **START** button to power on, charging light will be on first, this is Android MTK mode;



Power on

Press **START** button until **LED is on (about 2 seconds)** . Default is automatic mode.

Apple iCade mode: Press B button, then press **START** button to power on, **GAME** light will be on first, this is Apple iCade mode;
Apple iOS mode: Press X button, then press **START** button to power on, **KEY** light will be on first, this is Apple iOS mode;

Remark:(1)when use the specified mode for first time, then press **START** button to power on next time, remote will default specified mode before. If need shift to other mode, please refer to above power on mode.

(2) Under stand automatic mode,when connected with Android equipment then it is stand Android mode, when connected with Apple equipment, then change to Apple iCade mode. If under other mode, device can't shift mode automatically.

Power off

Long press **START** button, **LED light will flash to off(about 5 seconds)** , device will power off.

Note: If no connecting with Bluetooth device after 5mins, system will power off



② **Power off:** Long press **START** button, **LED light will flash to off (about 5 seconds)** , device will power off. Note: If no connecting with Bluetooth device after 5mins, system will power off automatically; after connecting with Bluetooth device, if no any operation, system will power off after 3mins .



Pair and connect

after power on, **LED** will flash, the device will enter into the **Bluetooth** pair mode automatically to find the address and name of this device(**X-039-XXX**), click then can connect.

③ **Pair and connect :** after power on, **LED** will flash, the device will enter into the **Bluetooth** pair mode automatically to find the address and name of this device(**X-039-XXX**), click then can connect. Pair and connect successfully, **LED** indicator will turn off. Next power on, it can connect and match the last Bluetooth device. Under turn off state, long press **START** button more than 8 seconds, **LED** will flash, then go to pair mode again, and can't connect last paired device automatically.

2.GAME function:(Turn side switch to Game side, now device is operated by two-hands horizontal.)

④ **Standard Android device:** In Menu, if joystick can move cursor, X, Y button is confirmation button, A B button is returning key; this means your mobile system can

support international standard gamepad, just download game and play directly (If can't operate, then refer to part ②, Android MTK mobile operation)
Game Download: use QR code software to scan QR code on the device (or enter into website [http:// www.mocute.com](http://www.mocute.com)) to enter into ZHUZILIN download center, then you can download ZHUZILIN game application or third party's

game application. ZHUZILIN Game center have all gamepad games, and support NES/GB/GBC/SFC/SMD/GBA/N64/MAME/PS games. Users can also download simulator BIN files to Games file folder in mobile, then can use ZHUZILIN software to open the game file, like many famous games: Super Mario, Metal Slug, Sangokushi and so on.

Android games usually have gamepad type, download this kind of games, just connect with Bluetooth then can operate with gamepad directly, this kind of games are like: Eternity Warriors 2, FIFA 15 and so on. (Some games maybe need set to use gamepad control when playing)

Senior game combination key :

L1=SELECT+A R1=SELECT+B
right joystick=left joystick+START L2=SELECT +X R2=SELECT+Y

② **Android MTK mobile operation:**Like Redmi 3G version, Huawei Honor3X, CoolPAD, Zhongxing, these old style mobiles use MTK CPU, due to MTK bad compatibility, they can't support international standard gamepad agreement. So if by standard Android connection method, unusual problems will happen. We preset MTK mode to support ZHUZILIN games.

③ **Mouse operation(just for Android)in GAME mode:** In GAME mode, press M button, then yellow **MOUSE** indicate light will be on, mouse function ok. Now joystick can move cursor, X button is volume+, A button is volume-, B button is left key of mouse, Y button is returning, and pressing M button again can quit mouse function.

④ **Apple iCade mode:** Enter into iOS APP store or other Apple store, search "icade", then you can find games of iCade which support gamepad, download and install then ok, like Akane Lite, Brotherhood, TTR Premium and so on.

Before play games, please set keyboard input mode to English input and can input English letters then ok. Next , please connect with Bluetooth and enter games then can play (Some games maybe need set to use iCade when playing)

Combination key: **L1=SELECT+A R1=SELECT+B**
when connected with control, if soft keyboard can't work, please hit M button or

⑤ **Apple iOS model 2:** This mode is custom non-standard third party Apple game mode(like NEW GAME)

3.KEY mode function:(please turn switch to KEY on device side, now device is operated by single hand and multimedia function buttons work on back)

① **Android devices:** X button is Volume+, A button is Volume-, B button is mute, Y button is returning key;

Music function operation: after connected with bluetooth, open media player(like SAMSUNG's media player), and play music, now our remote can do some operations: like stop, play, pause,changing songs and so on . Long pressing

previous/next can forward/backward.

Self-shutter: Android/iApple mobile use "camera" to take photoes, Android mobile like SAMSUNG can use Volume to adjust focus length, other Android mobile can go into camera setting to set volume for taking photo or scan barcode to download ZHUZHILIN application software, then can use camera directly.

E-Book page up and down:leader use Volume+/- to page, Kindle use joystick to page.

Mouse function:Pressing M button, then yellow **MOUSE** indicated light ill be long on, now mouse can work. joystick can move, **SELECT** is for left key of mouse, **START** is right key of mouse, top button is mouse long-pressing function. when pressing top button, **MOUSE** indicated light will flash, now moving mouse can achieve drag function or pressing top button and using joystick to achieve drag function.

② **Apple device :** X button is Volume+, A button is Volume-, B button is mute, Y button is HOME, Musice and self-shutter is same with Android device. Apple device don't support mouse function.

4.Key-locked function

After device connected, pressing **SELECT** and M button at the same time, can lock all keys beside **START** key(Means other keys can't work). and pressing **SELECT** and M button at the same time again can unlock. when buttons locks, **KEY** and **GAME** indicated light will flash at the same time.

5.Charge

Our product is with inner rechargeable lithium battery, when power is low, charging red **LED** will flash.Please insert 5V USB port to charge, then charging **LED** will be on. And when power is full,charging **LED** will be off.

Notes: 1. When accident cause not boot or unable to shutdown, please use needle to press **Reset** button on side.

2.If already paired ,but can't connect, please cancel the pair and boot the device and connect again.

Item	SPEC
SIZE	92mm*40mm*10mm
weight	27 gram
wireless protocol	wireless 3.0 compliant
wireless distance	2-10 meters
O S	Android /iOS/PC
Battery	Rechargeable lithium battery 100mA
Working time	About 10hours
Recharging current	5V <200mA



FCC Warning Statement

Changes or modifications not expressly approved by the party responsible for compliance could void the user's authority to operate the equipment.

This equipment has been tested and found to comply with the limits for a Class B digital device, pursuant to Part 15 of the FCC Rules. These limits are designed to provide reasonable protection against harmful interference in a residential installation. This equipment generates uses and can radiate radio frequency energy and, if not installed and used in accordance with the instructions, may cause harmful interference to radio communications. However, there is no guarantee that interference will not occur in a particular installation. If this equipment does cause harmful interference to radio or television reception, which can be determined by turning the equipment off and on, the user is encouraged to try to correct the interference by one or more of the following measures:

- Reorient or relocate the receiving antenna.
 - Increase the separation between the equipment and receiver.
 - Connect the equipment into an outlet on a circuit different from that to which the receiver is connected.
 - Consult the dealer or an experienced radio/TV technician for help.
- This device complies with part 15 of the FCC rules. Operation is subject to the following two conditions
- (1) this device may not cause harmful interference, and
 - (2) this device must accept any interference received, including interference that may cause undesired operation.

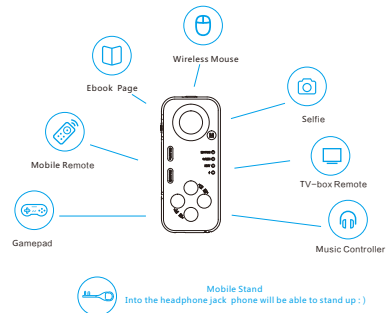

Mobile Stand
Into the headphone jack phone will be able to stand up :)

START.....

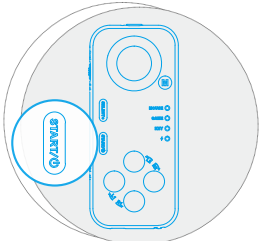

ON/OFF

Press **START** button until **LED** is on (about 2 seconds) . Default is automatic mode.

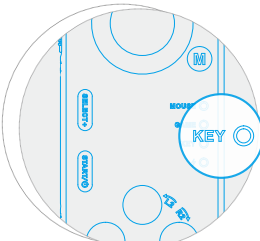

Pair and Connect

After power on, **LED** will flash, the device will enter into the **Bluetooth** pair mode automatically to find the address and name of this device(**X-039-XXX**), click then can connect

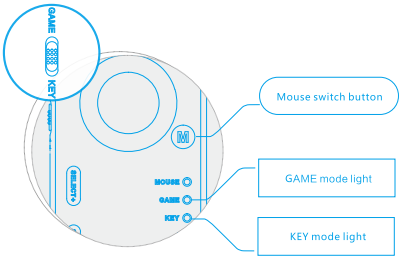

Mode Change

Press **M** button, change mouse mode.
Toggle Switches to change **GAME** or **KEY** mode.

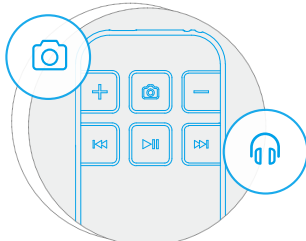

Multimedia function Button

Multimedia keys for operations such as pause and down song.



Download

Support massive resources