

# Mr. Christmas®

## Holiday Motion Projector Item No. 60503, 60505

**THIS PRODUCT IS NOT A TOY! Please read this entire instruction booklet before using.**

### INSTRUCTION MANUAL

#### 1. DESCRIPTION

Thank you for purchasing the **Holiday Motion Projector**. It projects multi-colored changeable animated holiday images on any flat surface. The package includes the unit, ground stake, tripod, 20 slides, an adapter and extra bulb. This product is not a toy and is not intended for use by children.

**Electrical Rating: 120V AC 60Hz 70VA**

**Normal operating temperature is from -20°C / -4°F to 35°C / 95°F**

At extremely cold temperatures (-20°C / -4°F) the spinning image may not start for a few minutes.

#### 2. UNPACKING THE UNIT

Your **Holiday Motion Projector** has been carefully packed to ensure that it will reach you in perfect condition. To unpack follow these steps:

- A. Carefully open the box and pull out the styrofoam insert and remove the unit from the styrofoam insert.
- B. Remove the film pouch and the ground stake from the styrofoam insert.
- C. Remove the plastic bag from the unit. The unit is now free of the packaging. Be sure to save the packaging of your unit from season to season.
- D. A spare bulb packed in a white box is included in the packaging to be used only when the bulb in the unit fails.

#### 3. OPERATION

- A. Insert the AC adapter plug into the power jack and plug the adapter into a nearby working outlet. The adapter is intended to be correctly oriented in a vertical or floor mount position.
- B. Press the "ON" button, the lamp will light on.
- C. Position the projected image by tilting and turning the projector housing.
- D. To focus, turn the focus adjust knob counter clock-wise or clock-wise.
- E. To make the image bigger, move the projector back from the intended surface.
- F. There is a button marked "SPIN IMAGE" and "FREEZE IMAGE":
  - SPIN IMAGE – The image will keep spinning.
  - FREEZE IMAGE – The image will become freeze
- G. AUTO TIMER - There is a switch for selecting 4 HOURS ON / AUTO OFF 20 HOURS and 6 HOURS ON / AUTO OFF 18 HOURS.
- H. Your **Holiday Motion Projector** comes with a remote control to control the unit.

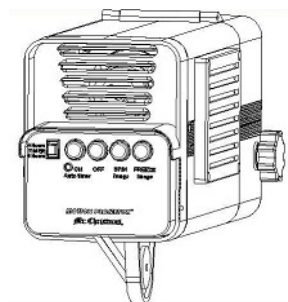

#### 4. MOUNTING THE UNIT

- A. Determine the **Holiday Motion Projector** position for desired location and image size.
- B. Before inserting the ground stake, check the ground for any electrical, gas, plumbing, or phone line hazards. Do not position the lens of the **Holiday Motion Projector** in direct path of the sun as this may cause a magnifying lens effect and burn the image film.
- C. Insert the ground stake into the ground. If the ground is hard, a hammer may be needed. In this case, use something such as a wooden block to prevent damage to the top of the ground stake.
- D. Or use the tripod for placing the unit on any flat surface.
- E. Loosen the ground stake stem mounting screw to its extreme open position. Align the round hole of the stem with the round end of the ground stake.
- F. Insert the stem into the round position of the ground stake. Then tighten the stem mounting screw.

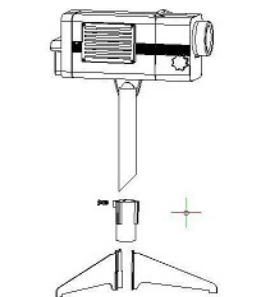
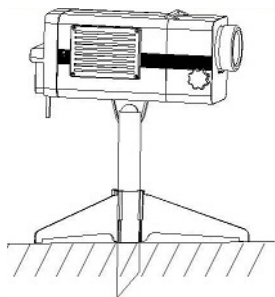

# Mr. Christmas®

## 5. TO CHANGE FILM

- A. Flip up the front housing as shown.
  - B. Slide installation – Align the slide holes to the housing pegs and insert and turn. Reverse this procedure to remove the slide.
- IMPORTANT:** Always place the film with engraved “FRONT” surface facing out to avoid damaging the film.

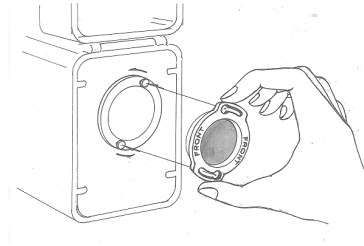
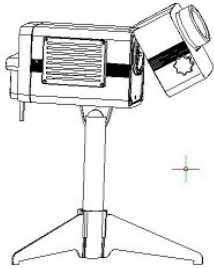

## 6. BULB REPLACEMENT

- A. Unplug the adapter and allow the projector housing to cool before changing bulb.  
CAUTION: To reduce the risk of fire, use a 60W or smaller 12V, type MR-16 bulb.
- B. Unscrew the mounting screw and remove the pressing plate from the lamp. Do not unscrew the mounting screw all the way (only until the pressing plate can be removed from the lamp). After changing the bulb, tighten the mounting screw, making sure the bulb pressing plate is over the lamp.

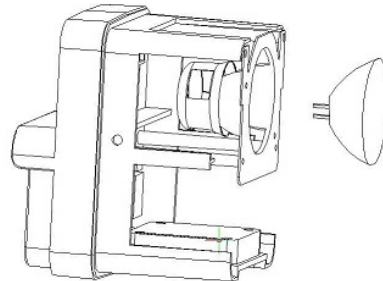
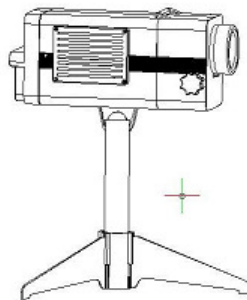

## 7. FUSE REPLACEMENT

Your **Holiday Motion Projector** comes with a spare fuse. To replace burnt-out fuses in the adapter, be sure to replace a burnt-out fuse with a fuse of the same rating: 7A 250V UL listed fuse.

**CAUTION:** BEFORE REPLACING, ALWAYS DISCONNECT THE MAIN POWER CORD FROM THE POWER SOURCE.

To replace the fuse, turn the “FUSE” knob and remove the burnt out fuse and replace it with a new one.

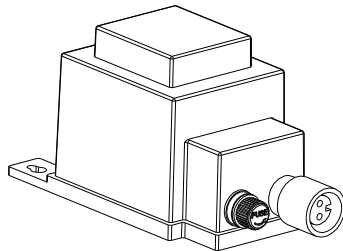

## 8. CARE INSTRUCTIONS

- A. Before using or reusing, inspect product carefully. Discard any products that have cracks in enclosure or exposed wire.
- B. When storing the product, carefully remove from the current location to avoid any undue strain or stress on the conductors, connections and wires.
- C. When not in use, store neatly in a cool, dry location protected from sunlight and heat.
- D. If necessary, clean product by wiping with a soft, dry cloth.

## 9. SAFETY INSTRUCTIONS AND WARNINGS

**WARNING:** When using outdoor portable lamps, basic safety precaution should always be followed to reduce the risk of fire, electric shock, and personal injury.

- a) Use only three-wire outdoor extension cords that have three prong grounding plugs and grounding receptacles that accept the device's plug.
- b) Ground Fault Circuit Interrupter (GFCI) protection should be provided on the circuit(s) or outlet(s) to be used if the projector will be used in a wet location. Receptacles are available with built-in GFCI protection.
- c) Use only with an extension cord for outdoor use, such as type SW, SW-A, SOW, SOW-A, STW, STW-A, STOW, STOW-A, SJW, SJW-A, SJOW, SJOW-A, SJTW, SJTW-A, SJTOW OR SJTOW-A.

**INSTRUCTION PERTAINING TO A RISK OF FIRE, ELECTRIC SHOCK, EXPOSURE TO EXCESSIVE UV RADIATION, OR INJURY PERSONS.**

**LIGHTED LAMP IS HOT!**

**READ AND FOLLOW ALL SAFETY INSTRUCTIONS.**

# Remote Control

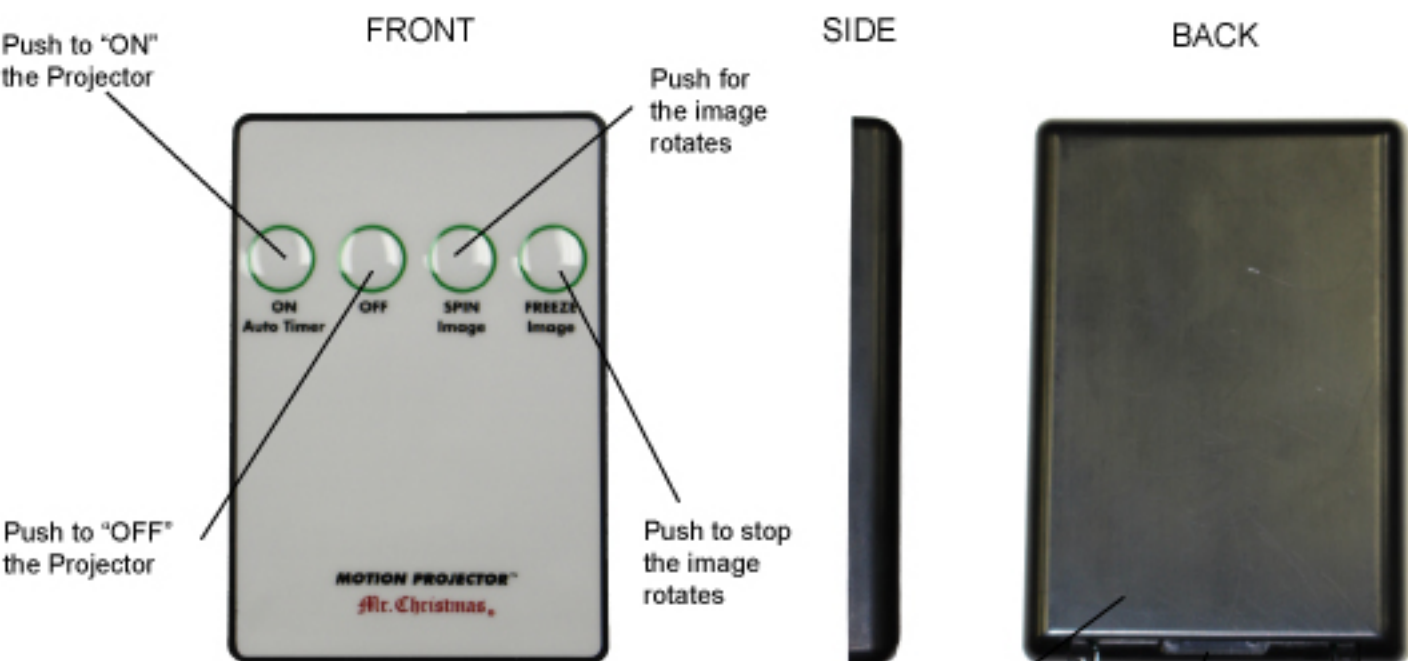

## ENLARGE VIEW FOR THE BATTERY COMPARTMENT

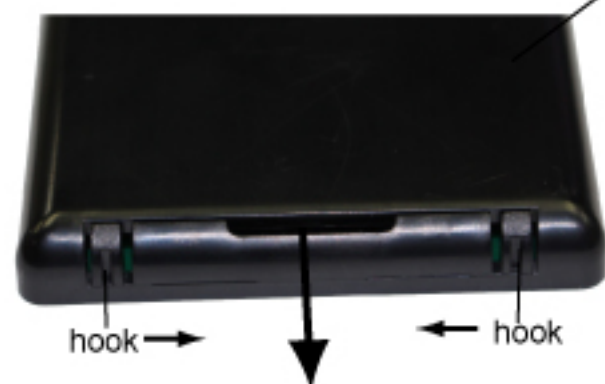

push both hook towards the middle,  
and pull the battery compartment out for  
batteries replacement

## BATTERY COMPARTMENT



USE TWO CR2032  
for the remote

# Mr. Christmas®

**WARNING: THIS IS NOT A TOY! THIS PRODUCT CONTAINS SMALL PARTS WHICH COULD CAUSE CHOKING IF SWALLOWED.**

**DO NOT REMOVE COVER. NO USER SERVICEABLE PARTS INSIDE. IF SERVICING IS NEEDED, SEND TO QUALIFIED SERVICE PERSONNEL. PLEASE ADHERE TO THE FOLLOWING:**

- A. Read Instructions** - All safety and operating instructions should be read before the item is operated. Please adhere to the instructions and warnings for your safety.
- B. Heat** - The item should be situated away from heat sources such as radiators, hairdryers, heat registers, stoves or other appliances that produce heat.
- C.** Do not let lamps rest of the supply cord or on any wire.
- D. Water** - The item should be situated away from bodies of water.
  - 1) Do not install or use within 10 feet of a pool, pond or lake.
  - 2) Do not use in a bathroom.
- E. Power Sources** - The item should be connected to a power supply only like the one that is provided with the item.
  - 1) Do not hang ornaments or other objects from cord.
  - 2) Do not close doors or windows on the product or product cords as this may damage the wire insulation.
  - 3) Do not secure the wiring of the product with staples or nails, or place on sharp hooks or nails.
  - 4) Unplug the product when leaving the house, retiring at night or if left unattended.
  - 5) Use only with extension cord approved for outdoor use.
  - 6) Do not install or use a cord-connected or directly plug-in power unit within 10' of a pool.
  - 7) Do not use a cord-connected or directly plug-in unit in a bathroom.
- F. Damage Requiring Service** - Refer all servicing to a qualified service personnel. Have a qualified service personnel service this item when:
  - 1) The power-supply cord or plug has been damaged.
  - 2) Objects have fallen.
  - 3) All troubleshooting techniques have been tried and the item will not work or has stopped working.
  - 4) The item has been dropped or the enclosure damaged.
- G.** This season use product is not extended for permanent installation or use.
- H.** To avoid risk of fire, burns, personnel injury and electrical shock this item should not be played with or placed where small children can reach it.
- I.** Do not use this product for other than its intended use.
- J.** Do not cover the product with cloth, paper, or any material not part of the product when in use.

*The following is only applicable to customers in the USA:*

*For more information about this product, please call 1-800-467-9627, or visit our website [www.mrchristmas.com](http://www.mrchristmas.com). We will be happy to help you!*

## **FEDERAL COMMUNICATIONS COMMISSION CODE, PART 15**

Note: This equipment has been tested and found to comply with the limits for a Class B digital device, pursuant to Part 15 of the FCC Rules. These limits are designed to provide reasonable protection against harmful interference in a residential installation. This equipment generates, uses and can radiate radio frequency energy and, if not installed and used in accordance with the instructions, may cause harmful interference to radio communications. However, there is no guarantee that interference will not occur in a particular installation. If the equipment does cause harmful interference to radio or television reception, which can be determined by turning the equipment off and on, the user is encouraged to correct the interference by one or more of the following measures:

- (a) Reorient or relocate the receiving antenna
- (b) Increase the separation between the equipment and the receiver
- (c) Connect the equipment to an outlet on a circuit different from that to which the receiver is connected
- (d) Consult the dealer or an experienced radio / TV technician for help

Any changes or modifications not expressly approved by the party responsible for compliance could void the user's authority to operate the equipment.

## **10. NINETY-DAY LIMITED WARRANTY**

Mr. Christmas warrants the original consumer / purchaser of the **Holiday Motion Projector** that it will be free from defects in material and workmanship for a period of ninety (90) days from date-of-purchase. Any liability of Mr. Christmas under this warranty shall be limited to the repair or replacement of defective parts without charge if the item is returned with shipping charges prepaid together with proof of date-of-purchase, name and mailing address of the original consumer/purchaser. This warranty does not cover defects caused by damages in transit, abuse, accident, negligence or repairs made by others. This warranty gives the consumer / purchaser specific legal rights. This consumer / purchaser may also have other rights, which vary from state to state.

---

ACTUAL PRODUCT MAY VARY SLIGHTLY FROM PHOTOGRAPHS / DRAWINGS IN THE INSTRUCTION MANUAL

---

# IC Warning

This device complies with Industry Canada licence-exempt RSS standard(s). Operation is subject to the following two conditions:

- (1) this device may not cause interference, and
- (2) this device must accept any interference, including interference that may cause undesired operation of the device.

*Le présent appareil est conforme aux CNR d'Industrie Canada applicables aux appareils radio exempts de licence. L'exploitation est autorisée aux deux conditions suivantes : (1) l'appareil ne doit pas produire de brouillage, et (2) l'utilisateur de l'appareil doit accepter tout brouillage radioélectrique subi, même si le brouillage est susceptible d'en compromettre le fonctionnement*