



## **User Manual for Super Shape**

Model: JN100

Brand: LESHI

FCC ID: 2AEVYJN100

Made in China

## **FCC Statement:**

NOTE: This equipment has been tested and found to comply with the limits for a Class B digital device, pursuant to part 15 of the FCC Rules. These limits are designed to provide reasonable protection against harmful interference in a residential installation. This equipment generates, uses and can radiate radio frequency energy and, if not installed and used in accordance with the instructions, may cause harmful interference to radio communications. However, there is no guarantee that interference will not occur in a particular installation. If this equipment does cause harmful interference to radio or television reception, which can be determined by turning the equipment off and on, the user is encouraged to try to correct the interference by one or more of the following measures:

- Reorient or relocate the receiving antenna.
- Increase the separation between the equipment and receiver.
- Connect the equipment into an outlet on a circuit different from that to which the receiver is connected.
- Consult the dealer or an experienced radio/TV technician for help.

Changes or modifications not expressly approved by the party responsible for compliance could void the user's authority to operate the equipment.

This device complies with Part 15 of the FCC Rules.

Operation is subject to the following two conditions:

- (1) this device may not cause harmful interference, and
- (2) this device must accept any interference received, including interference that may cause undesired operation.

Please read this manual and the Operation Instruction carefully before using this Smart Box and keep them for reference.

## **NOTICE**

Please keep the User Manual properly. If you will transfer the possession of this product, please make sure its new owner also possesses this manual. Please read this manual before you install and use the product as it provides very important safety information.

### **Notice for Battery:**

Please fully-charge the Smart Box when you use it for the first time.

This product can also be charged even if the battery is not fully-discharged. When product is manufactured, the battery has some power and can also be used.

The battery will be gradually run out if you lay it idle for long time.

### **Notice for Display Screen:**

The display screen of product is not LCD screen. Besides, the saturation level of electric power displayed by battery sign is not the specific percentage of electric power.

The Bluetooth sign indicates that this product is connected with the Smartphone.

Please avoid over-straining the power button in case that it would cause physical damage.

Please don't strike display screen in case that it would have breakage.

### **Pictures in This Manual:**

Pictures used in this manual are all duplicate images, so there might be differences between images and products in details, which shall not be regarded as product flaw.

**Safety Information:**

The Super Shape Smart Box you purchased is in accordance with relevant national standards. Therefore, the manufacturer is not responsible for any breakdowns caused by improper usage.

# CONTENT

<b>1 INTRODUCTION.....</b>	<b>6</b>
1.1 BASIC INFORMATION OF PRODUCT .....	6
1.2NAME AND DEFINITION OF EACH UNIT .....	7
<b>5 FAULT AND EXCLUSION.....</b>	<b>24</b>
5.1BATTERY AND POWER BUTTON.....	24
5.2BLUETOOTH AND DATA CONNECTION .....	24
5.3 DATA MEASUREMENT .....	24
<b>6 OTHERS.....</b>	<b>26</b>

# User Manual

## 1 Introduction

Distinguished User:

Thank you for purchasing Super Shape Smart Box.

In order to meet all your demands, we are devoted to create and design the product with excellent performance and convenience by our enthusiasm and expertise.

You can find all our products and related information, and purchase all kinds of accessories to support the use of Smart Box on the website of our company [www.le10.cn](http://www.le10.cn)

Besides, we will continue working hard to meet your demand, so if you have any questions or suggestions, don't hesitate to contact our after-sale service department.  
(see the contact information)

We also have commitment for you that we will update our technology, function, or aesthetic characters to keep the trend of technological development so as to improve our product.

Note:

Please read Operation Instruction and User Manual and use the product following their steps for your better user experience.

### 1.1 Basic Information of Product

Model: JN100

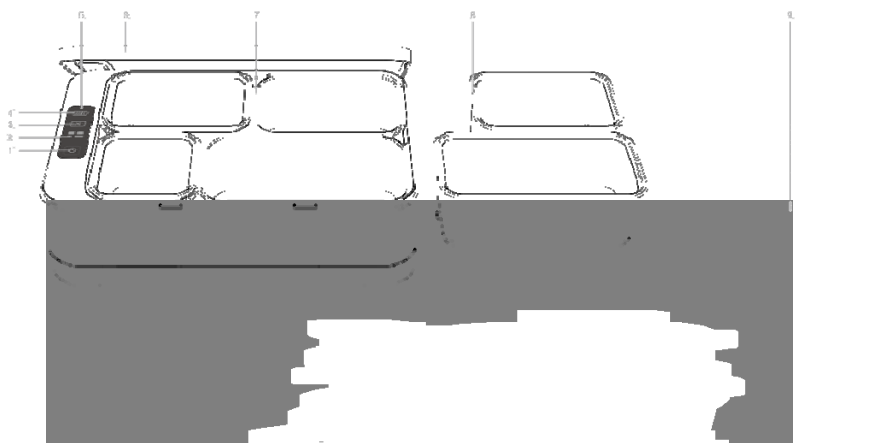

This product is among the Super Shape Smart Box series products independently researched and developed by Xi'an Leshi Smart Tableware Co. Ltd. The Smart Box has smooth line and shape outside with a good sense of science and technology and has split-type design inside, which makes it easier for use. Besides, it is equipped with G-Sensor Pressure Sensor with high precision, which can make sure the accuracy of weighing.

Software is based on Android OS intelligent operating system. The real-time data collected by Smart Box can be processed and calculated by applying original intelligent acquisition and control algorithm. Meanwhile, it can also guide and remind users on effected diet and exercise to help them with good diet and living habit.

Executive Standard: General requirements for safety of GB 4706.1-2005 domestic and electric appliance with similar functions.

## **1.2Name and Definition of each unit**

- Adapter K05100-1



- USB Cable

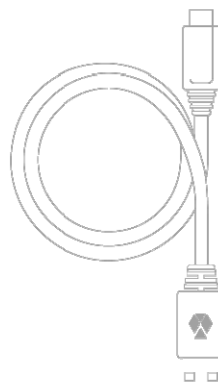

- BOX

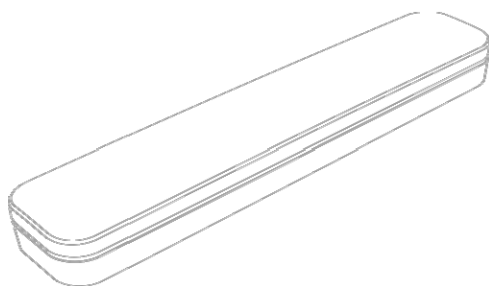

- chopsticks

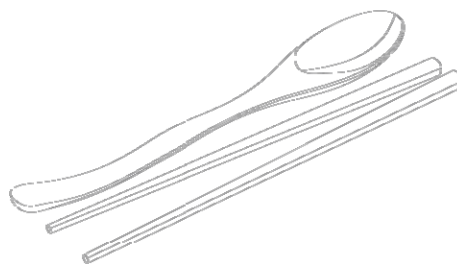

- User manual

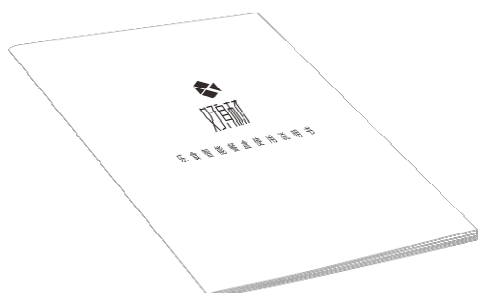



## 2. Functions and features of the product

### 2.1 Functions

Super Shape Smart Box and its affiliated software combine five functions (intelligent recommendation of meals; precise measurement of nutrition intake; analysis and suggestions of needed nutrition; interactive community and exercise reminding) together based on characteristics of different customers and it is the most considerate management assistant of healthy diet with the help of your Smartphone.

#### 2.1.1 Intelligent recommendation of nutritional food

It sets different nutritional meals scientifically and healthily based on different height, age, gender, weight, belief, clinical history, etc.

#### 2.1.2 Precise measurement of nutrition intake

Analyzing precisely the proportion of intake of protein (35%), carbohydrate (58%) and fat (17%) and complementing the lacking nutrition based on the measurement.

#### 2.1.3 Precise control of total nutrition intake

It controls your diet and total nutrition intake through sound, light, electricity and strobe and precise algorithm. It is impossible to eat less or more.

#### 2.1.4 Social platform

Your changing weight will be precisely recorded every day. And you can view the slimming experience of other people from social platform.

#### 2.2 The style of the Smartbox

Adhering to the philosophy of scientific, dedicated, healthy and happy, our product provides consumers with comprehensive nutrition management service through technology, and dedicates to be “expert of nutrition management”.

The intelligent software expands the functions of Smart Box, making it comprehensively monitor and manage the diet, even sleeping, exercise and diagnosis and treatment of customers, and providing them with more healthier, scientific and rational lifestyle.



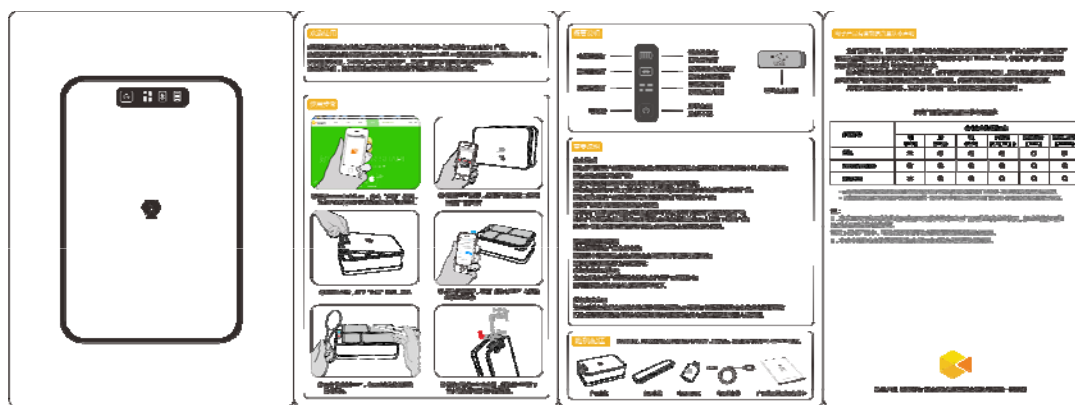

2. Please read the instructions and this manual carefully before using Smart Box, which is quite helpful.

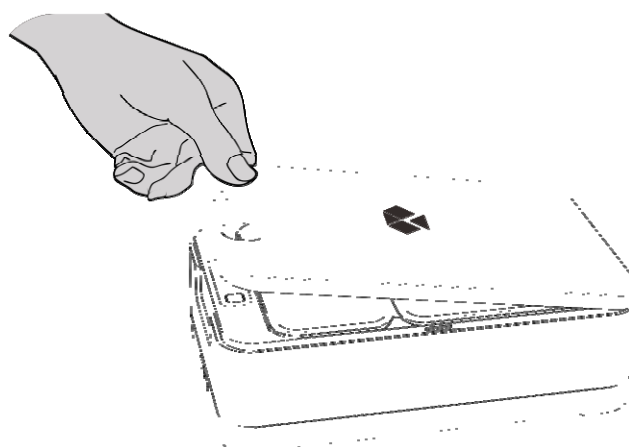

3. Please open the lid from one side. Do not slide or use other ways to pry it up.

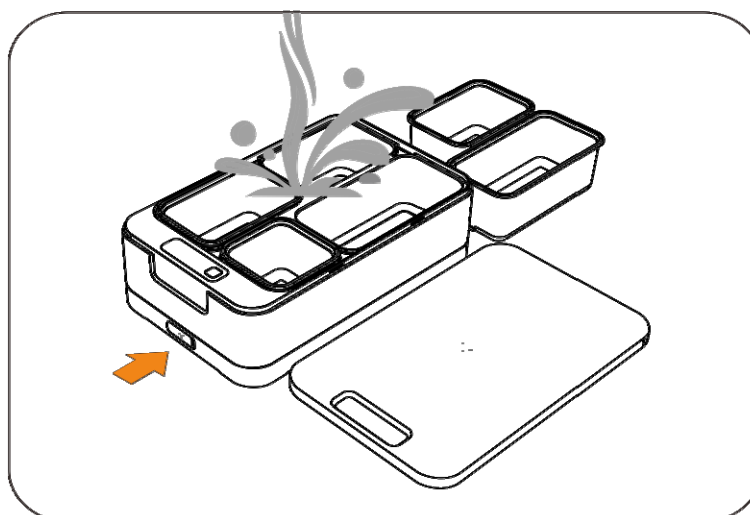

4. Plug the cover of USB, and open the lid of the Smart Box, and then clean the four

inside boxes and the whole Smart Box carefully.

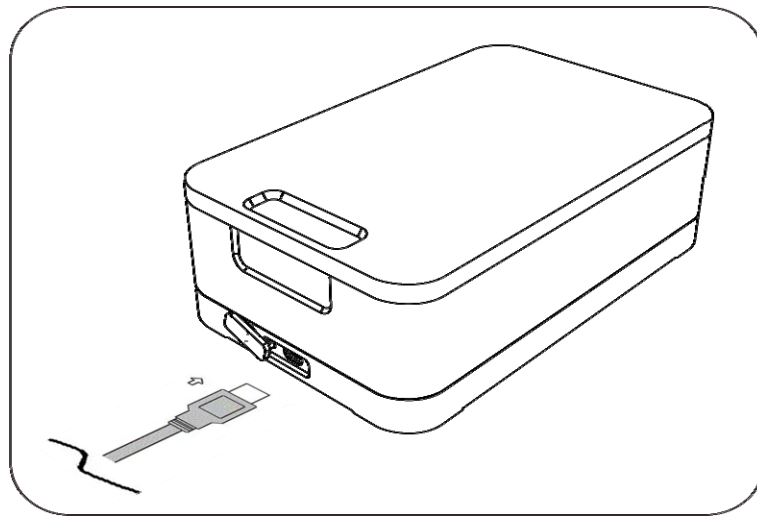

5. After you finish the cleaning, please charge it before your use. When it is charging, the breathing LED is on.



Notice:

- Please protect your battery and maintain its best operating performance.  
Do not charge it over 24 hours continuously.
- Do not connect adapter and data line with other objects, which might cause breakdown or damage.



In order to better provide our service, please log in the following website:  
[www.le10.cn/mindex/application](http://www.le10.cn/mindex/application) to download affiliated apps for your phone.

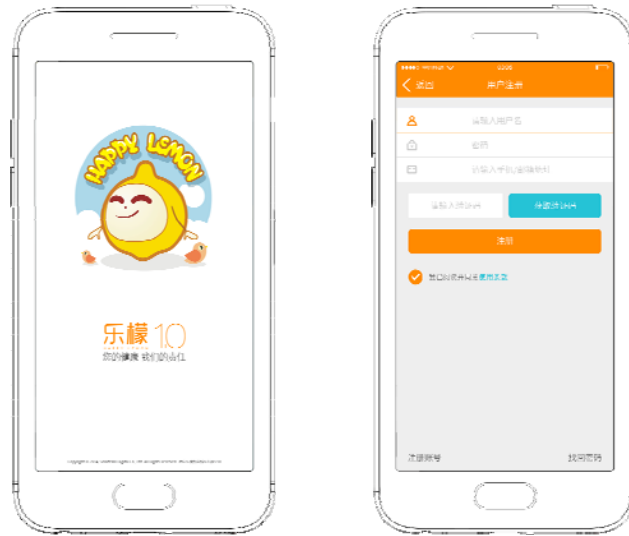

7. Finish the installment of app. Launch the apps (you should make sure the internet connection of your phone) and create a new account (because you are new customer) to experience functions of our product, and then log in the app with your new account.



8. Use the account you created to finish the Login and complete Personal Information.



9. Set your Slimming Goal and Cycle, and complete Slimming Assessment, which can produce scientific diet plan. All these information are basis of using this box.

### 3.2 Usage of Smart Box

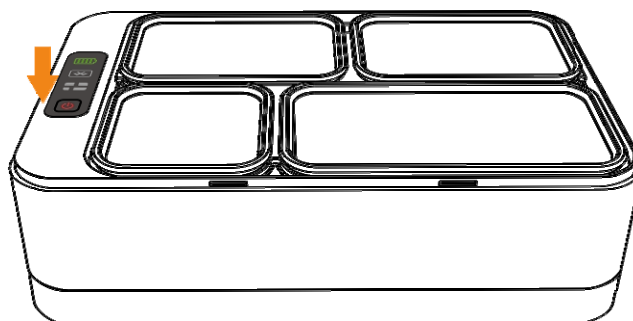

1. Press the power button of the Smart Box, and it will be in the standby mode.



Notice:

- Please open the lid of box before you press the power button.
- When it is in the standby mode, the battery indicator will be on. Green light indicates high-level while red light indicates low-level.

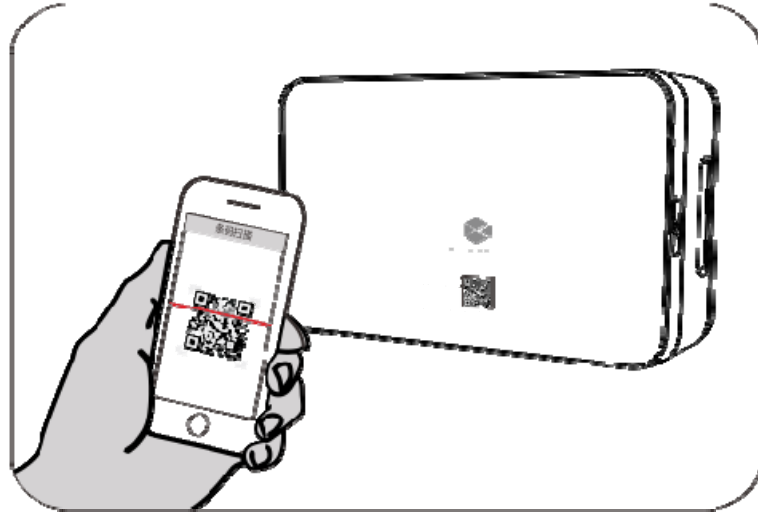

2. Scan QR code from the bottom of the Smart Box with affiliated tool of the app, and wait for the pairing and connection of Bluetooth between your Smartphone and Smart Box, thus to bind app with your Smart Box.

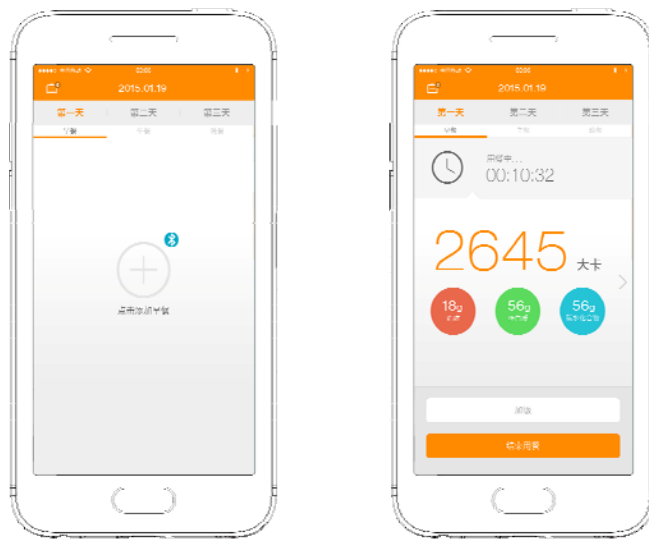

3. After you finish binding, you can Add Breakfast according to the reminder of software, which shows diet time and calorie information.

4. After binding, please fill in your personal information (your privacy will be guaranteed) according to the notification of the app to finish your health plan. Then the app will create the slimming report about your BMI for your reference.



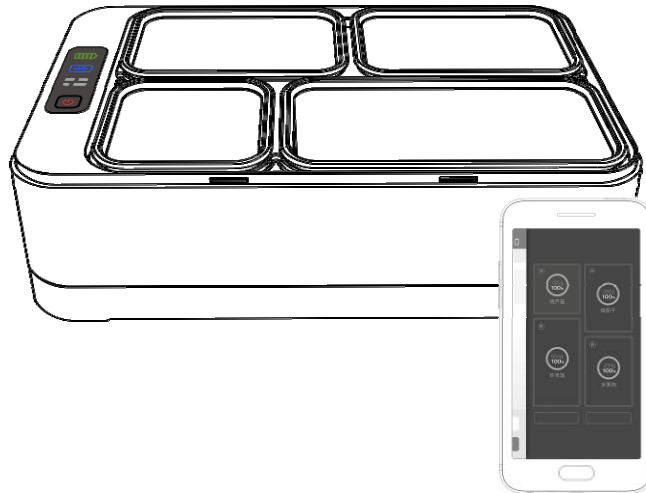

5. Now you can enjoy your meal with Smart Box: please reassure the connection of app and Smart Box. When dishes are selected, enter personal dining, and select Add Food, and then put rice and dishes to the inside boxes of Smart Box. The real-time weight of the meal will be displayed by the app.

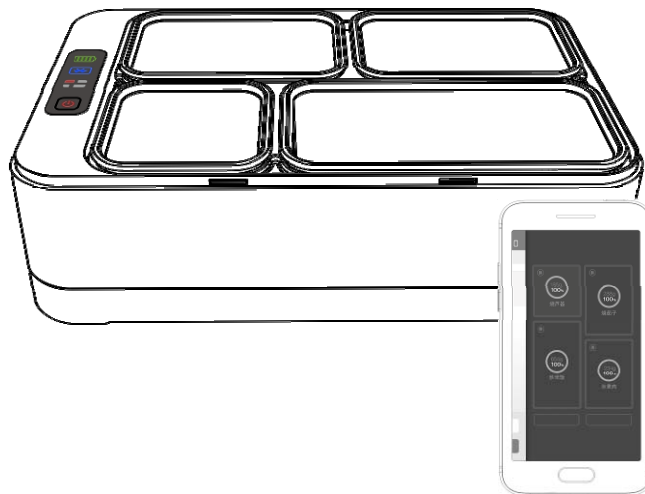

6. And you will be reminded when the meal is overweight.

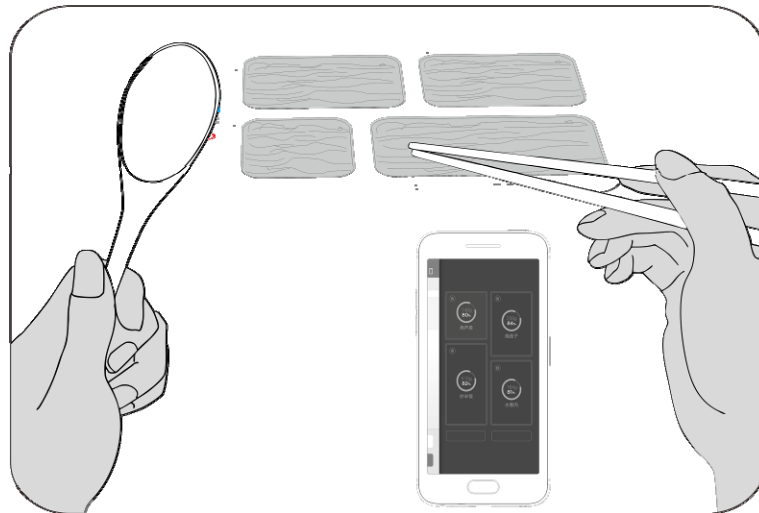

7.The meal is ready and you can enjoy the meal. The weight of the meal of each inside box will be displayed through app during your dining. And you can also experience the entertainment function of the app during the meal.

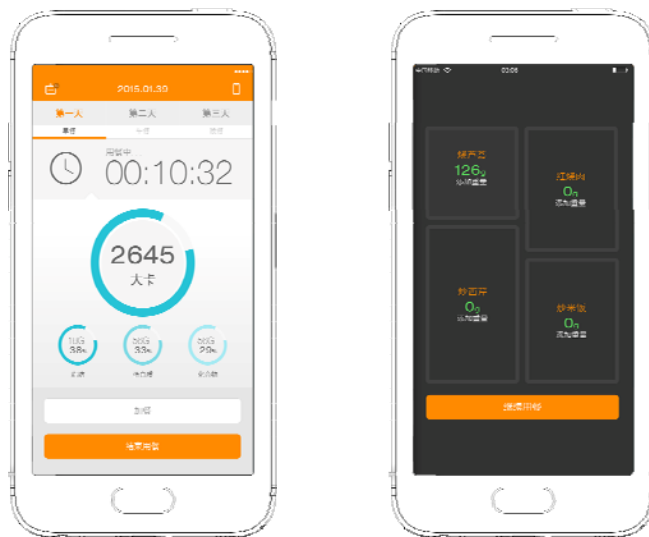

8.If you have good appetite today and have already eaten the selected meal, and the intake of the meal will be precisely measured by the Smart Box, and adding more meal is allowed as well. You can enter Add the Meal.

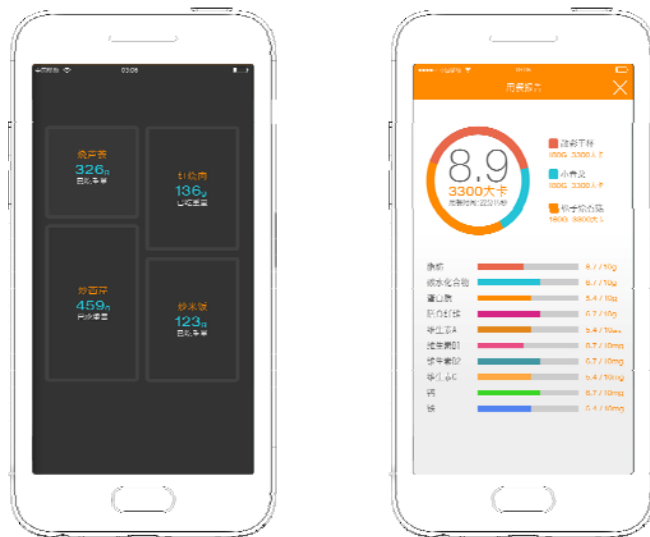

9.The warning notification will pop up if the amount of meal surpasses the recommended amount of meal, and the Smart Box will also vibrate to remind you about the excessive amount. You should stop dining in that case.

### 3.3 Other functions of the app

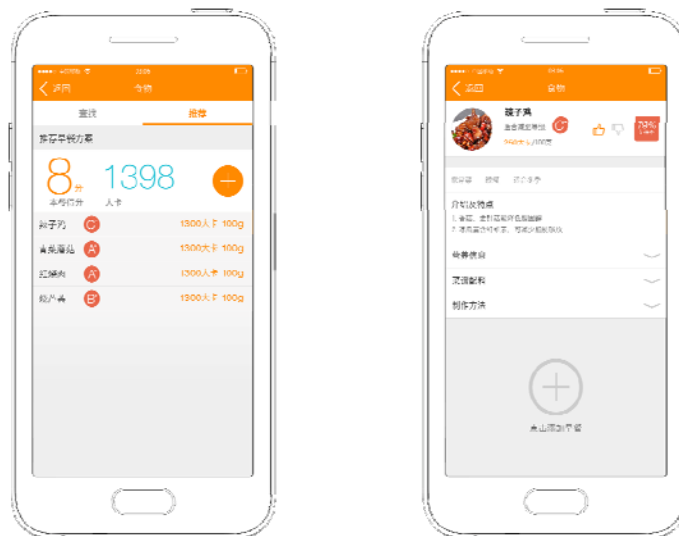

1. **【View Recipe】** : You can view recipe when using the Smart Box or app. And you can enter **【Personal Dining】** to view the personal recipe at the latest 3 days.

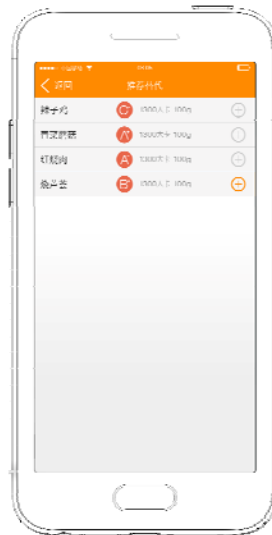

2. **【View/Change Recommended Menu】** : You can select dishes based on the recommended recipe of the app by entering **【Personal Dining】** , or select your favorite dishes by entering **【Customized Dining】** .



3. **【Nutrition Records】**: Dining records will be created after the meal. The amount of nutrition and micro-elements of each meal will be precisely calculated and you can view the detailed records of your dining.

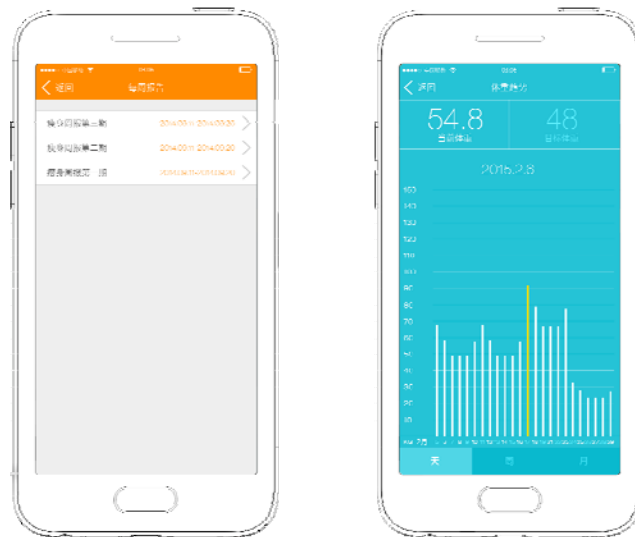

4. **【Weight Records】**: The change of your weight (one month) will be recorded in the form of curve chart. And you can view the detailed records and the change of curve chart.



5. **【Diet Records】**: If you have eaten some desserts or snacks which beyond the recommended recipe of the Smart Box, you can add related records of those food to gain more precise diet records.



6.. Exercise Recording: Besides scientific diet, fitting exercises can also promote healthy slimming. You can select exercise projects and check exercise details.

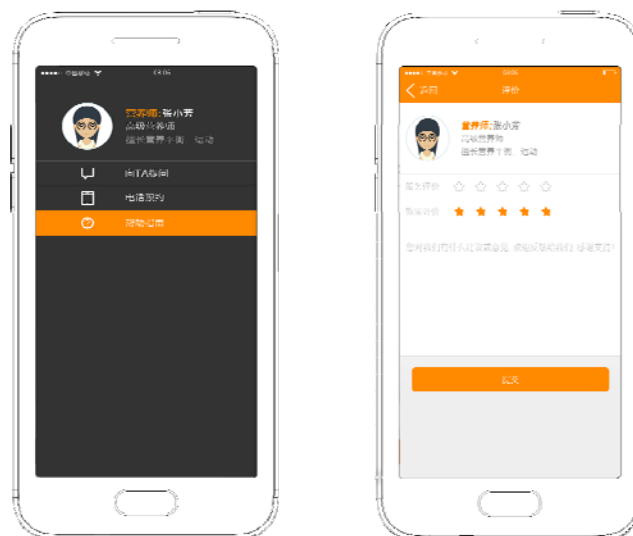

7. **【Online Communication With Nutritionists】**: If you have used our product for a period of time and the weight of your body have decreased but not obvious, you can leave the message to nutritionists or communicate with them online through the app.

## 4. Maintenance

- Please switch off the Smart Box after using it to protect the battery.
- Four inside boxes and the silicone ring of upper cover of the Smart Box can be cleaned by detergent and sponge, but it cannot be cleaned by steel wool.
- The body of the Smart Box can be cleaned by wet towel when it is stained. And it can also be flushed by running warm water (within 40°C) on condition that USB cover is well plugged, but the Smart Box cannot be soaked in the water for a long time, or else the water will enter into and cause the breakdown of the machine.
- If the Smart Box won't be used for a long time, please clean and put it into the packing box, and put it at the ventilated and dry place.

## 5 Fault and Exclusion

:

If there are any problems or faults in the process of using Smart Box, please try to figure them out by following methods:

### 5.1 Battery and Power button

Power button of Smart Box cannot be switched on. Neither battery indicator nor power button indicator is on.

Battery has been fully-discharged. Please recharge it.

Battery life has been exhausted. Please contact after-sale service department to change new battery.

Indicator of power button is not on and the box cannot be started up. The power button key might have physical fault.

### 5.2 Bluetooth and data connection

Bluetooth cannot be connected

- Bluetooth indicator of Smart Box is not on. Please restart the Smart Box.
- Bluetooth indicator is normal but it cannot connect with smart terminal software. Please restart the Bluetooth of smart-phone.

### 5.3 Data Measurement

Data measurement is not accurate.

- Check the operating environment of Smart Box. Please try to operate it under smooth and stable environment.



**Remark: If problems and faults cannot be excluded after analyzing phenomena mentioned above, please contact our maintenance department or dealer. Disassembling this device by non-specialized person is not allowed.**

## 6 Others

### Charging Adapter

This product and alternating-current(AC) power button adapter(accessory) can be used in any countries or regions with AC power button ranging from 100V to 240V, 50/60Hz.

When it is needed, please choose AC plug converter in accordance with local socket design.

- Electronic transformer (tour transformer) is not allowed to use in case it would cause breakdown.

### Battery

- We suggest that the battery be charged in ambient temperature ranging from 10-30°C. When it is beyond this range, the effectiveness of charging might be affected.
- Under the environment with low or high temperature, the performance of battery will be lowered. Therefore, when you use it in low or high temperature, working time of battery will be shortened and electric quantity will be consumed faster.
- As lifetime of battery is finite, battery capacity will be gradually reduced and working time will be shortened as time goes by. When working time is obviously shortened, please contact maintenance department to purchase and replace new battery.