

Hardware included / Quincaillerie incluse / Herramientas incluidas

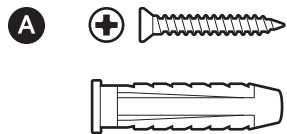

Tools needed / Outils nécessaires / Herramientas requeridas

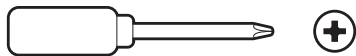

PH2

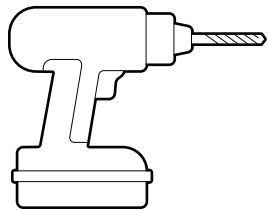

5 mm

1. Download the Ring app. / Téléchargez l'application Ring. / Descarga la app de Ring.



2. Scan the QR code on your device. / Scannez le code QR présent sur votre appareil. / Escanea el código QR en tu dispositivo.

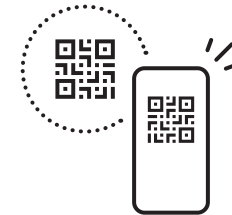

3. Choose a location. / Choisissez un emplacement. / Elige la ubicación.

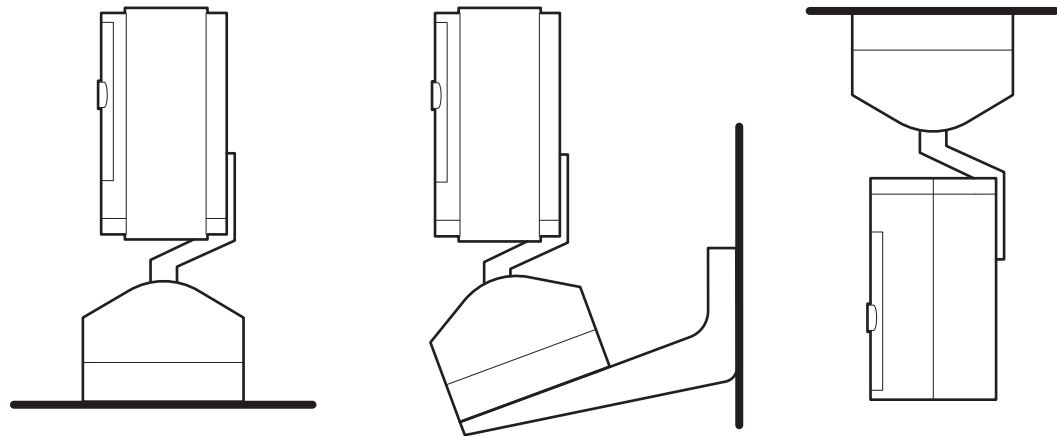

Flat installation / Installation à plat / Instalación en una superficie plana

Place your camera on a level surface with 6.5 in (16.5 cm) of space in every direction and plug in. / **Place your camera on a level surface with 6.5 in (16.5 cm) of space in every direction and plug in.** / Place your camera on a level surface with 6.5 in (16.5 cm) of space in every direction and plug in.

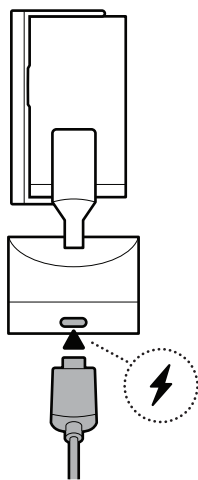
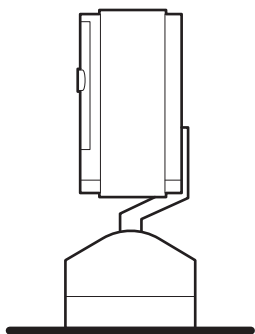

Wall installation / Wall installation / Wall installation

1. Use the mounting plate as a guide to mark screw holes on the wall with 6.5 in (16.5 cm) of space in every direction. / **Use the mounting plate as a guide to mark screw holes on the wall with 6.5 in (16.5 cm) of space in every direction.** / Use the mounting plate as a guide to mark screw holes on the wall with 6.5 in (16.5 cm) of space in every direction.

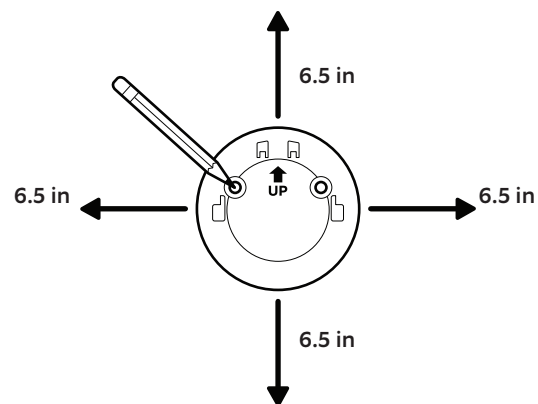

2. Install the mounting plate with the UP arrow pointing up. / **Install the mounting plate with the UP arrow pointing up.** / Install the mounting plate with the UP arrow pointing up.

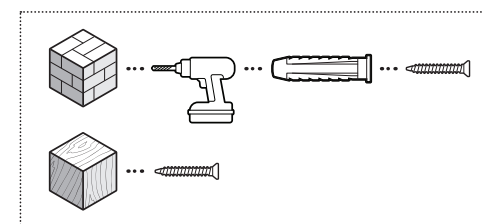
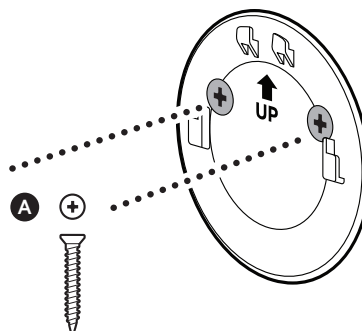

On stucco, brick, or concrete, use a 3/16 in (5 mm) masonry bit to drill holes for the included wall anchors. / **On stucco, brick, or concrete, use a 3/16 in (5 mm) masonry bit to drill holes for the included wall anchors.** / On stucco, brick, or concrete, use a 3/16 in (5 mm) masonry bit to drill holes for the included wall anchors.

3. Run the power cable through the hole in the mounting bracket and plug in. / Run the power cable through the hole in the mounting bracket and plug in. / Run the power cable through the hole in the mounting bracket and plug in.

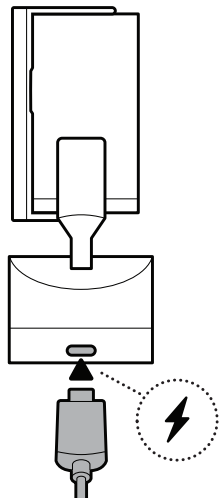
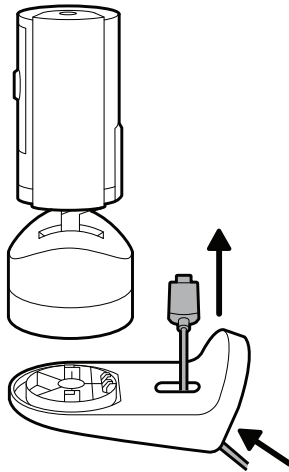

4. Secure your camera to the mounting bracket by sliding until you feel a click. / Secure your camera to the mounting bracket by sliding until you feel a click. / Secure your camera to the mounting bracket by sliding until you feel a click.

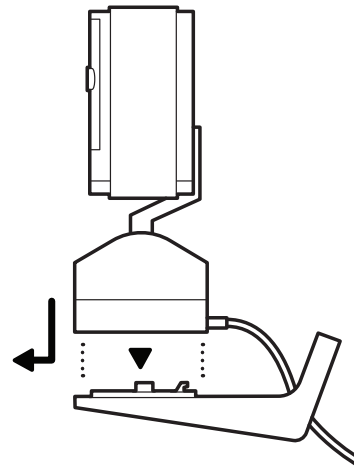

5. Secure your camera and bracket to the mounting plate by sliding until you feel a click. / Secure your camera and bracket to the mounting plate by sliding until you feel a click. / Secure your camera and bracket to the mounting plate by sliding until you feel a click.

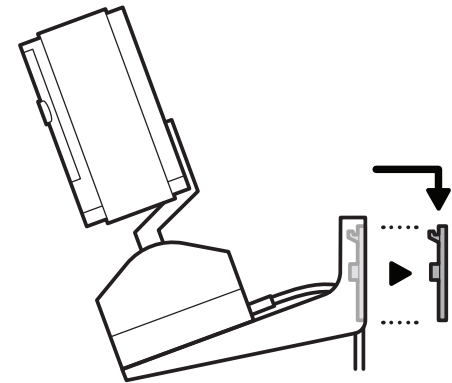

Ceiling installation / Ceiling installation / Ceiling installation

1. Use the mounting plate as a guide to mark screw holes on the ceiling with 6.5 in (16.5 cm) of space above and around.
/ Use the mounting plate as a guide to mark screw holes on the ceiling with 6.5 in (16.5 cm) of space above and around.
/ Use the mounting plate as a guide to mark screw holes on the ceiling with 6.5 in (16.5 cm) of space above and around.

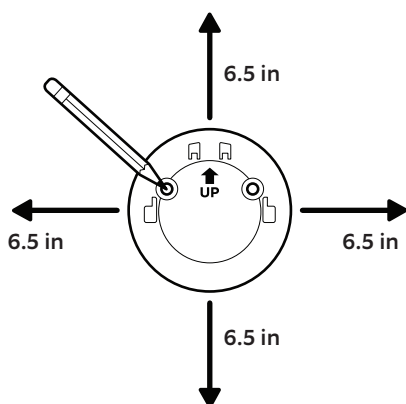

2. Install the mounting plate with the UP arrow pointing opposite of your desired viewing direction. / Install the mounting plate with the UP arrow pointing opposite of your desired viewing direction. / Install the mounting plate with the UP arrow pointing opposite of your desired viewing direction.

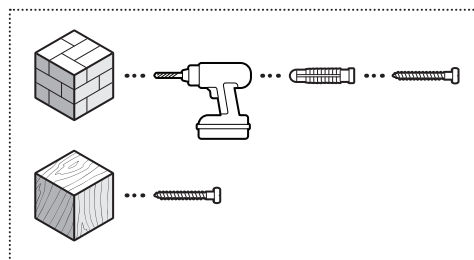
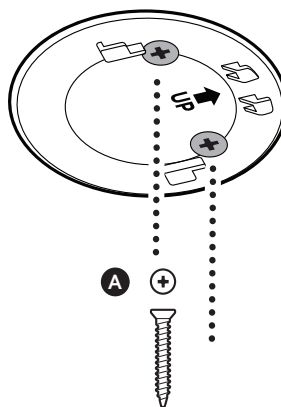

On stucco, brick, or concrete, use a 3/16 in (5 mm) masonry bit to drill holes for the included wall anchors.
/ On stucco, brick, or concrete, use a 3/16 in (5 mm) masonry bit to drill holes for the included wall anchors.
/ On stucco, brick, or concrete, use a 3/16 in (5 mm) masonry bit to drill holes for the included wall anchors.

3. Secure your camera to the mounting plate by sliding until you feel a click. / Secure your camera to the mounting plate by sliding until you feel a click. / Secure your camera to the mounting plate by sliding until you feel a click.

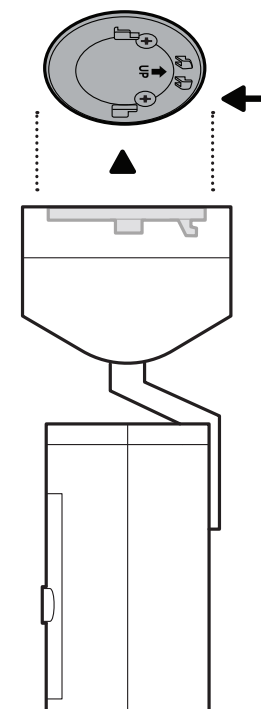

4. Plug in the power cable. / Plug in the power cable. / Plug in the power cable.

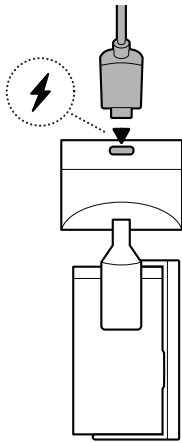

Using the privacy cover. / Using the privacy cover. / Using the privacy cover.

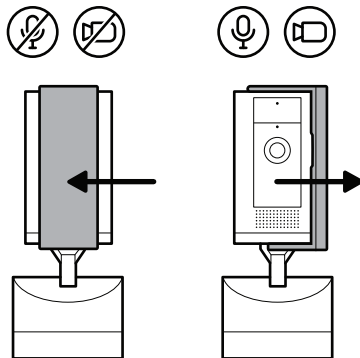

Removing the privacy cover. / Removing the privacy cover. / Removing the privacy cover.

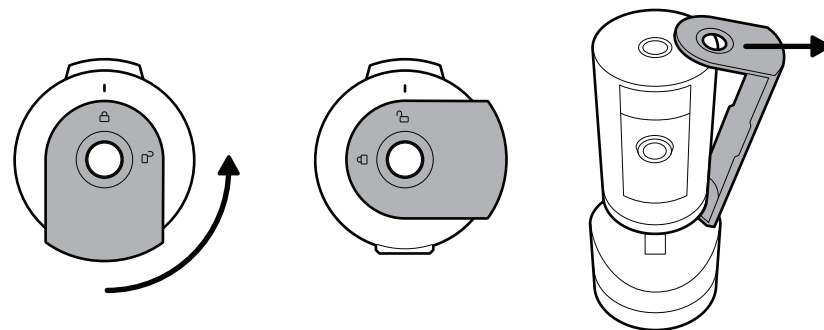

Attaching the privacy cover. / Attaching the privacy cover. / Attaching the privacy cover.

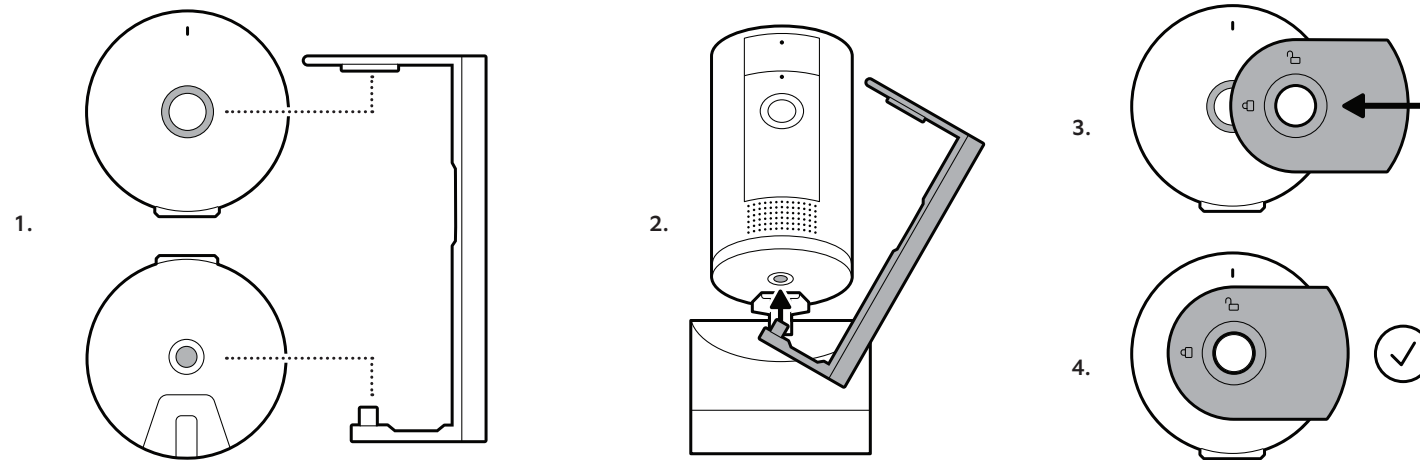

 ring.com/callus

 ring.com/help