

Model: M-BOX/P3

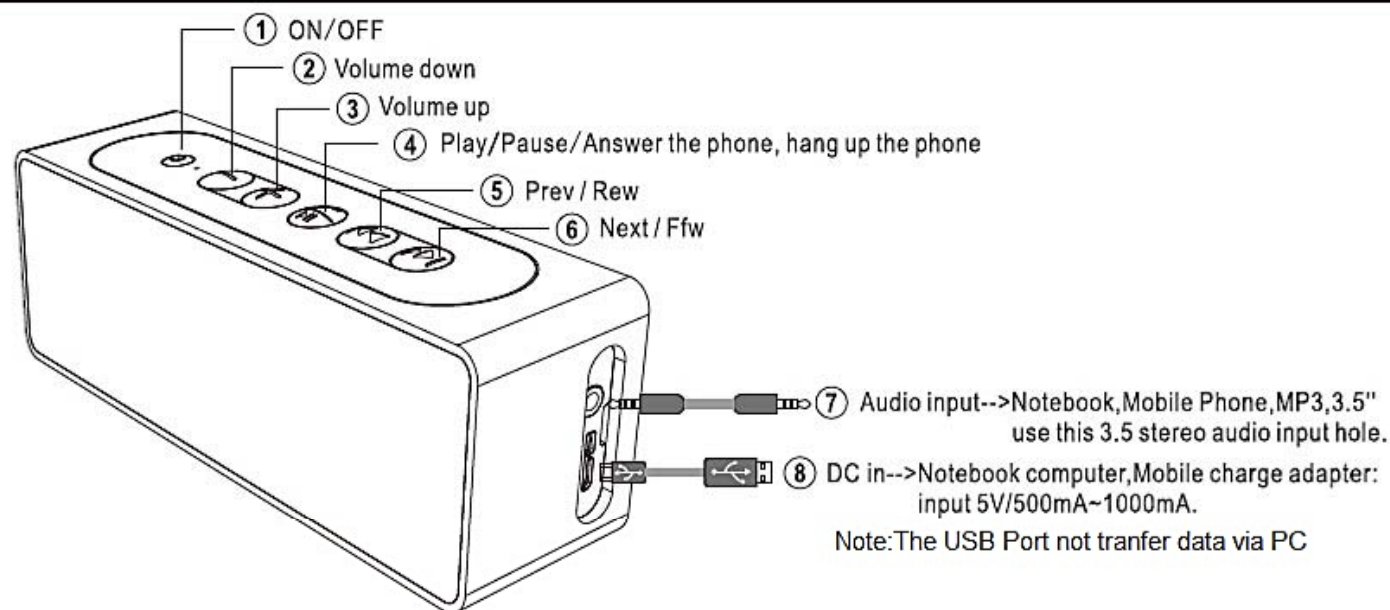

★ **Tips! Please give the new device charging before use!**

- ① ON/OFF button: Long press(5 seconds) ,Power On.Short press,the following functional switchover(BT/Aux in).
- ② Play and Pause button:
 - ※ BT situation:Short press ,play and pause,When called line,short press and answer the call.press again,hung up. When press twice in a short time,can call the last call number.
 - ※ Aux in situation:Short press ,play and mute.

- ③ “-” :Long press ,the volume down.shor press ,prev.
- ④ “+” : Long press,the volume up,Next.
- ⑤ “⏮” :shor press ,prev ,long press,the Rev.
- ⑥ “⏭” : shor press ,Next ,long press,the Ffw.

FAQ:

If you have problems as following when you are using the speaker unit, please refer the following instructions, if still can not solve the problem, please contact the agency, Do not repair by yourself.

1. If there's no sound from the speaker?

1) Check if the power is on.

2) Check if the battery is empty (charged it).

3) Check if the "AUX In" cable is been connected well.

SAFETY PRACTICES:

※ To ensure safety, firstly, please read and obey the following safety practices.

※ Any edge cutting, not smooth surface, metal parts, accessories, or package are all possible to cause the bleed or injured accidentally, please be careful when using.

※ This product can't be eaten, please keep kids off it!

※ Do not modify, repair or dismantle the product without authorization, improper handling may lead to wires short-circuit, product damaged or even cause fire. It will lose efficacy if the product has been changed without authorization.

※ Do not use any cleaner or fluid to clean the speaker surface, this product can only use dry cloth clean.

2. Occur distortion when the volume is loud?

1) Please check the USB power cable, if there's no enough power to support the battery, and change another USB cable.

2) Please check if the sound source is not connect well.

3. The box play normally with charged 3.7V battery, if connecting to 5V power supply, it may lead to sound distortion.

※ Not appropriately control the volume of the speaker (Such as frequently readjust the volume), will impact the speaker's effect, or damage the speaker.

※ Please try to avoid dropping down, collision or excessive pressure.

※ Please do not use the product in dangerous surrounding (special work condition, such as laboratory), the product may cause interference to the sensitive surrounding.

※ If any abnormal situation occurs when using, please immediately stop using this product.

※ Drop into fire or high temperature environment may explode.

FCC Statement:

This equipment has been tested and found to comply with the limits for a Class B digital device, pursuant to part 15 of the FCC Rules. These limits are designed to provide reasonable protection against harmful interference in a residential installation. This equipment generates, uses and can radiate radio frequency energy and, if not installed and used in accordance with the instructions, may cause harmful interference to radio communications.

However, there is no guarantee that interference will not occur in a particular installation. If this equipment does cause harmful interference to radio or television reception, which can be determined by turning the equipment off and on, the user is encouraged to try to correct the interference by one or more of the following measures:

- Reorient or relocate the receiving antenna.
- Increase the separation between the equipment and receiver.
- Connect the equipment to an outlet on a circuit different from that to which the receiver is connected.

This device complies with part 15 of the FCC rules. Operation is subject to the following two conditions: (1) This device may not cause harmful interference, and (2) this device must accept any interference received, including interference that may cause undesired operation.

Note: Modifications to this product will void the user's authority to operate this equipment.