

bewell
connect®

UK

MyCompanion



 **RoHS**

FC



CE 0890

BW-PX10

By **Visionmed®**

This product complies with EN 301 489-7, -1; EN 300 440-1, -2 ; EN 301 511; EN 301 489-1, 3; EN60950-1; SGS UK 0890; Reach (RoHS).

Changes or modifications not expressly approved by the party responsible for compliance could void the user's authority to operate the equipment.

This equipment has been tested and found to comply with the limits for a Class B digital device, pursuant to Part 15 of the FCC Rules. These limits are designed to provide reasonable protection against harmful interference in a residential installation. This equipment generates, uses and can radiate radio frequency energy and, if not installed and used in accordance with the instructions, may cause harmful interference to radio communications. However, there is no guarantee that interference will not occur in a particular installation.

If this equipment does cause harmful interference to radio or television reception, which can be determined by turning the equipment off and on, the user is encouraged to try to correct the interference by one or more of the following measures:

- Reorient or relocate the receiving antenna.
- Increase the separation between the equipment and receiver.
- Connect the equipment into an outlet on a circuit different from that to which the receiver is connected.
- Consult the dealer or an experienced radio/TV technician for help.

This device complies with Part 15 of the FCC Rules. Operation is subject to the following two conditions: (1) this device may not cause harmful interference, and (2) this device must accept any interference received, including interference that may cause undesired operation.

FCC RF Exposure Requirements:

This equipment must be installed and operated in accordance with provided instructions and the antenna(s) used for this transmitter must be installed to provide a separation distance of at least 20 cm from all persons and must not be co-located or operating in conjunction with any other antenna or transmitter. End-users and installers must be provided with antenna installation instructions and transmitter operating conditions for satisfying RF exposure compliance.

CAUTION: This device is designed for use on Domestic Animal ONLY

TABLE OF CONTENTS

1. NOTES ON SAFETY.....	29
2. USE	30
2-1. DESCRIPTION	30
2-2. CHARGING THE BATTERY	30
2-3. INSTALLING THE SIM CARD	30
2-4. SWITCHING ON.....	31
2-5. ATTACHING THE TRACKER TO THE ANIMAL'S COLLAR.....	32
3. APPLICATION	33
3-1. DOWNLOADING THE APPLICATION	33
3-2. CREATING THE ANIMAL PROFILE	34
3-3. ACTIVATING THE TRACKER	36
4. FEATURES.....	37
4- 1. TRACK THE PERFORMANCE OF THE ANIMAL	37
4-2. LOCATING THE ANIMAL	39
4-3. FOLLOW THE ROUTE TAKEN BY THE ANIMAL	40
4-4. NEARBY FUNCTION	41
4-5. SETTINGS	42
4-6. MODES OF USE OF THE DEVICE	43
5. HOW TO MAINTAIN AND STORE THE UNIT	44
6. HOW TO PREVENT A MALFUNCTION.....	44
7. FEATURES	45
8. TROUBLESHOOTING.....	46
9. GLOSSARY / FAQ.....	48

Log onto our website to find out how to install and use the BewellConnect application www.bewell-connect.com/install.

*The manufacturer keeps the right to modify without any preliminary opinion
technical specifications of the product.*

Dear Customer,

You have just purchased this BewellConnect tracker and we thank you for your confidence.

We hope you will get the best use out of it and we advise you to read this instruction manual carefully.

Our pets play an important role in our daily lives. Companions for play, hunting, guide for disabled person, they bring joy, comfort, and also break loneliness and isolation. Precious like a family member, the loss of an animal is a major source of anguish. Animals often run away and need to be protected from surrounding dangers or accidents it can cause. Having a pet also means taking care of its health. In town, our animals often don't get enough exercise. This is why we need to check their nutrition and physical activity to prevent overweight.

MyCompanion is a little box which is fitted to the animal's collar. It is a little concentration of technology. It contains a GSM/GPS/GPRS tag and various sensors make it possible, at any time, to locate your pet and accurately follow the path it has travelled to go and find it. All collected data is stored on secure servers in France.

MyCompanion enables you to monitor the physical activity of your animal: distance travelled, number of paces, calories burned. You can fix goals of longer walks to get it to move more and

check its caloric expenditure in relation to its physical activity.

Connected all the time, MyCompanion works on 2G networks and +, offering the densest coverage availability in the world.

1. NOTES ON SAFETY

- Use this appliance only for the use for which it is designed as described in this manual.
- This appliance may be used for personal use at home. Do not use the unit for other purpose.
- Use this appliance in an ambient temperature range of 0 to 60°C.
- Do not expose this appliance to extreme temperature conditions > 60°C ou < -20°C.
- Do not expose this appliance to electric shocks.
- Never drop the appliance.
- Follow the maintenance instructions specified in this manual.
- Do not attempt to open the device. In case of problems, contact your dealer.
- Do not leave this appliance within the reach of children.
- Discontinue use of the device in case of anomalies or malfunction.

2. USE

2-1. DESCRIPTION

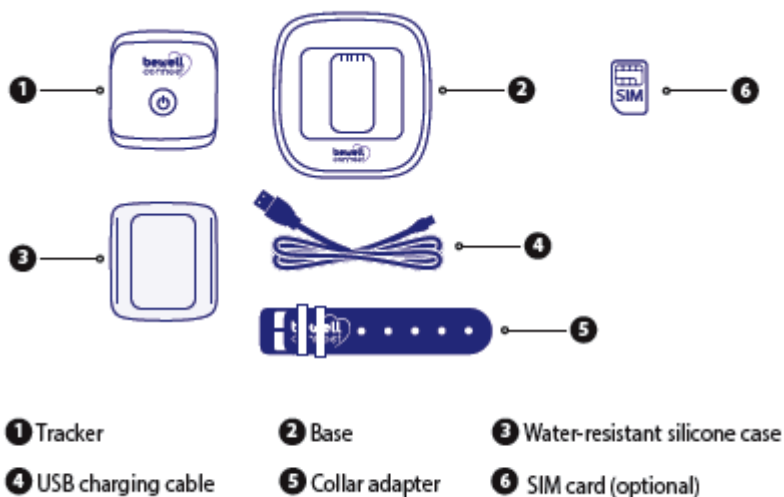

2-2. CHARGING THE BATTERY

When using the device for the first time, make sure you charge the battery via the USB port provided for this purpose. Connect the USB cable from your device to your computer to load the product. Once the appliance is charged, you can disconnect the USB cable.

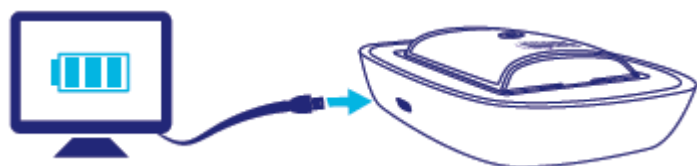

CAUTION
**RISK OF EXPLOSION IF BATTERY IS REPLACED
BY AN INCORRECT TYPE.
DISPOSE OF USED BATTERIES ACCORDING TO
THE INSTRUCTIONS.**

2-3. INSTALLING THE SIM CARD

- If the product is delivered without operator SIM :

You have obtained a second SIM card from your operator, or a twin card on your usual subscription

OR you have acquired a classic internet/sms/voice type subscription.

Regardless of the chosen operator, check that the subscription includes a sufficient number of sms and data volume suited for its use (refer to your operator's instructions).

Important : In both cases, check that the PIN code of the SIM card is deactivated.

• **If the product is delivered with a SIM card :**

The SIM card is pre-activated, it suffices to insert it into the product.

This procedure is likely to change depending on the operator. Please consult the internet site to take advantage of the latest updates :

www.bewell-connect.com/install

Important : the tracker should be switched off when the SIM is inserted. Open the trap and insert the SIM (see diagram below).



2-4. SWITCHING ON

To turn on the device, press and hold the button for about 8 seconds, until the LED shifts to red.



2-5. ATTACHING THE TRACKER TO THE ANIMAL'S COLLAR

A. Attach the tracker directly on the collar

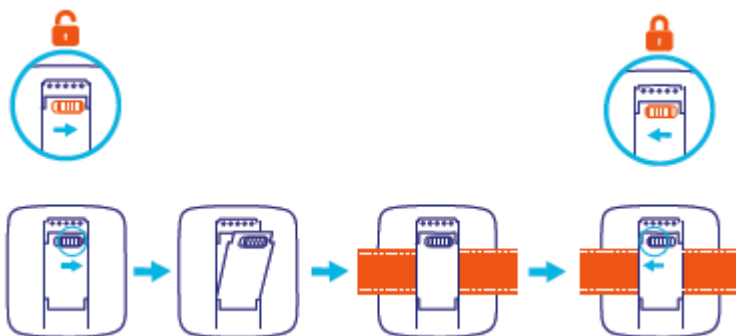

B. For big collars, use the collar adapter



C. To protect the tracker, use the silicone water-resistant case, and attach it to the collar

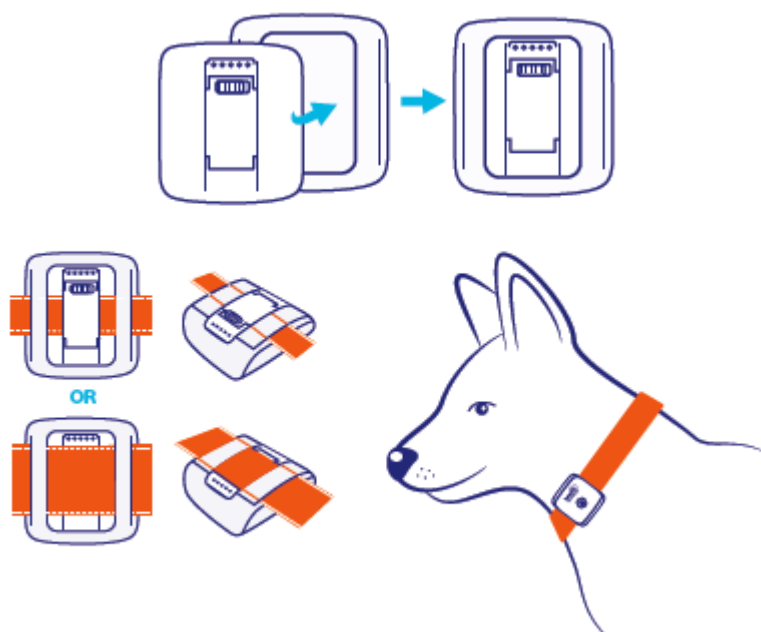

3. APPLICATION

The following information is likely to be updated.

3-1. DOWNLOADING THE APPLICATION

Download the application BewellConnect onto your phone or tablet:



- By the App store or Google Play



- or by flashing the QR Code located on the side of the box.

Then click on the icon MyCompanion.

3-2. CREATING THE ANIMAL PROFILE

Create a profile OK

+ SIM 13145733693
Name Buddy

Birthday 22/09/2011

Gender : Male Female

Breed : Dog Cat

Weight 25kg

Goal 10000steps

Size 58 cm

Owner Add +

Veterinary Add +

User Profile Modify

Buddy 13145733693

Date of birth 22 09 2011 (3yrs)

Gender Male

Breed Dog

Weight 25kg

Size 58cm

Owner Louis Marceau
23 rue Guérin - 35000 RENNES
+33 1 23 45 67 89
+33 1 23 45 67 89

Veterinary Clinique de l'Arsenal
25 Bvd Voltaire - 35000 RENNES
+33 1 23 45 67 89

> PET ACTIVITY

When opening MyCompanion, create the profile of your animal by completing the required fields. You may take a photo or add one from those presented in your smartphone. You can add the complete physical characteristics of your animal.

You can create several profiles, and select them in the *Companions* menu.

User Profile Modify

Buddy 13145733693

Date of birth 22 09 2011 (3yrs)

Gender Male

Breed Dog

Weight 25kg

Size 58cm

Owner Louis Marceau
23 rue Guérin - 35000 RENNES
+33 1 23 45 67 89
+33 1 23 45 67 89

Veterinary Clinique de l'Arsenal
25 Bvd Voltaire - 35000 RENNES
+33 1 23 45 67 89

> PET ACTIVITY

Companions +

Buddy 13145733693 99%

Harlow 13145733745 17%

Miika No tracker

3-3. ACTIVATING THE TRACKER

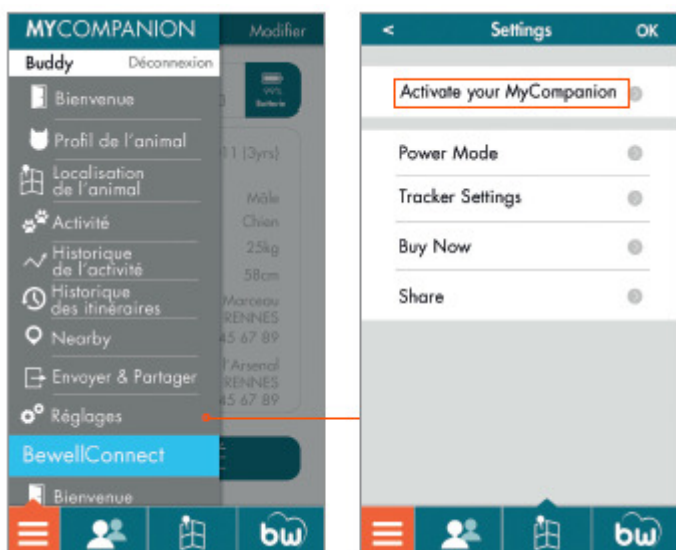

Activate the tracker in the *Settings* menu. Copy the IMEI number on the product packaging. Enter the telephone number associated with the SIM card (on the packaging of the product, or provided by the operator).

4. FEATURES

4- 1. TRACK THE PERFORMANCE OF THE ANIMAL



Click on the *Pet Activity* button in the profile

OR

Select the *Pet Activity* menu.

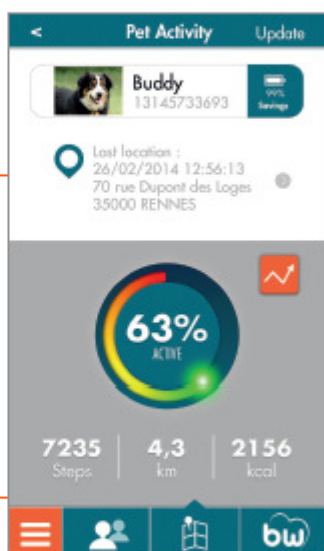

4-2. LOCATING THE ANIMAL

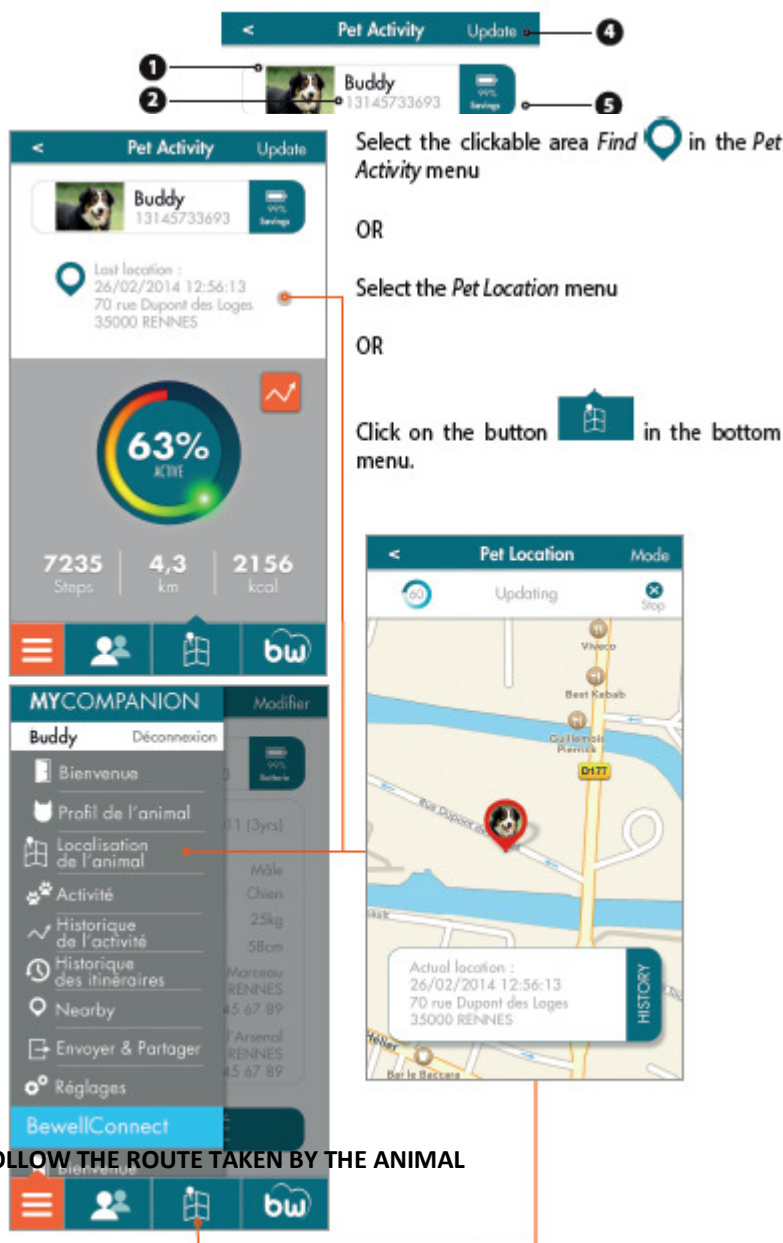

Select the clickable area **Find** in the **Pet Activity** menu

OR

Select the **Pet Location** menu

OR

Click on the button in the bottom menu.

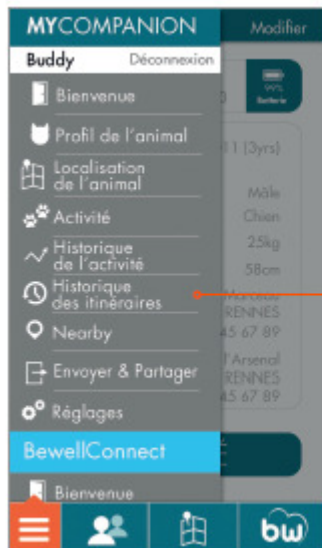

Select the *Pet Route History* menu

OR

Click on the *Pet Route History* shortcut in the *Pet Location* menu.

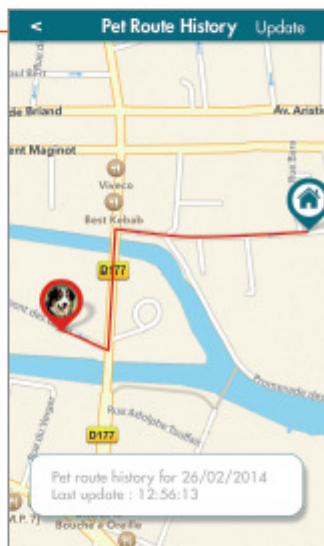
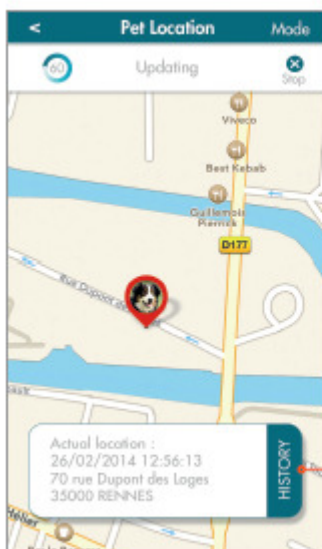

4-4. NEARBY FUNCTION

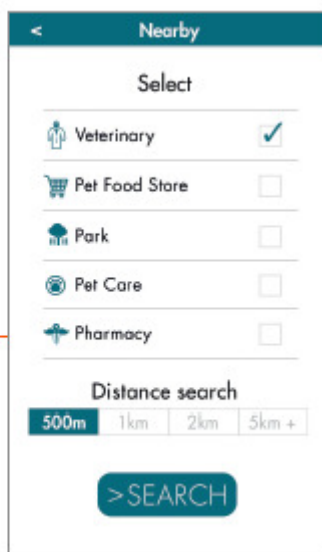
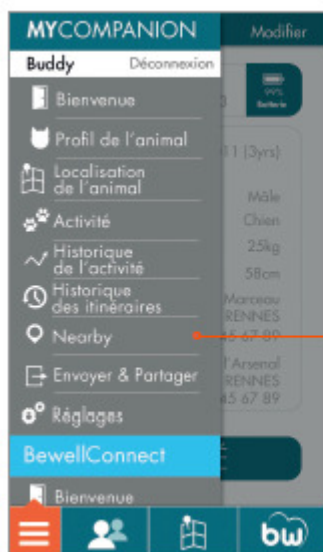

The *Nearby* function allows you to search the point of interest closest to the location where you are without effort.

The points of interest available are :

- Veterinary surgeons
- Shops for animals or pet shops
- Parks
- Grooming centres
- Pharmacies

The radius is adjustable from 500 metres to 5 kilometres.

4-5. SETTINGS

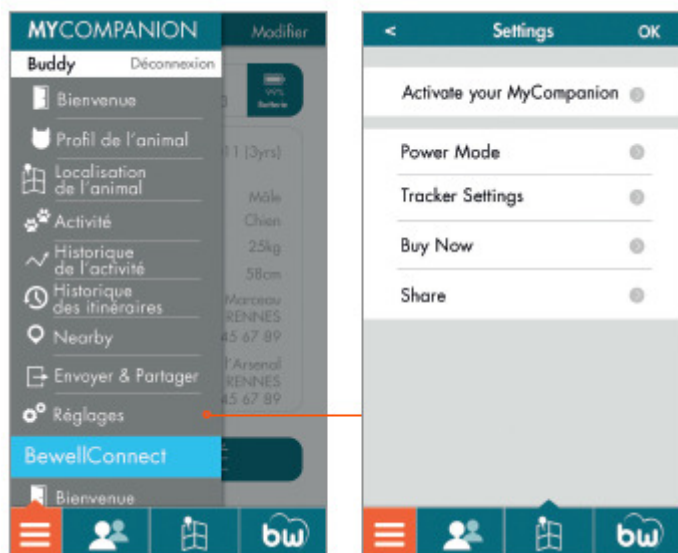

- Activate your MyCompanion : allows you to activate a tracker.
- Power mode : allows you to choose the mode of use of the battery.
- Tracker Settings : allows you to see and modify the SIM/IMEI association for each of the trackers.
- Buy Now: link to the Bewellconnect online shop.
- Share : allows you to share the performance of your animals via social networks.

4-6. MODES OF USE OF THE DEVICE

Your MyCompanion has 3 available modes, which affect battery life.

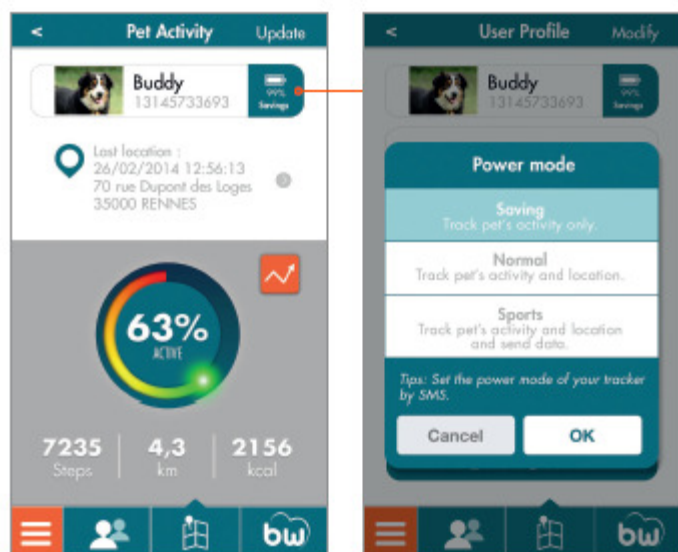

- An energy saving mode (Saving) : MyCompanion calculates only the activity of the animal.

The position may be displayed on request. Battery life of approximately 7 days.

- **A normal mode of use (Normal)** : MyCompanion calculates the position and activity of the animal every 5 minutes. This information are stored in the memory of the device for longer battery life. Battery life of approximately 4 days.
- **A “real time” mode (Sport)** : MyCompanion calculates and transmits its position and the activity of the animal every 5 minutes. The information is updated automatically. This mode is suitable for walks and physical exercise. Battery life of approximately 24 hours.

5. HOW TO MAINTAIN AND STORE THE UNIT

- Use a dry soft cloth to clean the unit. If necessary, use a cloth lightly dampened with tap water.
- Do not use alcohol, benzene, thinner or other harsh chemicals to clean the device.

6. HOW TO PREVENT A MALFUNCTION

- Do not drop the device and avoid sudden jars or shocks.
- Do not insert other objects into any holes.
- Do not attempt to disassemble the unit.
- Do not turn device in water
- The monitor might not meet its performance specifications or cause safety hazard if stored or used outside the specified temperature and humidity ranges in specifications.

7. FEATURES

Product name	BewellConnect® MyCompanion
Model	BW-PX10
Dimensions	47 x 47 x 20 mm
Weight	Tracker : 34,7g - Base : 110g
Working Temp.	Temp. : 0~60°C
Storage Temp.	Temp. : -20~80°C
Frequency	GSM850 / EGSM900 Class4 (2W) 33dBm / DCS1800 / PCS1900 Class1 (1W) 30dBm
System of additional localization	Cellid and triangulation GSM / GPRS
Format SIM card	Micro
Sealing	IP65
Battery	LiPo
Charging time	2h
Duration of the battery	7 days on standby
USB	USB 2.0 Port
Voltage	3,7V
Consumption	<2mA
Amperage	360mAh
Battery life	7days (Save Mode)
Supplied accessories	A tracker for animal, a collar adapter, a charging base, a supplied USB cable, a silicone water-resistant case, an instruction manual, a quickstep

8. TROUBLESHOOTING

If you have one of the following problems with MyCompanion, please refer to this breakdown service guide to help resolve the problem. If the problem persists, please contact our customer service.

DIODE COLOUR GUIDE		
Action	Status	Meaning
Pressing and holding the button for 7 seconds	Red continuous	Power On
Pressing and holding the button for 7 seconds	Red continuous	Power Off
Low Battery	Flashing red	Battery below 20%
On the base	Red continuous	Under charge
	Blue continuous	100% charged
Upload data / synchro with the cloud	Flashing blue	Synchronization of data with the cloud
Problem with the SIM card	Flashing red	SIM incorrectly installed / SIM unable to use the network
Order received	2 blue flashes	Order received and accepted

9. GLOSSARY / FAQ

- GPS (global positioning system) :

Positioning system by American satellite (average accuracy of 2 to 10 m)

- CELLID (cell identifier) :

Location by reference to the locations of GSM phone antennas

- SIM :

Accepts all cards in the micro SIM format. The PIN code must be disabled or equal to 0000.

Uses sms and data.

To locate itself, MyCompanion uses both CELLID and GPS. To analyze the activity, MyCompanion uses an accelerometer and calculates the calories burned, distance travelled, and the number of paces.

REMINDER ON THE MODES			
Mode	Activity	Location	Meaning
Save	X	—	Activity : followed, kept in memory Location : no (on request only) Energy consumption : minimum, max battery life 7 days Recommended for : walks and simple monitoring Not connected to the server (on request only)
Normal	X	X	Activity : followed, kept in memory Location : every 5 min, kept in memory Energy consumption : Average, max battery life 4 days Recommended for : walk and physical monitoring of the animal Not connected to the server (on request only) In normal mode, an update with the cloud will be automatically triggered when the battery goes below 10 %.
Sport	X	X	Activity : followed, sent to the cloud Location : every 5 min, sent on the server/cloud. Energy consumption : maximum, max battery life 1 day Recommended for : sporting activity Connected to the server/cloud

Regardless of the mode chosen, the user always has the possibility to send the *Find* orders (sending an SMS to the tracker), *Update* (updating of the data), *Pet Route History*, *Nearby* (this information goes through secure servers in France).