

CONTROLS

DE Bedienung ES Controles FR Contrôles IT Controlli PT Controlos SE Kontroller JP コントロールボタン ZH 控制操作 TR Kontroller
BA Управління CZ Řízení RO Management SK Ovládanie LV Vadības ierīces LT Valdikliai EE Juhtnupud PL Funkcje



x1

2s

5s

10s



ON

OFF

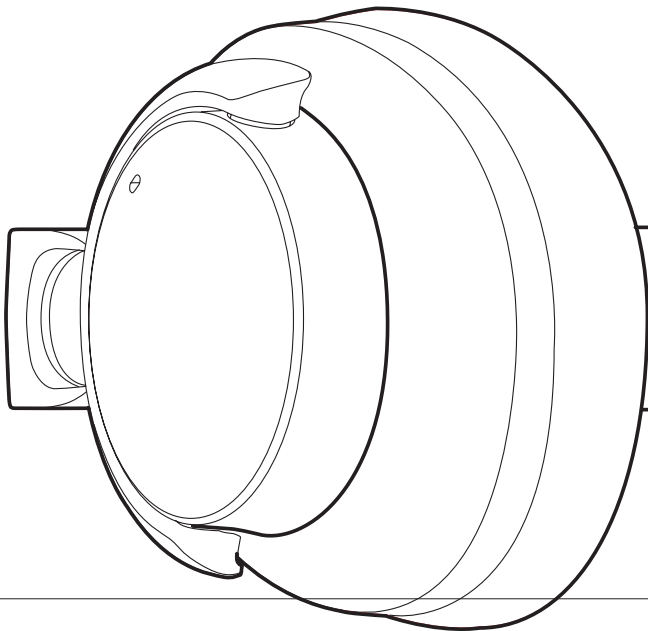

x1

2s



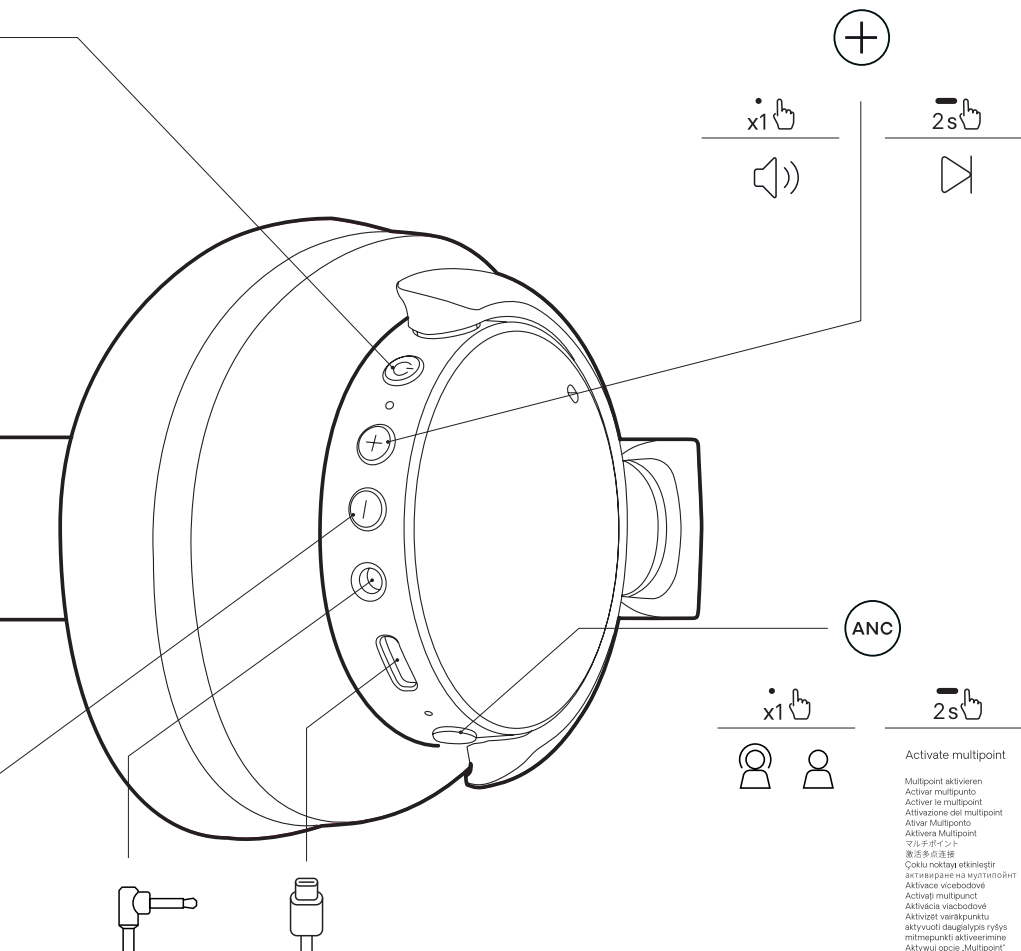

Activate multipoint

Multipoint aktivieren
 Activar multipunto
 Activer le multipoint
 Attivazione del multipoint
 Aktivier Multipoint
 Attivera Multipoint
 マルチポイント
 多点多点接続
 Czeku noktasy etkileşim
 активізація на мультиточках
 Aktivace vícebodové
 Aktiviraj multipunt
 Aktivacija višebodovė
 Aktivizēt vairākpunktu
 aktywizuj duagialypis ryšys
 miltmepunkti aktivierimine
 Aktywuj opcję „Multipoint”

URBANISTA VALENCIA

QUICK START GUIDE

SCHNELLSTARTANLEITUNG

GUÍA DE INICIO RÁPIDO

GUIDE DE DÉMARRAGE RAPIDE

GUIDA RAPIDA

GUIA DE INÍCIO RÁPIDO

SNABBSTARTSGUIDE

クイックスタートガイド

快速入门指南

HIZLI BAŞLANGIÇ KILAVUZU

РЪКОВОДСТВО ЗА БЪРЗ СТАРТ

STRUČNÝ NÁVOD K POUŽITÍ

GHID DE ÎNȚIERE RAPIDĂ

SPRIEVODCA RÝCHLYM SPUSTENÍM

ĪSĀ LIETOŠANAS INSTRUKCIJA

GREITASIS NAUDOJIMO VADOVAS

KIIRKÄSIJUHEND

SKRÓCONA INSTRUKCJA OBSŁUGI

POWER ON & CONNECT

^{DE} Einschalten und anschließen ^{ES} Encender y conectar ^{FR} Allumer et connecter ^{IT} Accendi e connetti ^{PT} Encender y conectar ^{SE} Slå på och anslut
^{JP} 電源・接続 ^{ZH} 开机并连接 ^{TR} Gücü açın ve bağlanın ^{BG} Включете и свържете ^{CZ} Zapněte a připojte se ^{RO} Porniți și conectați ^{SK} Zapnite a pripojte sa
^{LV} Ieslēdziet un izveidojiet savienojumu ^{LT} Įjunkite ir prijunkite ^{EE} Lülitage sisse ja ühendage ^{PL} Włącz i połącz

1

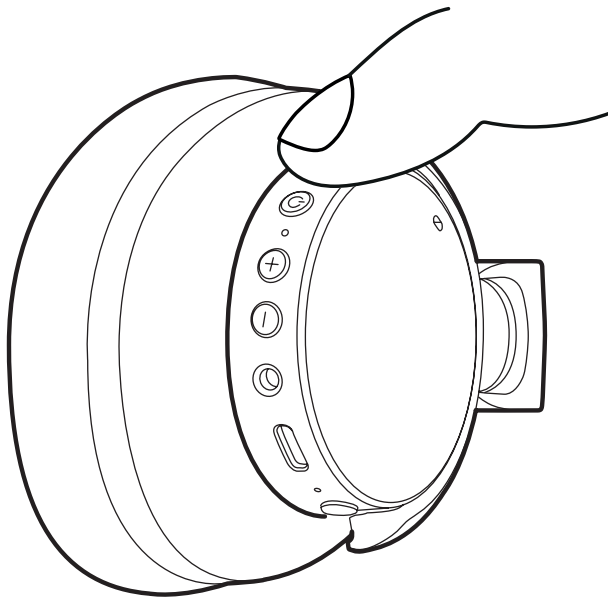

2

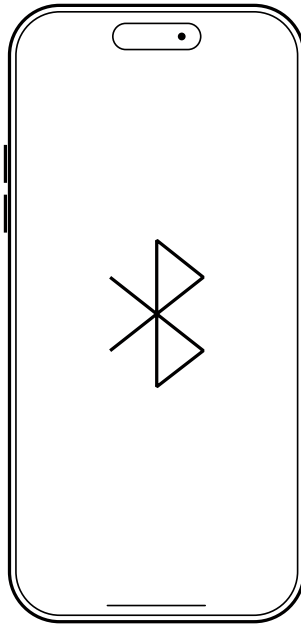

"Urbanista Valencia"

FCC Warning

This device complies with part 15 of the FCC Rules. Operation is subject to the following two conditions: (1) This device may not cause harmful interference, and (2) this device must accept any interference received, including interference that may cause undesired operation.

Any changes or modifications not expressly approved by the party responsible for compliance could void the user's authority to operate the equipment.

This equipment has been tested and found to comply with the limits for a Class B digital device, pursuant to part 15 of the FCC Rules. These limits are designed to provide reasonable protection against harmful interference in a residential installation. This equipment generates, uses and can radiate radio frequency energy and, if not installed and used in accordance with the instructions, may cause harmful interference to radio communications. However, there is no guarantee that interference will not occur in a particular installation. If this equipment does cause harmful interference to radio or television reception, which can be determined by turning the equipment off and on, the user is encouraged to try to correct the interference by one or more of the following measures:

- Reorient or relocate the receiving antenna.
- Increase the separation between the equipment and receiver.
- Connect the equipment into an outlet on a circuit different from that to which the receiver is connected.
- Consult the dealer or an experienced radio/TV technician for help.

FCC Radiation Exposure Statement

This equipment complies with FCC radiation exposure limits set forth for an uncontrolled environment. This transmitter must not be co-located or operating in conjunction with any other antenna or transmitter.

urbanista

URBANISTA.COM

ISED Warning

This device contains licence - exempt transmitter(s)/receiver(s) that comply with Innovation, Science and Economic Development Canada's licence - exempt RSS(s). Operation is subject to the following two conditions:

- (1) This device may not cause interference.
- (2) This device must accept any interference, including interference that may cause undesired operation of the device.

Cet appareil contient des émetteurs/récepteurs sans licence qui sont conformes aux RSS sans licence d'Innovation, Sciences et Développement économique Canada. L'exploitation est soumise aux deux conditions suivantes :

- (1) Cet appareil ne doit pas causer d'interférences.
- (2) Cet appareil doit accepter toute interférence, y compris les interférences qui pourraient causer un fonctionnement indésirable de l'appareil.

ISED Radiation Exposure Statement:

This equipment complies with ISED RF radiation exposure limits set forth for an uncontrolled environment. This transmitter must not be co-located or operating in conjunction with any other antenna or transmitter.

Cet appareil est conforme aux limites d'exposition de rayonnement RF ISED établies pour un environnement non contrôlé.

Cet émetteur ne doit pas être co-implanté ou fonctionner en conjonction avec toute autre antenne ou transmetteur.

urbanista

URBANISTA.COM