

memorex™

MP3441

BLUETOOTH CD BOOMBOX

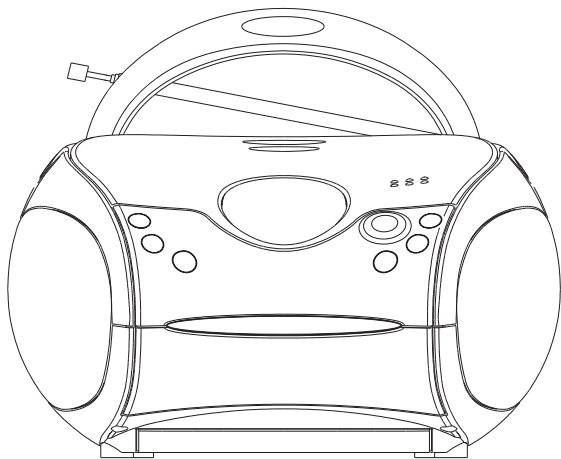

INSTRUCTION MANUAL

WARNING

CLASS 1 LASER PRODUCT

CLASS 1 LASER PRODUCT
APPAREIL À LASER DE CLASSE 1
PRODUCTO LASER DE CLASE 1

CAUTION
INVISIBLE LASER RADIATION
WHEN OPEN AND INTERLOCKS
DEFEATED.
AVOID EXPOSURE TO BEAM



This product contains a low power laser device.

Warning: Do not touch the lens.

DO NOT THROW BATTERIES IN FIRE !

PRECAUTIONS

Follow the advice below for safe and appropriate operations.

ON PLACEMENT

- Do not use the unit in places which are extremely hot, cold, dusty, or humid.
- Place the unit on a flat and even surface.
- Do not restrict the air flow of the unit by placing it in a place with poor air flow, by covering it with a cloth, or by placing it on a carpet.

ON SAFETY

- When connecting and disconnecting the AC cord, grip the plug and not the cord itself. Pulling the cord may damage it and create hazard.
- When you are not going to use the unit for a long period of time, disconnect the AC power cord.

ON AC VOLTAGE

- Before use, check that the rated voltage of your unit matches your local voltage.

ON CONDENSATION

- When left in a heated room where it is warm and damp, water droplets or condensation may form inside the CD player.
- When there is condensation inside the unit, the unit may not function normally.
- Let it stand for 1 to 2 hours before turning the power on, or gradually heat the room up and dry the unit before use.
- Ensure a minimum distance of 5 cm around the apparatus for sufficient ventilation.
- Ensure that the ventilation is not impeded by covering the ventilation openings with items, such as newspapers, table-cloths, curtains, etc..
- Do not place naked flame sources, such as lighted candles on the apparatus.
- Take attention to the environmental aspects of battery disposal.
- Use the apparatus only in moderate climates.
- Do not expose the apparatus to dripping or splashing.
- Do not place objects filled with liquids, such as vases, on the apparatus.
- Battery shall not be exposed to excessive heat such as sunshine, fire or the like.
- The mains plug of apparatus should not be obstructed OR should be easily accessed during intended use.

Should any trouble occur, disconnect the AC power cord and refer servicing to qualified personnel.



The lightning flash with arrowhead symbol within the triangle is a warning sign alerting the user of "dangerous voltage" inside the unit.

CAUTION

**RISK OF ELECTRIC SHOCK
DO NOT OPEN**

ATTENTION : To reduce the risk of electric shock, do not remove the cover. There are no user serviceable parts inside the unit. Refer all servicing to qualified personnel.



The exclamation point within the triangle is a warning sign alerting the user of important instructions accompanying the product.

In case of malfunction due to electrostatic discharge the apparatus has to be reset by disconnecting it from mains supply.

THE MARKING INFORMATION IS LOCATED AT THE BACK OF APPARATUS.

FCC Statement:

This device complies with Part 15 of the FCC Rules. Operation is subject to the following two conditions: (1) this device may not cause harmful interference, and (2) this device must accept any interference received, including interference that may cause undesired operation.

Warning: Changes or modifications to this unit not expressly approved by the party responsible for compliance could void the user's authority to operate the equipment.

NOTE: This equipment has been tested and found to comply with the limits for a Class B digital device, pursuant to Part 15 of the FCC Rules. These limits are designed to provide reasonable protection against harmful interference in a residential installation. This equipment generates, uses and can radiate radio frequency energy and, if not installed and used in accordance with the instructions, may cause harmful interference to radio communications.

However, there is no guarantee that interference will not occur in a particular installation. If this equipment does cause harmful interference to radio or television reception, which can be determined by turning the equipment off and on, the user is encouraged to try to correct the interference by one or more of the following measures:

- ☐ Reorient or relocate the receiving antenna.
- ☐ Increase the separation between the equipment and receiver.
- ☐ Connect the equipment into an outlet on a circuit different from that to which the receiver is connected.
- ☐ Consult the dealer or an experienced radio/TV technician for help.

LOCATION OF CONTROLS

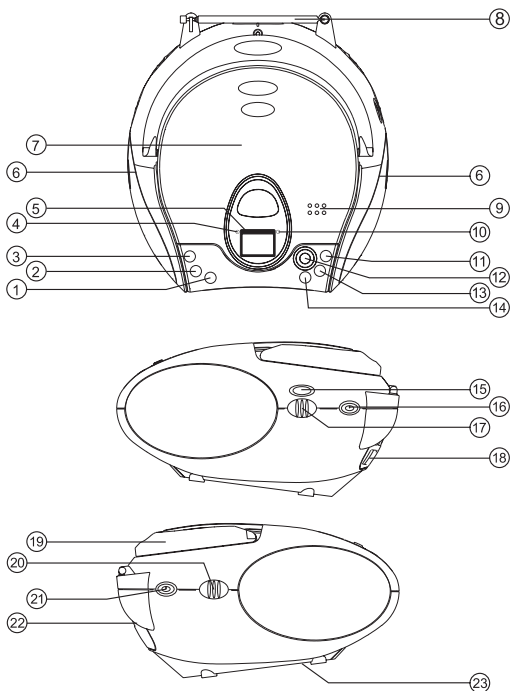

- | | |
|--|-------------------------|
| 1. CD PROGRAM / CLOCK-ADJ. /
CD PLAY MODE BUTTON | 13. CD BACK BUTTON ◀◀ |
| 2. CD FOLDER UP BUTTON | 14. CD STOP BUTTON ■ |
| 3. POWER BUTTON ⏻ | 15. DIAL SCALE |
| 4. BLUETOOTH INDICATOR  | 16. BAND SWITCH |
| 5. CD DISPLAY | 17. TUNING CONTROL |
| 6. SPEAKER | 18. AC SOCKET |
| 7. CD DOOR | 19. CARRYING HANDLE |
| 8. TELESCOPIC ANTENNA | 20. VOLUME CONTROL |
| 9. OPEN / CLOSE CD BUTTON | 21. FUNCTION SWITCH |
| 10. FM STEREO INDICATOR | 22. PHONES JACK |
| 11. CD NEXT BUTTON ▶▶ | 23. BATTERY COMPARTMENT |
| 12. CD PLAY / PAUSE BUTTON ▶▶ | |

POWER SUPPLY

USING HOUSE CURRENT

Before use, check that the rated voltage of your unit matches your local voltage.

Note: Plug is used as the disconnect device.

The disconnect device shall remain readily operable.

To AC socket

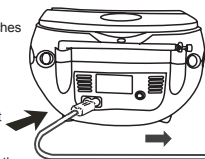

To AC outlet

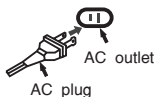

USING BATTERIES

Disconnect the AC power cord from the AC inlet of the unit. Battery power is cut automatically by the cord while it is connected.

When the volume decrease, or the sound distorts, replace all of the batteries with new ones.

battery door

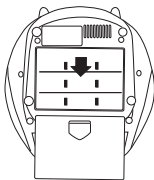

Insert 6 UM-2
(size C) batteries.

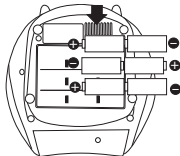

TURN ON / OFF THE SYSTEM

Press the  POWER button to turn the audio on.

To change the audio mode between CD, RADIO AND BLUETOOTH ,set the FUNCTION switch while the power is on. The audio mode is displayed.

Turn off the unit by pressing the POWER button. The current time is shown on the display.

POWER

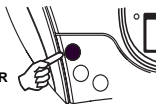

ADJUSTING THE SOUND

TO ADJUST THE VOLUME

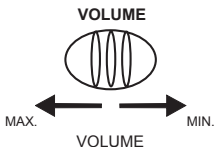

FOR PRIVATE LISTENING

Plug in headphones (ø3.5 mm stereo mini-plug) to the PHONES jack.

When headphones are plugged in, the speakers are automatically disconnected.

CLOCK ADJUSTMENT

The clock is displayed on LCD display at standby mode.

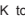
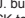
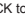
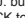
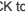
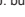
1. Press the PROGRAM / CLOCK-ADJ. button,
2. Press the  NEXT or  BACK to select 12 hours or 24 hours display.
3. Press the PROGRAM / CLOCK-ADJ. button, the hour digit flash.
4. Press the  NEXT or  BACK to adjust hour digit.
5. Press the PROGRAM / CLOCK-ADJ. button, the minute digit flash.
6. Press the  NEXT or  BACK to adjust minute digit.
7. Press the PROGRAM / CLOCK-ADJ. button again, the correct time is shown on display.



LCD display

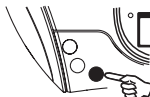

CLOCK-ADJ.

LISTENING TO THE RADIO

1. Turn on the unit by pressing the  POWER button.

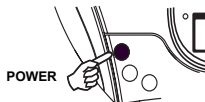

2. Set to RADIO

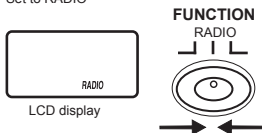

3. Select a band.



FOR BETTER RECEPTION

FM



AM



- NOTE :**
1. FM stereo LED indicator lights if receive FM stereo broadcast and the BAND switch set on "FM STEREO".
 2. When too much noise is heard during FM STEREO reception, set BAND switch to FM mono.

AFTER LISTENING

Turn off the unit by pressing the  POWER button.

4. Tune in to a station.

TUNING



5. Adjust the sound.

VOLUME

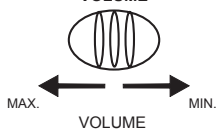

COMPACT DISC PLAYBACK

1. Turn on the unit by pressing the  POWER button.

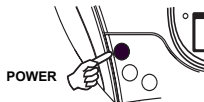

2. Set to CD

FUNCTION

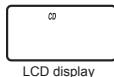

3. Open the CD door by pushing
CD Door Open / Close button.

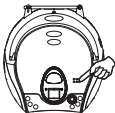

4. Insert a disc with the label side
facing up.



5. Close the CD door.
The disc will rotate and the total
tracks of the disc will show on

6. Press the PLAY/PAUSE **▶▶** button.
Track number "01" & the symbol "▶" & "CD"
will be shown during normal compact disc playback.
Track number "001", the symbol "▶" & "MP3"
will be shown during MP3 playback.
Track number "001", the symbol "▶" & "WMA"
will be shown during WMA playback.



CD display



MP3 display



WMA display

TO INTERRUPT PLAYBACK

Press the Play/Pause **▶▶** button and the symbol "▶" will
be flashed. Press the button again to resume playback.

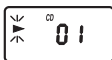

CD display



MP3 display



WMA display

TO STOP PLAYBACK

Press the STOP **■** button and
the display shows the
total tracks of the disc.

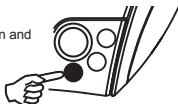

TO SKIP TO THE BEGINNING OF A TRACK

- Press either one of the **◀◀** or **▶▶** skip buttons according to the desired skip direction.
- Play/back resumes from the selected track.
- When the **◀◀** button is pressed once during play, the previous track starts again.
- When the **▶▶** button is pressed once during play, the next track plays.

SEARCHING FOR A PASSAGE WITHIN A TRACK

- Keep the **◀◀** or **▶▶** button pressed during playback,
and release the button as soon as you recognise the desired
passage. Then normal CD playback will resume from this point.



Unit will be automatically off after 30mins without further operation (in stop mode / CD door open).

REPEAT , REPEAT FOLDER , REPEAT ALL AND MIX PLAYBACK

Press PLAY MODE button during CD playback. CD plays with a single track repeat,
all tracks repeat or randomly.

FOR NORMAL COMPACT DISC PLAYBACK

Mode sequence REPEAT >> REPEAT ALL >> MIX >>
CLEAR.

During Repeat 1 mode,
display shows



During Repeat 2 mode,
display shows



CD display

During Mix mode,
display shows

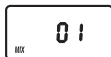

CD display

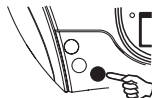

PLAY MODE

FOR MP3 / WMA PLAYBACK

Mode sequence REPEAT >> REPEAT FOLDER >> REPEAT ALL >> MIX >> CLEAR.

During Repeat 1 mode,
display shows



During Repeat 3 mode,
display shows



During Repeat 2 mode,
display shows



MP3 / WMA display

During Mix mode,
display shows

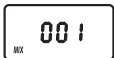

MP3 / WMA display

Note on CD-R/RW discs

- Because of non-standardized format definition/ production of CD-R/RW, playback quality and performance are not guaranteed.
- Manufacturer is not responsible for the playability of CD-R/RW due to recording conditions, such as PC performance, writing software, media ability, etc.
- Do not attach a seal or label to either side of the CD-R/RW disc. It may cause a malfunction.
- It is recommended to record only audio files on CD-R/RW discs for easy reading.

FOLDER UP

For MP3/WMA playback, when the unit is at STOP mode, skip up to next folder/album at increasing order & it will show the folder/album number; press PLAY/PAUSE button to start the playback of the selected folder/album. When the unit is at MP3/WMA PLAYBACK mode, skip up to next folder/album at increasing order & the folder/album number will flash for 3 seconds; then it will start playback of the selected folder/album.

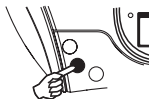

PROGRAMMED PLAYBACK

PROGRAMMED PLAYBACK

FOR NORMAL COMPACT DISC PLAYBACK

Programmed playback enables tracks on a disc to be played in the desired order. Up to 20 tracks can be programmed.

1. Press the "PROGRAM" button.
2. Press the "NEXT" and "BACK" buttons to select the desired track number.
3. Press the "PROGRAM" button again to memorize the track.
4. Repeat steps 2 and 3 until all desired tracks are programmed.
5. Press the "PLAY/PAUSE" button to start.
"▶", "PROG" & track number are shown on the CD display.
6. Press the "STOP" button once to stop programmed playback.
7. Press the "PLAY/PAUSE" button to resume programmed playback.
8. Open the CD door, turn off the CD player or press the "STOP" button twice to clear the programmed memory.

Note : Programming can only be made when the player is in stop mode.



PROGRAM



CD display
"PROGRAM"

FOR MP3 / WMA PLAYBACK

Programmed playback enables folders/albums or tracks on a disc to be played in the desired order. Up to 20 folders/albums or tracks can be programmed.

1. Press the "PROGRAM" button.
2. For "Folder programming", press the "FOLDER UP" buttons to select the desired folder number.
3. For "Track programming", press the "NEXT" and "BACK" buttons to select the desired track number. Then, press "PROGRAM" button again to memorize the selected track.
4. Repeat steps 2 and 3 until all desired folders or tracks are programmed.
5. Press the "PLAY/PAUSE" button to start.
"▶", "PROG" and "MP3 / WMA" & track number are shown on the CD display.
6. Press the "STOP" button once to stop programmed playback.
7. Press the "PLAY/PAUSE" button to resume programmed playback.
8. Open the CD door, turn off the CD player or press the "STOP" button twice to clear the programmed memory.

Note : Programming can only be made when the player is in stop mode.



PROGRAM



MP3 / WMA display
"PROGRAM"

BLUETOOTH OPERATION

1. Press the POWER  button.

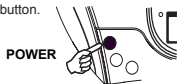

2. Set to  BLUETOOTH, the "BT" is shown on the display.



LCD display



- Next time you switch on the unit, the speaker connects to the last paired device automatically.
- The music streaming may be interrupted by obstacles between the device and the unit, such as walls, or other devices nearby that operate in the same frequency.

Unit will be automatically off after **4.5 hours** without further operation .

3. On your Bluetooth device, activate Bluetooth and search for F-6188. The bluetooth LED indicator flashes during pairing.

"BLUETOOTH"



4. Connected : Bluetooth LED indicator is always light on.
5. After successful connection, start music play on the Bluetooth device.

MAINTENANCE

CLEANING CD

If the CD skips or will not play, the disc may need cleaning. Before playing, wipe the disc from the centre out with a cleaning cloth. After playing, store the disc in its case.



CLEANING THE CD LENS

If the CD lens is dusty, clean it with a brush-blower. Blow several times on the lens and remove the dust with the brush. Finger prints may be removed with a cotton swab moistened with alcohol.

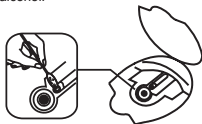

CLEANING THE UNIT

Do not use volatile chemicals on this unit. Clean by lightly wiping with a soft cloth.

IMPORTANT NOTE

If an abnormal display indication or an operating problem occurs, disconnect the AC power cord and remove the batteries. Wait at least 5 seconds, then reconnect the AC power cord or reinstall the batteries.

WARNING

Should the CD door be opened before the reading of the CD is completed, a jamming noise may occur. This is resolved by closing the CD door.

SPECIFICATIONS

CD SECTION

Channels:	2 channels
S / N ratio:	60 dB
Wow & Flutter:	undetectable
Sampling frequency:	44.1 kHz 8 x over sampling
Quantization:	1 bit DA converter
Pick up light source:	Semi - conductor laser
Pick up wave length	790 nm

BLUETOOTH SECTION

Bluetooth standard	Bluetooth Standard Version 2.1 + EDR
Range :	10 m (free space)

RADIO SECTION

Tuning ranges:	FM 87.5 - 108 MHz AM 530 - 1710 kHz
Antennas:	AM Built - in ferrite bar FM Rod antenna

GENERAL

Output power:	1 W + 1 W (RMS)
Power consumption:	12 W
Speaker:	3 " 8 OHM
Phones jack:	3.5 MM
Power source:	AC : 120V ~ 60Hz DC : 9V (6 x 1.5V LR14/ "C"/UM2)
Dimensions:	224(L) x 234(D) x 128(H)mm
Weight	1.42 KGS

Due to continuing improvement, the features and the design are subject to change without notice.

Where to place the item :

Today's furniture is coated with a wide variety of lacquers and synthetic-coatings that are treated with an extensive range of cleaning products. Therefore, the possibility that some of these substances contain components that react adversely to the rubber feet of the item and soften them, cannot be completely excluded. The rubber feet of the appliance can cause discoloring to furniture surfaces. If necessary, place the appliance on a non-slide surface.