

## 2 in 1 Carplay adapter box

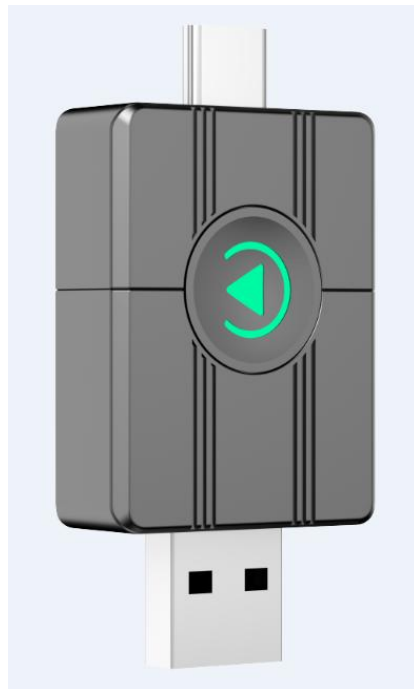

## 1. Product Overview

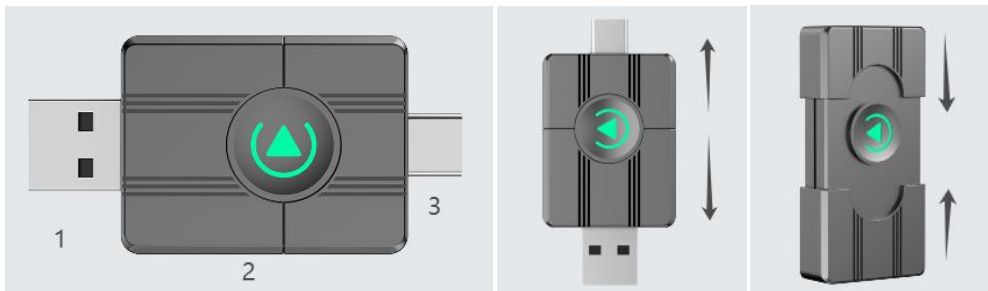

CB04 car interconnection smart box is mainly used to realize the interconnection between mobile phones and cars . The conversion function integrates mobile phone and car entertainment and navigation , providing users with rich driving pleasure; reducing the frequency of using mobile phones, providing users with a safer driving experience.



1. USB A port 2. light 3. USB-C port

## 2. Product composition list

### Product accessories list

name	Graphic	illustrate	quant
Smart Box		Used to achieve interconnection between mobile phones and cars	1
USB-A connector		Used for connecting smart box and car	1
USB-A connector		Used for connecting smart box and car	1

### 3. Product Instructions

#### A. Installation diagram

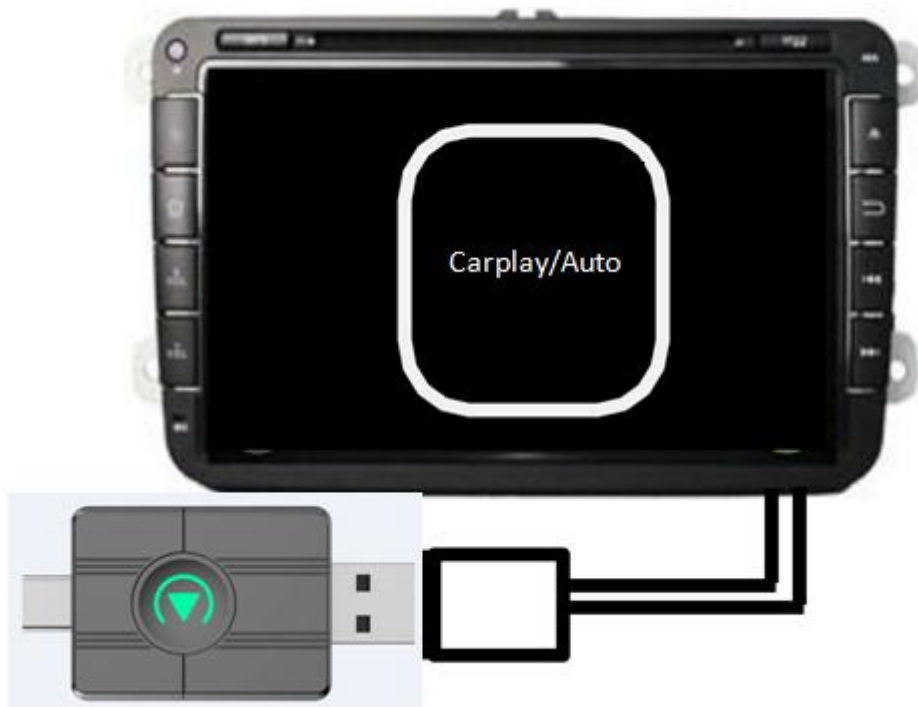

Connect the smart box to the original car's USB data interface as shown in the figure.

**Note:** You can use a USB adapter to transfer

#### B. Apple CarPlay

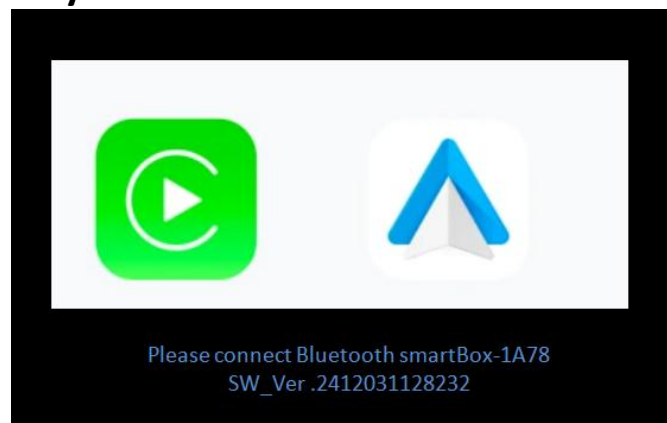

Click "Smartlink " to enter the "carplay/Auto" connection interface , read the box data and wait, the Bluetooth name is displayed as: smartBox-XXXX

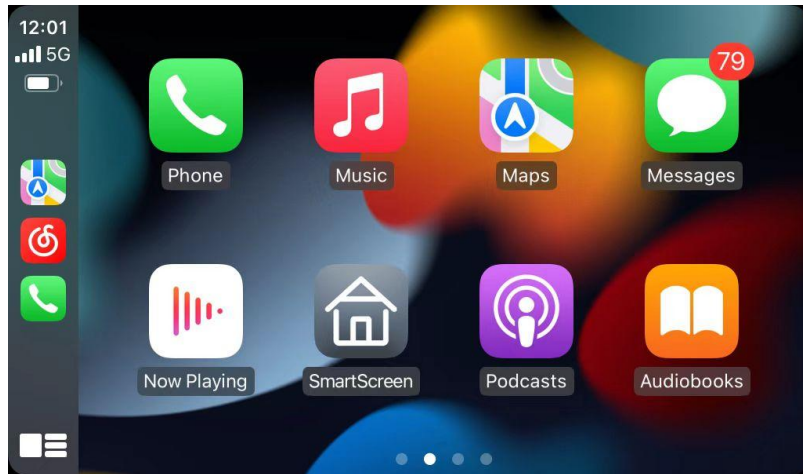

Open iPhone Bluetooth, search for the Bluetooth **device name** : " smartBox- XXXX" **Click to connect** and allow synchronization, and finally click "Use Allow" . **After connecting, please wait for a while, and CarPlay will display the screen as shown above**

(The Apple CarPlay option only supports Apple phones. Please turn off the Bluetooth button first, then turn off the WiFi button in the phone settings to disconnect).

### C.AndroidAuto

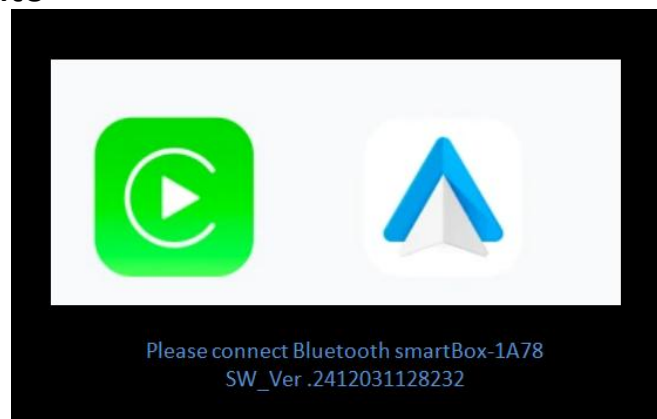

Click "Smartlink " to enter the "carplay/Auto" connection interface , read the box data and wait, Bluetooth is displayed, the name is: smartBox-XXXX

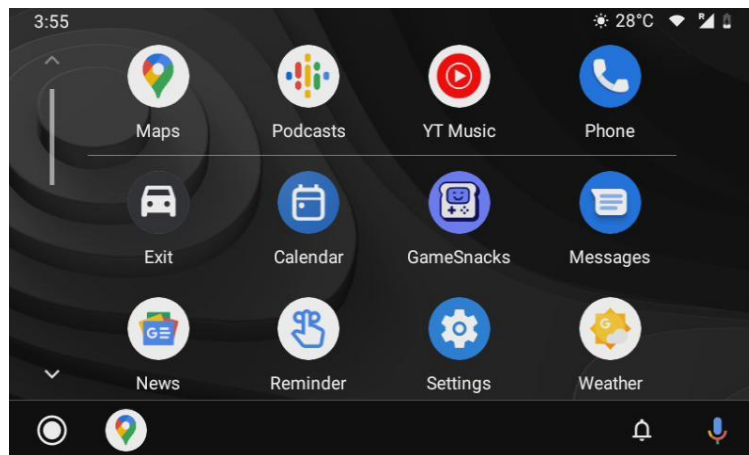

Open the **Bluetooth** of your **Android phone** , search for the Bluetooth device name : " smartBox- XXXX" and **click Connect** . **After connecting, please wait for a moment. The Auto display screen is as shown above.**

(Wireless Android Auto option only supports Android phones. Please forget Bluetooth in phone settings and turn off the WiFi button to disconnect).

**Note: The original car must have Carplay and Auto applications**

#### **4. Software Online Upgrade Instructions**

##### **iPhone**

Need to move the smart box to the USB power adapter; Join the Wifi device named " smartBox\_xxxx" Enter the password on the iPhone : 88888888 ; Enter the IP 192.168.1.101 in the Safari browser and press ' Click to Upgrade ' ; Wait a few minutes to upgrade. "Note: After the upgrade is successful. Please forget to use the ' smartBox xxxx' network"

19:37

4G

System Version

Build Number 22011515.1334.1

Choose Headunit

Unit Type Default (For Most CarPlay Units) >

Problem Description

Car Make E.g. Toyota

Model Name E.g. Camry XLE

Year E.g. 2020

Detailed description of the problem:

Please enter text here

Submit

Online Update

Your software is up to date

Copyright©2020 - 2021

192.168.1.101

19:38

4G

System Version

Build Number 22011515.1334.1

Choose Headunit

Unit Type Default (For Most CarPlay Units) >

Problem Description

Car Make E.g. Toyota

Model Name E.g. Camry XLE

Year E.g. 2020

Detailed description of the problem:

Please enter text here

OK

Default (For Most CarPlay Units)

Ford SYNC 2.0 Specific

192.168.1.101



## Android Phone

Need to move the smart box to the USB power adapter; Join the Wifi device named " smartBox\_xxxx" Enter the password on Android: 88888888 ; Enter the IP 192.168.1.101 in the browser and press ' Click to upgrade ' ; Wait a few minutes to upgrade. "Note: After the upgrade is successful. Please forget to use the ' smartBox xxxx' network"

7:37

Problem Description

Car Make E.g. Toyota

Model Name E.g. Camry XLE

Year E.g. 2020

Detailed description of the problem:

Please enter text here

Submit

Online Update

13%

Your software is up to date

Update

Update Notes

【测试版本】

1. 测试OTA

7:37

Problem Description

Car Make E.g. Toyota

Model Name E.g. Camry XLE

Year E.g. 2020

Detailed description of the problem:

Please enter text here

Submit

Online Update

13%

Your software is up to date

Update

Update Notes

【测试版本】

1. 测试OTA



How do I upload log data for my motor department when **the Smart Box is not working?**

Please enter the IP address on the page, fill out the Car Information Problem Description worksheet, and press "Submit"

to upload your log data.

Problem Description

Car Make

E.g. Toyota

Model Name

E.g. Camry XLE

Year

E.g. 2020

Detailed description of the problem:

Please enter text here

Submit

**Note:** When upgrading the software and submitting logs, the smart box needs to be connected to the vehicle's USB power supply.

---

### Frequently asked questions

---

Serial number	question	Solution
1	Carplay Unable to connect	<div><div>①</div>The first connection takes longer.</div> <div><div>②</div>Only iPhone supports Carplay .</div> <div><div>③</div> Check whether the WiFi and Bluetooth functions of the mobile phone are normal.</div> <div><div>④</div> Enter the phone settings General Carp lay, Delete all records and reconnect.</div> <div><div>⑤</div>Restart your iPhone and</div>

2	Auto Unable to connect	<p>① Only supports Android phones.</p> <p>② Upgrade the Auto-related programs on your mobile phone to the latest version .</p> <p>③ The VPN function cannot be enabled when casting the screen.</p>
---	------------------------------	---

---

## Product Specifications

---

model	CB04
Master	high performance soc
Wireless	Apple Carplay, Android Auto.
Wireless	Wifi , Bluetooth
Operating	Input: 5V1A
size	mm
weight	About 40g
Material	ABS/PC



This device complies with part 15 of the FCC Rules. Operation is subject to the following two conditions: (1) this device may not cause harmful interference, and (2) this device must accept any interference received, including interference that may cause undesired operation.

Any changes or modifications not expressly approved by the party responsible for compliance could void the user's authority to operate the equipment.

NOTE: This equipment has been tested and found to comply with the limits for a Class B digital device, pursuant to Part 15 of the FCC Rules. These limits are designed to provide reasonable protection against harmful interference in a residential installation. This equipment generates, uses and can radiate radio frequency energy and, if not installed and used in accordance with the instructions, may cause harmful interference to radio communications. However, there is no guarantee that interference will not occur in a particular installation.

If this equipment does cause harmful interference to radio or television reception, which can be determined by turning the equipment off and on, the user is encouraged to try to correct the interference by one or more of the following measures:

- Reorient or relocate the receiving antenna.
- Increase the separation between the equipment and receiver.
- Connect the equipment into an outlet on a circuit different from that to which the receiver is connected.
- Consult the dealer or an experienced radio/TV technician for help.

The device has been evaluated to meet general RF exposure requirement. The device can be used in portable exposure condition without restriction