

⚠ The illustrations may vary from the actual products.
⚠ Please read the instruction manual carefully and keep it in a proper way.

Gold Rosita
NO.1682

TURBO SPINNER

2.4GHz RC Mini Stunt Car Instruction Manual

⚠ ATTENTION: Please read these instructions carefully before playing the car

- This toy contains small parts. Do not put them in mouth as it may result in choking hazard.
- This toy is not suitable for children under 6 years old.
- The toy has sharp parts. Please pay attention during operation.
- Keep your face away from the car & never touch it with your hand when it is spinning at high speed to avoid being hurt.
- Do not stay close to the car when it is rotating at high speed.

BATTERY WARNINGS: to avoid over-heating, damage or leaking to the battery, please pay attention to the following:

1. RECHARGEABLE BATTERY IN THE CAR BODY:

- Short circuit is definitely to be avoided.
- Recharge it when the car body completely stops. Do not overcharge the battery.
- Do not use it immediately after it becomes wet, to prevent short circuit.
- Never soak in water, throw away in fire, dismantle or weld the rechargeable battery.
- Keep it away from fire and heat. Store in place with low humidity and low temperature.
- Recharge the battery from any computer via the given USB cable is highly recommended.

2. BATTERIES IN THE REMOTE CONTROLLER:

- Do not use rechargeable battery like nickel-cadmium battery or nickel dry battery.
- New and used batteries are not to be mixed.
- Batteries are to be inserted with the correct polarity.
- Dispose of batteries safely.
- Remove batteries from product before extended storage.
- If liquid leaking from battery gets into your eyes, do not rub your eyes. Wash them well with clean water and go to see a doctor immediately.
- Pay attention that your finger, hair, clothes or clothing accessories will not get clogged in the spinning wheels.
- To avoid accidents, please keep the car out of the reach of children under 6 years old.

Ⓢ CONTENT OF THE PACKAGING:

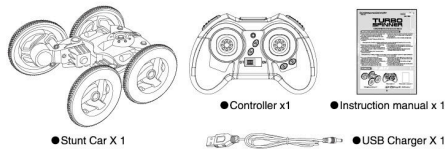

1

Ⓢ PART LIST:

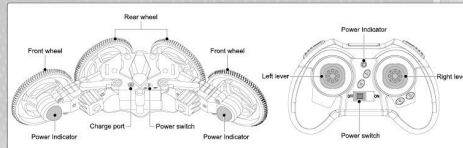

Ⓢ Batteries Installation:

Use a screwdriver to loosen the screw on the battery cover in counter clockwise direction. Insert 3x1.5V "AAA" batteries with the correct polarity, replace the battery cover and tighten the screw.

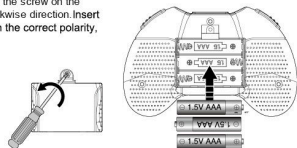

Ⓢ BATTERY CHARGING:

Turn "OFF" the power of the stunt car before charging. Then plug the USB cable to the slot located on the side of the stunt car, and connect the other side to a computer device. USB light will be ON during charging & USB light will be OFF when charging is completed. The charging time is ~ 20 minutes. Play time per fully charged battery is about 7 ~ 10 minutes.

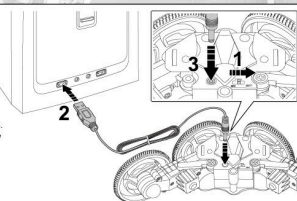

2

Ⓢ Operation:

First of all, place the stunt car on flat ground. Slide the power switch to "ON" position and the power indicator light will flash rapidly. With the remote controller facing the car, slide the power switch to "ON" position. Throttle up and down quickly. The power indicator light will stay on and you can start to play now. (Working distance is 10 ~ 20 meters and will be out of range beyond this distance)

NOTE: stunt performance is best on solid, flat ground. Low pile carpet will affect stunt action & filaments might be caught which will clog the wheels.

1. Forward: Push up the left and right control levers at the same time and the car will move forward; pull down control levers at the same time and the car will flip over.

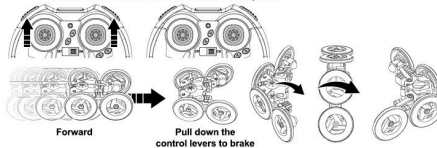

2. Backward: Pull the left and right control levers at the same time and car will move backward; push up the control levers at the same time and the car will flip over.

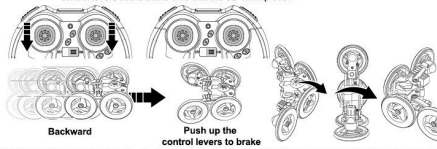

3. Vertical rotation in clockwise direction: Push up the left control lever and pull down the right lever at the same time. The car will rotate fast vertically in clockwise direction.

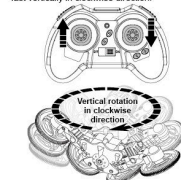

3

4. Vertical rotation in counter clockwise direction: Pull down the left control lever and push up the right control lever at the same time. The car will rotate fast vertically in counter clockwise direction.

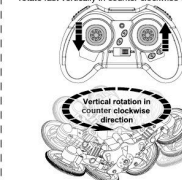

Ⓢ Troubleshooting:

Issues	Causes	Solutions
Unable to run	Loss of transmission - remote control is not directed to the car.	Make sure the remote control is directed to the car.
	Car or controller batteries lack of power.	Transmission signal will be weak when battery power is low. Charge the car and replace new batteries to the controller.
	The distance is outside of the control area or deviate from solid angle.	Take the controller close to the car, the effective distance is about 10-20 meters.
	A barrier existing between the car body and the controller.	Remove obstructions between the car and the remote control.
Unsuccessful operation	Electrostatic induction resulting in false operation.	Wait for a few minutes, or try it in another place.
	Foreign matter on tire or shaft.	Remove the foreign matter.
	Running on a carpet or rough places.	Run it on a smooth, clean and firm surface.
	Discontinuous running after the battery is consumed.	Charge the car first. If it fails, replace the controller battery.



WARNING:

CHOKING HAZARD—Small parts. Not for children under 6 years old.

WARNINGS:

FCC ID: 2AEJP-SYN-2018-MSC

This device complies with part 15 of the FCC rules. Operation is subject to the following two conditions:
1. This device may not cause harmful interference, and
2. This device must accept any interference received, including interference that may cause undesired operation.

Note: This equipment has been tested and found to comply with the limits for a Class B digital device, pursuant to Part 15 of the FCC Rules. These limits are designed to provide reasonable protection against harmful interference in a residential installation. This equipment generates, uses and can radiate radio frequency energy and, if not installed and used in accordance with the instructions, may cause harmful interference to radio communications. However, there is no guarantee that interference will not occur in a particular installation. If this equipment does cause harmful interference to radio or television reception, which can be determined by turning the equipment off and on, the user is encouraged to try to correct the interference by one or more of the following measures:

- Reorient or relocate the receiving antenna
- Increase the separation between the equipment and receiver
- Connect the equipment into an outlet on a circuit different from that to which the receiver is needed
- Consult the dealer or an experienced radio / TV technician for help

Warning: Changes or modifications to this unit not expressly approved by the party responsible for compliance could void the user's authority to operate the equipment.

MADE IN CHINA

4