

CERAMICS

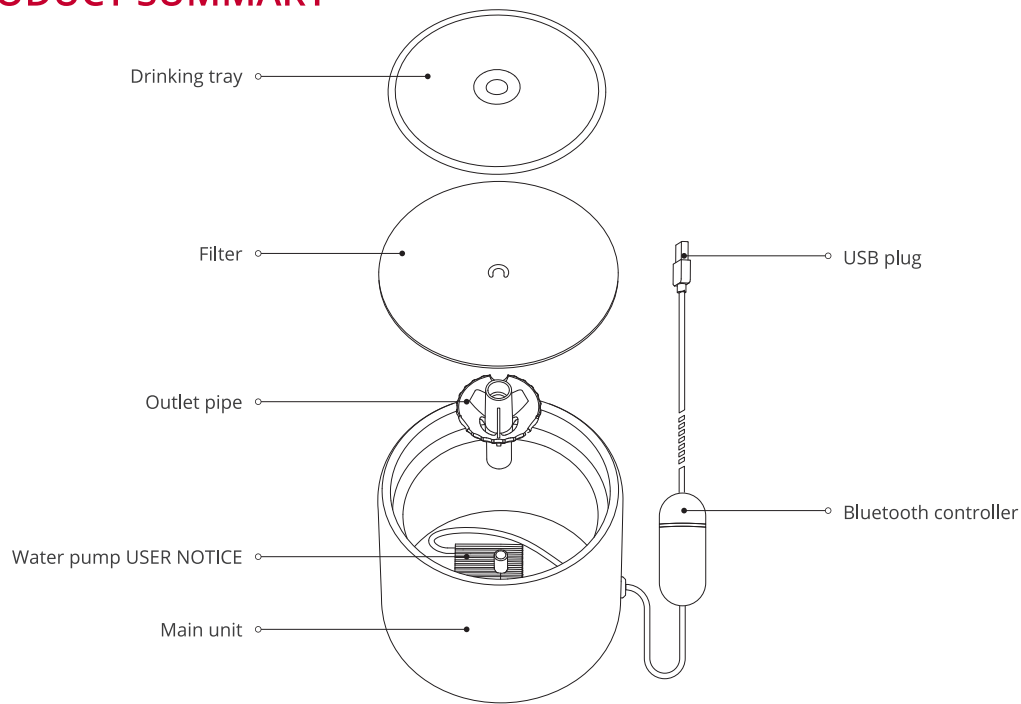

| PRODUCT SUMMARY



*Note: We will make product improvements on a regular basis in order to provide better products. The actual product may differ from the image on the package.

| USING THE APP



Scan QR code to download PETKIT App

Download the PETKIT App and complete your registration via the App. Go to the App's main page and follow the instructions to add the Petkit EVERSWEET 5 MINI and connect your device.

| INSTALLATION AND USE



Scan to watch an instructional video on how to install and use the device

| MAINTENANCE AND CLEANING



Scan to watch an instructional video on how to clean this device

| INDICATOR LIGHT DESCRIPTION

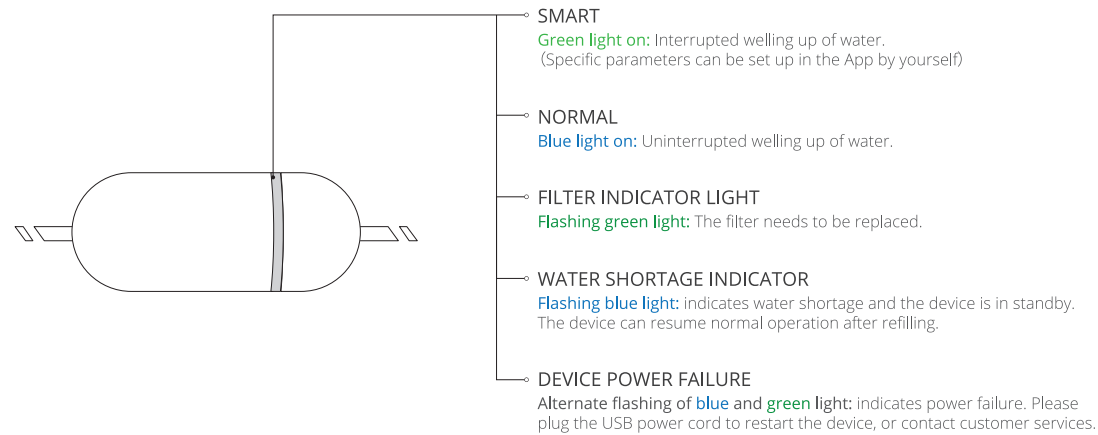

| USER NOTICE

- Thank you for purchasing the PETKIT EVERSWEET 5 MINI. Petkit works hard to improve the lives of pet owners and pets alike through the use of technology.
- Before using, please carefully read the User Manual. By setting up or using the device, you agree that you have already read and accepted the safety guidelines listed below.
- Our company is not responsible, nor does it accept any legal responsibility, for any accidents or losses caused by improper use of this device.
- Our company reserves the right to interpret and modify this notice.

| USER SAFETY GUIDE

***Failure to follow the safety guide outlined below may result in device malfunction or other unexpected accidents.**

- Only set up and use the device as instructed in the User's Manual.
- This device is not recommended for pets younger than 3 months.
- Please only use this device indoors.
- his device only uses a small amount of power. However, it may still leak power if pets chew on the wire. Please guide your pets to use it correctly.

| USER SAFETY GUIDE

01V1.1

- Please make sure the device is placed on a level surface. Do not overturn the device, otherwise it may not function properly or spill water.
- The ceramic main unit is fragile, please handle with care, do not press or fall.
- If the device is not used for a long period of time or is moved, please unplug the power cord.
- Children should only be allowed to operate this device under the supervision of an adult.
- In order to avoid unnecessary damage or injury, only repair technicians should be allowed to repair this device.
- Please check the remaining water in the drinking fountain before taking your vacation.
- In case of product use problems, please contact customer service in time.

This device complies with part 15 of the FCC Rules. Operation is subject to the following two conditions:
(1) This device may not cause harmful interference, and ; (2) this device must accept any interference received, including interference that may cause undesired operation.

FCC warning:

Any Changes or modifications not expressly approved by the party responsible for compliance could void the user's authority to operate the equipment.
Note: This equipment has been tested and found to comply with the limits for a Class B digital device, pursuant to part 15 of the FCC Rules. These limits are designed to provide reasonable protection against harmful interference in a residential installation. This equipment generates uses and can radiate radio frequency energy and, if not installed and used in accordance with the instructions, may cause harmful interference to radio communications. However, there is no guarantee that interference will not occur in a particular installation. If this equipment does cause harmful interference to radio or television reception, which can be determined by turning the equipment off and on, the user is encouraged to try to correct the interference by one or more of the following measures: -Reorient or relocate the receiving antenna. -Increase the separation between the equipment and receiver.

-Connect the equipment into an outlet on a circuit different from that to which the receiver is connected.
-Consult the dealer or an experienced radio/TV technician for help.

This equipment complies with FCC radiation exposure limits set forth for an uncontrolled environment. This equipment should be installed and operated with minimum distance 20cm between the radiator & your body.

IC warning

- English:
This device complies with Industry Canada licence-exempt RSS standard(s). Operation is subject to the following two conditions:
(1) This device may not cause interference, and
(2) This device must accept any interference, including interference that may cause undesired operation of the device.

- French:
Le présent appareil est conforme aux CNR d'Industrie Canada applicables aux appareils radio exempts de licence. L'exploitation est autorisée aux deux conditions suivantes:
(1) l'appareil ne doit pas produire de brouillage, et
(2) l'utilisateur de l'appareil doit accepter tout brouillage radioélectrique subi, même si le brouillage est susceptible d'en compromettre le fonctionnement.