

QUICKSTART GUIDE

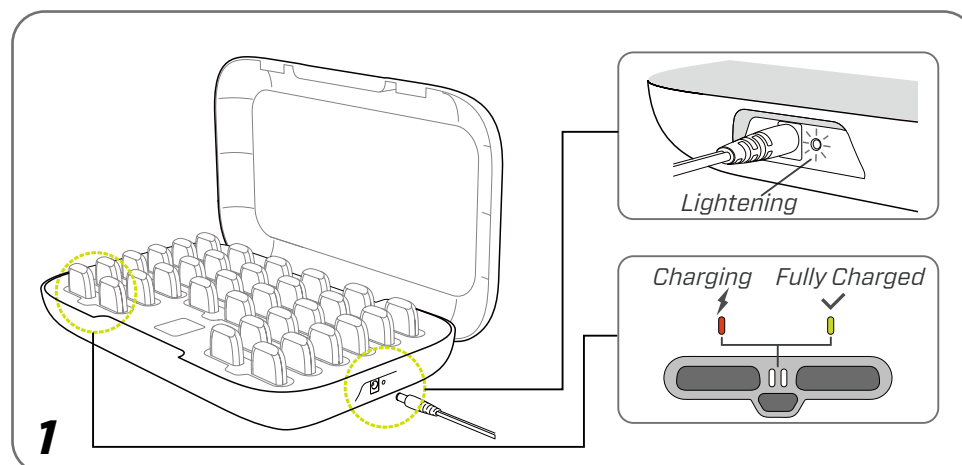

Charge your sensor fully.



Download the free app, then follow the prompts to add and check your sensors.

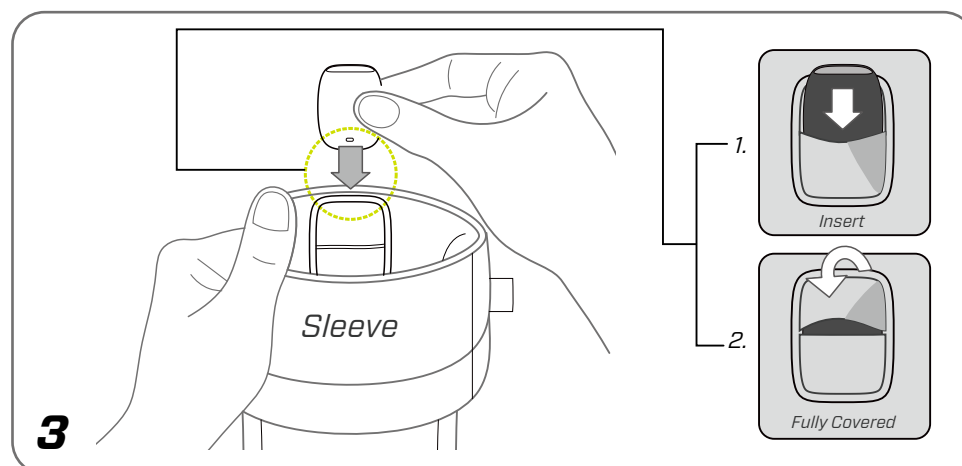

Put the sensor into the pocket on the calf sleeve.

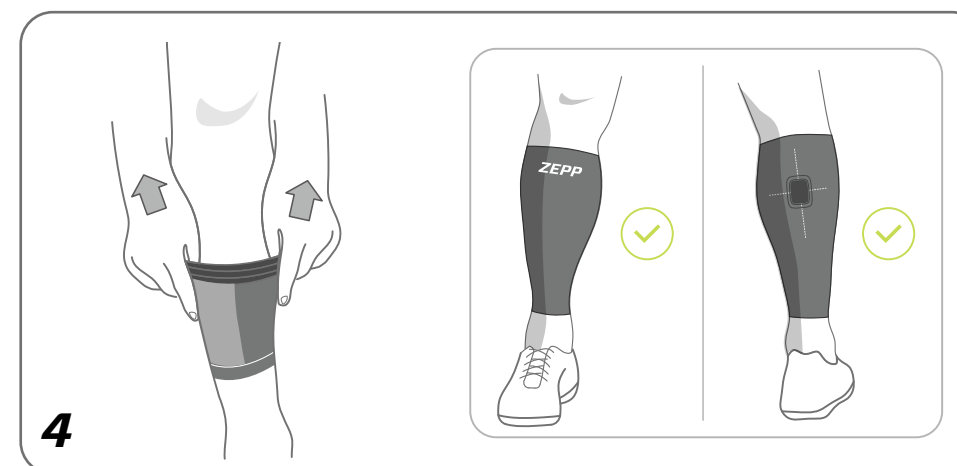

Pull calf sleeve to the appropriate height, keeping the sensor pocket on the back of your calf.

Visit Zepp.com to learn more about your Zepp Play Soccer Sensor and Zepp Products.

Charger Adaptor

