

# geminini



## TT-900WD

**Vintage Bluetooth Turntable with Built-In Stereo Speakers**

©2023 Innovative Concepts & Design, LLC. All Rights Reserved.  
Bluetooth® is a registered trademark of Bluetooth SIG Inc  
Product specifications and colors may vary from photo.

Manufactured and serviced by:  
Innovative Concepts & Design LLC  
458 Florida Grove Road  
Perth Amboy, NJ 08861 USA  
(732)587-5466

[geminisound.com](http://geminisound.com)

# INDEX

What's Included	2
Precautions	3
Features	4
Product Overview	5
Getting Started	7
Specifications	9
FCC Compliance Statement	10
Legality & Safety	11
Warranty Info	12
Manual en Español	14

## What's Included

Please ensure that you find these accessories with your TT-900WD package.

- Gemini TT-900WD Turntable
  - Power Cable
  - Felt Slipmat
- 45 RPM Adapter
- User Manual

# PRECAUTIONS

## PLEASE READ THESE INSTRUCTIONS GIVEN IN THIS MANUAL AND THOSE MARKED ON THE UNIT

This set has been designed and manufactured to assure personal safety. Improper use can result in electric shock or fire hazard. The safeguards incorporated in this unit will protect you if you observe the following procedures for installation, use and servicing. This unit is fully transistorized and does not contain any parts that can be repaired by the user.

### WARNINGS

#### *Fire and Electric Shock Hazard*

1. Do not place any open flame sources, such as lighted candles, on or near the apparatus.
2. Do not attempt to service the apparatus yourself.
3. Opening or removing covers may expose you to dangerous voltages or other hazards and will void the manufacturer's warranty.
4. To prevent risk of fire or electric shock, avoid overloading wall outlets, extension cords, or integral convenience receptacles.
5. Lightning storms Unplug this apparatus during lightning storms.
6. Object and liquid entry: Never insert objects of any kind through the openings of this apparatus, as it may touch dangerous voltage points or short-circuit parts that could result in a fire or electric shock. Care should be taken so that objects do not fall, and liquids are not spilled into the apparatus through openings in the enclosure.

# FEATURES

Bring the warmth of vinyl and the convenience of modern tech together with the Gemini TT-900WD. This all-in-one turntable system combines a vintage woodgrain design with built-in stereo speakers and Bluetooth functionality, making it the perfect centerpiece for music lovers who appreciate both style and sound.

## **Retro-Inspired Design**

Classic wood cabinet finish with a sleek modern layout, blending timeless aesthetics with today's minimalist look to complement any home setup.

## **Wireless Music Ready**

Easily stream your favorite digital tracks from any Bluetooth-enabled device directly to the built-in speakers—no cables or receiver required.

## **Spin Your Favorites**

Supports both 33 1/3 and 45 RPM vinyl records, so you can enjoy everything from full-length albums to classic singles with ease.

## **Built-In Amplifier for Passive Speakers**

Power your passive speakers directly with the turntable's built-in amplifier for fuller, more dynamic sound without extra gear.

## **Premium Sound Cartridge**

Equipped with a high-quality moving magnet cartridge for rich, balanced sound reproduction straight from the source.

Whether you're rediscovering your vinyl collection or streaming a new playlist, the Gemini TT-900WD delivers vintage vibes and modern performance in one streamlined unit.

# PRODUCT OVERVIEW

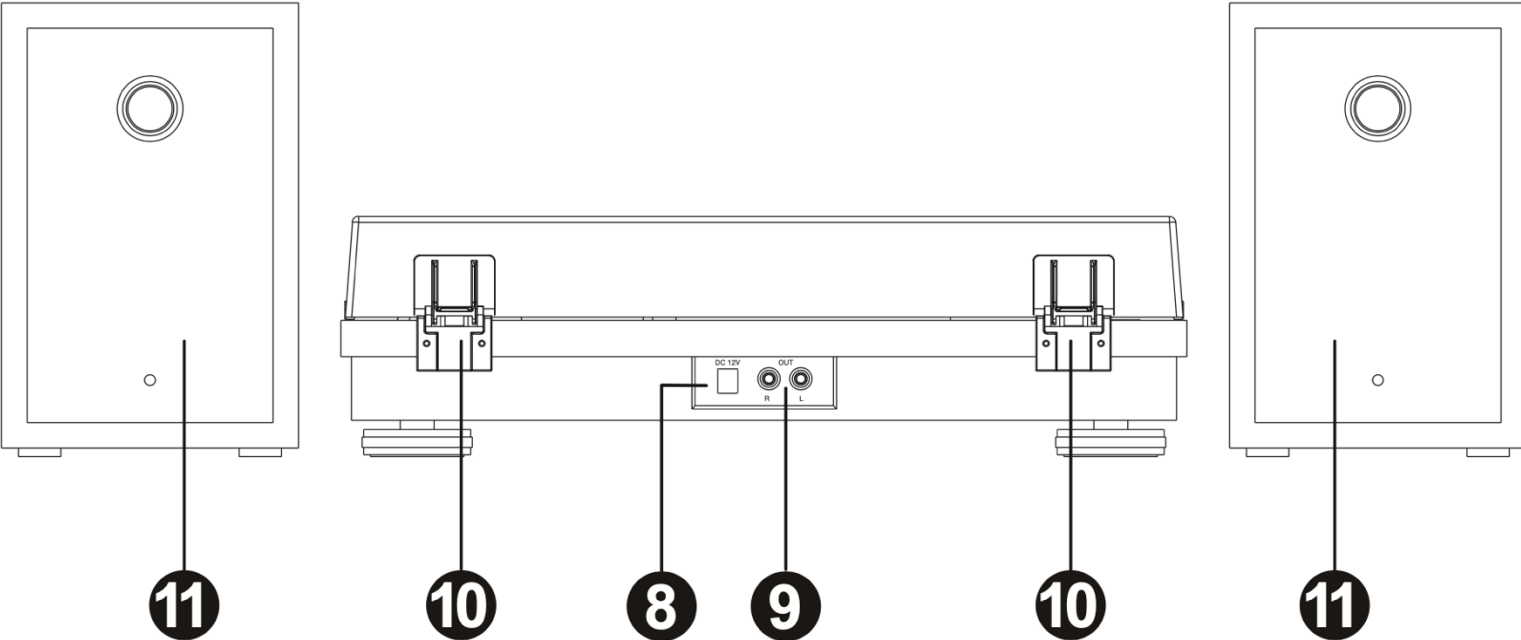
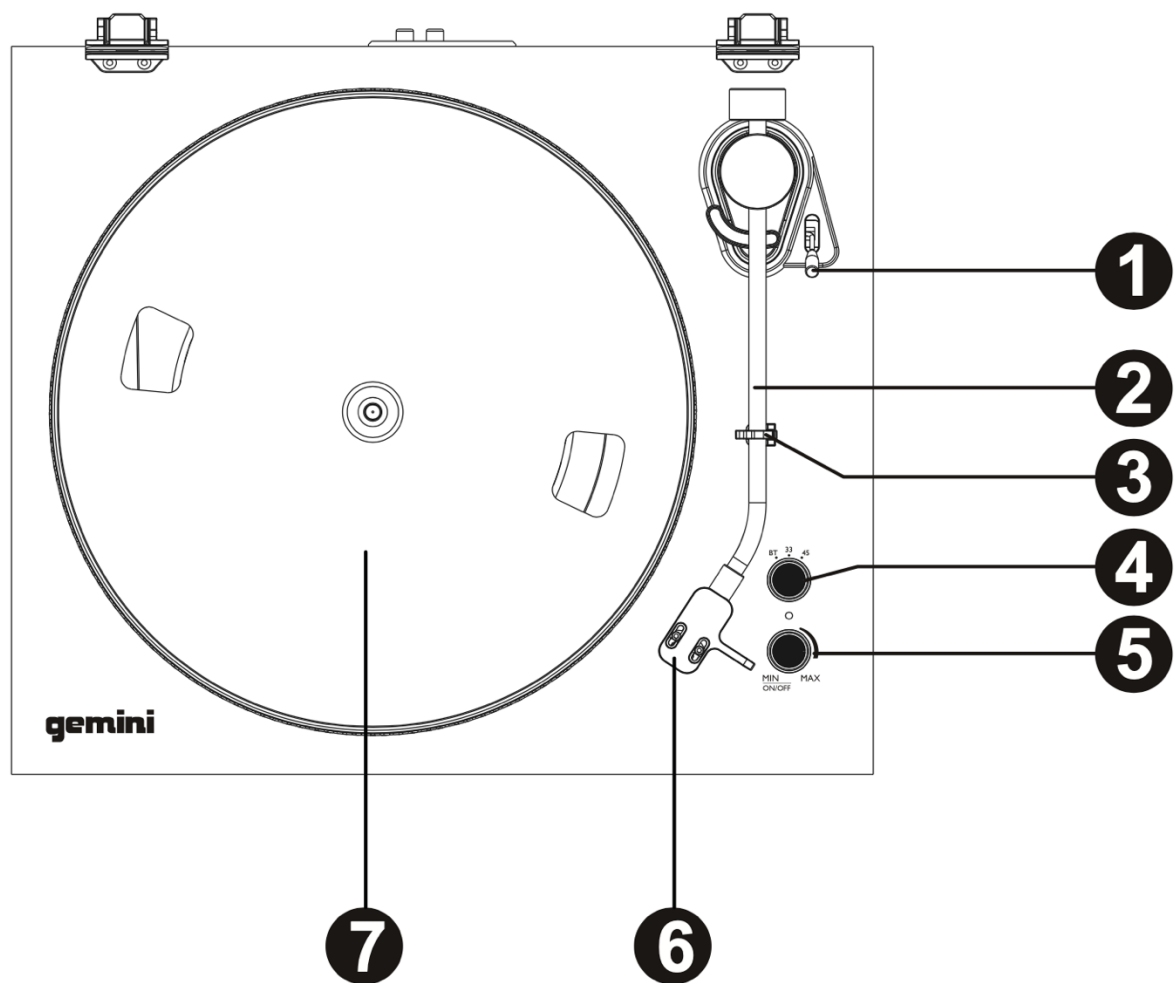

# PRODUCT OVERVIEW

1. Cueing Lever
2. Tone arm
3. Tone arm clip/rest
4. Function knob (BT & 33/45 RPM switch)
5. Power Switch (and Volume Control)
6. Headshell with cartridge  
(Remove transparent stylus protector before use)

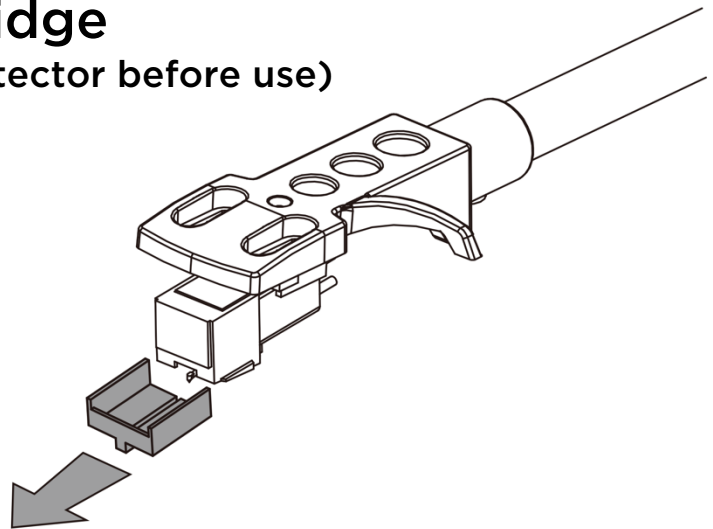

7. Platter  
(Place the felt slipmat and the place your record here)
8. DC IN port  
(Used to connect power adapter)
9. RCA output  
(Used to connect to external speakers)
10. Turntable Lid Hinges
11. External speakers

# GETTING STARTED

1. Remove the unit from the packaging and attach the dust cover by sliding its sockets onto the rear hinges (they may fit tightly).
2. Connect the main unit to the speakers using the RCA cable.
3. Plug the DC adapter into the DC IN jack on the back, then connect the adapter to a power outlet.

## PHONO MODE (VINYL RECORD PLAYBACK)

1. Turn on the power knob. Place a record on the platter and select 33 or 45 RPM based on the record. Red indicator light will turn on.

*Some 45RPM records will need the included center-hole adapter.*

2. Remove the stylus protector and unlock the tone arm clip. Push the lift lever back to raise the tone arm, then move it over the desired spot on the record. The platter will start spinning. Push the lever forward to lower the tone arm and begin playback.

3. To stop playback, push the lift lever back to raise the tone arm, then return it to its resting position. Push the lever forward to lower it, then secure the tone arm with the clip.

### ***Please Note:***

*Never lift the cartridge by hand during playback, as this can damage the record or stylus—always use the cueing lever.*

# BLUETOOTH MODE

1. Set the function knob to BT; the blue indicator will flash.
2. Enable Bluetooth on your device and pair with "Gemini TT-900WD" The light will stop flashing once connected, and you can stream audio through the turntable.
3. Use the volume knob or your device's volume controls to adjust the sound.

# REPLACING THE STYLUS

It is recommended to replace the stylus after 1,000 hours of playing time or if it is damaged.

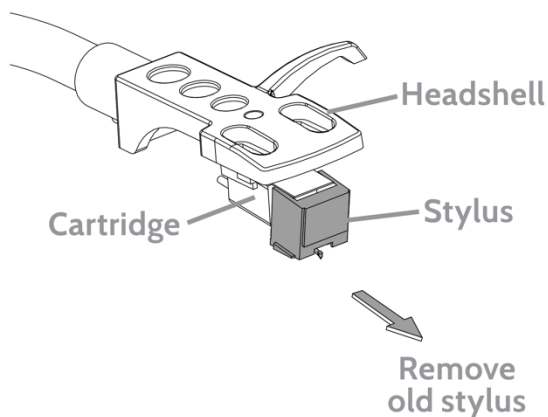

- Turn off the turntable and unplug it.

- To remove the old stylus, hold the headshell and cartridge firmly, then pull the stylus forward to remove.

To install a new stylus, slide it onto the cartridge until it clicks into place.

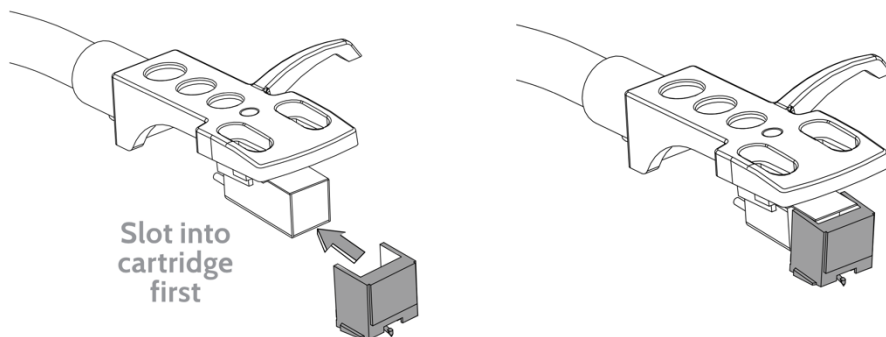



## STYLUS CARE

Clean the stylus regularly to remove dust and fluff. Use a proper stylus brush or cleaner (not included), brushing from back to front along the tip.

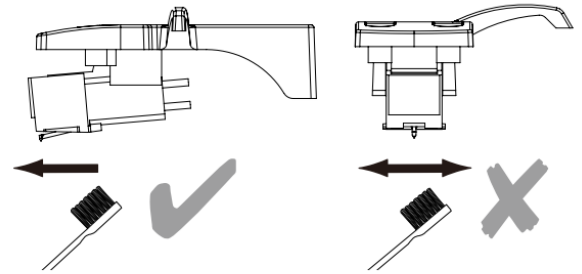

## SPECIFICATIONS

<b>Direct / Belt Drive</b>	<b>Belt Drive</b>
<b>Speed</b>	<b>33 &amp; 45RPM</b>
<b>Headshell/Cartridge</b>	<b>Stereo Cartridge with Ceramic Stylus</b>
<b>Turntable Platter Material</b>	<b>ABS</b>
<b>Wow and Flutter</b>	<b>&lt;0.3%</b>
<b>Bluetooth Version</b>	<b>V5.3</b>
<b>Speaker Power</b>	<b>2 x 60W</b>
<b>Power Supply</b>	<b>AC/DC Adapter Input 100-240V Output 12V-2A</b>
<b>Power Consumption</b>	<b>24W</b>

**Responsible Party Name:**

ICAD Holdings LLC

**Company address:**

458 Florida Grove Road  
Perth Amboy, NJ, 08861 USA

**FCC Compliance Statement**

This device complies with Part 15 of the FCC Rules. The operation is subject to the following two conditions:

- (1) This device may not cause harmful interference, and
- (2) This device must accept any interference received, including interference that may cause undesired operation.

Note: This equipment has been tested and found to comply with the limits for a class B digital device, pursuant to Part 15 of the FCC Rules. This equipment generates, uses and can radiate radio frequency energy and if not installed and used in accordance with the instructions, may cause harmful interference to radio communications. However, there is no guarantee that interference will not occur in a particular installation. If this equipment does cause interference to radio or television reception, which can be determined by turning the equipment off and then on, the user is encouraged to try to correct the interference by one or more of the following measures:

- Reorient or relocate the receiving antenna.
- Increase the separation between the equipment and receiver.
- Connect the equipment to a different outlet so that the equipment and receiver are on different branch circuits.
- Consult the dealer or an experienced radio/TV technician for help.

Any Changes or modifications not expressly approved by the party responsible for compliance could void the user's authority to operate the equipment.

# LEGALITY & SAFETY

The device is not intended for use by people (including children) with reduced physical, sensory or mental capacity. People who have not read the manual, unless they have received an explanation from someone responsible for their safety, should not use this unit. Children should be monitored to ensure that they do not play with the device. The device should always be readily accessible. The device should not be exposed to water. No objects filled with liquids, such as vases, shall be placed on the device. Always leave a minimum distance of 10 cm around the unit to ensure sufficient ventilation. Open flame sources, such as candles, should not be placed on top of the device. The device is intended for use only in temperate climates. At full volume, prolonged listening may damage your hearing and cause temporary or permanent deafness, hearing drone, tinnitus, or hyperacusis. Listening at high volume is not recommended. One hour per day is not recommended either. Danger of explosion if battery is incorrectly replaced or not replaced by the same type or equivalent. The battery should not be exposed to excessive heat such as sunshine or fire. Different types of batteries, or new and used batteries, should not be mixed. The battery must be installed according to its polarity. If the battery is worn, it must be removed from the product. The battery must be disposed of safely. Always use collection bins to protect the environment. The battery can only be replaced by the maker of this product, the sales department, or a qualified person. Switch the device off where the use of the device is not allowed or where there is a risk of causing interference or danger - for example: on an aircraft, or near medical equipment, fuel, chemicals or blasting sites. Check the current laws and regulations regarding the use of this device in the areas where you drive. Do not handle the device when driving. Concentrate fully on driving. All wireless devices are susceptible to interference which may affect their performance. All our devices conform to international/national standards and regulations, and we aim to limit user exposure to electromagnetic fields. These standards and regulations were adopted after the completion of extensive scientific research. This research established no link between the use of the mobile headset and any adverse effects on health if the device is used in accordance with standard practices. Only qualified people are authorized to install or repair this product. Only use batteries, chargers and other accessories which are compatible with this equipment. Do not connect incompatible products. This equipment is not waterproof. Keep it dry. Keep your device in a safe place, out of the reach of young children. The device contains small parts which may present a choking hazard to kids.

# WARRANTY AND REPAIR

All Gemini Sound products are designed and manufactured to the highest standards in the industry. With proper care and maintenance, your product will provide years of reliable service.

## LIMITED WARRANTY

A. Gemini Sound guarantees its products to be free from defects in materials and workmanship for one (1) year from the original purchase date. Exceptions: Laser assemblies on CD Players, cartridges, and crossfaders are covered for 90 days.

B. This limited warranty does not cover damage or failure caused by abuse, misuse, abnormal use, faulty installation, improper maintenance or any repairs other than those provided by an authorized Gemini Sound Service Center.

C. There are no obligations of liability on the part of Gemini Sound for consequential damages arising out of or in connection with the use or performance of the product or other indirect damages with respect to loss of property, revenues, of profit, or costs of removal, installation, or reinstallation. All implied warranties for Innovative Concepts & Design LLC, including implied warranties for fitness, are limited in duration to one (1) year from the original date of purchase, unless otherwise mandated by local statutes.

## RETURN/REPAIR

A. In the U.S.A., please call our helpful Customer Service Representatives at (732) 346-0061, and they will be happy to give you a Return Authorization Number (RA#) and the address of an authorized service center closest to you.

B. After receiving an RA#, include a copy of the original sales receipt, with defective product and a description of the defect. Send by insured freight to: Gemini Sound and use the address provided by your customer service representative. Your RA# must be written on the outside of the package, or processing will be delayed indefinitely!

C. Service covered under warranty will be paid for by Gemini Sound and returned to you. For non-warrantied products, Gemini Sound will repair your unit after payment is received. Repair charges do not include return freight. Freight charges will be added to the repair charges.

D. On warranty service, you pay for shipping to Innovative Concepts & Design LLC, we pay for return shipping within the continental United States. Alaska, Hawaii, Puerto Rico, Canada, Bahamas, and the Virgin Islands will be charged for freight.

E. Please allow 2-3 weeks for the return of your product.

Under normal circumstances your product will spend no more than 10 working days at Gemini Sound. We are not responsible for shipping times.

# **FUNCIONES**

Combina la calidez del vinilo y la comodidad de la tecnología moderna con el Gemini TT-900WD. Este sistema de tocadiscos todo en uno combina un diseño vintage de vetas de madera con altavoces estéreo incorporados y funcionalidad Bluetooth, lo que lo convierte en la pieza central perfecta para los amantes de la música que aprecian tanto el estilo como el sonido.

## **Diseño de inspiración retro**

Acabado clásico de gabinete de madera con un diseño moderno y elegante, que combina la estética atemporal con el aspecto minimalista de hoy para complementar cualquier configuración del hogar.

## **Listo para música inalámbrica**

Transmite fácilmente tus pistas digitales favoritas desde cualquier dispositivo habilitado para Bluetooth directamente a los altavoces integrados, sin necesidad de cables ni receptores.

## **Gira tus favoritos**

Admite discos de vinilo de 33 1/3 y 45 RPM, para que pueda disfrutar de todo, desde álbumes de larga duración hasta sencillos clásicos con facilidad.

## **Amplificador incorporado para altavoces pasivos Alimenta**

tus altavoces pasivos directamente con el amplificador integrado del tocadiscos para obtener un sonido más completo y dinámico sin necesidad de equipos adicionales.

## **Cartucho de sonido premium**

Equipado con un cartucho de imanes móviles de alta calidad para una reproducción de sonido rica y equilibrada directamente desde la fuente.

Ya sea que esté redescubriendo su colección de vinilos o transmitiendo una nueva lista de reproducción, el Gemini TT-900WD ofrece vibraciones vintage y rendimiento moderno en una unidad optimizada.

# DESCRIPCIÓN GENERAL DEL PRODUCTO

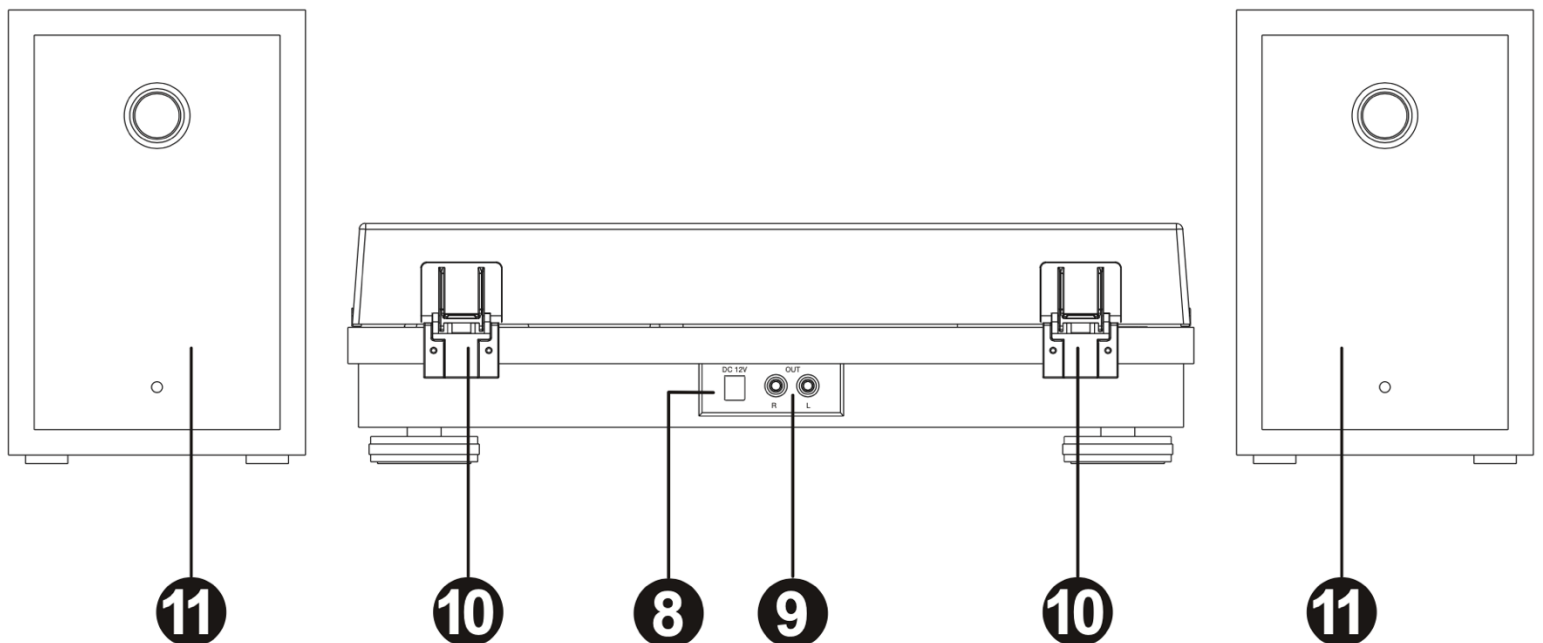
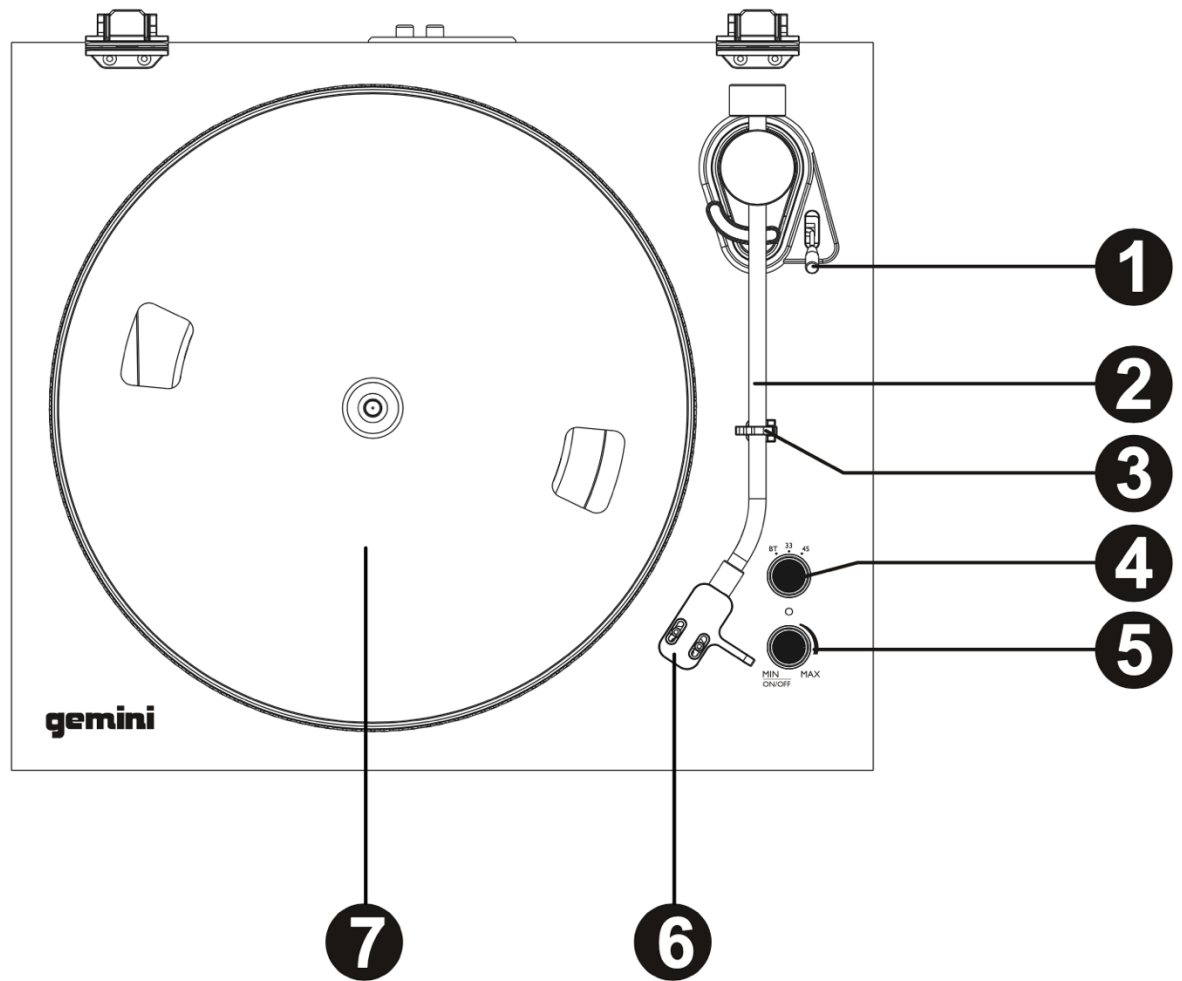

# DESCRIPCIÓN GENERAL DEL PRODUCTO

1. Palanca de señalización
2. Brazo
3. Pinza/reposabrazos para tonificar
4. Perilla de función (interruptor BT y 33/45 RPM)
5. Interruptor de encendido (y control de volumen)
6. Carcasa de la cabeza con cartucho  
(Retire el protector de lápiz transparente antes de usar)
7. Plato (Coloque la alfombrilla deslizante de fieltro y coloque su disco aquí)
8. Puerto de entrada de CC (Se utiliza para conectar el adaptador de corriente)
9. Salida RCA (Se utiliza para conectarse a altavoces externos)
10. Bisagras de la tapa del plato giratorio
11. Altavoces externos

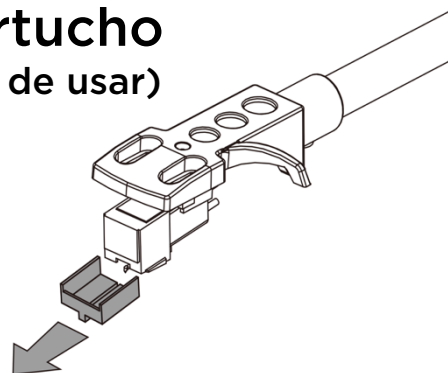

# EMPEZAR

1. Retire la unidad del embalaje y coloque la cubierta antipolvo deslizando sus casquillos sobre las bisagras traseras (pueden encajar firmemente).
2. Conecte la unidad principal a los altavoces mediante el cable RCA.
3. Conecte el adaptador de CC a la toma DC IN en la parte posterior, luego conecte el adaptador a una toma de corriente.

## MODO FONO

### (REPRODUCCIÓN DE DISCOS DE VINILO)

1. Encienda la perilla de encendido. Coloque un disco en el plato y seleccione 33 o 45 RPM según el registro. Se encenderá la luz indicadora roja.

*Algunos discos de 45 RPM necesitarán el adaptador de orificio central incluido .*

2. Retire el protector del lápiz óptico y desbloquee el clip del brazo de tono. Empuje la palanca de elevación hacia atrás para levantar el brazo de tono, luego muévelo sobre el lugar deseado en el disco. La fuente comenzará a girar. Empuje la palanca hacia adelante para bajar el brazo de tono y comenzar la reproducción.
3. Para detener la reproducción, empuje la palanca de elevación hacia atrás para levantar el brazo de tono y, a continuación, devuélvalo a su posición de reposo. Empuje la palanca hacia adelante para bajarla, luego asegure el brazo de tono con el clip.



### ***Tenga en cuenta:***

***Nunca levante el cartucho con la mano durante la reproducción, ya que esto puede dañar el disco o el lápiz óptico, use siempre la palanca de referencia.***

## **MODO BLUETOOTH**

1. Coloque la perilla de función en BT; El indicador azul parpadeará.
2. Habilite Bluetooth en su dispositivo y empareje con "Gemini TT-900WD" La luz dejará de parpadear una vez conectado y podrá transmitir audio a través del tocadiscos.
3. Use la perilla de volumen o los controles de volumen de su dispositivo para ajustar el sonido.

## **SUSTITUCIÓN DE LA AGUJA**

Se recomienda reemplazar el lápiz óptico después de 1,000 horas de tiempo de reproducción o si está dañado.

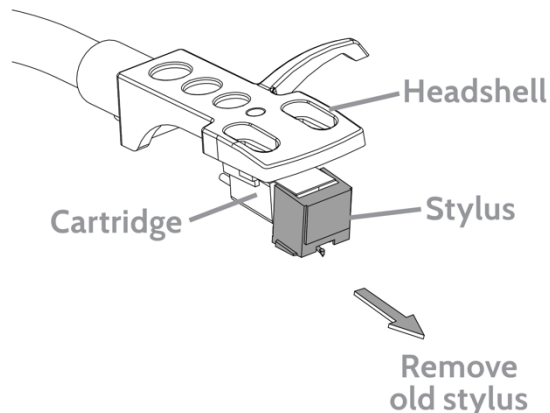

- Apague el plato giratorio y desconéctelo.

- Para quitar el lápiz óptico viejo, sostenga firmemente la carcasa del cabezal y el cartucho, luego tire del lápiz óptico hacia adelante para quitarlo.

Para instalar un nuevo lápiz óptico, deslícelo sobre el cartucho hasta que encaje en su lugar.

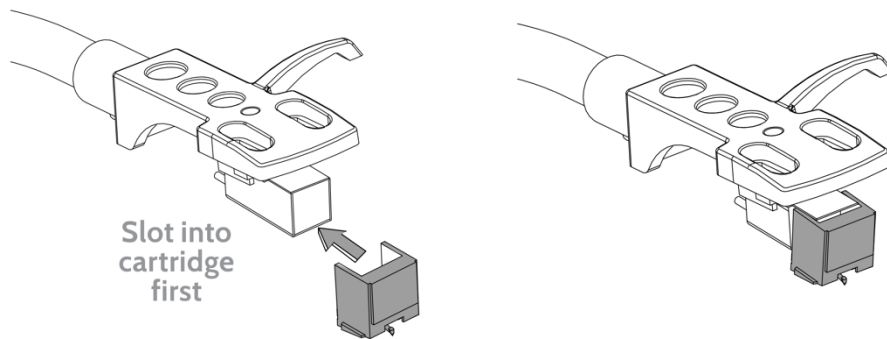

## CUIDADO DEL LÁPIZ ÓPTICO

Limpie el lápiz óptico con regularidad para eliminar el polvo y las pelusas. Use un cepillo o limpiador de lápiz óptico adecuado (no incluido), cepillando de atrás hacia adelante a lo largo de la punta.

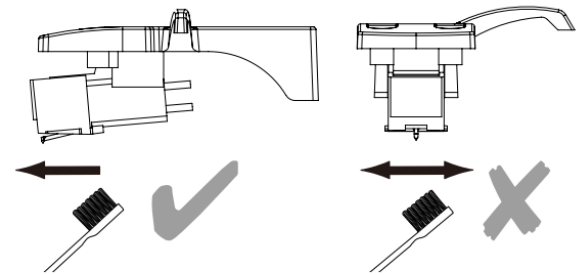

# CARACTERÍSTICAS TÉCNICAS

Transmisión directa / por correa	Transmisión por correa
Velocidad	33 y 45 RPM
Cabezal/Cartucho	Cartucho estéreo con lápiz óptico cerámico
Material del plato de la plataforma giratoria	ABS
Wow y aleteo	<0.3%
Versión de Bluetooth	V5.3
Potencia del altavoz	2 x 60W
Fuente de alimentación	Adaptador de CA/CC Entrada 100-240V Salida 12V-2A
Consumo de energía	24W

# gemini<sup>®</sup>

## WELCOME TO THE GEMINI FAMILY!

At Gemini, our highest priority is making your experience unforgettable.  
Need help with setting up, troubleshooting, or looking for some tips?  
We're here for you, Monday through Friday 9AM-5PM EST.



[hello@geminisound.com](mailto:hello@geminisound.com)



1-844-GEMINI9



[www.geminisound.com](http://www.geminisound.com)

