

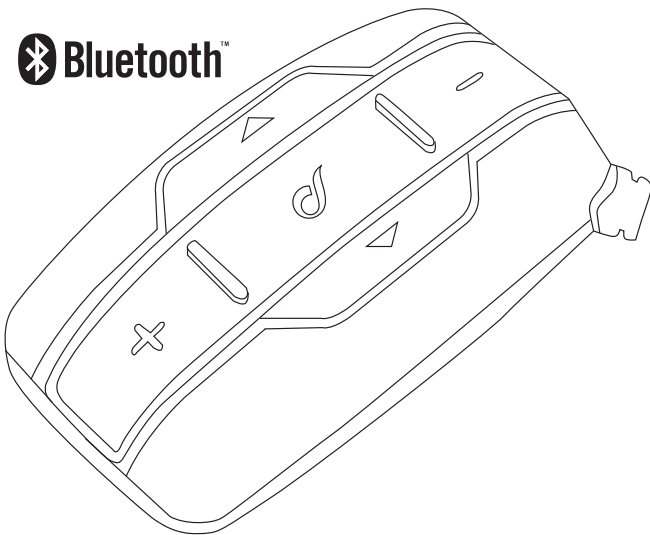

EDGE



QUICK GUIDE

CHECK FOR SOFTWARE UPDATES ON WEBSITE
www.interphone.com

WARNING ON THE BATTERY OF THE PRODUCT

Fully charge the battery before using the product for the first time. Do not store the product without charging it. Failure to do so may cause irreversible damage to the battery capacity. Charge the battery every TWO months.

WARNING ON THE WATER RESISTANCE OF THE PRODUCT

The external unit (control unit), connected to the audio kit, can be immersed in a meter of fresh water for a maximum of 30 (thirty) minutes.

Despite this, the device is not immune to greater stress, such as prolonged immersions or high pressure water jets.

Using the product during intense meteorological phenomena, at high speeds, may be equivalent to subjecting the product to a high pressure jet.

FOLLOW ALL SUGGESTIONS CAREFULLY TO AVOID DAMAGING THE DEVICE:

Do not immerse the product in fresh water which is more than a metre deep for more than 30 minutes.

Do not store the product when still wet: dry it with a clean, soft cloth.

Do not expose the product to salt water or ionised water, drinks or other liquids.

If the device is exposed to liquids other than fresh water, wash the device with cold fresh water and dry it carefully with a clean, soft cloth.

Do not expose the product to high pressure water jets.

CHAPTER 1 – COMPOSITION OF THE KIT

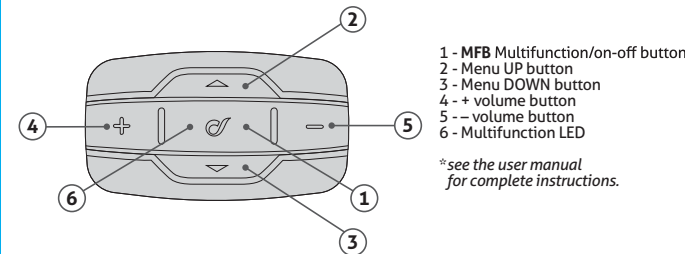

- 1 - MFB Multifunction/on-off button
- 2 - Menu UP button
- 3 - Menu DOWN button
- 4 - + volume button
- 5 - - volume button
- 6 - Multifunction LED

*see the user manual
for complete instructions.

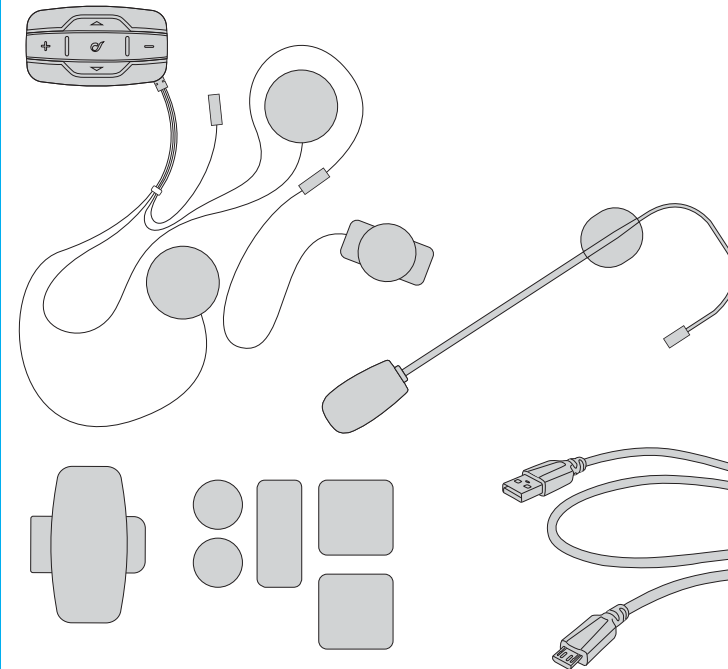

CHAPTER 2 – INSTALLATION INSTRUCTIONS

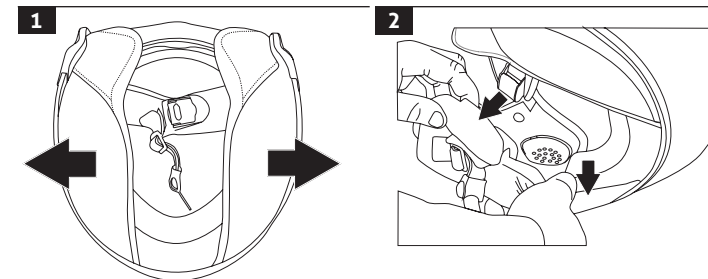

If possible, remove the two cushions or padding

Locate the area in correspondence with the ear

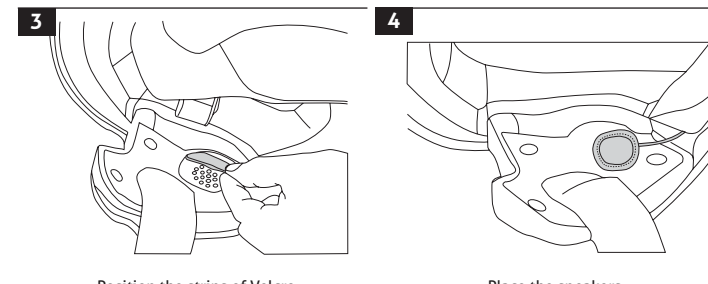

Position the strips of Velcro for the speakers

Place the speakers

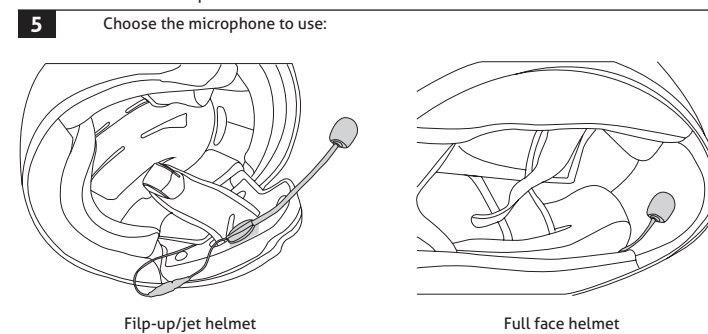

Filp-up/jet helmet

Full face helmet

6 Choose the bracket to use, to be attached on the left side of the helmet:

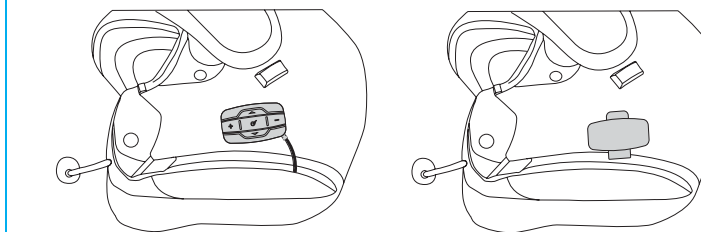

Sticker

Bracket

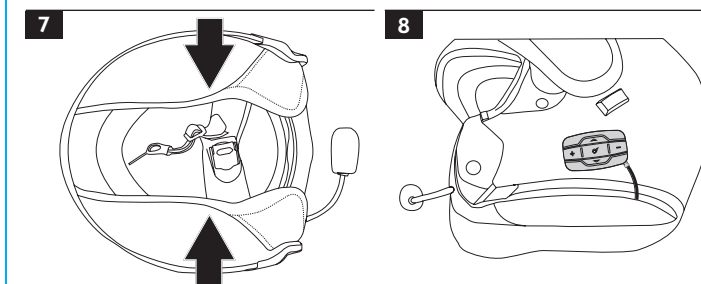

Re-install the cushions

Install the control unit

(!) Warnings on installation:

1. The centre of the speakers must be placed in correspondence with the ears, as close as possible.

2. The marking "MIC" on the microphone must be directed towards the mouth.

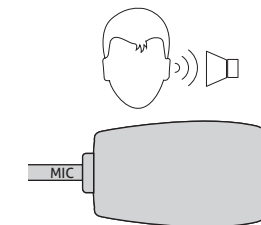

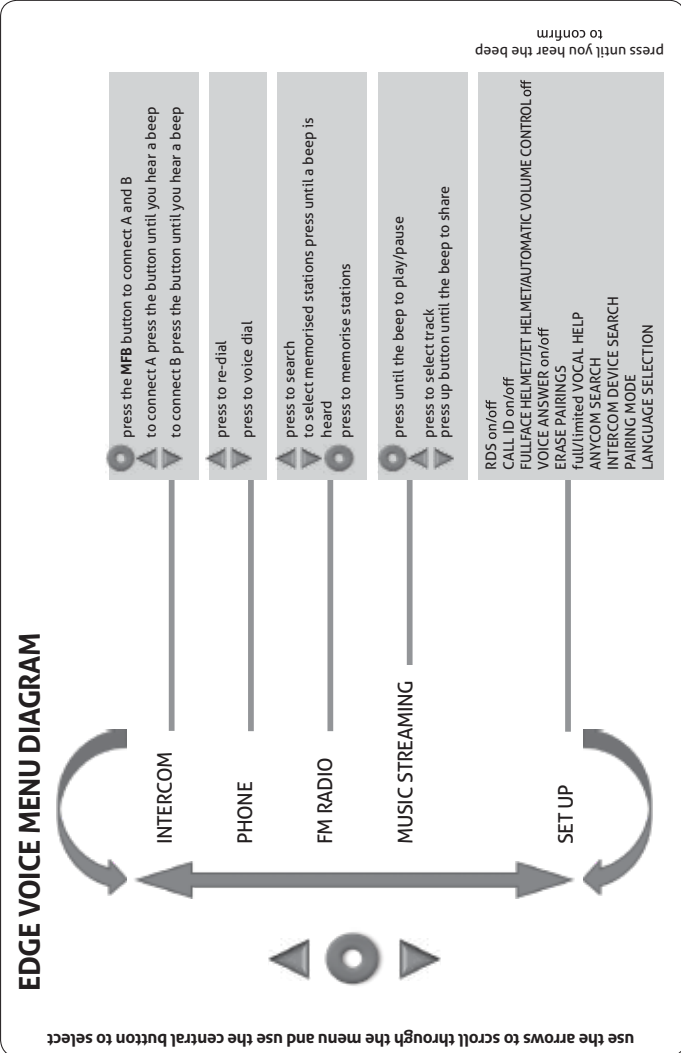

CHAPTER 3 - BATTERY CHARGE

Insert the micro USB charging cable in the special intercom connector, as shown in the picture. Connect the cable to a standard USB charger.

LED indications:
- orange LED: charging.
- green LED: fully charged

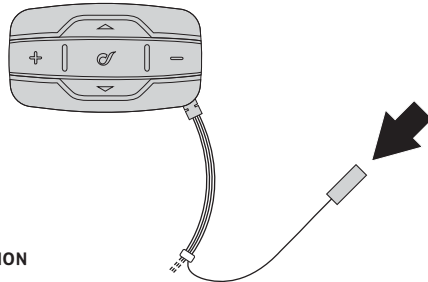

CHAPTER 4 - BASIC CONFIGURATION

Turn the device on
Press the central MFB button until the blue LED comes on.

Turn the device off
Press the central MFB button until the red LED lights up and the device turns off.

Factory Reset
With the device off, press together the central MFB button and UP button and DOWN button until the device switches on. All settings and pairings will be erased.

CHAPTER 5 - TELEPHONE / GPS

Pairing
1. With the intercom off, press and hold the central MFB button until the LED flashes red/blue alternately.
2. Start searching for new devices on the mobile phone / GPS
3. Select the intercom on the phone / GPS "interphone edge".
4. Once the pairing has been confirmed, the LED will flash BLUE twice, every three seconds.

Answering a call
Just say loudly "HELLO" or short press the central MFB button.

CHAPTER 6 - CHANGE THE VOICE GUIDE LANGUAGE

1. Turn off the EDGE
2. Turn the EDGE on again
3. Briefly press the UP button
4. Briefly press the MFB button
5. Briefly press the UP button
6. When you hear the guide voice speak in your language press the MFB button.

CHAPTER 7 - INTERCOM

Pairing with another Interphone device (for the first time only)
With the EDGE turned off, press the central MFB button (1) for 5 seconds until the two red and blue LEDs flash alternately and then press the upper button. The device will begin to search for a second Interphone device.
Make sure that the second Interphone device is in "PAIRING MODE" (blue and red LEDs flashing alternately).

Two way intercom talk
On one unit only, press the central MFB button.
To stop communication, on one unit only, press the central MFB button.

CHAPTER 8 - PAIRING WITH A NON-INTERPHONE DEVICE

With the EDGE turned off, press the central MFB button (1) for 5 seconds until the two red and blue LEDs flash alternately and then press the lower button. The device will begin to search for a second NON Interphone device.
On the second NON Interphone device activate phone pairing; refer to the relative user manual if necessary.
The EDGE begins to search for a second third-party device (NON Interphone device).

CHAPTER 9 - PAIRING OF 3 OR 4 INTERPHONE EDGE DEVICES:

Pairing 3 EDGE devices:

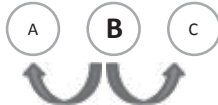

Pair A with B using the procedure described in Chapter 7.
Then pair B with C using the procedure described in Chapter 7.
To start a conversation press the central button of user B.

Pairing 4 EDGE devices:

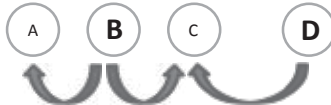

After having paired the three devices as described above, pair C with D using the procedure described in Chapter 7.
Start a conversation between three devices (A-B-C) then press the central button of user D to start add the forth user to the conversation.

TECHNICAL CHARACTERISTICS

Bluetooth® compliance:	Bluetooth v. 3.0 - Class I
Supported Bluetooth profiles:	HFP A2DP AVRCP
Frequency:	2.402 – 2.480GHz
Power:	10dBm EIRP
Operating temperature:	0 – 45°C
Charging temperature:	10 - 40°C
Dimensions mm:	60x80x30
Weight:	44 g
Capacity:	Up to 10 meters
Talk time:	12 h
Stand-by time:	700 h
Charging time:	3 h
Battery type:	Lithium-ion rechargeable

SAR is measured with the device at 0 mm to the body, while transmitting at the highest certified output power level in all frequency bands of the device.
The maximum SAR value is 0.095 W/kg (head/body) averaged over 10 gram of tissue.



WARNING: To prevent possible hearing damage, do not listen at high volume levels for long periods.

Federal Communications Commission (FCC) Statement
Industry Canada (IC) Statement
15.21
You are cautioned that changes or modifications not expressly approved by the part responsible for compliance could void the user's authority to operate the equipment.
15.105(b)
This equipment has been tested and found to comply with the limits for a Class B digital device, pursuant to part 15 of the FCC/IC rules. These limits are designed to provide reasonable protection against harmful interference in a residential installation. This equipment generates, uses and can radiate radio frequency energy and, if not installed and used in accordance with the instructions, may cause harmful interference to radio communications. However, there is no guarantee that interference will not occur in a particular installation. If this equipment does cause harmful interference to radio or television reception, which can be determined by turning the equipment off and on, the user is encouraged to try to correct the interference by one or more of the following measures :
-Reorient or relocate the receiving antenna.
-Increase the separation between the equipment and receiver.
-Connect the equipment into an outlet on a circuit different from that to which the receiver is connected.
-Consult the dealer or an experienced radio/TV technician for help.
This device complies with part 15 of the FCC rules and Industry Canada licence-exempt RSS standard(s)
Operation is subject to the following two conditions :
1)This device may not cause interference and
2)This device must accept any interference, including interference that may cause undesired operation of the device.
FCC/IC RF Radiation Exposure Statement :
This equipment complies with FCC/IC radiation exposure limits set forth for an uncontrolled environment. End users must follow the specific operating instructions for satisfying RF exposure compliance. This transmitter must not be co-located or operating in conjunction with any other antenna or transmitter.



EN - Hereby, Cellular Italia S.p.A declares that the radio equipment type BTFB (Interphone Edge) is in compliance with Directive 2014/53/EU and Directive RoHS (2011/65/EU). The user is prohibited from making any type of change or variation to the device.
Variations or changes not expressly approved by Cellular Italia S.p.A will cancel the user's authorisation to use the device.
Only update with software provided by Cellular Italia S.p.A.
Bluetooth® is a trademark owned by Bluetooth SIG, Inc.
The full text of the EU declaration of conformity is available at the following internet address: http://www.cellularline.com/it_it/dichiarazione-conformita/



EN - INSTRUCTIONS FOR THE DISPOSAL OF APPLIANCES FOR DOMESTIC USERS
(Applicable in countries in the European Union and those with separate waste collection systems)
This mark on the product or documentation indicates that this product must not be disposed of with other household waste at the end of its life. To avoid any damage to health or the environment due to improper disposal of waste, the user must separate this product from other types of waste and recycle it in a responsible manner to promote the sustainable re-use of the material resources.
Domestic users should contact the dealer where they purchased the product or the local government office for all the information regarding separate waste collection and recycling for this type of product. Corporate users should contact the supplier and verify the terms and conditions in the purchase contract. This product must not be mixed with other commercial waste.
This product has a battery that cannot be replaced by the user. Do not attempt to open the device to remove the battery as this could cause malfunctions and seriously damage the product. When disposing of the product, please contact the local waste disposal authority to remove the battery. The battery inside the device was designed to be able to be used during the entire life cycle of the product