

Quide 232.5 mm X 195 mm

- STEP 1 Start**
- Please charge over 5 hours for first time. Please insert charging cable into USB plug and attach charging head to charging pins beneath JUMPY Plus module.

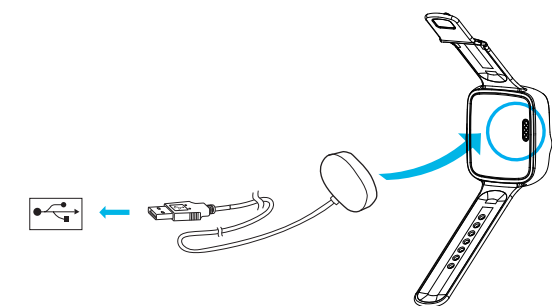

Layout and Buttons

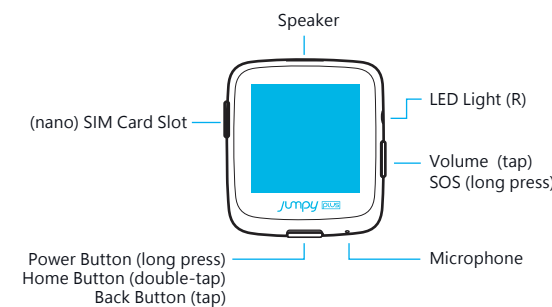

- STEP 2 Power on**
- Once fully charged, please long press Power/Home/Back Button for 5 seconds to turn on JUMPY Plus. Double-tap the button return to the main menu (clock) or tap it to return to the previous page.

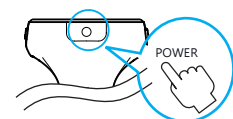

- STEP 3 Insert SIM card**
1. Make sure your SIM card with enough credits and its 3G data connection enabled.
 2. Unlock SIM card lock
 3. Insert nano SIM card and JUMPY Plus will reboot.
- * JUMPY Plus supports WDMA 1900/2100 MHz.
* Only partial functions are accessible in JUMPY Plus without SIM inserted.
* Communication/Messaging/Calendar/Tracking is workable with Linked JUMPY Plus.
* You may unlock SIM card lock by smartphone. Please check JUMPY+ App FAQ

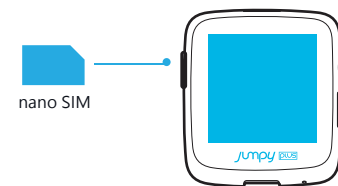

- STEP 4 Install JUMPY+ App**
1. Search and download JUMPY+ app from Google Play or iTunes Store.
 2. Use mobile number to register JUMPY+ user account.
 3. Turn on Bluetooth to link with JUMPY Plus.

Compatible device

1. Android 4.3 and above
2. iOS 8 and above
3. BLE 4.0 and above



STEP 5 Link to Mobile Devices

Link as first parent

1. Insert nano SIM into JUMPY Plus and turn on the watch
2. Launch JUMPY+ app. Log-in and enter Account Management Page.
3. Tap "+" to link a JUMPY Plus.
4. Select "Relationship" with JUMPY Plus user.
5. Tap the intended-to-link JUMPY Plus and then accept "link" on watch.
6. Once receiving link confirmation from JUMPY Cloud, please input Kid information (such as birthday, mobile number and etc). Then Link process is complete.

Link as second parent

1. Launch JUMPY+ app. Log-in and enter Account Management Page.
2. Tap "+" to link a JUMPY Plus.
3. Select "Relationship" with JUMPY Plus user.
4. Tap the intended-to-link JUMPY Plus and then accept "link" on watch.
5. JUMPY Cloud will send a request to get first-link parent to get permission for 2nd parent to link.
6. Once first-link parent accept, 2nd parent will get confirm for watch linking.

*4 parents at most to link one JUMPY Plus.

Thank you for choosing JUMPY Plus JR-02-W

Before using JUMPY Plus, please download "JUMPY+" App from iTunes Store or Google Play to your mobile device and install it. Besides, with up-to-date JUMPY Plus upgrade, you can benefit latest JUMPY plus features. Please check our website <http://www.jumpy.cc> for updates.

JUMPY Plus at a Glance

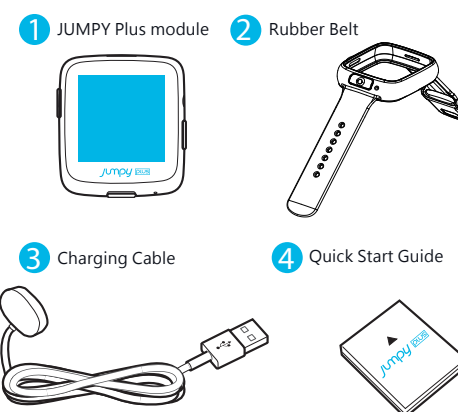

Quick Start Guide

Specification

Model: JR-02-W. H13 x L49 x W43 mm, 56 g, 1.6" (240X240), 420mAh, 4GB /512MB, Dual 1GHz, WCDMA 2100/1900MHz, Bluetooth, wifi, USB2.0. Microphone, Speaker, G-Sensor, Gyroscope, LED, SIM card slot (for nanoSIM)

Safety Instruction

1. Keep out of reach of kids under age 3 without parent's supervision.
2. To avoid to use JUMPY Plus outdoor under thunder storm.
3. Do not use fire to destroy JUMPY Plus which may trigger battery explosion. Please follow local recycling regulation.
4. Never attempt to open or repair JUMPY Plus which does not contain any user-serviceable parts. Please contact local service center.
5. To avoid kids or pets to chew or swallow JUMPY Plus.

Warrenty

Under normal operation, JUMPY Plus user is granted 12 months limited warranty since procurement. Please check relative info on <http://www.jumpy.cc>.

Certification

1. IP54 water resistance
2. ASTM F963 and EN71 for Standard Consumer Safety Specification for Toy Safety
3. Federal Communications Commission (FCC): FCC ID : 2ADZ9-JR-02-W



<http://jumpy.cc>

jumpy

Designed by Joyray Technology Co. Ltd.
4F., No.230, Sec. 4, Ren'ai Rd, Da'an Dist., Taipei City 106, Taiwan
Copyright© 2015 by Joyray Technology Co.Ltd. - All Rights Reserved.
Email: services@joyraytech.com



jumpy plus

Join the Future of Parenthood
with JUMPY Plus

Federal Communications Commission (FCC) Statement 15.21
You are cautioned that changes or modifications not expressly approved by the party responsible for compliance could void the user's authority to operate the equipment.
This device complies with part 15 of the FCC Rules. Operation is subject to the following two conditions:
1) this device may not cause interference and
2) this device must accept any interference, including interference that may cause undesired operation of the device.
15.105(b)
This equipment has been tested and found to comply with the limits for a Class B digital device, pursuant to part 15 of the FCC rules. These limits are designed to provide reasonable protection against harmful interference in a residential installation.
This equipment generates uses and can radiate radio frequency energy and, if not installed and used in accordance with the instructions, may cause harmful interference to radio communications. However, there is no guarantee that interference will not occur in a particular installation. If this equipment does cause harmful interference to radio or television reception, which can be determined by turning the equipment off and on, the user is encouraged to try to correct the interference by one or more of the following measures:
-Reorient or relocate the receiving antenna.
-Increase the separation between the equipment and receiver.
-Connect the equipment into an outlet on a circuit different from that to which the receiver is connected.
-Consult the dealer or an experienced radio/TV technician for help.
FCC RF Radiation Exposure Statement:
To comply with the FCC RF exposure compliance requirements, this device and its antenna must not be co-located or operating in conjunction with any other antenna or transmitter.
For next to mouth operation, this device has been tested and meets FCC RF exposure guidelines when used with an accessory that contains no metal and that positions the device a minimum of 10 mm from the face.
Use of other accessories may not ensure compliance with FCC RF exposure guidelines.
For limb-worn operation, this device has been tested and meets FCC RF exposure guidelines when used with an accessory that contains no metal and that positions the device a minimum of 6 mm from the body. Use of other accessories may not ensure compliance with FCC RF exposure guidelines.
Head: 0.409 W/kg@1g (FCC); Extremity: 2.194 W/kg@10g (FCC)