

Manual

Product Features:

1. Dual track output enhances stereo perception.
2. Special On-head design on.
3. Touch design makes answering call, adjusting volume and switching tracks more convenient. Particularly fit for drivers and reduce the traffic accidents.
4. Longer standby time and working time.
5. With the most new solution of Bluetooth, it is compatible with most of Bluetooth device of Audio.
6. Push button of power. It can extended battery life as we can cut off the power by clicking the power button easily.
7. With Omnidirectional microphone design and advanced circuit of noise canceling, you can get a good feel anywhere.
8. The design of composite membrane of horn unit could kindly return the audio signal to the original condition and bring the good feeling of acoustics.

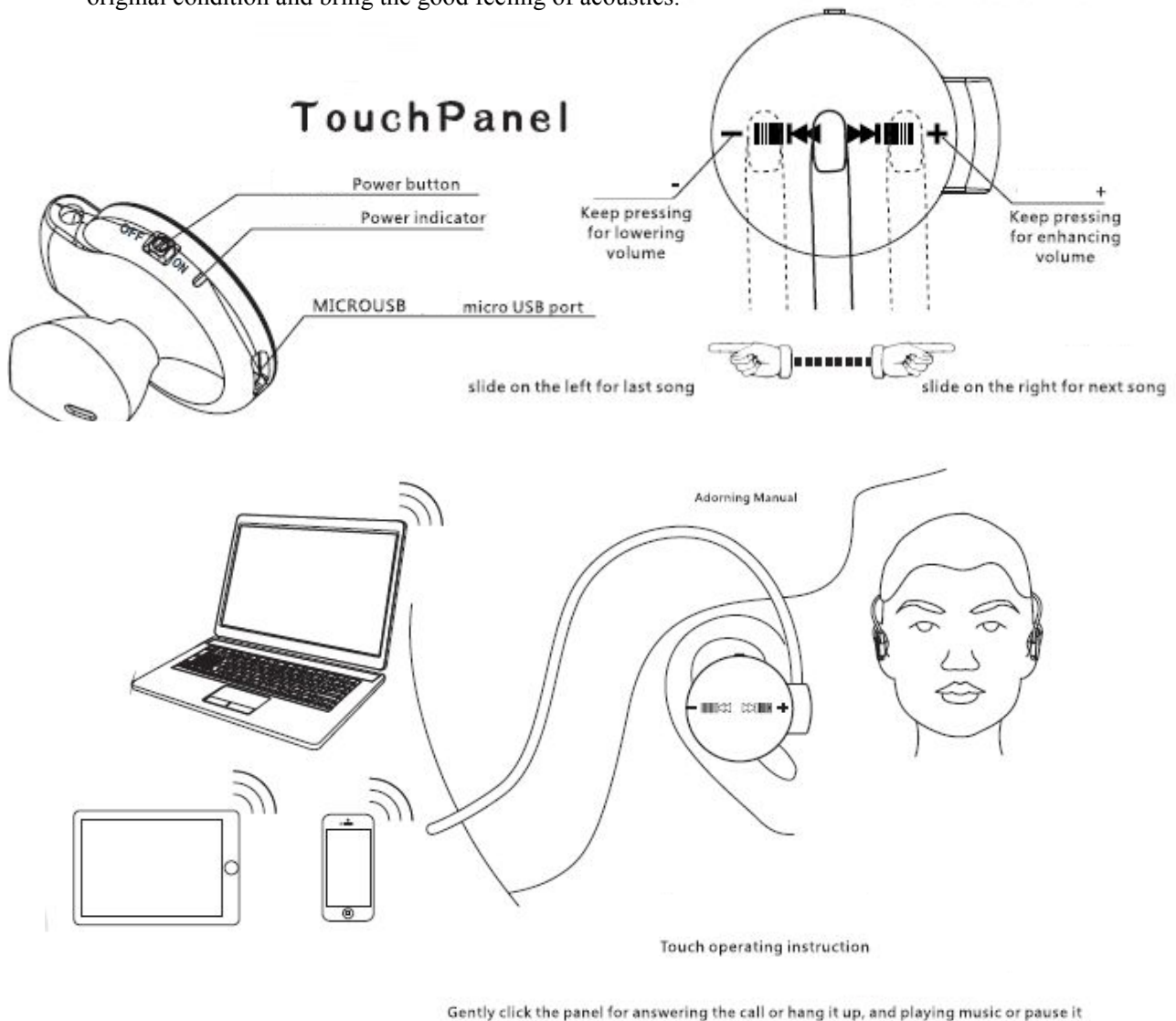

Parameters:

- Bluetooth version: V4.1
- Transmission distance: 10 m
- Battery capacity: 80 mAh
- Working time: 8 h
- Standby time: 30 day
- Driver diameter: 14.2
- Frequency response: 20Hz to 20KHz
- Sensitivity: 105dB
- Sensitivity of Microphone: -45dB

FCC STATEMENT :

This device complies with Part 15 of the FCC Rules. Operation is subject to the following two conditions:

- (1) This device may not cause harmful interference, and
- (2) This device must accept any interference received, including interference that may cause undesired operation.

Warning: Changes or modifications not expressly approved by the party responsible for compliance could void the user's authority to operate the equipment.

NOTE: This equipment has been tested and found to comply with the limits for a Class B digital device, pursuant to Part 15 of the FCC Rules. These limits are designed to provide reasonable protection against harmful interference in a residential installation.

This equipment generates uses and can radiate radio frequency energy and, if not installed and used in accordance with the instructions, may cause harmful interference to radio communications. However, there is no guarantee that interference will not occur in a particular installation. If this equipment does cause harmful interference to radio or television reception, which can be determined by turning the equipment off and on, the user is encouraged to try to correct the interference by one or more of the following measures:

Reorient or relocate the receiving antenna.

Increase the separation between the equipment and receiver.

Connect the equipment into an outlet on a circuit different from that to which the receiver is connected.

Consult the dealer or an experienced radio/TV technician for help.

RF warning statement:

The device has been evaluated to meet general RF exposure requirement. The device can be used in portable exposure condition without restriction.