

Android mobile data terminal

Quick Reference Guide

CE1588



1. Installation of SIM and TF card



1. Left sliding lock

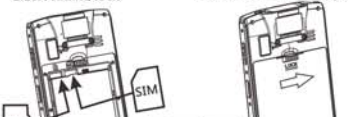

3. Insert SIM and TF card.



4. Put the battery in and put the cover on then



2. Battery charge



1. This cell phone can be recharged via USB devices (trickle charge)

2. You can recharge (fast charge) by 5V, 1A power adapter.

Battery icon	Description
	Main battery
	State of charge
	Battery run out

Attention:

- 1 LED display flashing red when charging, and the LED will normally on when the charge was completed.
- 2 We suggested to charge more than 12 hours with power adapter when first recharge.
- 3 It needs to ensure charge and discharge at least once within 2 months if left uncharged a longtime.
- 4 To use the charging equipment which compatible please.

3. start-up, shutdown, restart and restore factory settings

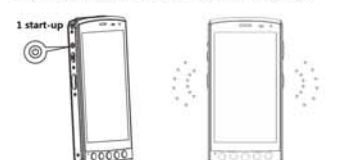

1. Long press the POWER Key.

2. To release the POWER key after once vibration

3. shutdown/Restart

1. Press the POWER button for 2 seconds in the state of power on

2. Click on the "Shutdown" or "restart" button

Long press the POWER button for 7 seconds to restart in the state of power on

9. Function customization

Management permission

Home - menu - management permissions setting - default password 123456

Suggest resetting the administrator password (shall not be less than 6-bit)

Android Mobile Terminal

Android Mobile Terminal

Android Mobile Terminal

Android Mobile Terminal

Android Mobile Terminal

Android Mobile Terminal

Android Mobile Terminal

Android Mobile Terminal

Android Mobile Terminal

Android Mobile Terminal

Android Mobile Terminal

Android Mobile Terminal

Android Mobile Terminal

Android Mobile Terminal

Android Mobile Terminal

Android Mobile Terminal

Android Mobile Terminal

Android Mobile Terminal

Android Mobile Terminal

Android Mobile Terminal

Android Mobile Terminal

Android Mobile Terminal

Android Mobile Terminal

Android Mobile Terminal

Android Mobile Terminal

Android Mobile Terminal

Android Mobile Terminal

Android Mobile Terminal

Android Mobile Terminal

Android Mobile Terminal

Android Mobile Terminal

Android Mobile Terminal

Android Mobile Terminal

Android Mobile Terminal

Android Mobile Terminal

Android Mobile Terminal

Android Mobile Terminal

Android Mobile Terminal

Android Mobile Terminal

Android Mobile Terminal

Android Mobile Terminal

3 Restore factory settings

Enter "setting" option, click on "personal", click on "restore factory settings"

Attention: all settings you have been made for this cell phone will be restored to the original settings, please operation carefully.

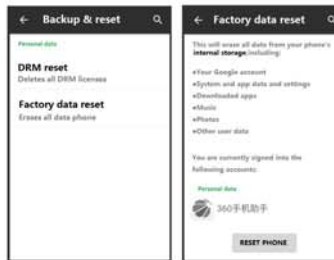

4 Connect to PC

This device can exchange data with PC through the USB DATA cable. The operation process is as follows:

- 1 To insert the standard cable of this cell phone into USB port of PC and then insert the other end of the data wire into this cell phone.
- 2 There will pop up "USB has been connected" on the left top of the screen, to scroll down to connect icon on the top of the screen, to click the "USB has been connected".
- 3 To click "open the USB storage device" on the pops up interface.

5 Operations for touch screen and keys

1 Touch screen

The cell phone has adopted capacitive touch screen. It supports multi-touch and you can operate by slight touch, such as start, click, move, screen zooms in and out, soft keyboard input and other operations.

Attention:

Do not tap the screen with a touch pen; this operation is not valid for capacitive screen and the screen may not have any response when you operation wearing gloves that is normal phenomenon.

Permission release:

Homepage-menu-management permission settings-enter the administrator password-ok-remove the tick of guest user permission-Guest application settings-remove the tick on the program-save return



Customize the display text of homepage:

Home page - long press text strip - set text attributes and content - return - to confirm the modification



WARNING:

This device complies with part 15 of the FCC Rules. Operation is subject to the following two conditions:

- (1) This device may not cause harmful interference, and
- (2) This device must accept any interference received, including interference that may cause undesired operation. Changes or modifications not expressly approved by the party responsible for compliance could void the user's authority to operate the equipment.

NOTE:

This equipment has been tested and found to comply with the limits for a Class B digital device, pursuant to part 15 of the FCC Rules. These limits are designed to provide reasonable protection against harmful interference in a residential installation.

This equipment generates, uses and can radiate radio frequency energy and, if not installed and used in accordance with the instructions, may cause harmful interference to radio communications. However, there is no guarantee that interference will not occur in a particular installation. If this equipment does cause harmful interference to radio or television reception, which can be determined by turning the equipment off and on, the user is encouraged to try to correct the interference by one or more of the following measures:

- Reorient or relocate the receiving antenna.
- Increase the separation between the equipment and receiver.
- Connect the equipment into an outlet on a circuit different from that to which the receiver is connected.
- Consult the dealer or an experienced radio/TV technician for help.

FCC RF Exposure Information and Statement:

The SAR limit of USA (FCC) is 1.6 W/kg averaged over one gram of tissue.

Device types: FCC ID 2ADXX-MX-5060 has also been tested against this SAR limit. The highest SAR value reported under this standard during product certification for use on the Head is 0.043W/Kg and on the body is 0.137W/Kg (0mm distance), 0.063W/Kg (10mm distance)

CE Note:

The SAR limit of Europe (CE) is 2.0 W/kg averaged over one gram of tissue. Device types: MX-5060 has also been tested against this SAR limit. The highest SAR value reported under this standard during product certification for use on the Head is 0.014W/Kg and on the body is 0.092W/Kg (0mm distance).

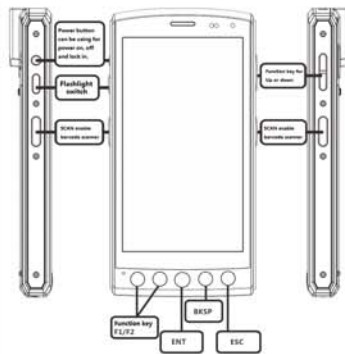

6 Barcode scanning

1 Start bar code scanning

To view the scan status icon on the top right of the screen. Scanning has been activated if it is 1. Scanning has not activated yet if it is 2. Need to open it in setting.

Start Methods for bar code scanning

Method A: Starting the desktop application (scan settings). Method B: To enter the setup option of the Android system, click [scan settings], start bar code scanning.

2 Start Scanning

Open any text input box or client application, and you can activate the scanning by press the scanning key on both side. Please run "Scan Settings" application if you want more barcode scanning settings option.

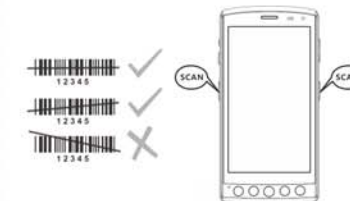

7 Starting WiFi Wi-Fi and 4G data application

Access to the Android system setup options, then click [network] operation, start the WLAN and enter WLAN settings, then to select the Wi-Fi network which you need. When the connection is successful, the network icon is shown below:

WLAN

Open

2. Open the applications of 4G Data

Enter setup options of the Android system.

To click [network] [mobile network] [start data flow]

4G means that currently accessing the 4G network

3G means that CDMA is current network

E means that EDGE is current network

G means that GPRS is current network

There are four types of data connections. Depending on your wireless network environment, the access speed of 4G is the fastest among them. Secondly is WCDMA, the next is EDGE and the slowest is GPRS.

Attention: it will generate traffic expense after connecting to mobile networks, the system will turn off the 4G data applications automatically when Wi-Fi wireless network is connected successfully. This cell phone support for 2G network, 3G network and 4G network, please refer to the product model

8 Care & Maintenance

1. This cell phone can achieve the industrial dustproof and waterproof, and tolerate a certain degree of harsh working conditions but do not use in circumstances beyond this standard for a long term.

2. The working temperature of this cell phone is 20°C-40°C. Just do not use in ultra-low temperature or high-temperature environment long term.

3. This cell phone can bear fall down from 12 meters heights for many times. But its touch screen maybe damage in the process of falling down by contact with hard objects directly, and avoid slide down in use.

4. To charge the cell phone with the power adapter in line with national standards. Use our company's standard battery please.

5. Do not make the battery contact with metal objects, as that will cause polarity short circuit of the battery and battery damage temporarily or permanently even explosion.

6. Please avoid dust-proof place of the barcode scanner window scratches by sharp objects. Otherwise probably reduce the performance of bar code reading.

Maxxon Technology (Shanghai) INC.
TEL: +86 21 64955599
FAX: +86 21 64955598
Address: Unit 8, 12E Building 11, No. 518, Xinhuan Rd.,
Songjiang District, Shanghai, China