



NF08

Instruction Manual

Table of Contents

INTRODUCTION	1
FUNCTIONAL FEATURES	1
PRODUCT SPECIFICATION LIST.....	2
BATTERY	4
FUNCTIONAL OPERATION.....	5
Add a new tag	5
Find the tag	10
Left behind notification.....	11
Found notification.....	12
Lost Mode - Enable lost mode.....	13
Lost Mode - Pickup use lost mode.....	16
Anti-tracking Reminder.....	19
Remove items.....	22
SAFETY AND HANDLIN.....	24
COMPATIBILITY STATEMENT.....	24
LEGAL NOTICE.....	25
CREDIT LINES.....	25

INTRODUCTION

NF08 allows you to track items almost anywhere, leveraging Apple's Find My network of nearly one billion iOS devices around the world. If the tag is out of range from user's iOS device. The tag will beep instantly alert and remind something left behind,

Users can use them to track your keys, luggage, musical instruments, your pet, or even bicycle. Apple's Find My app can locate users' tagged items and help to get close to them. iPhone 11 or later can get precise directions until users find their lost item.

FUNCTIONAL FEATURES

- * This tag can be used to keep track and prevent users' belonging lost, such as: Pet, mobile phones, keys, wallets, backpacks, luggage suitcase, and umbrella, etc.
- * High buzzer volume can also be recognized the prompt tone even in a noisy environment.
- * Support keys to switch different states according to user demand: pairing broadcasting enabled; serial number search and recovery;
- * Strong battery life and support replaceable CR2032 battery
- * Basic function support: Add device; View items; Find items location; Notice of loss; Remove items; Connection reset.

PRODUCT SPECIFICATION LIST

Category		Specifications
Overall dimensions		42mm*42mm*9.5mm
Installation method		Hanging decorations or built-in
Hardware interface	Power Supply	CR2032 Non rechargeable button battery
	Key	Chip mounted mechanical key
	Buzzer	Piezo Buzzer
	G-sensor	Gravity induction
Software interface	Operating system	iPhone or iPod touch,IOS14.3 Or above iPad iPadOS 14.3 Or above , mac macOS Big Sur11.1 Or above
	Protocol Specification	FMNA spec R1
	APP interface	BLE5.0/ios14.3 Version above
	Other	Firmware update(UARP)

Electrical characteristics	Working voltage	$3V \pm 0.3V$
	Power consumption characteristics	Broadcast current < 16MA Buzzer sounding current < 60MA Quiescent current < 10uA
	BLE Transmitting power	4dBm
	Transmission distance	> 30m
	Working temperature	$-40^{\circ}\text{C} - 85^{\circ}\text{C}$

BATTERY

Install a coin battery (CR2032) before using the device:

- * Remove the battery cover.
- * Insert a battery into the device with the positive side (+) facing up.
- * Place the battery cover on the device until the battery is placed in the right position.
- * Press the battery cover with your thumb until it stops moving.
- * Open the back cover of the battery, press the button next to the battery, and release after hearing the "drip" sound;

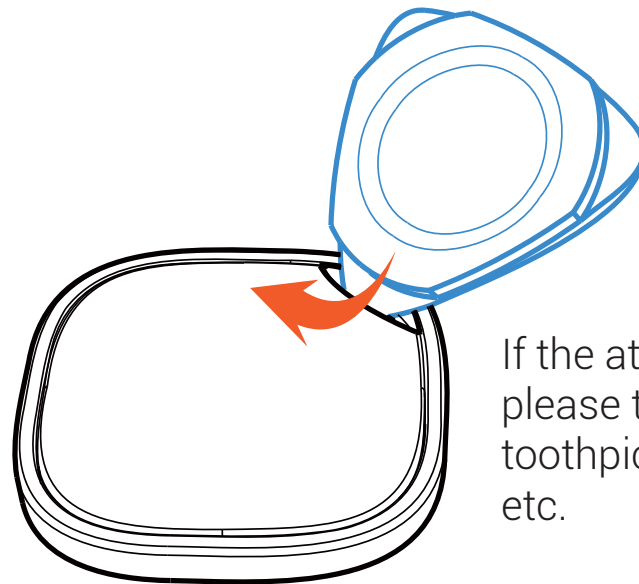

If the attached pry open tool lost, please try to use other tools like toothpicks, paper clips, keys and etc.

FUNCTIONAL OPERATION

Add a new tag

Open the back cover of the battery, press the button next to the battery, and release after hearing the "drip" sound.

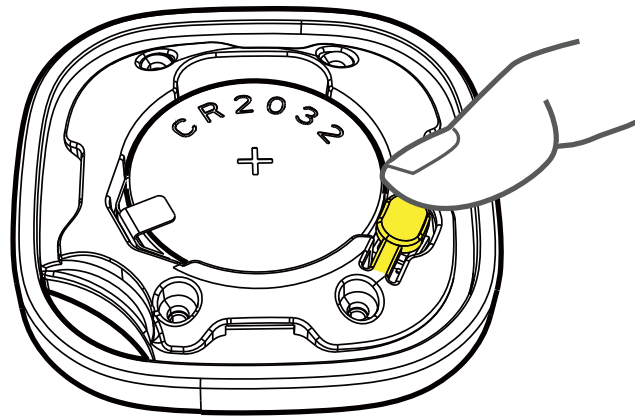

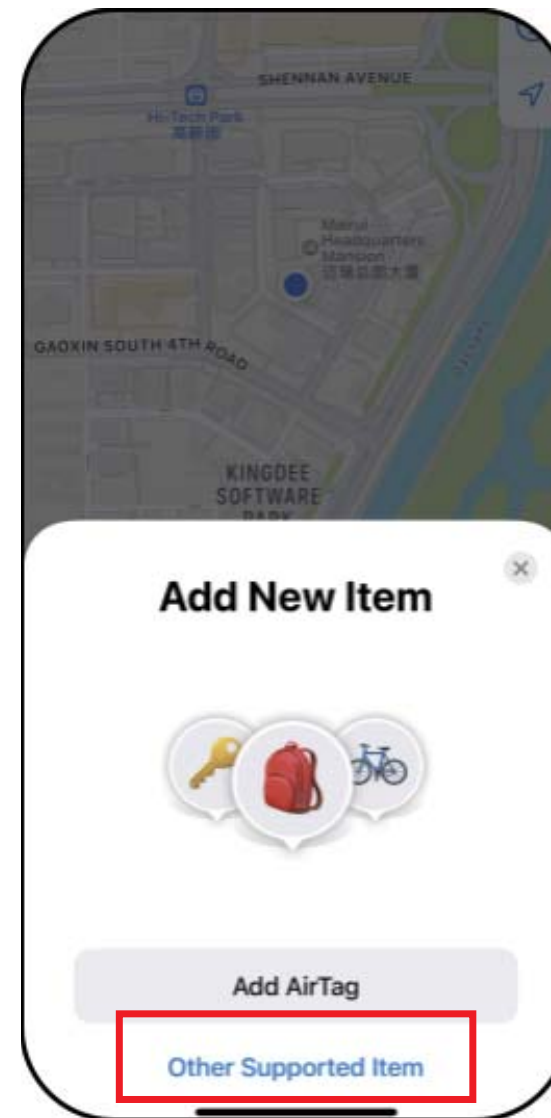

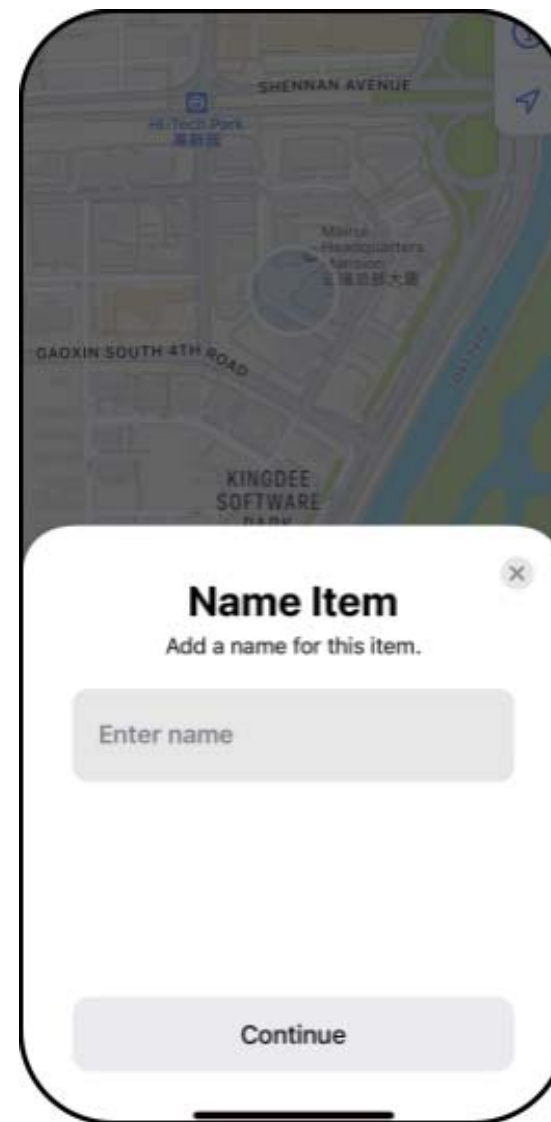
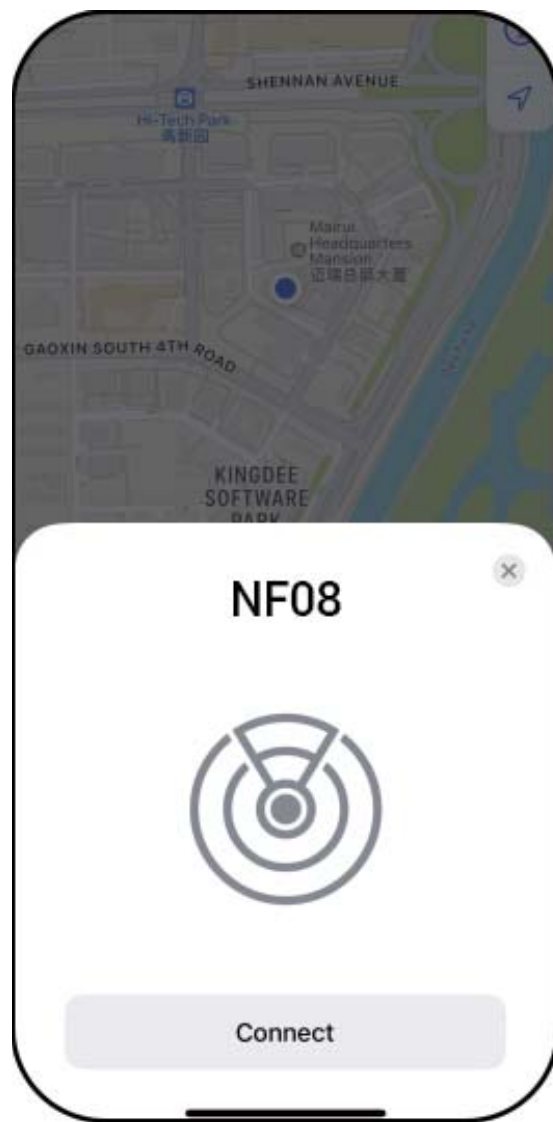

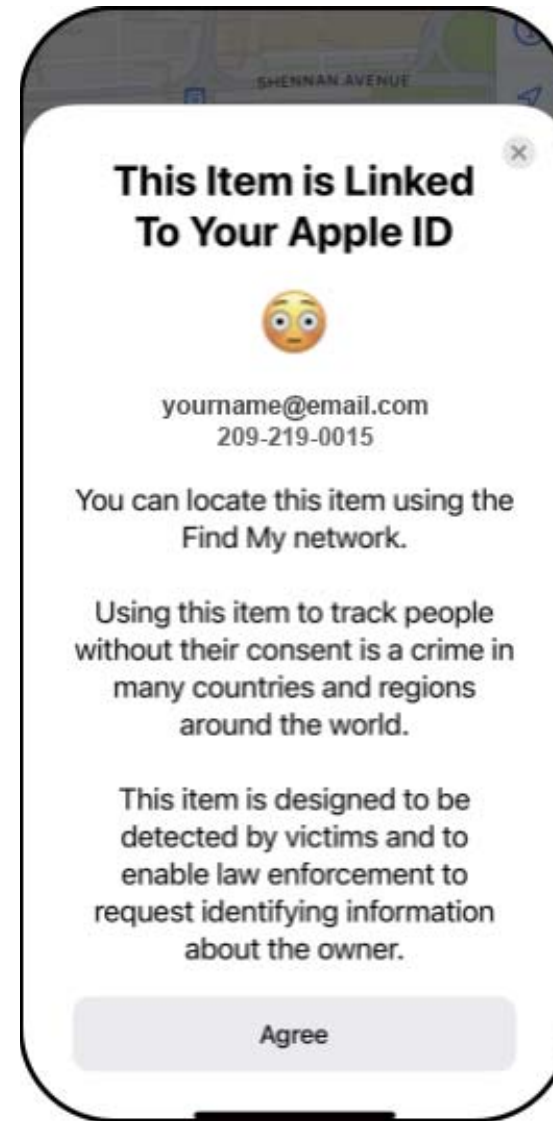
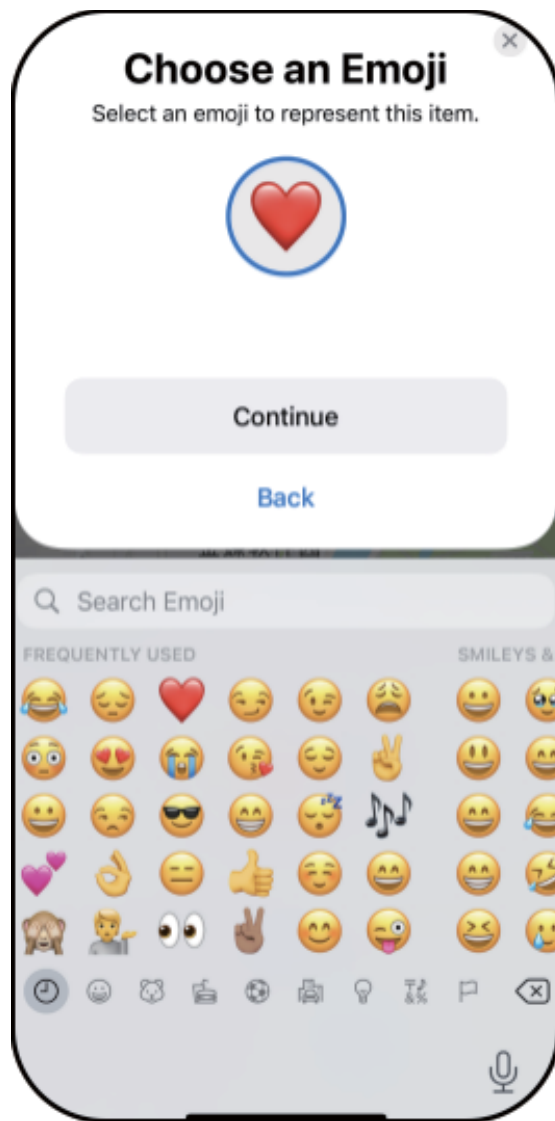

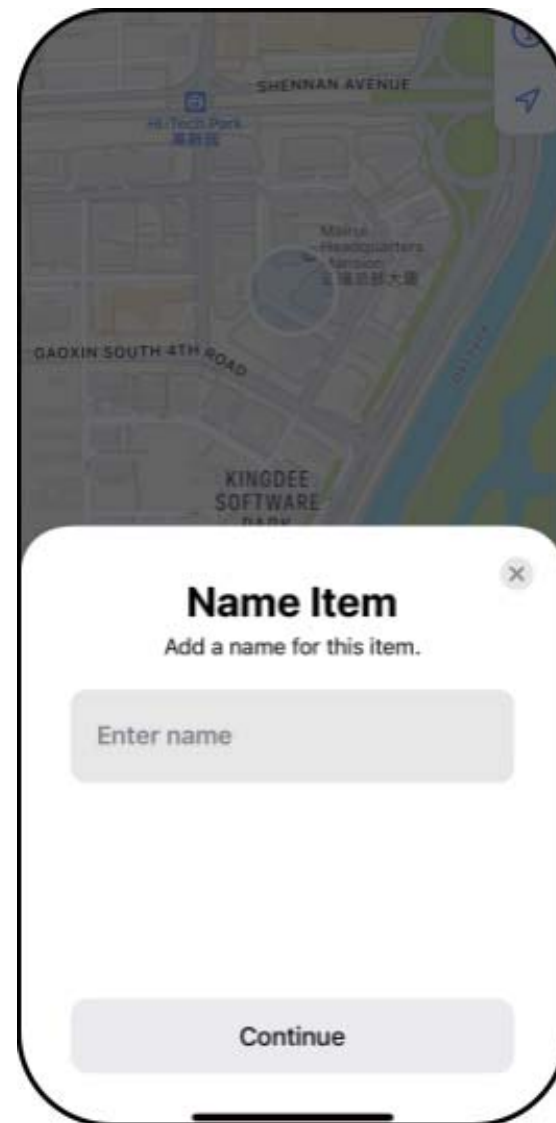
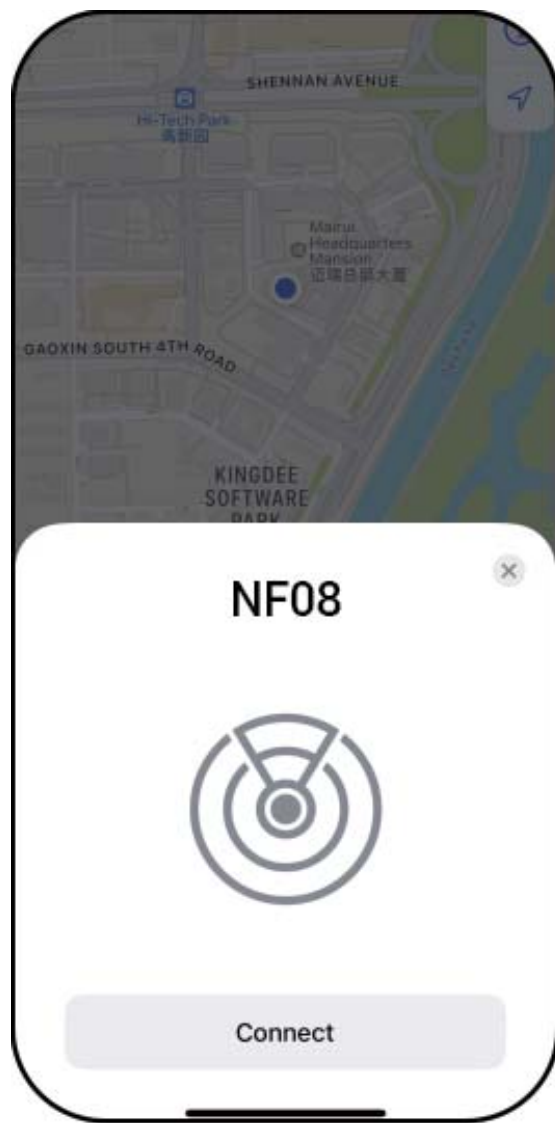

Find the tag

When you like to find the item, just click "Play sound" and the device will beep a 10-second sound.

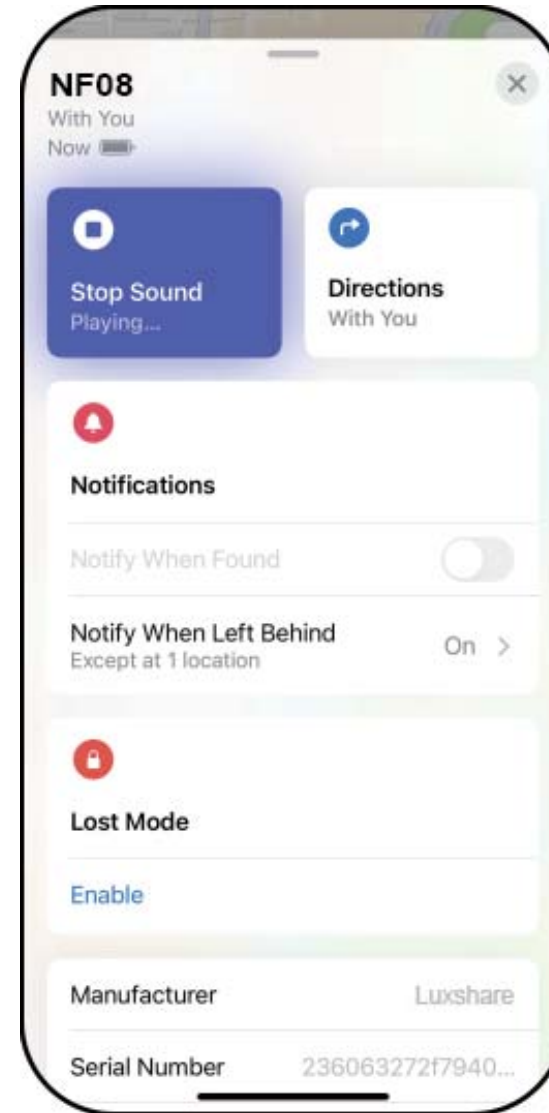
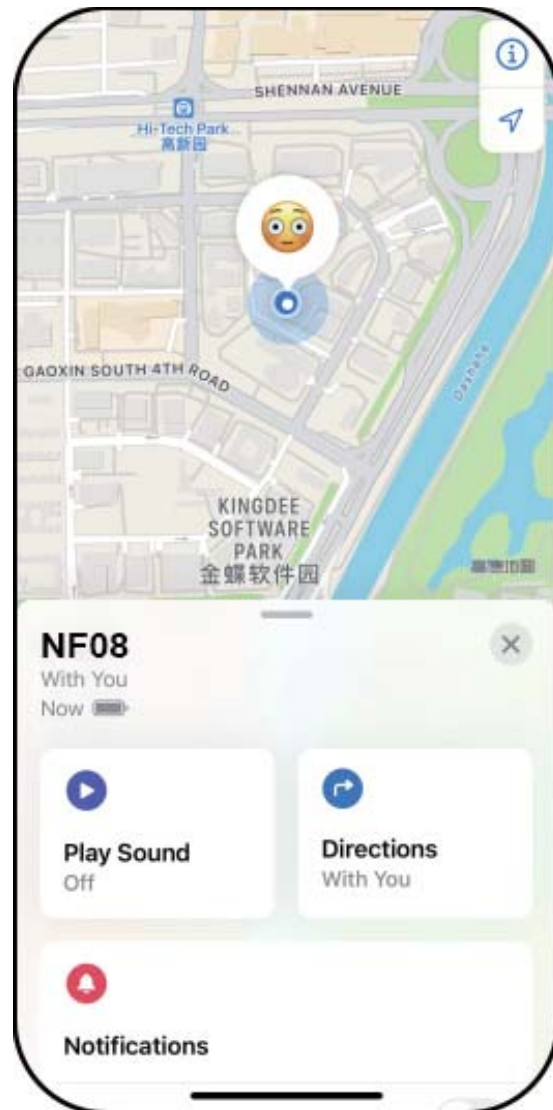

Left behind notification

When the device is left from a specified area, the Find My App will be notified that the device is left behind.



Found notification

The tag has been disconnected from the paired phone. When the tag is nearby the phone, the phone connects automatically to the tag and user will receive an instant notification that the item has been found.

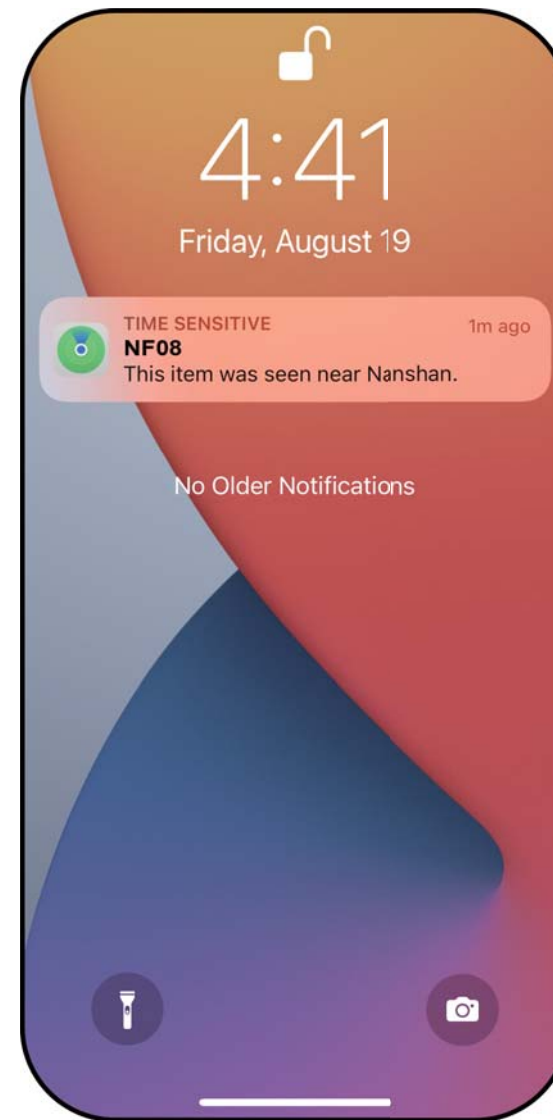

Lost Mode - Enable lost mode

When the item has been lost, to open the lost mode, first open the Find My APP and click the item after connecting it. Locate the lost mode and click "Enable".

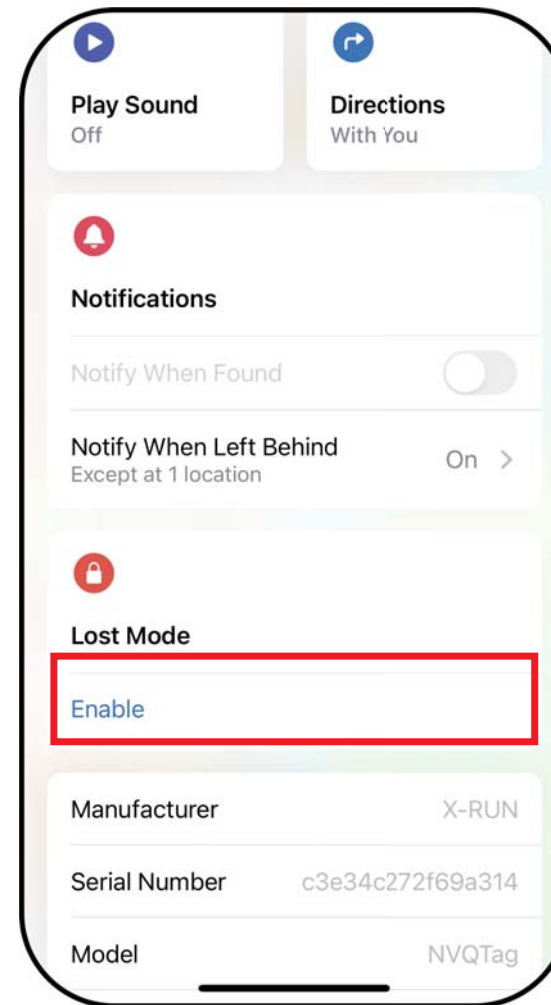
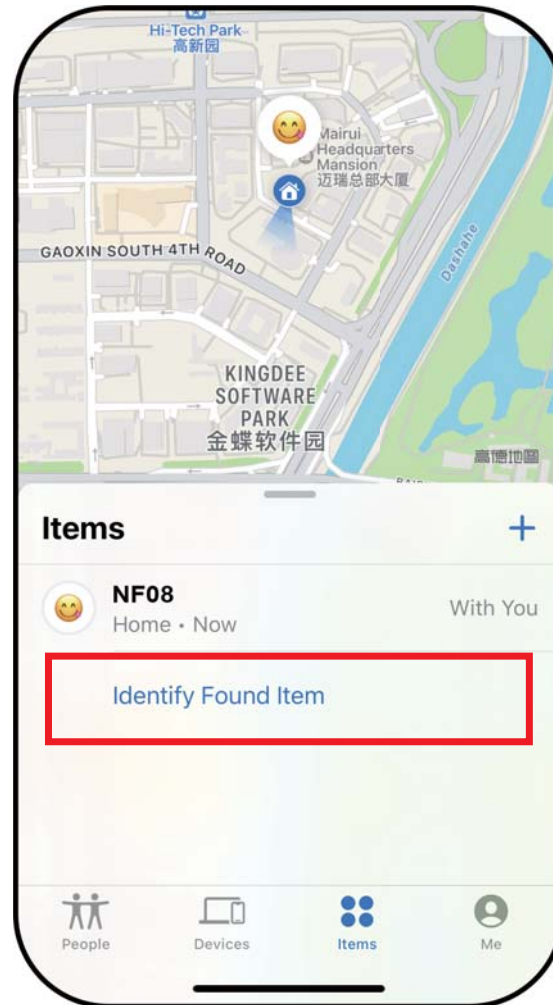

Click "Continue"; Enter your phone number and click "Next". Turn on the "Notify When Found" switch.

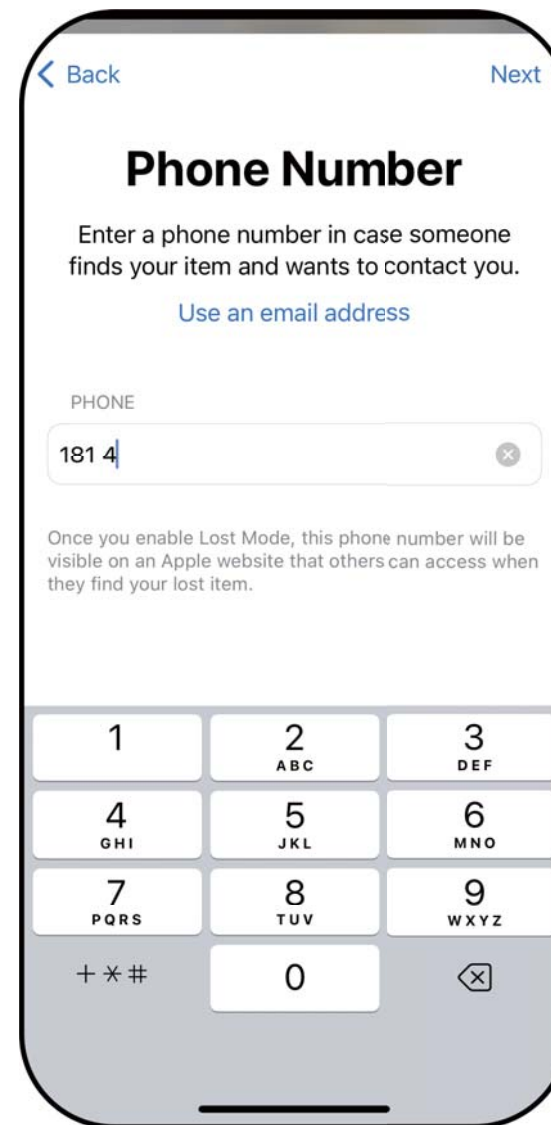
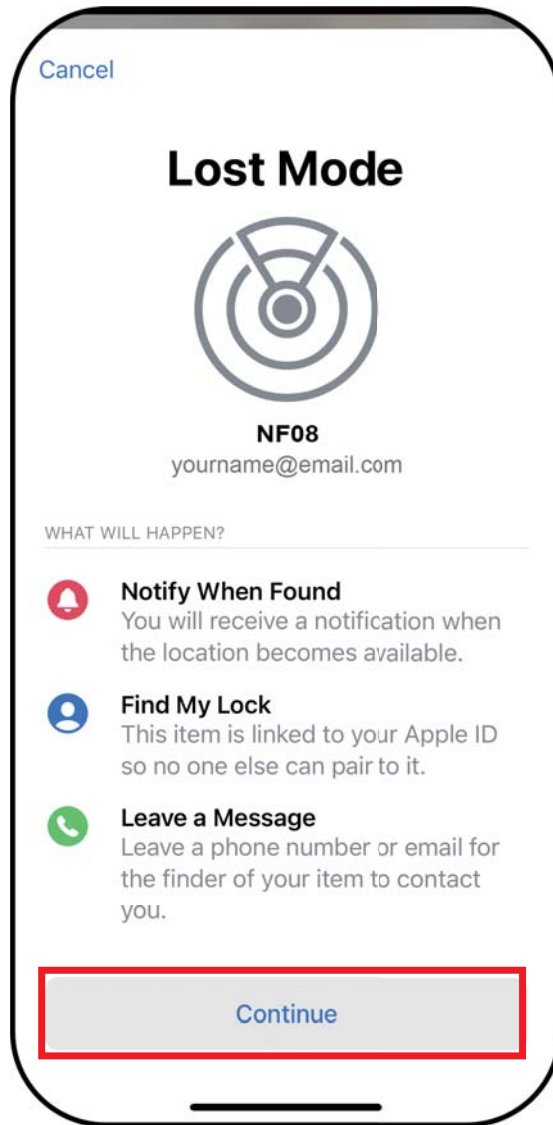

Return to the Enable loss mode page and check that the loss mode is enabled successfully.

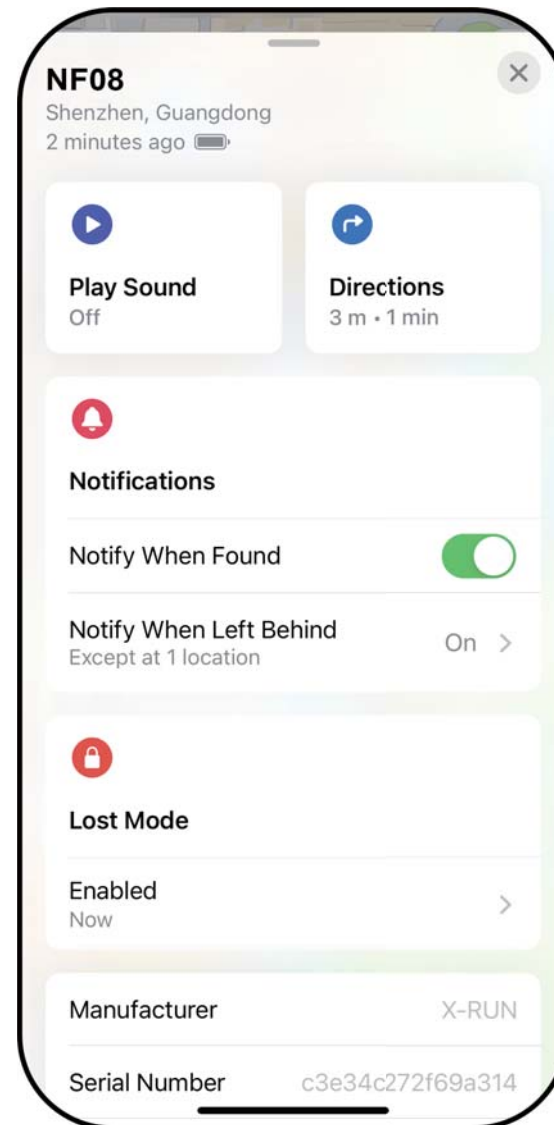
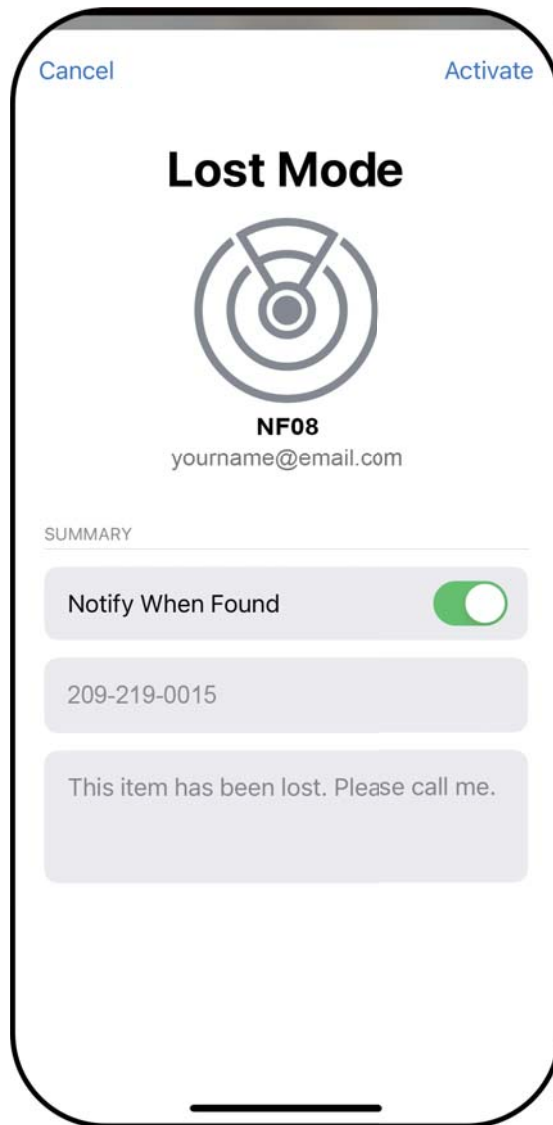

Lost Mode

- Pickup use lost mode

When the lost item is picked up, open the mode of identifying the lost item.

1. First open the search APP and click "Identify Found Item"

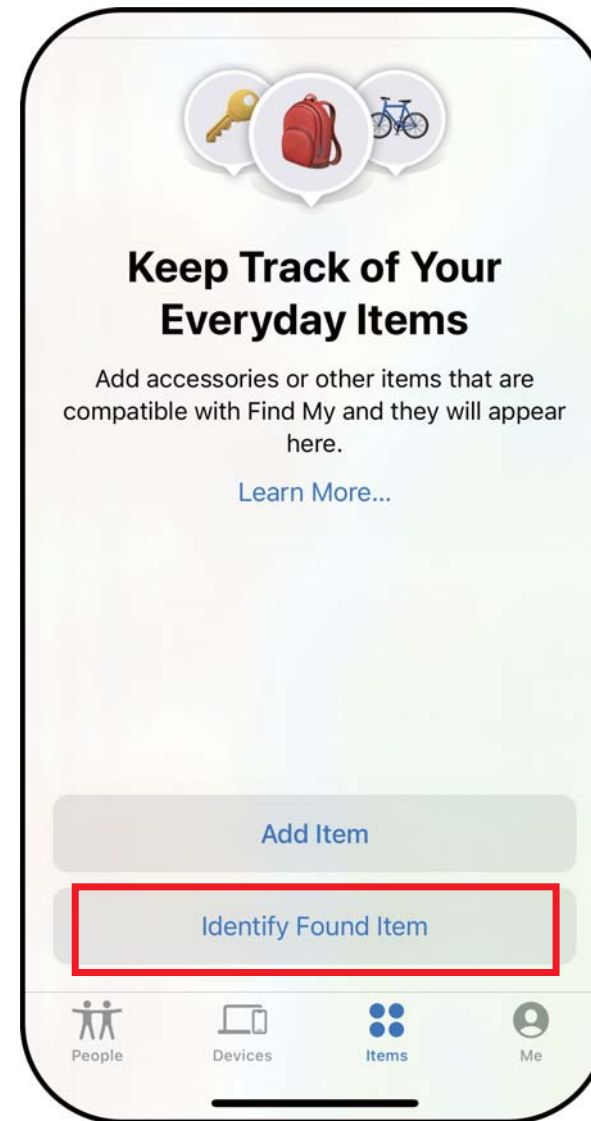

2. Click "Identified Item" and click "Continue".

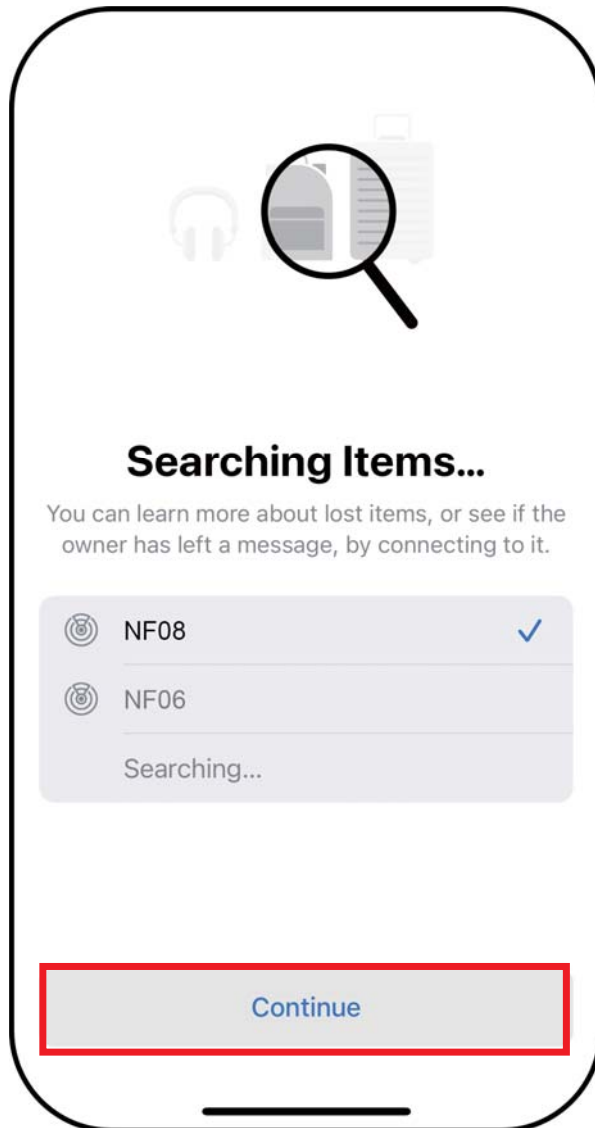

3. Open the back cover of the item and press the button next to the battery. When you hear a beep, release the button.

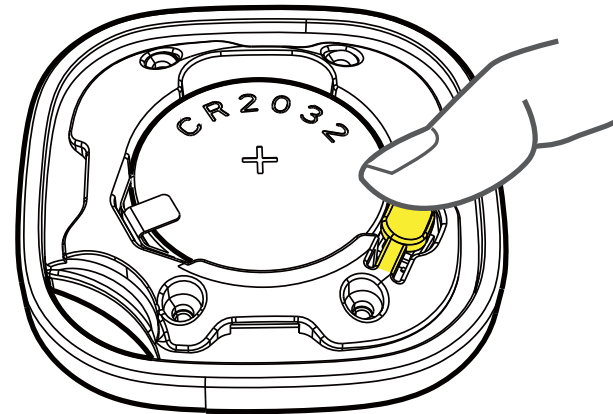

4. After waiting for about 1 minute, click "Continue on the website" on the APP.

Get contact information for the missing owner.

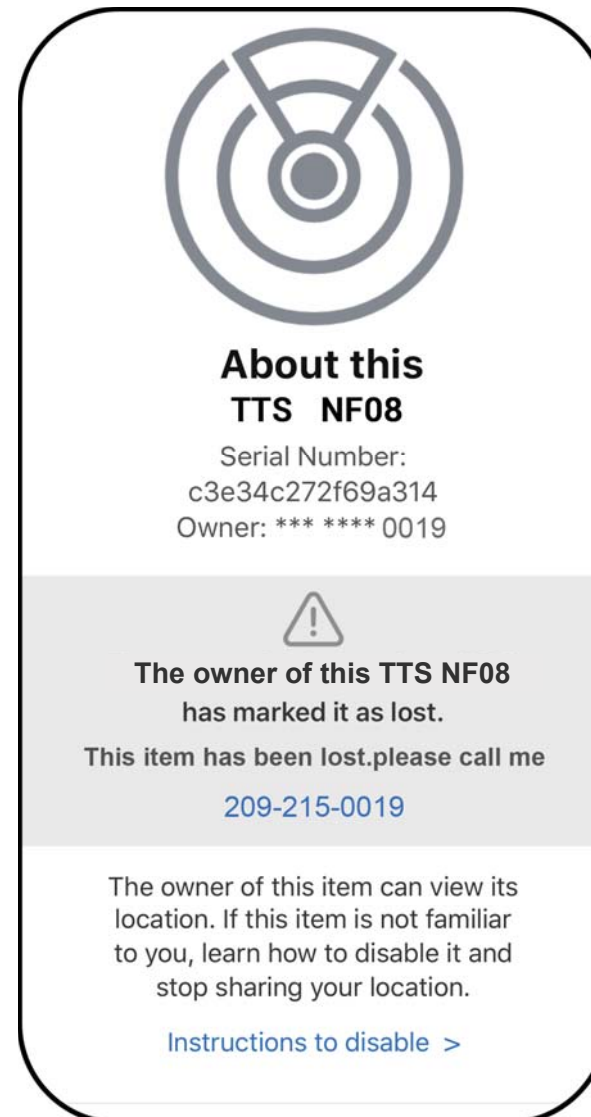
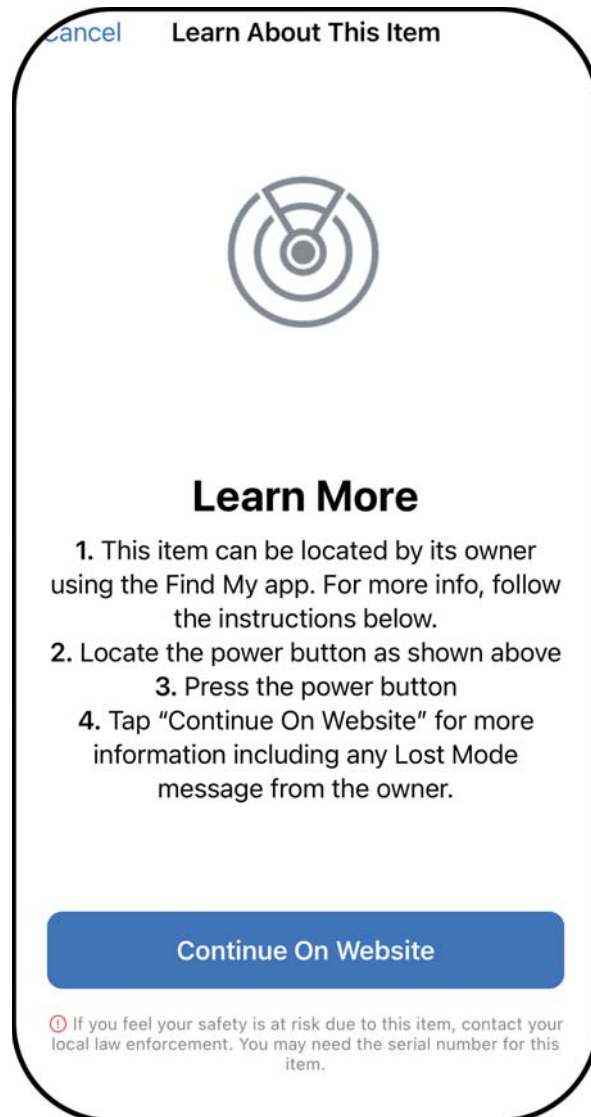

Anti-tracking Reminder

When the tag is disconnected from the paired phone and the tag has been following the tracked Apple device for more than two hours, the tracked Apple device will receive an anti-tracking reminder from his Find My App. User can check the location of the tag by playing the sound and disable sharing the location.

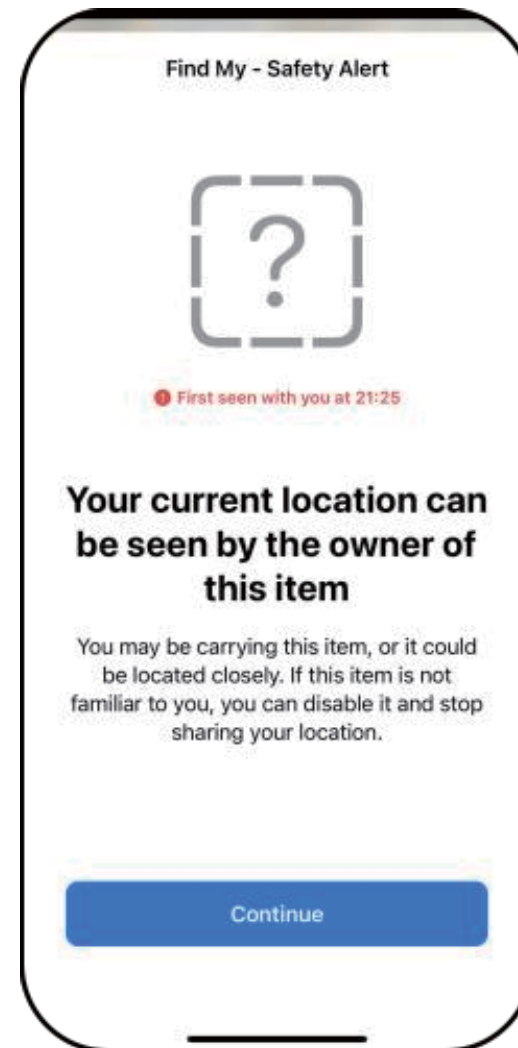
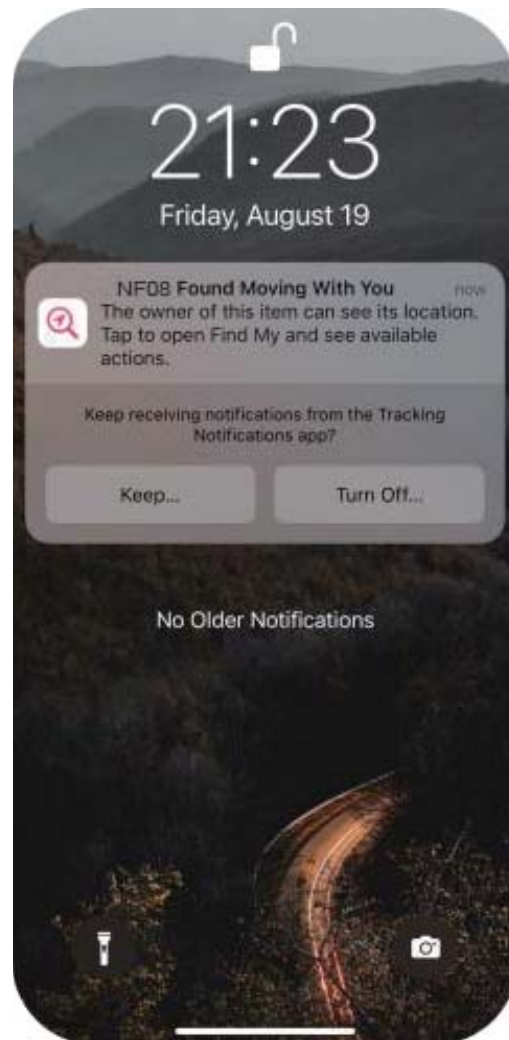

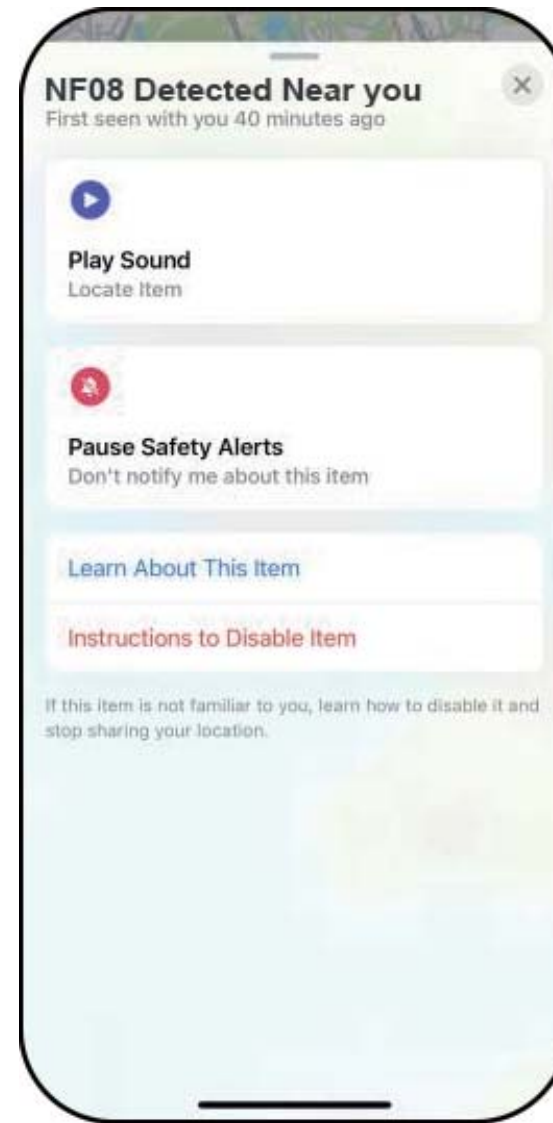
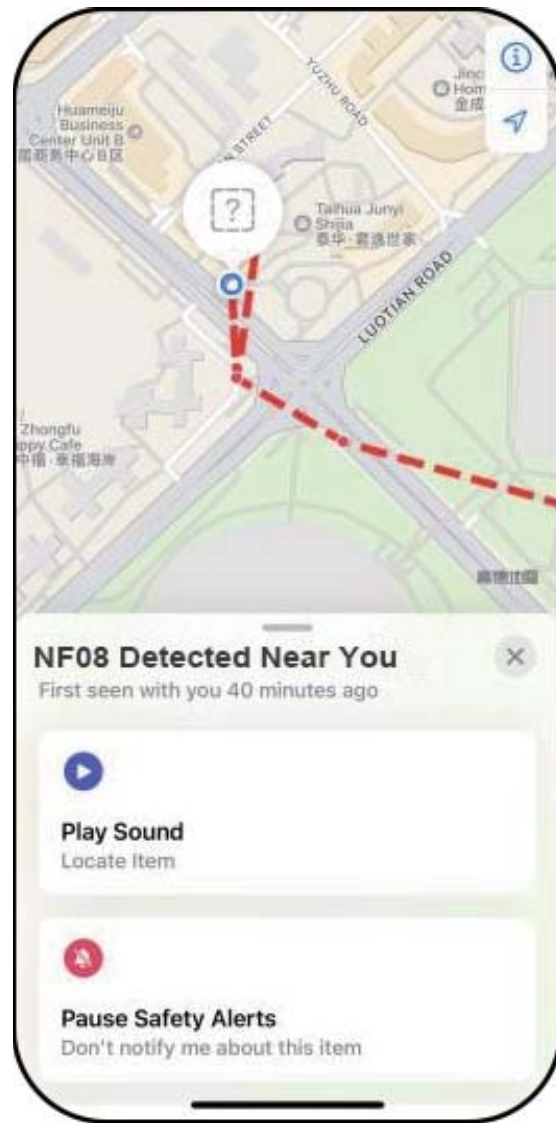

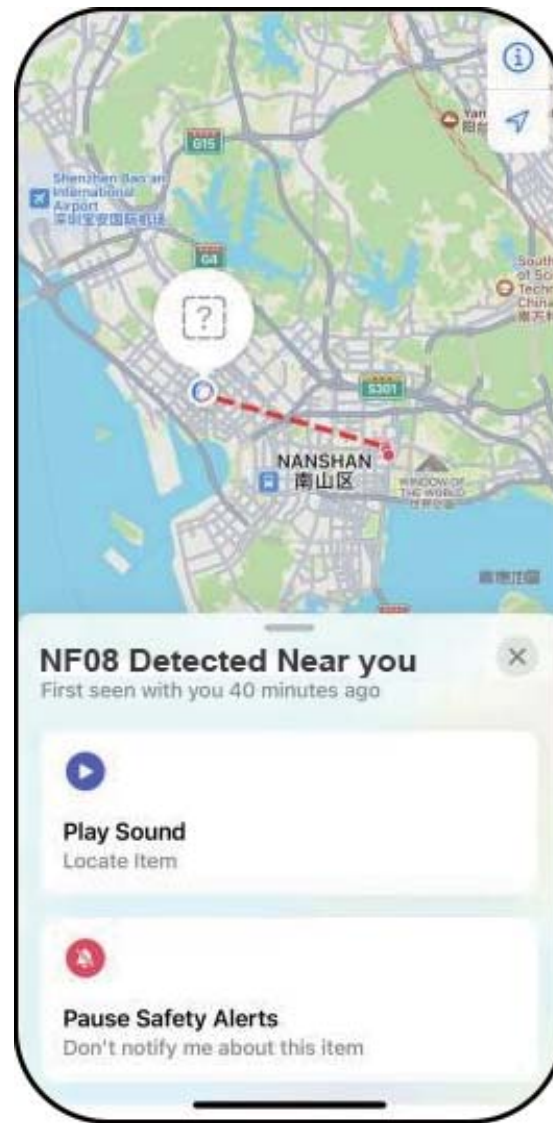

Remove items

*** Clear pairing on the device**

Long press the button; when three beeps sound heard, continue to hold and press until a loud beep sound is heard. The tag will be restored back to factory settings which will clear tag pairing information.

Then the tag can be found again, but it can't be added to the new phone until the original Apple device removes the tag.

*** Remove the device from the Apple device**

To remove a tag from the Find My APP, the tag must be connected to Apple device in order to synchronously clear the pairing information from the device. If not connected, the pairing information is still stored on the tag. The tag is not able to broadcast the pairing information and cannot be found and added to the new Apple device again.

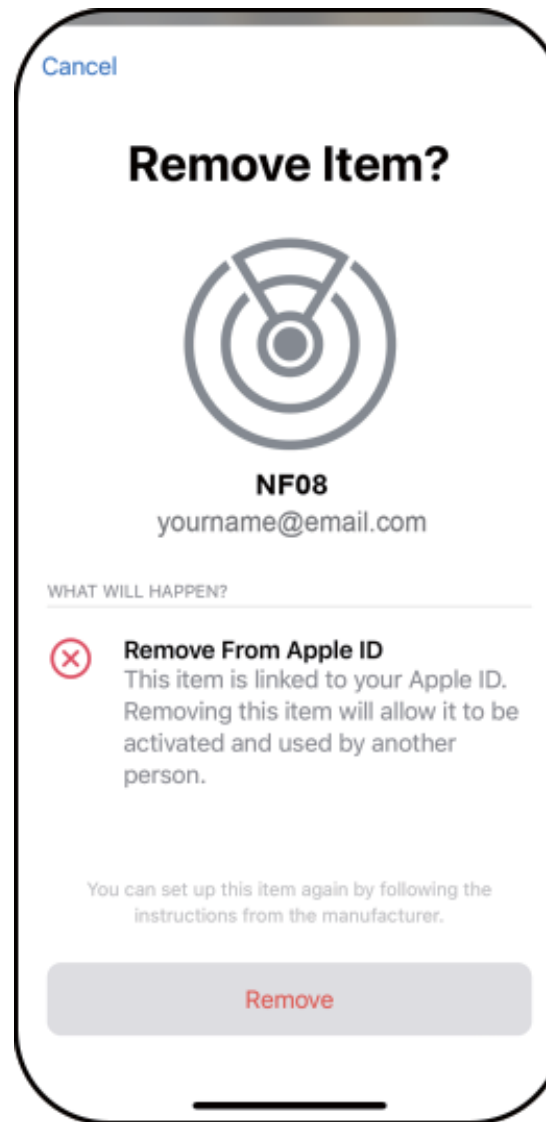

SAFETY AND HANDLIN

*** Important safety information**

NF08 contains sensitive electronic components and needs to handle with care. The battery can be damaged if dropped, burned, punctured, crushed, disassembled. It can cause human injury if it is exposed to excessive heat or liquid or the environments with high concentrations of industrial chemicals. Don't use the damaged NF08.

*** Choking hazard**

The battery may present a choking hazard or cause other injury to kids. Please keep these items away from kids.

COMPATIBILITY STATEMENT

To use the Apple Find My app to locate this item, the latest version of iOS, iPadOS, or macOS is recommended.

LEGAL NOTICE

Use of the Works with Apple badge means that a product has been designed to work specifically with the technology identified in the badge and has been certified by the product manufacturer to meet Apple Find My network product specifications and requirements. Apple is not responsible for the operation of this device or use of this product or its compliance with safety and regulatory standards.

CREDIT LINES

Apple, Apple Watch, iPad, iPadOS, iPod touch, Mac, and macOS are trademarks of Apple Inc., registered in the U.S. and other countries. IOS is a trademark or registered trademark of Cisco in the U.S. and other countries and is used under license.

FCC ID: 2ADXE-NF08

NOTE: This equipment has been tested and found to comply with the limits for Class B digital devices, in accordance with section 15 of the FCC Rules. These limits are designed to provide reasonable protection against harmful interference in a residential installation. This equipment generates uses and can radiate radio frequency energy and, if not installed and used in accordance with the instructions, may cause harmful interference to radio communications. However, there is no guarantee that interference will not occur in a particular installation. If this equipment does cause harmful interference to radio or television reception, which can be determined by turning the equipment off and on, the user is encouraged to try to correct the interference by one or more of the following measures:

- Reorient or relocate the receiving antenna.
- Increase the separation between the equipment and receiver.
- Connect the equipment into an outlet on a circuit different from that to which the receiver is connected.
- Consult the dealer or an experienced radio/TV technician for help

Changes or modifications not expressly approved by the party responsible for compliance could void the user's authority to operate the equipment.

This device complies with Part 15 of the FCC Rules. Operation is subject to the following two conditions:

- (1) this device may not cause harmful interference, and
- (2) this device must accept any interference received, including interference that may cause undesired operation.