

SmartUFO Visible Safety!



1 Download Eachpal APP

1. Scan the QR code below to download.



2. Go to Eachpal.com to download.

3. Go to App or Android Store and search the keyword "Eachpal" to download.

2 Install Eachpal APP and Register Account

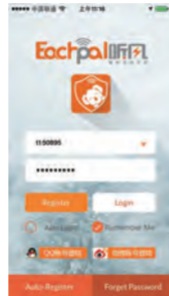

* It's suggested to register with email or Auto-Register, the original password of Auto-Register account is 666666.

3 Activate and Bind SmartUFO

1. Press on the top of SmartUFO for five seconds to power on the device.



2. Log in and click on the sign "+" on the upper right corner, click on "Binding Device" and input the number of inserted SIM card then click "O".

3. The cellphone shows do you want to send invitation message to register this device, click "OK".



4. When the red light of SmartUFO starts flickering, click the top of SmartUFO for 5 times continuously and rapidly. Device gets successfully bound when

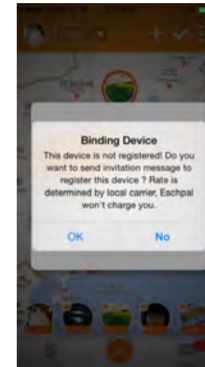

Contact Us



4 Q&A

Q:Why do I fail to power on SmartUFO?

A:Might the battery is low, please charge it and try again.

Q:Why do I fail to send a message to activate the device?

A:Please re-start your cellphone and try again.

Q:How to power off the device?

A:Press on the top of SmartUFO for five seconds, when the red and blue light is flickering, click the top of device for 5 times continuously and rapidly then it shuts down.

Q:Does SmartUFO support all SIM card?

A:All GSM card is supported but CDMA.

Accessories

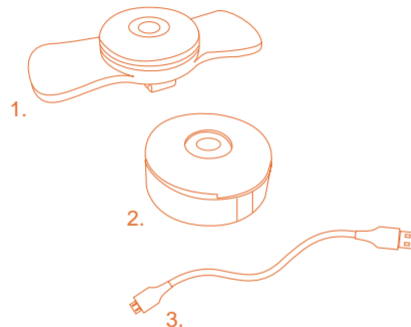

Accessories :

1.SmartUFO Device

2.Charging Base

3.USB Cable

Battery Charging



Press the side buttons of charging base as blew picture, open the top cover, put the device into it, then closed the cover and plug the USB cable and connect with the PC to charge the battery.

SOS Alert



Click the top of SmartUFO for three times continuously and rapidly would trigger SOS alert immediately, the current location and 10 seconds voice-record would be pushed to SOS contacts of Eachpal APP.

Low Battery Alert



When the device is low battery, the red light would start flickering and alert information would be pushed also, please charge the device timely.

Notice

SmartUFO works in rainy day but please don't immerse it in water and not be carried into Sauna room.

* SmartUFO uses Wi-Fi/GSM/GPRS positioning technology but it won't connect any Wi-Fi device.

FCC RF Exposure Information and Statement

The SAR limit of USA (FCC) is 1.6 W/kg averaged over one gram of tissue.
Device types: SmartUFO(FCC ID: 2ADMG-SMARTUFO) has also been tested against this SAR limit. The highest SAR value reported under this standard during product certification for worn on the body is 1.208W/kg.

This device was tested for typical body-worn operations with the back of the handset kept 0.0 cm from the body. To maintain compliance with FCC RF exposure requirements, use accessories that maintain a 0.0 cm separation distance between the user's body and the back of the handset. The use of belt clips, holsters and similar accessories should not contain metallic components in its assembly. The use of accessories that do not satisfy these requirements may not comply with FCC RF exposure requirements, and should be avoided.

This device complies with part 15 of the FCC rules. Operation is subject to the following two conditions: (1) this device may not cause harmful interference, and (2) this device must accept any interference received, including interference that may cause undesired operation.

NOTE: The manufacturer is not responsible for any radio or TV interference caused by unauthorized modifications to this equipment. Such modifications could void the user's authority to operate the equipment.

NOTE: This equipment has been tested and found to comply with the limits for a Class B digital device, pursuant to part 15 of the FCC Rules. These limits are designed to provide reasonable protection against harmful interference in a residential installation. This equipment generates uses and can radiate radio frequency energy and, if not installed and used in accordance with the instructions, may cause harmful interference to radio communications. However, there is no guarantee that interference will not occur in a particular installation.

If this equipment does cause harmful interference to radio or television reception, which can be determined by turning the equipment off and on, the user is encouraged to try to correct the interference by one or more of the following measures:

- Reorient or relocate the receiving antenna.
- Increase the separation between the equipment and receiver.
- Connect the equipment into an outlet on a circuit different from that to which the receiver is connected.
- Consult the dealer or an experienced radio/TV technician for help.