

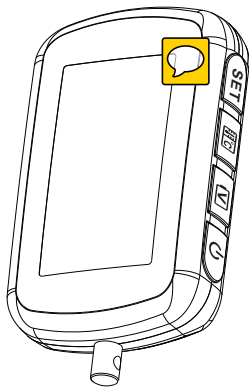

TPMS



CMT-M10E USER'S MANUAL

V7.03.21

封面157g过光胶, 128g双铜纸, 四色印刷, 打码钉

目錄

Safety Precautions	2
Packing List	3
Monitor Power On	4
External Sensor Installation	5
Driving Checking	6
LCD Display Description	7
Monitor Features	8
Monitor Buttons Instruction	9
Enter Setting Mode	10
Exit Setting Mode	11
Pressure Unit Setting	12
Temperature Unit Setting	13
Code Learning	14
High Temperature Alarm Value Setting (Factory Default 65 °C)	16
Front Tire High Pressure Alarm Value Setting (Factory Default 46 Psi)	17
Front Tire Low Pressure Alarm Value Setting (Factory Default 26 Psi)	18
Rear Tire High Pressure Alarm Value Setting (Factory Default 46 Psi)	19
Rear Tire Low Pressure Alarm Value Setting (Factory Default 26 Psi)	20
External Sensor Exploded View	21
External Sensor Battery Replacement	22
Top Reasons of Leaking in Nonstandard Tire Valves	23
FAQ	24

Safety Precautions

1. Tire safety can not only rely on this system, the motorcycle user should inspect the tire regularly in case of nail sticking or any breaking.
2. Please park the vehicle and check as soon as the system starts warning.
3. This system can not predict the suddenly damage by outside force.
4. Please don't operate this system when driving. The monitor can only work correctly when power is on.
5. The sensor battery lifetime is related to vehicle driving mileage, and it can be shortened when working under -20℃ temperature.
6. The tire temperature will get higher when driving, and the tire pressure will be 1- 4 Psi higher accordingly.
7. Please do not clean or soak the sensor by water or other chemical liquid.
8. The suggested tire pressure and the maximum pressure values are marked in side of tire or in the motorcycle manual, please adjust the right alarm value after confirm with the tire or motorcycle factory or the technician.
9. The suggested service life of tire is 3 to 4 years, for avoiding of any breaking when driving in high speed, please change to metal valve if the original is a rubber one when change the tire.

The applicable model for this system is motorcycle with 2 or 3 tires.



It is recommend that install monitor and make it power on before sensors.



The monitor and sensors are already matched with each other before leaving the factory, no need to do code learning again after installation.

Packing List

Monitor

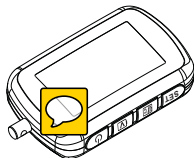

Monitor Cover

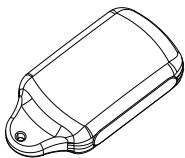

L shape Metal Valve 2pcs

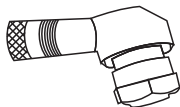

External Sensor 2pcs

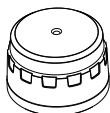

(the user should buy 1 more if the motorcycle is with 3 tires)

CR 1632 Battery 2pcs



AAA Battery



Combination Wrench



Hexagonal Nut 3pcs



(1pc for backup)

Ring Needle



(for replacing the silicon seal ring)

Silicon Seal Ring 2pcs
(all for backup)



If the silicon seal ring is damaged, please replace it by the backup ring in case of leaking.

Key Ring



User's Manual

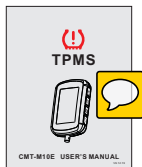

Monitor Power On

- 1** Install the AAA battery in monitor, and power on automatically.

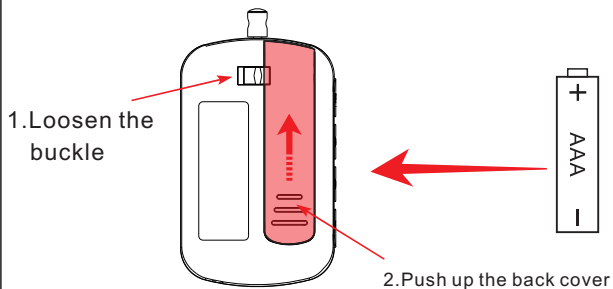

- 2** Install the sensors right after the monitor is power on.

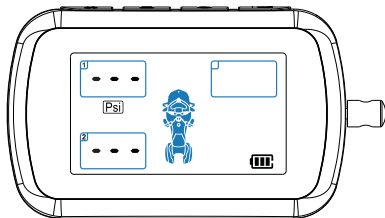

* The factory default is 2 sensors mode, the user should switch it to 3 sensors mode if the motorcycle is with 3 tires before install all the sensors.

External Sensor Installation

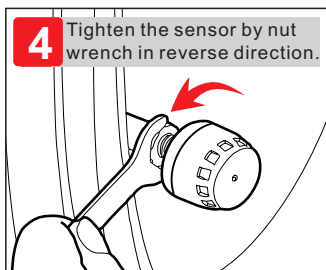
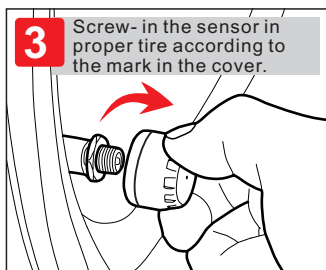
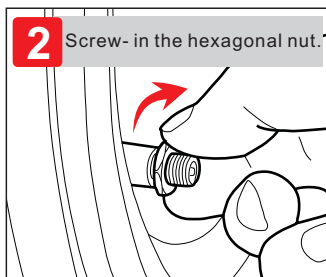
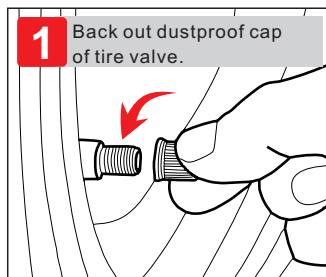

- 1: Front-left tire
- 2: Rear tire
- 3: Front-right tire

Note:

Please clean the surface of tire valve before install the sensor. The hexagonal nut is used for fixing the sensor and avoid of stealing, please loosen it with the special wrench before inflating.

Driving Checking

- 1** When the driving speed is up to 10km/h, the tire data will be updated automatically.

>10km/h

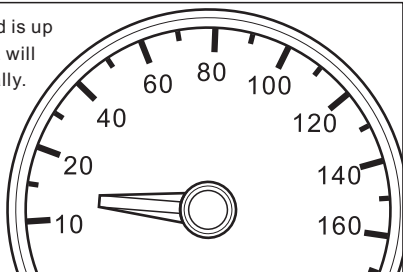

- 2** If all the tire pressure data is shown, it means the system installed and working properly.

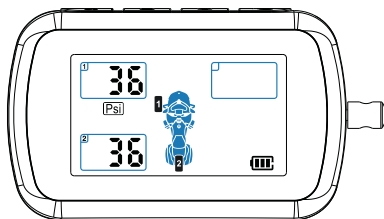

LCD Display Description

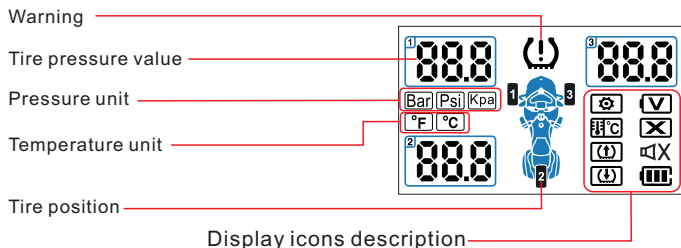

	Code learning of sensor and monitor
	High Temperature Warning (show icon when tire temperature is out of the set range)
	High Pressure Warning (show icon when tire pressure is higher than the set value)
	Low Pressure Warning (show icon when tire pressure is lower than the set value)
	Low Power Warning (show icon when the sensor battery is run out of power)
	Sensor Disabled (show icon when any of the sensors is disabled)
	Mute Mode (Backlight with some icons keep flashing and monitor keep vibrating)
	Battery icon (show monitor battery power)

LCD Display Description

Driving Display

When the driving speed is up to 10km/h, the tire data will be updated automatically.

Sensor Disabled

Monitor Features

High Temperature Warning



Bi-Bi-

The tire temperature is higher than 65°C.
Temperature display range:-40°C ~ +90°C

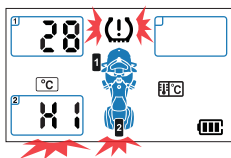

Sensor Battery Run Out of Power



Bi--Bi--

External sensor battery lifetime is about 1 year.

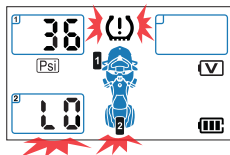

Abnormal Pressure Warning



Above 46 Psi: Bi-Bi-Bi-Bi-
Below 26 Psi: Bi-Bi-Bi-

The pressure is out of normal range 26- 46Psi
(Factory Default Pressure Range)

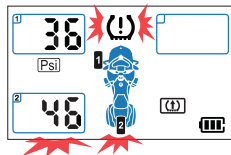
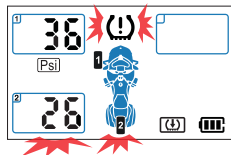

The maximum pressure of 10 to 15 inch tire is about 41Psi, the user should inflate the tire according to motorcycle manual, and adjust the right alarm value in monitor.

The suggested front tire pressure: 29Psi ~25Psi (High alarm value 35Psi, low alarm value 21Psi)

The suggested rear tire pressure: 36Psi ~31Psi (High alarm value 39Psi, low alarm value 25Psi)

Above is only for reference, please adjust according to the actual conditions.

Monitor Buttons Instruction

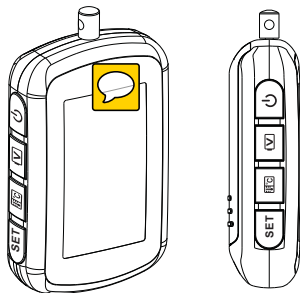





Monitor Technical Parameters

Input Voltage: 1.5V

Operating Current: < 0.6mA

Operating Temperature: - 4 0℃ ~+ 8 5℃

Operating Humidity: 5 ~ 98%

-  Power button
-  Battery power query button / forward button
-  Temperature query button / backward button
-  SET SET button / confirm button

Buttons instruction



Short press  : turn on backlight.

Under non setting mode

Short press  : switch to show pressure value.

Short press  : switch to show temperature value.

Short press  : switch to show sensor battery power value.

Short press  +  : switch sound / mute mode (monitor vibrate twice when enter mute mode and beep once when exit), factory default is in sound mode.

Long press  +  : switch tire numbers 2 or 3, factory default is 2 tires.

Long press  +  until beep twice: restore to factory settings.

Long press  : turn on / off the monitor.

Under setting mode

Short press  : enter the current setting item or confirm and exit. (except code learning mode)

Short press  : backward to last one

Short press  : forward to next one

Enter Setting Mode

- 1** Under non setting mode, press SET button and hold on until beep once to enter setting mode

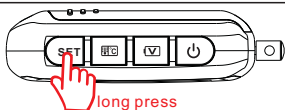

- 2** Switch by pressing backward / forward buttons circularly as follow:

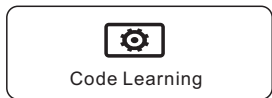
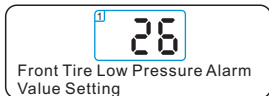
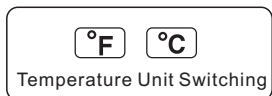
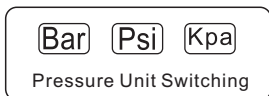
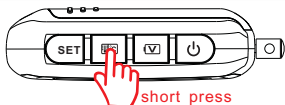

Exit Setting Mode

- 1** Under any mode, press SET button and hold on until beep 4 times, confirm the previous setting and exit.

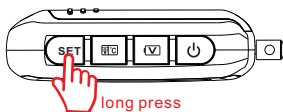

- 2** Under any mode, if there is no operation within 20 seconds the system will exit the current mode automatically with confirming the previous setting (except code learning mode).

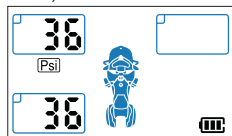
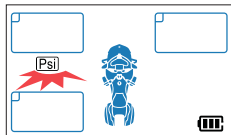

- 3** Under code learning mode:

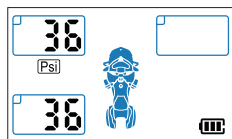
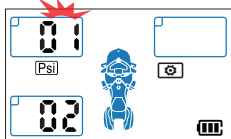

- If there is no operation and code learning signal within 3 minutes, the system will confirm and exit automatically.

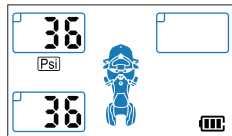
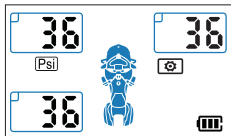

- If there is no operation and code learning signal after 20 seconds when the third sensor is learned, the system will confirm and exit automatically.

Pressure Unit Setting

1. Choose pressure unit setting mode, the display show pressure unit Bar, Psi and Kpa.

* The factory default pressure unit is Psi.

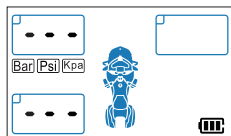

2. Press SET button shortly until beep once and then release to enter pressure unit setting, the current unit icon flash.

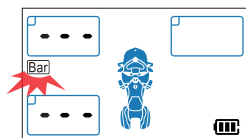
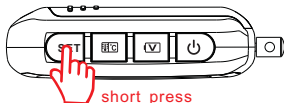

3. Press forward / backward button to switch the pressure unit.

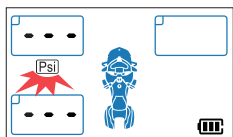

4. Press SET button shortly until beep once and then release to confirm the setting and exit the current mode.

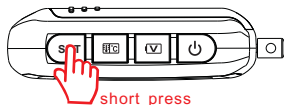

Temperature Unit Setting

1. Choose temperature unit setting mode, the display show temperature unit $^{\circ}\text{C}$ and $^{\circ}\text{F}$.

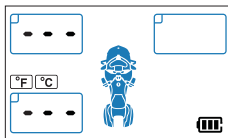

2. Press SET button shortly until beep once and then release to enter temperature unit setting, the current unit icon flash.

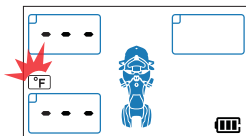
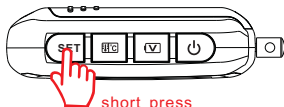

3. Press forward / backward to switch the temperature unit.

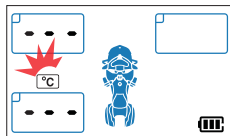
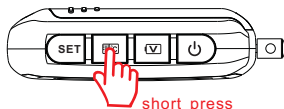

4. Press SET button shortly until beep once and then release to confirm the setting and exit the current mode.

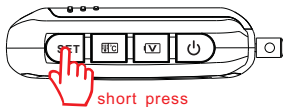

Code Learning

* Please switch 2 or 3 tires mode in monitor accordingly before code learning. (The factory default is 2 tires.)

1. Choose code learning mode, the display show icon .

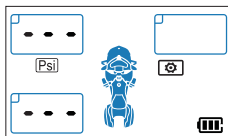

2. Press SET button shortly until beep once and then release, the display show "01-02-03" and 01 icon start to flash, it means the system enter the code learning mode.

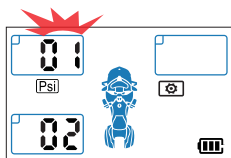
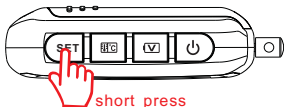

Code Learning

3. Install the sensor and the display will show current tire pressure and temperature.

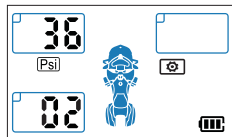

4. Press forward / backward button to choose the tire position, the current value icon flash.

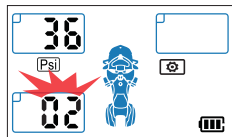
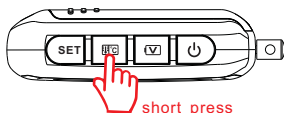

5. Install the current position sensor and the display will show the tire pressure and temperature.

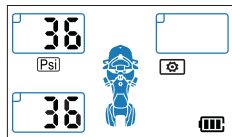

High Temperature Alarm Value Setting (Factory Default 65°C)

1. Choose high temperature alarm value setting, the display show icon .

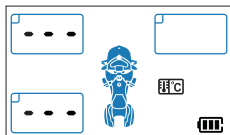

2. Press SET button shortly until beep once and then release to enter high temperature alarm value setting, the current value icon flash.

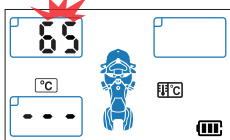
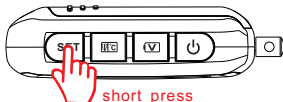

3. Press forward / backward button to adjust the value, by each press the value increase / decrease 1°C and will be circular between 60°C and 90°C.

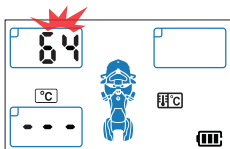
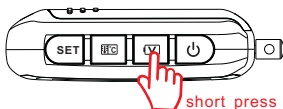

4. Press SET button shortly until beep once and then release to confirm the setting and exit the current mode.

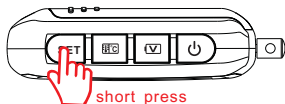

Front Tire High Pressure Alarm Value Setting (Factory Default 46 Psi)

1. Choose high pressure alarm value setting, the display show icon  and the current value on top-left.

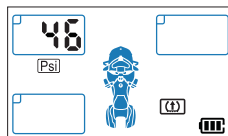

2. Press SET button shortly until beep once and then release to enter high pressure alarm value setting, the current value icon flash.

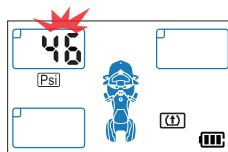
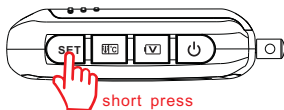

3. Press forward / backward button to adjust the value, by each press the value increase / decrease 1Psi and will be cycled.

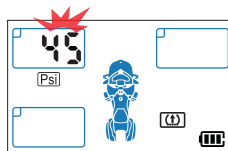
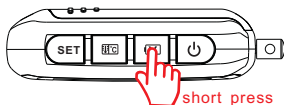

4. Press SET button shortly until beep once and then release to confirm the setting and exit the current mode.

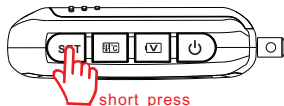

Front Tire Low Pressure Alarm Value Setting (Factory Default 26 Psi)

1. Choose low pressure alarm value setting, the display show icon  and the current value on top-left.

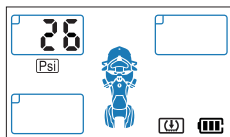

2. Press SET button shortly until beep once and then release to enter low pressure alarm value setting, the current value icon flash.

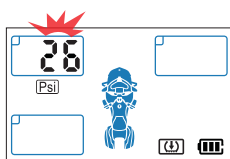
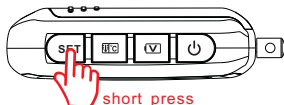

3. Press forward / backward button to adjust the value, by each press the value increase / decrease 1Psi and will be cycled.

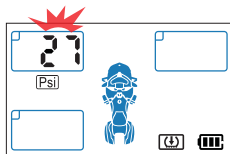
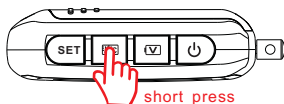

4. Press SET button shortly until beep once and then release to confirm the setting and exit the current mode.

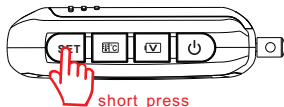

Rear Tire High Pressure Alarm Value Setting (Factory Default 46 Psi)

1. Choose low pressure alarm value setting, the display show icon  and the current value on lower-left.

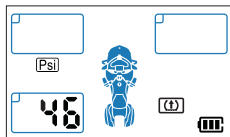

2. Press SET button shortly until beep once and then release to enter high pressure alarm value setting, the current value icon flash.

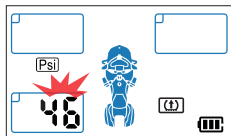
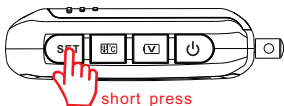

3. Press forward / backward button to adjust the value, by each press the value increase / decrease 1Psi and will be cycled.

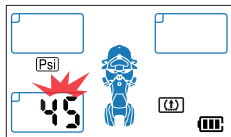
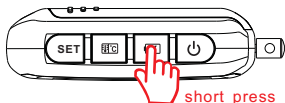

4. Press SET button shortly until beep once and then release to confirm the setting and exit the current mode.

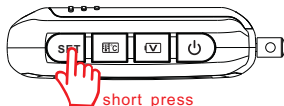

Rear Tire Low Pressure Alarm Value Setting (Factory Default 26 Psi)

1. Choose high pressure alarm value setting, the display show icon  and the current value on lower-left.

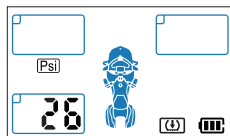

2. Press SET button shortly until beep once and then release to enter low pressure alarm value setting, the current value icon flash.

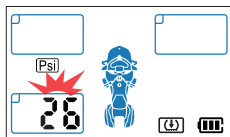
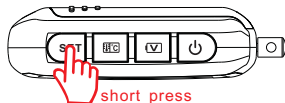



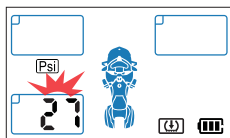
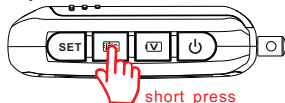

3. Press forward / backward button to adjust the value, by each press the value increase / decrease 1Psi and will be cycled.

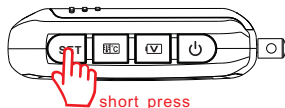

4. Press SET button shortly until beep once and then release to confirm the setting and exit the current mode.

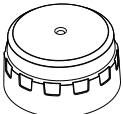

External Sensor Exploded View

	Cover
	Button Battery CR1632
	Sensor
	Silicon Seal Ring
	Hexagonal Nut

External Sensor Technical Parameter

Sensor Size: 20x20x16mm

Sensor Weight: <10g

Pressure Range: 0Psi-120Psi / 0Bar-8.0Bar

Battery Model: CR1632

Static Current: < 0.7 μ A

Battery Lifetime: about 1 year

Operating Current: < 12mA

Operating Temperature: -40 $^{\circ}$ C ~ +85 $^{\circ}$ C

Pressure Error: \pm 1Psi / \pm 0.1Bar

Temperature Error: \pm 2 $^{\circ}$ C

Operating Humidity: 5~98%

Working Frequency: FSK 433.92MHz

External Sensor Battery Replacement

* No need to take out the sensor from tire if it is installed already, just unscrew the sensor cover from the valve to replace battery.

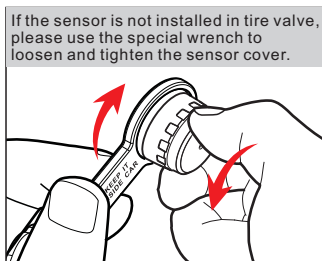
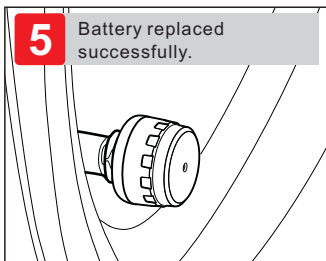
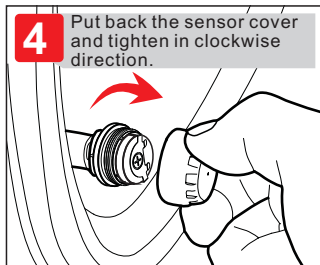
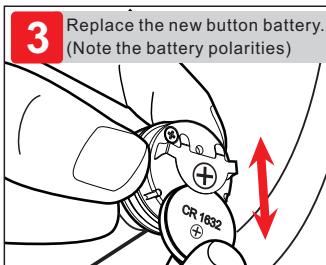
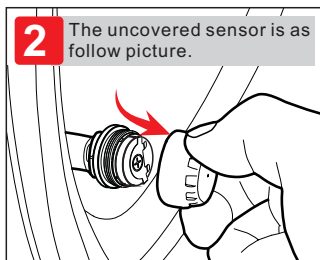
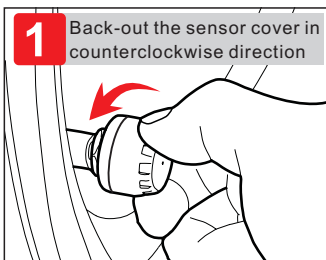

Top Reasons of Leaking in Nonstandard Tire Valves

Standard Valve

- The valve core is even with the edge.
- The valve thread length $\geq 9\text{mm}$

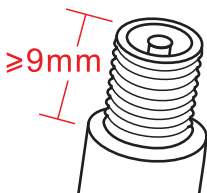

Leaking Reason 1 of Nonstandard Tire Valve

The breach in the valve may cause leaking, please replace it with a standard valve.



Leaking Reason 2 of Nonstandard Tire Valve

If the valve core is lower than edge, please adjust it with nut wrench.

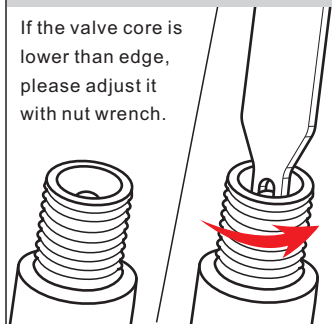

Leaking Reason 3 of Nonstandard Tire Valve

If the valve core is higher than edge, please adjust it with nut wrench.

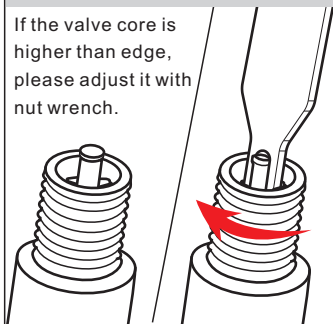

FAQ

Sensor Interface Leaking

It is usually caused by nonstandard tire valve, please replace it with a standard one in tire store.

Sensor Missing

Please buy sensor from our company and reset it.

Monitor Not Working

1. Check if the monitor AAA battery is installed.
2. Check if the monitor AAA battery polarity is correct.
3. Check if the monitor AAA battery is run out or power, please replace new one.
4. Please reinstall the monitor AAA battery.
5. Please contact the local distributor if the problem still exists after above checking.

Sensor Battery Out of Power (External)

Please replace a new button battery CR 1632

Sensor Transmission Not Good

- 1 . Check if the sensor is installed in tire and near the monitor, because the sensor and monitor wireless transmission distance is limited.
- 2 . Check if the sensor battery CR1632 is installed(External).
- 3 . Check if the sensor battery polarity is correct(External).
- 4 . Check if the sensor battery is run out of power, please replace new one(External).
- 5 . Please reinstall the sensor battery. After taking out the battery, wait for more than 10 seconds to reinstall it back, this will make sure the sensor is reset(External).
- 6 . Check if there is some sensor from another system mixed in this one. Each sensor has a unique ID code, and the monitor can only recognize the sensor from this system.
- 7 . Please contact the local distributor If the problem still exists after above checking.

Monitor Tire Pressure Show “0” and Warning

- 1 . Check if the sensor is installed properly.
- 2 . If it is external sensor, please tighten the sensor in the tire valve. Because the sensor can not detect the tire pressure if it is not contacted with valve core.

FAQ

Monitor Show Nothing after Restart

The sensor can only detect and show new tire pressure and temperature value when the pressure is changed by over 1Psi / 0.1Bar, so just drive and speed up the motorcycle

The Backup Silicon Seal Ring Use

The backup silicon seal ring is for replacing the old one in sensors, because it will be aged which may cause leaking after using for about 2 years. The original sensor is already installed with a silicon seal ring before leaving the factory, please do not set one more.

FCC Statement

This equipment has been tested and found to comply with the limits for a Class B digital device, pursuant to Part 15 of the FCC Rules. These limits are designed to provide reasonable protection against harmful interference in a residential installation. This equipment generates uses and can radiate radio frequency energy and, if not installed and used in accordance with the instructions, may cause harmful interference to radio communications. However, there is no guarantee that interference will not occur in a particular installation. If this equipment does cause harmful interference to radio or television reception, which can be determined by turning the equipment off and on, the user is encouraged to try to correct the interference by one or more of the following measures:

- Reorient or relocate the receiving antenna.
- Increase the separation between the equipment and receiver.
- Connect the equipment into an outlet on a circuit different from that to which the receiver is connected.
- Consult the dealer or an experienced radio/TV technician for help.

This device complies with part 15 of the FCC Rules. Operation is subject to the following two conditions: (1) This device may not cause harmful interference, and (2) this device must accept any interference received, including interference that may cause undesired operation.

Changes or modifications not expressly approved by the party responsible for compliance could void the user's authority to operate the equipment.